

NOTE: SEE SPECIFICATIONS FOR ADDITIONAL INFORMATION AND SCHEDULES

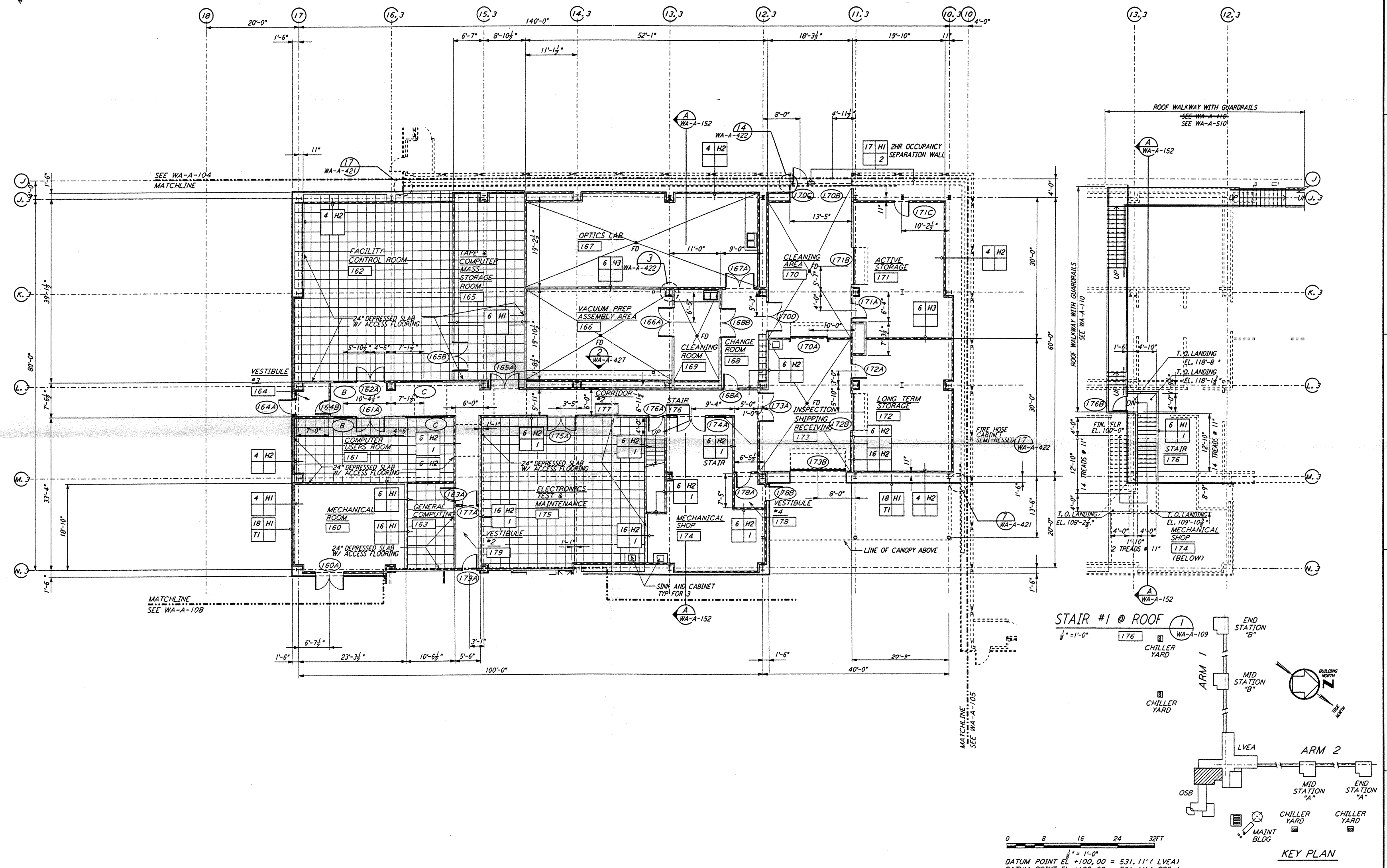
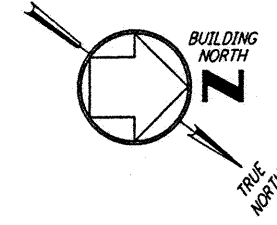

This document and the design it covers are the property of PARSONS. They are loaned only with the borrower's expressed written agreement that they will not be reproduced, copied, loaned, exhibited, or used in any other way, except by written consent from PARSONS to the borrower.

| NO. | DATE | BY | CHKD | ENGR | PROJ | DESCRIPTION |
|-----|------|----|------|------|------|-------------|
|     |      |    |      |      |      |             |
|     |      |    |      |      |      |             |
|     |      |    |      |      |      |             |

ISSUED FOR CONSTRUCTION  
 DRAWN SF/CRT 5-12-96  
 CHECKED TB 5-26-96  
 ENGINEER CLK 7-12-96  
 PROJ WAW 7/12/96

0629 REGISTERED ARCHITECT  
 ALEX ANDREW HUBB  
 STATE OF WASHINGTON  
 4/12/96

**PARSONS**  
 100 WEST WALNUT STREET  
 PASADENA, CALIFORNIA

**LIGO**  
 CALIFORNIA INSTITUTE OF TECHNOLOGY  
 MASSACHUSETTS INSTITUTE OF TECHNOLOGY

LASER INTERFEROMETER  
 GRAVITATIONAL-WAVE OBSERVATORY  
 SITE NO. 1 - HANFORD, WASHINGTON

ARCHITECTURAL CORNER STATION  
 OSB PARTIAL FLOOR PLAN SHEET 2  
 AS NOTED PPI 150969 8094  
**WA-A-109**

0 8 16 24 32 FT  
 1" = 16'-0"  
 DATUM POINT EL. +100.00 = 531.11' (LVEA)  
 DATUM POINT EL. +100.00 = 531.11' (OSB)

REG. JUN. 20, 1994 REV. 1/79 5170 517002 45711515 MAR 25 1996 45711515

REG. JUN. 20, 1994 REV. 1/79 517002 45711515 MAR 25 1996 45711515