

This document and the design it covers are the property of PARSONS. They are loaned only with the borrower's expressed written agreement that they will not be reproduced, copied, loaned, exhibited, or used in any other way, except by written consent from PARSONS to the borrower.

This document and the design it covers are the property of PARSONS. They are loaned only with the borrower's expressed written agreement that they will not be reproduced, copied, loaned, exhibited, or used in any other way, except by written consent from PARSONS to the borrower.

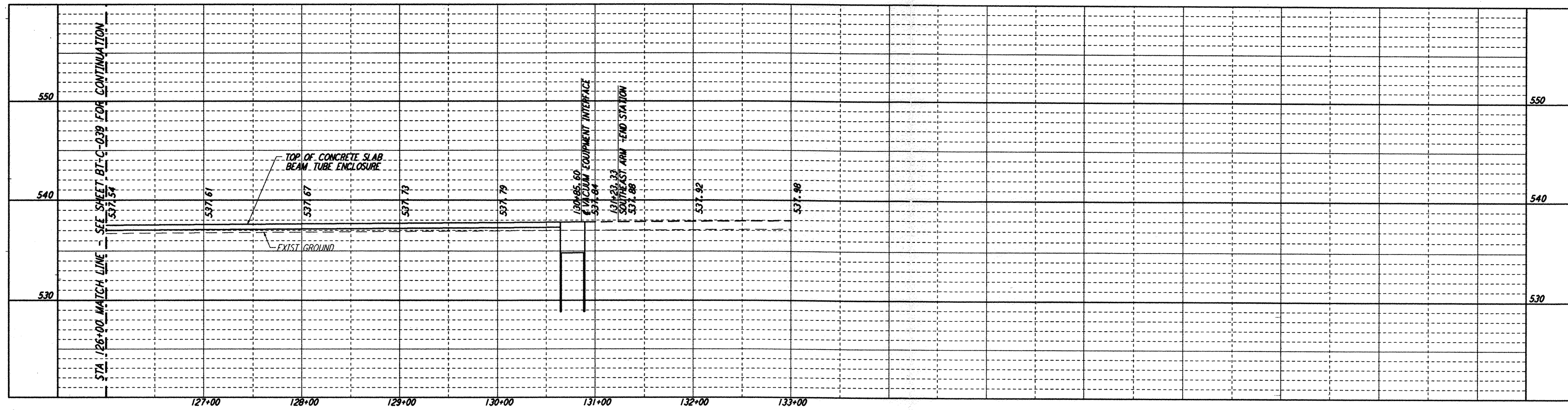

**PROFILE**  
 SCALES: HORIZ: 1" = 50'  
 VERT: 1" = 5'

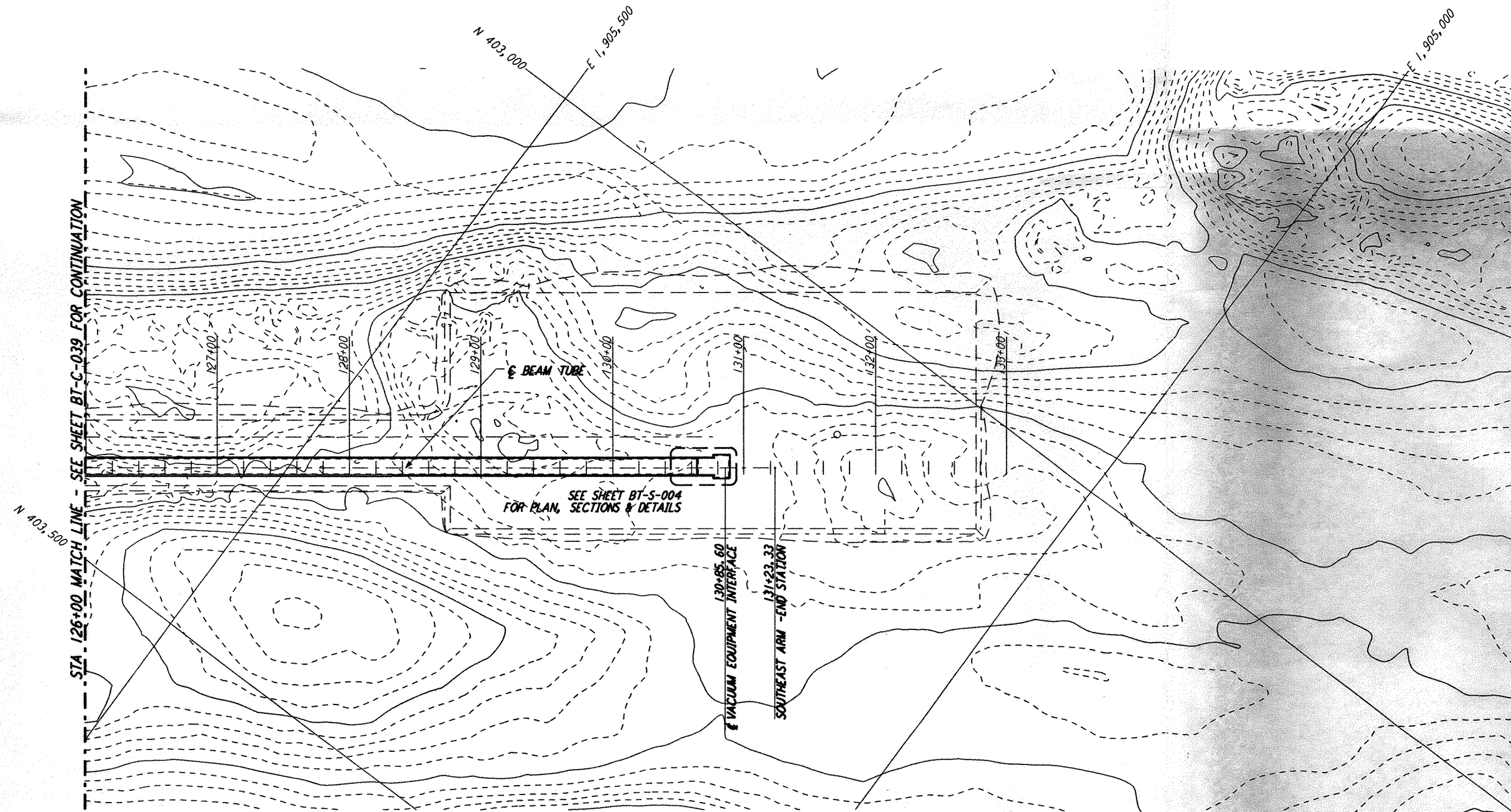

**PLAN**  
 SCALE: 1" = 50'

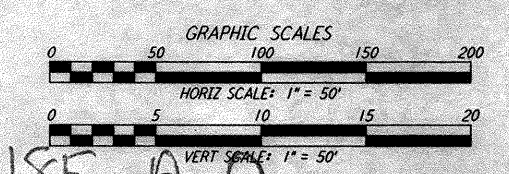
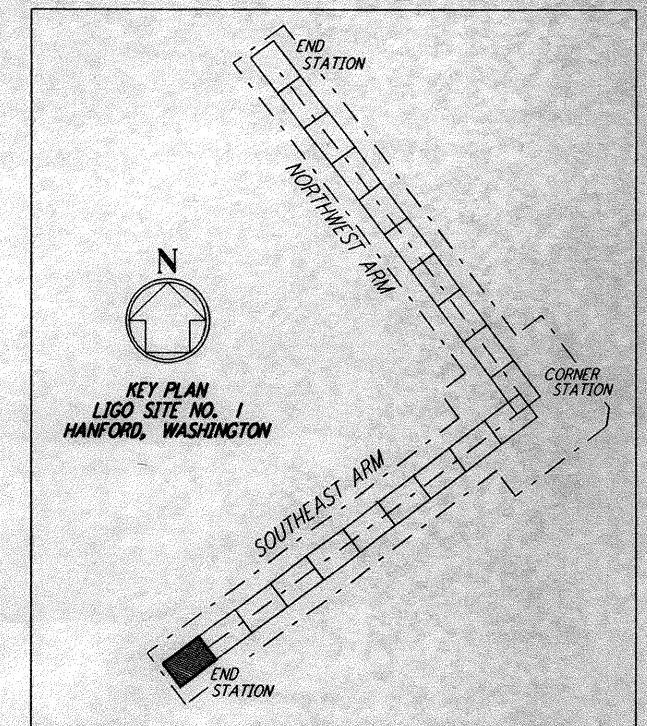
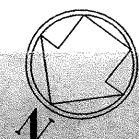

0960185-A-D

NO.	DATE	APRD BY	DESCRIPTION OF REVISION
9			
8			
7			
6			
5			
4			
3			
2			
1			

NO.	DATE	APRD BY	ISSUED FOR
1	8-14-95		PRELIMINARY DESIGN REPORT

DATE	BY
8-10-95	WRB

**PARSONS**  
 100 WEST WALNUT STREET  
 PASADENA, CALIFORNIA

**LIGO**  
 CALIFORNIA INSTITUTE OF TECHNOLOGY  
 MASSACHUSETTS INSTITUTE OF TECHNOLOGY

**LASER INTERFEROMETER  
 GRAVITATIONAL-WAVE OBSERVATORY  
 BEAM TUBE ENCLOSURE - HANFORD, WA**

TITLE	SCALE	CONTRACT NUMBER	PROJECT NUMBER
SOUTHWEST ARM PLAN AND PROFILE STA 126+00 TO STA 133+00	AS NOTED	PP150969	8094
SHEET NUMBER	BT-C-040	REVISIONS	