

This document and the design it covers are the property of PARSONS. They are loaned only with the borrower's expressed written agreement that they will not be reproduced, copied, loaned, exhibited, or used in any other way, except by written consent from PARSONS to the borrower.

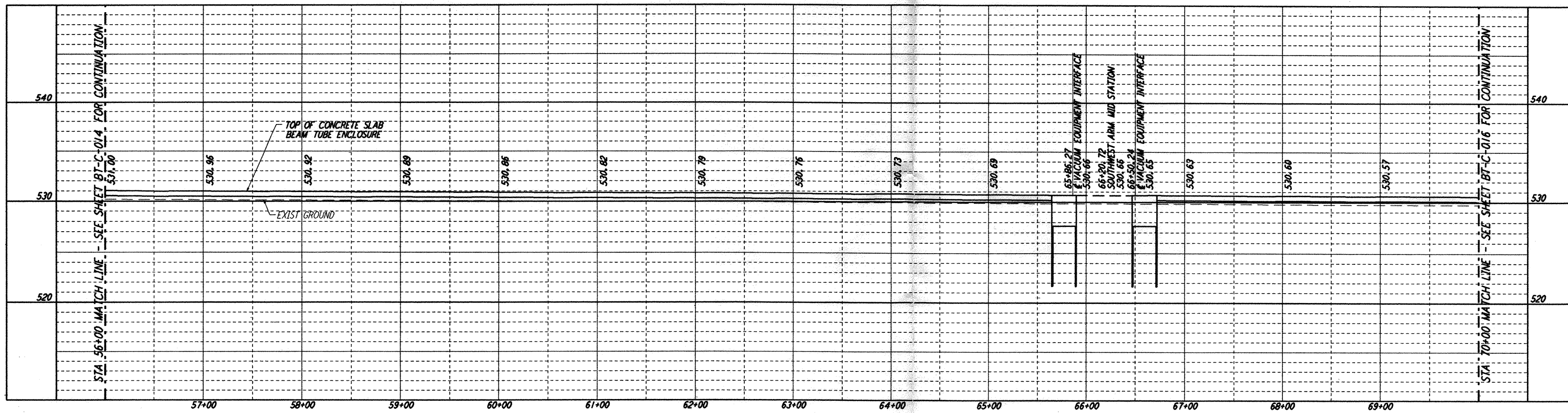

**PROFILE**  
 SCALES: HORIZ: 1" = 50'  
 VERT: 1" = 5'

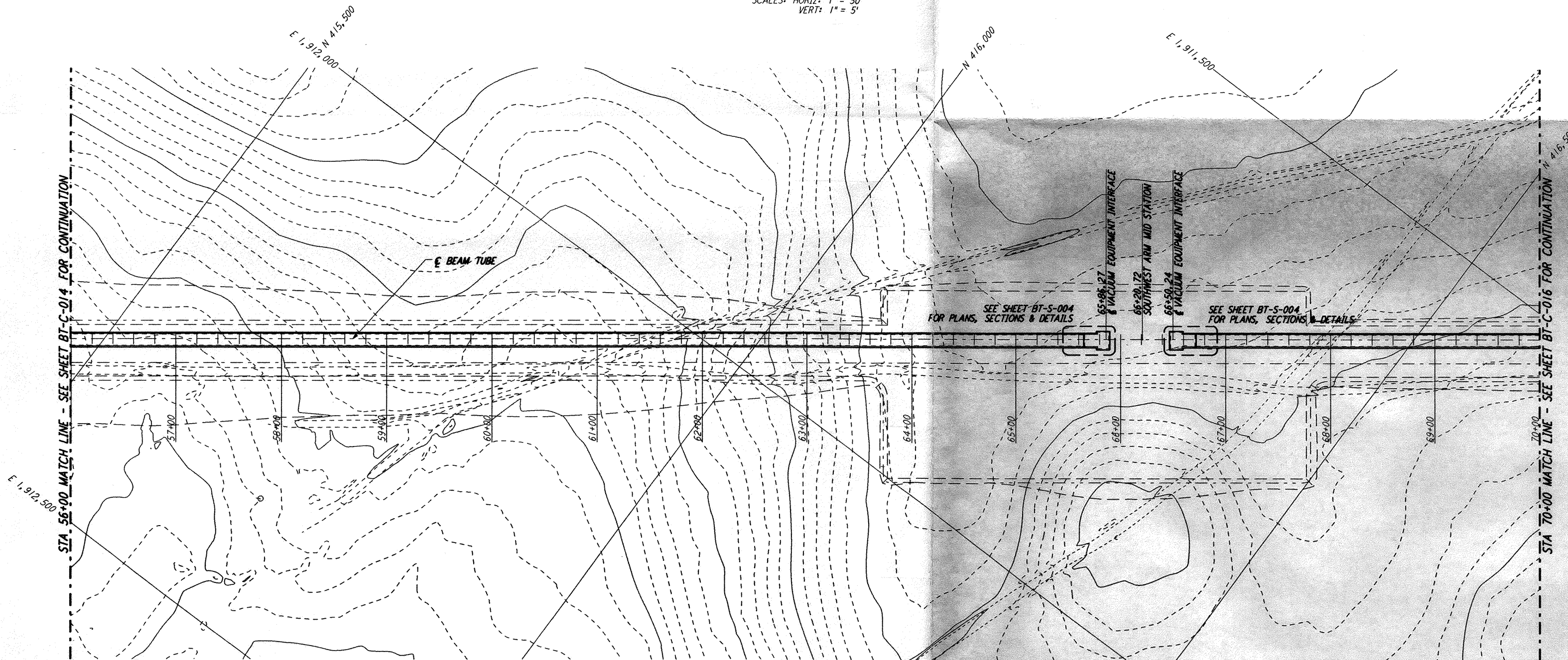

**PLAN**  
 SCALE: 1" = 50'

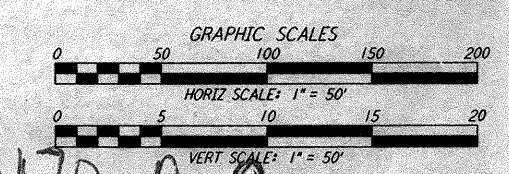
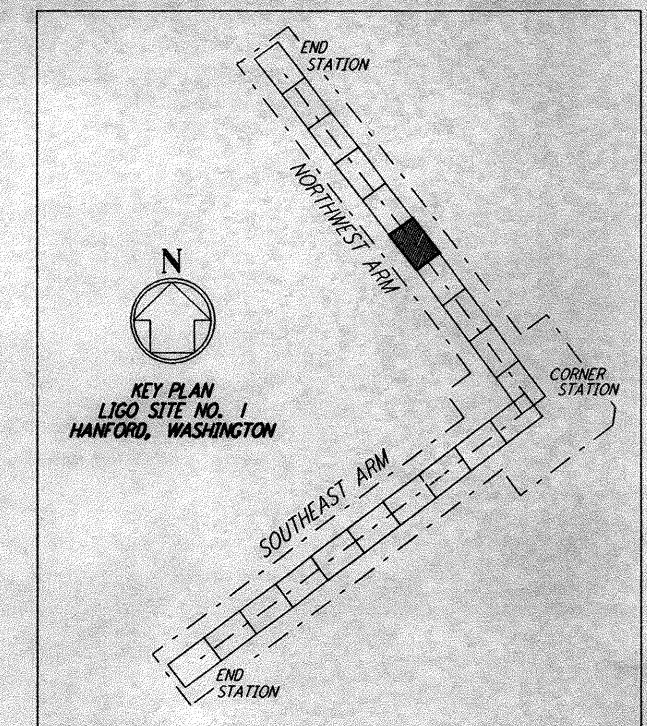
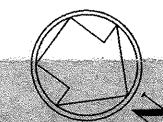

0960170-A-0

NO.	DATE	APPR BY	DESCRIPTION OF REVISION
9			
8			
7			
6			
5			
4			
3			
2			
1			

NO.	DATE	APPR BY	ISSUE
9			
8			
7			
6			
5			
4			
3			
2			
1	8-14-95		PRELIMINARY DESIGN REPORT

DATE	8-10-95
DRAWN	WRB
CHECKED	
SECT HD	
PROJ MGR	
CLIENT	

**PARSONS**  
 100 WEST WALNUT STREET  
 PASADENA, CALIFORNIA

**LIGO**  
 CALIFORNIA INSTITUTE OF TECHNOLOGY  
 MASSACHUSETTS INSTITUTE OF TECHNOLOGY

**LASER INTERFEROMETER  
 GRAVITATIONAL-WAVE OBSERVATORY  
 BEAM TUBE ENCLOSURE - HANFORD, WA**

TITLE: NORTHWEST ARM PLAN AND PROFILE STA 56+00 TO STA 70+00

SCALE: AS NOTED

CONTRACT NUMBER: PP150969

PROJECT NUMBER: 8094

SHEET NUMBER: BT-C-015

REVISION: