

NOTES: (UNLESS OTHERWISE SPECIFIED)
 1. BREAK ALL SHARP EDGES.
 2. SPECIFICATIONS FOR THE CONSTRUCTION OF THIS ASSEMBLY ARE COVERED IN THE LARGE OPTIC SUSPENSION SPECIFICATION, LIGO E970038.

| REV | DATE | DRAWN BY | CHECKED | DCC | DCN/DESCRIPTION |
|-----|---------|----------|---------|-----|---|
| A | 1/19/98 | J. HAZEL | | | E980004/INITIAL RELEASE |
| B | 5/1/98 | J. HAZEL | | | E980088/ATTACHED I.D. PLACEMENT |
| C | 5/11/98 | J. HAZEL | | | E980090/1.00 DIM FROM EDGE WAS .50 FROM EDGE REC HOLE-1.50 WAS 1.00 |

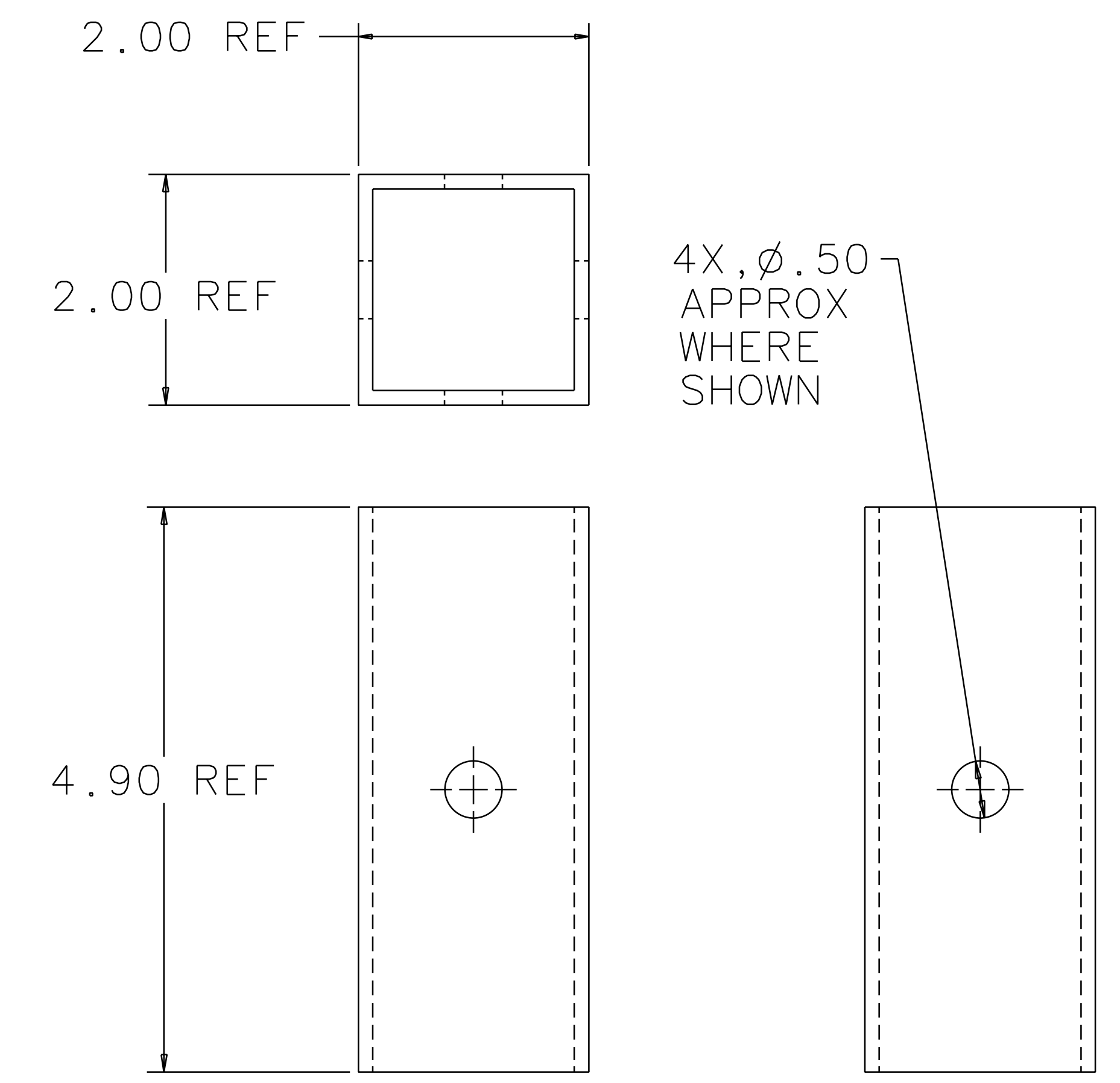

LEG DETAIL
SCALE 1/1

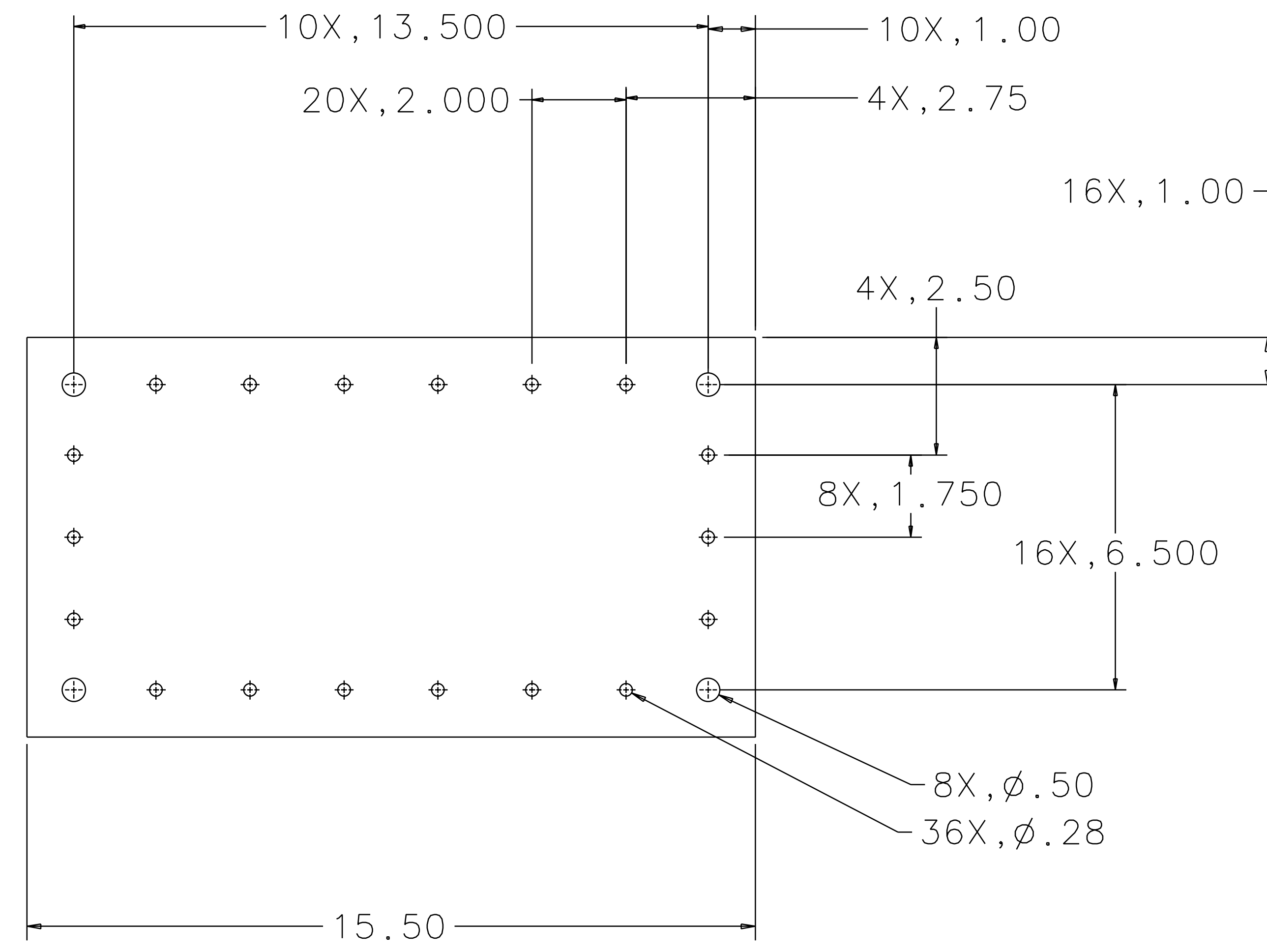
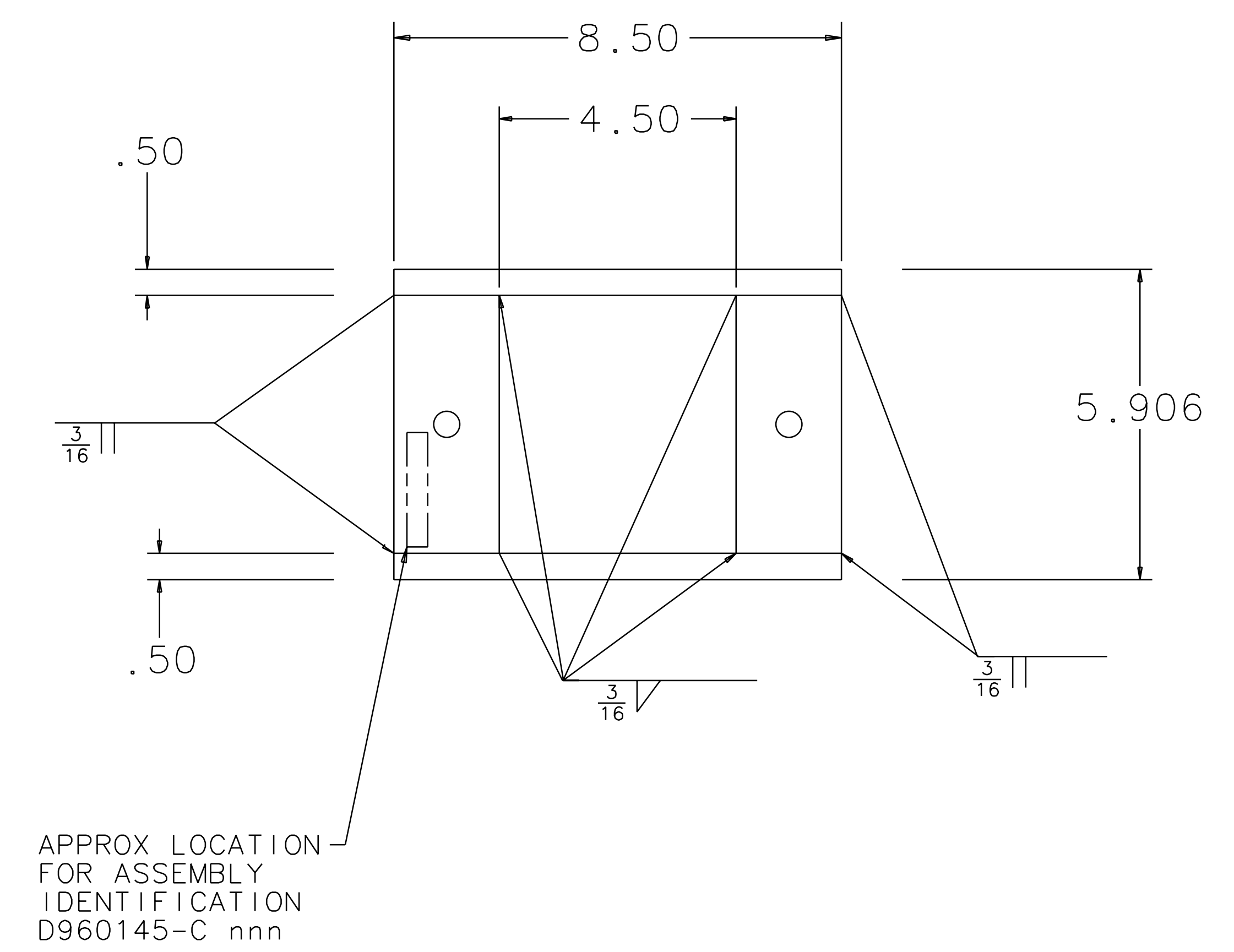
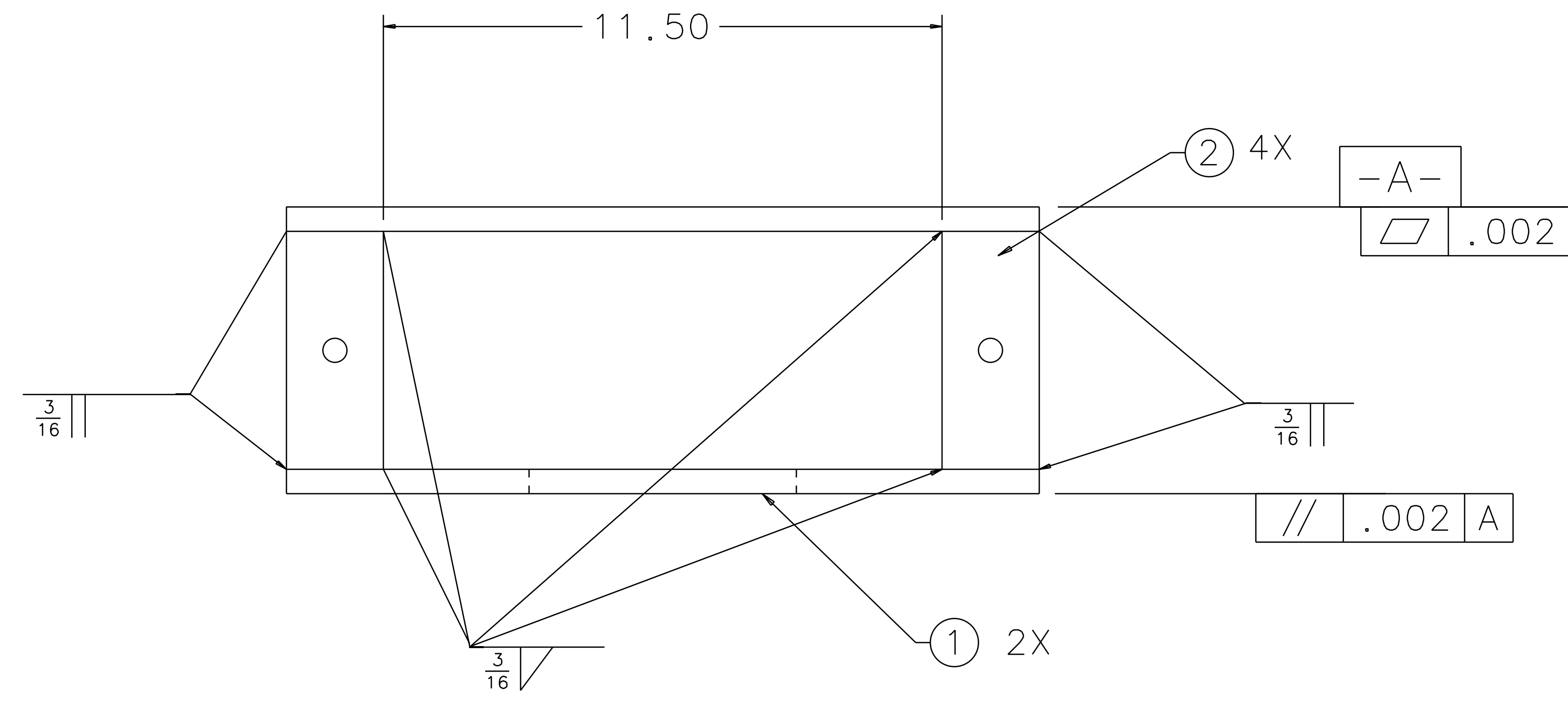

APPROX LOCATION FOR ASSEMBLY IDENTIFICATION D960145-C nnn

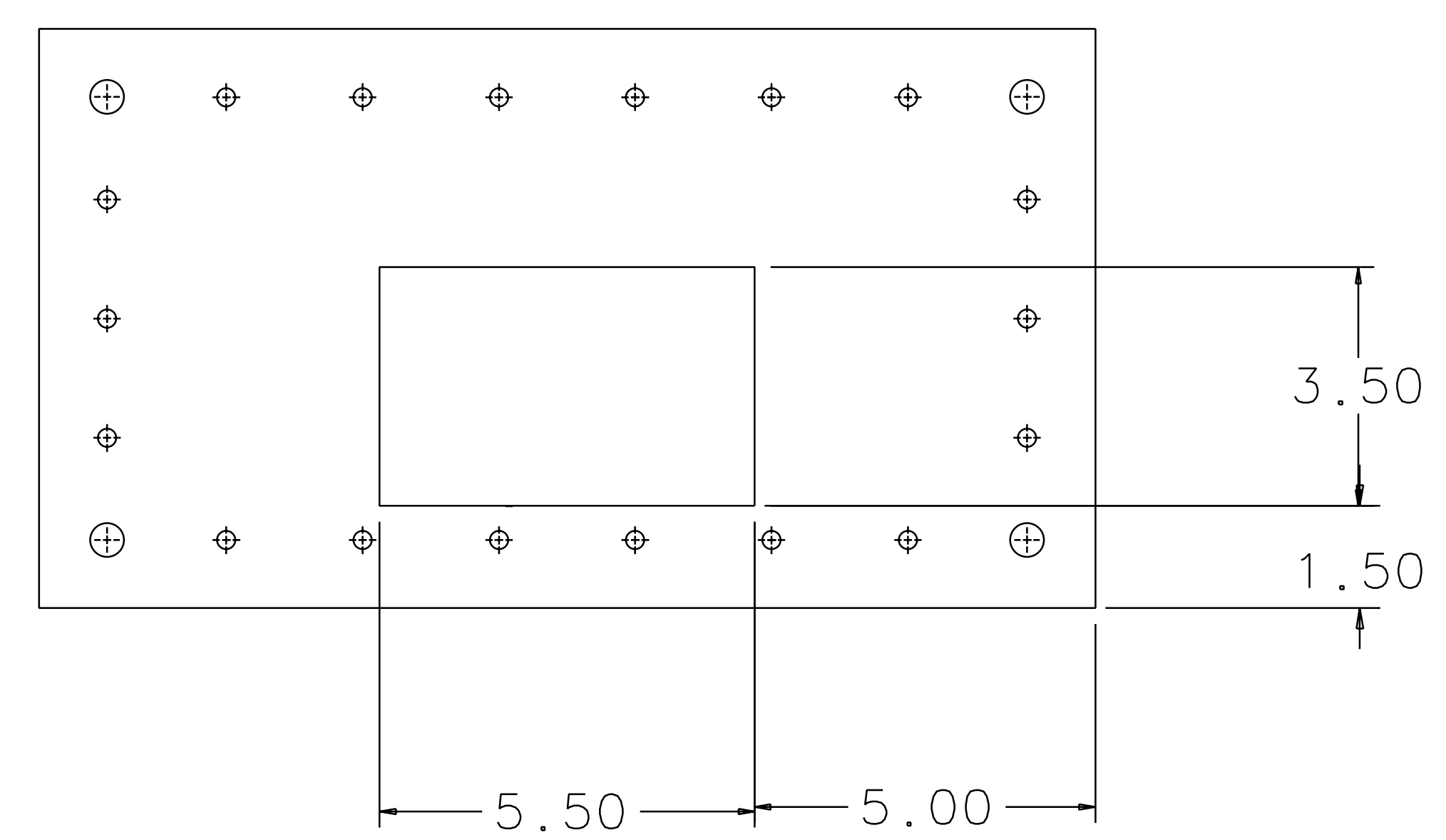

| QTY | REQ | PART OR IDENTIFYING NO | NOMENCLATURE OR DESCRIPTION | MATERIAL SPECIFICATION | ITEM NO. |
|-----|-----|------------------------|---------------------------------------|------------------------|----------|
| 4 | | | LEGS: 2.0 x 2.0 x .125 WALL THICKNESS | 304 STAINLESS | 2 |
| 2 | | | PLATES: 15.5 x 8.5 x .5 (REF) | 304 STAINLESS | 1 |

UNLESS OTHERWISE SPECIFIED DIMENSIONS ARE IN INCHES
 TOLERANCES ARE:
 FRACTIONS DECIMALS ANGLES
 0.XX±0.01
 0.XXX±0.005
 ANGLES±0.5°

DO NOT SCALE DRAWING

APPROVALS DATE TITLE
 J. Hazel 5/96
 DRAWN BY
 CHECKED

LIGO CALIFORNIA INSTITUTE OF TECHNOLOGY
 MASSACHUSETTS INSTITUTE OF TECHNOLOGY
 LOS HEIGHT ADAPTER ASSEMBLY

MATERIAL 304 STAINLESS
 FINISH SEE NOTES

SCALE 1/2

REV C

SHEET 1 OF 1

NEXT ASSEMBLY D960132, D970560, D970572
 FILE LOCATION home/dcc/docs/D960145.pdf