

8 7 6 5 4 3 2 1

**NOTES CONTINUED:**  
 ⑤ SCRIBE, ENGRAVE, OR MECHANICALLY STAMP (NO INKS OR DYES) DRAWING PART NUMBER, REVISION (AND VARIANT OR "TYPE" IF APPLICABLE) ON NOTED SURFACE OF PART FOLLOWED ON THE NEXT LINE WITH A THREE DIGIT SERIAL NUMBER. SERIAL NUMBERS START AT 001 FOR THE FIRST ARTICLE AND PROCEED CONSECUTIVELY. USE MINIMUM 0.12" HIGH CHARACTERS, UNLESS THE SIZE OF THE PART DICTATES SMALLER CHARACTERS. A VIBRATORY TOOL MAY BE USED.  
 EXAMPLE: DXXXXXX-VY, TYPE-XX, S/N XXX

| REV. | DATE        | DCN #    | DRAWING TREE # |
|------|-------------|----------|----------------|
| V1   | 22 OCT 2010 | E1000614 | -              |
| -    | -           | -        | -              |
| -    | -           | -        | -              |

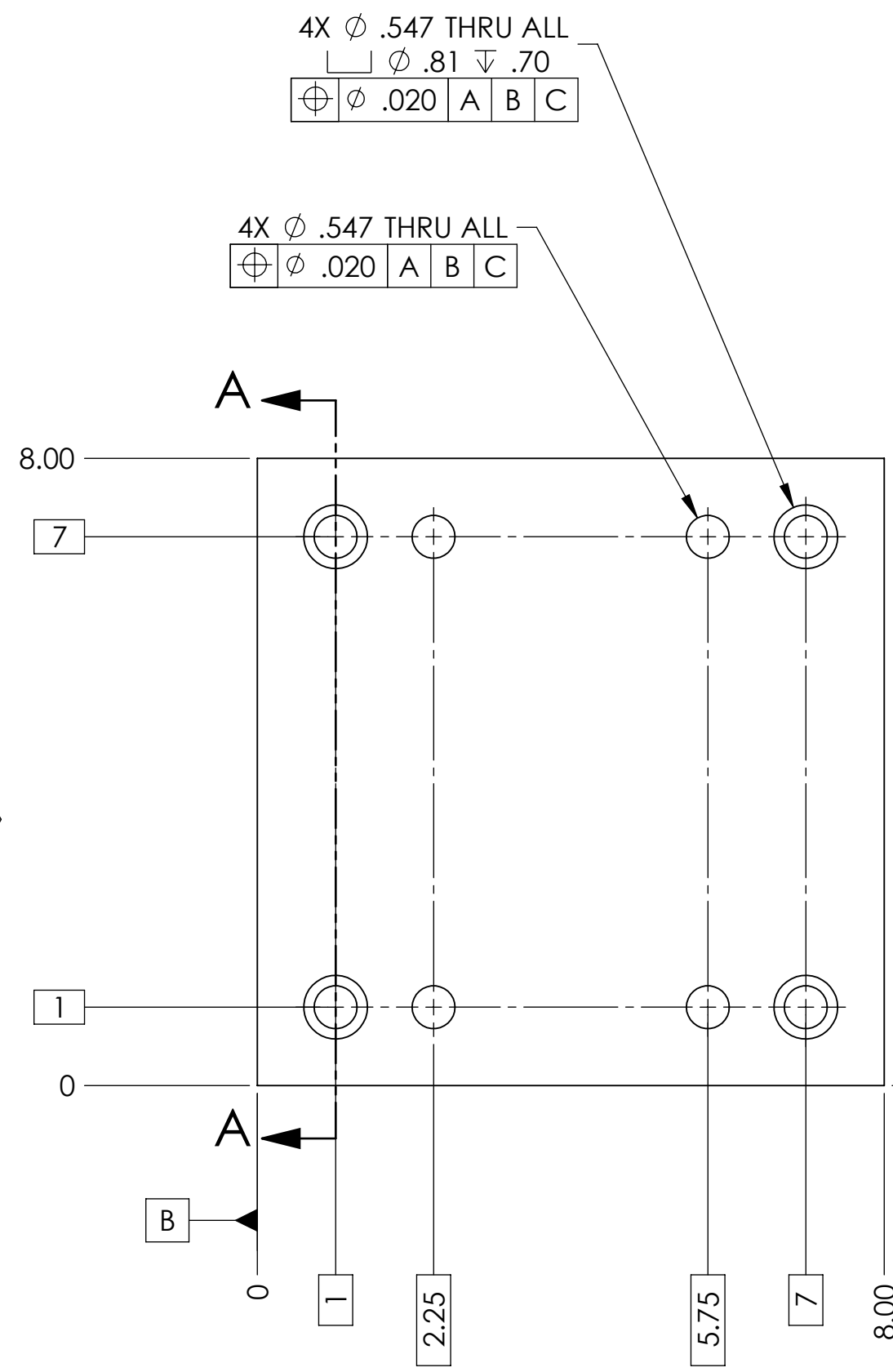
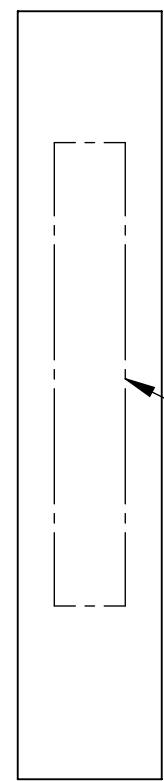
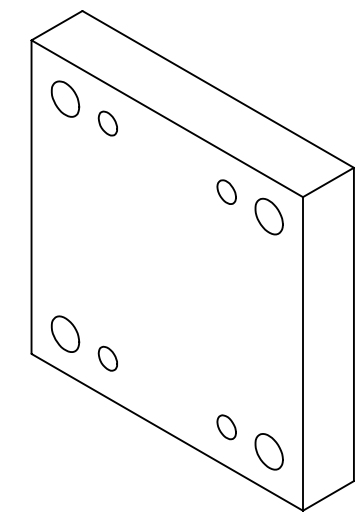

4X  $\phi$  .547 THRU ALL  
 $\square$   $\phi$  .81  $\nabla$  .70  

|          |             |   |   |   |
|----------|-------------|---|---|---|
| $\oplus$ | $\phi$ .020 | A | B | C |
|----------|-------------|---|---|---|

4X  $\phi$  .547 THRU ALL  

|          |             |   |   |   |
|----------|-------------|---|---|---|
| $\oplus$ | $\phi$ .020 | A | B | C |
|----------|-------------|---|---|---|

$\square$  .010

$\square$  .005

1.50

SECTION A-A

D070591 Spacer, HAM-ISI Installation Fixture, PART PDM REV: X-001, DRAWING PDM REV:

| NOTES AND TOLERANCES: (UNLESS OTHERWISE SPECIFIED)   |                                      |
|--|--------------------------------------|
| DIMENSIONS ARE IN INCHES   |                                      |
| TOLERANCES:<br>.XX $\pm$ .01<br>.XXX $\pm$ .005<br>ANGULAR $\pm$ 0.5°  |                                      |
| 1. INTERPRET DRAWING PER ASME Y14.5-1994.  | 2. REMOVE ALL SHARP EDGES, R.02 MIN. |
| 3. DO NOT SCALE FROM DRAWING.  |                                      |
| 4. ALL MACHINING FLUIDS MUST BE FULLY SYNTHETIC, FULLY WATER SOLUBLE AND FREE OF SULFUR, SILICONE, AND CHLORINE. |                                      |
| MATERIAL   | FINISH                               |
| 6061 Alloy   | 128 $\mu$ inch                       |

|   |                                      |                     |
|---|--------------------------------------|---------------------|
| CALIFORNIA INSTITUTE OF TECHNOLOGY<br>MASSACHUSETTS INSTITUTE OF TECHNOLOGY | PART NAME                            |                     |
|   | Spacer, HAM-ISI Installation Fixture |                     |
|   | SYSTEM<br>ADVANCED LIGO              | SUB-SYSTEM<br>SEI   |
| NEXT ASSY<br>D070587  | DESIGNER<br>FMATCHARD                | DATE<br>DEC 2007    |
|   | DRAFTER<br>SBARNUM                   | DATE<br>19 OCT 2010 |
|   | CHECKER<br>FMATCHARD                 | DATE<br>21 OCT 2010 |
|   | APPROVAL<br>KMASON                   | DATE<br>22 OCT 2010 |

|            |             |              |
|------------|-------------|--------------|
| SIZE       | DWG. NO.    | REV.         |
| B          | D070591     | v1           |
| SCALE: 1:2 | PROJECTION: | SHEET 1 OF 1 |

8 7 6 5 4 3 2 1