

REV.	DATE	DCN #	DRAWING TREE #
A	20th July 2007	E070186-00-D	

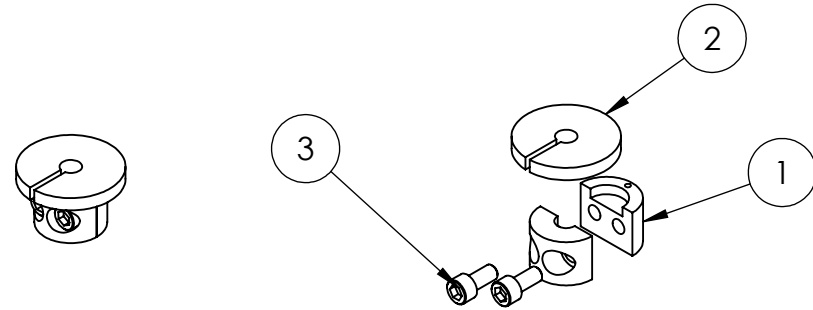
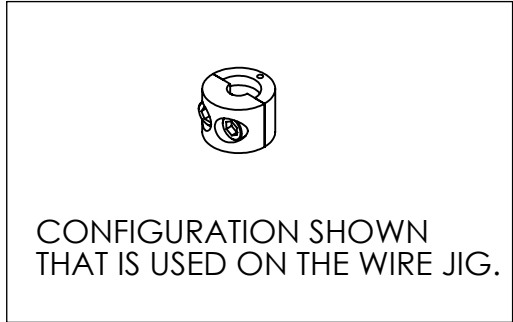

ITEM NO.	QTY	SPARE	TOTAL	PART NUMBER	DESCRIPTION	MATERIAL
4	1		0	D070213	WIRE CLAMP 4 OPTICAL BENCH	300 SSTL
3	2		0	---	Ag-SST SOCKET HEAD CAP SCREW #2-56 UNC-2A X 0.1875 LONG	300 SSTL
2	1		0	D070068	C SPACER LOCATED BETWEEN GLASS BENCH & WIRE CLAMP	300 SSTL
1	1		0	D070070	WIRE CLAMP 4 OPTICAL BENCH	300 SSTL

NOTES: (UNLESS OTHERWISE SPECIFIED)

LIGO CALIFORNIA INSTITUTE OF TECHNOLOGY
 MASSACHUSETTS INSTITUTE OF TECHNOLOGY
 IGR, GLASGOW UNIVERSITY GEO 600 GROUP

SCOTTISH UNIVERSITIES PHYSICS ALLIANCE
 TECHNOLOGY FOR EXPERIMENTAL &
 OBSERVATIONAL PHYSICS IN SCOTLAND (TEOPS)

SYSTEM ADVANCED LIGO
 SUB-SYSTEM SUS OMC
 NEXT ASSY OPTICAL BENCH
 PART NAME LOWER CLAMP WIRE CLAMP ASSEMBLY

DRAWN C. Torrie 7 FEB 2007
 CHECKED M. Meyer
 APPROVED

SIZE DWG. NO. D070067 REV. A
 SCALE: 1:5 PROJECTION: SHEET 1 OF 1