

NOTES: (UNLESS OTHERWISE SPECIFIED)  
 1. BREAK ALL SHARP EDGES .01/.02 X 45°  
 2. ALL DIMENSIONS IN MILLIMETER

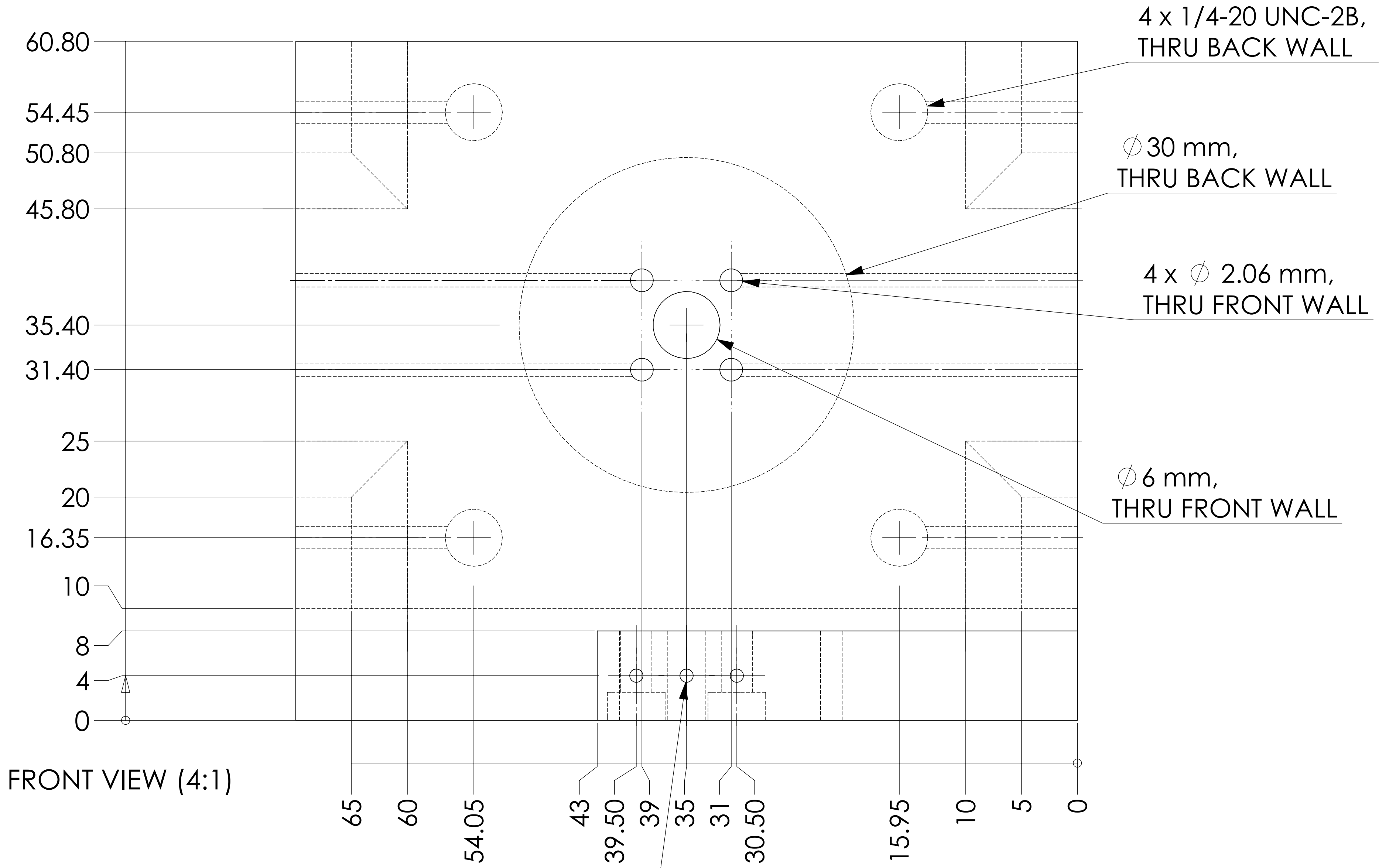

FRONT VIEW (4:1)

3 x VENT HOLES,  $\phi$  1.20 mm,  
 THRU TO NEXT HOLE

UNLESS OTHERWISE SPECIFIED:		NAME	DATE	Massachusetts Institute of Technology LIGO project
DIMENSIONS ARE IN mm	DRAWN	Edith Innerhofer	02/2006	TITLE: RPI, OSEM-plate-extender, Rev 01, page 1/4
TOLERANCES ARE: $\pm$ 0.05mm	CHECKED			
ANGULAR: $\pm$ .25°	ENG APPR.			
	MFG APPR.			
MATERIAL Aluminum	Q.A.			SIZE DWG. NO. REV <b>C</b> LIGO-D060036-01-R 01
FINISH $\sqrt{32}$	COMMENTS:			
DO NOT SCALE DRAWING				SCALE: 4:1 WEIGHT: SHEET 1 OF 4

NOTES: (UNLESS OTHERWISE SPECIFIED)  
 1. BREAK ALL SHARP EDGES .01/.02 X 45°  
 2. ALL DIMENSIONS IN MILLIMETER

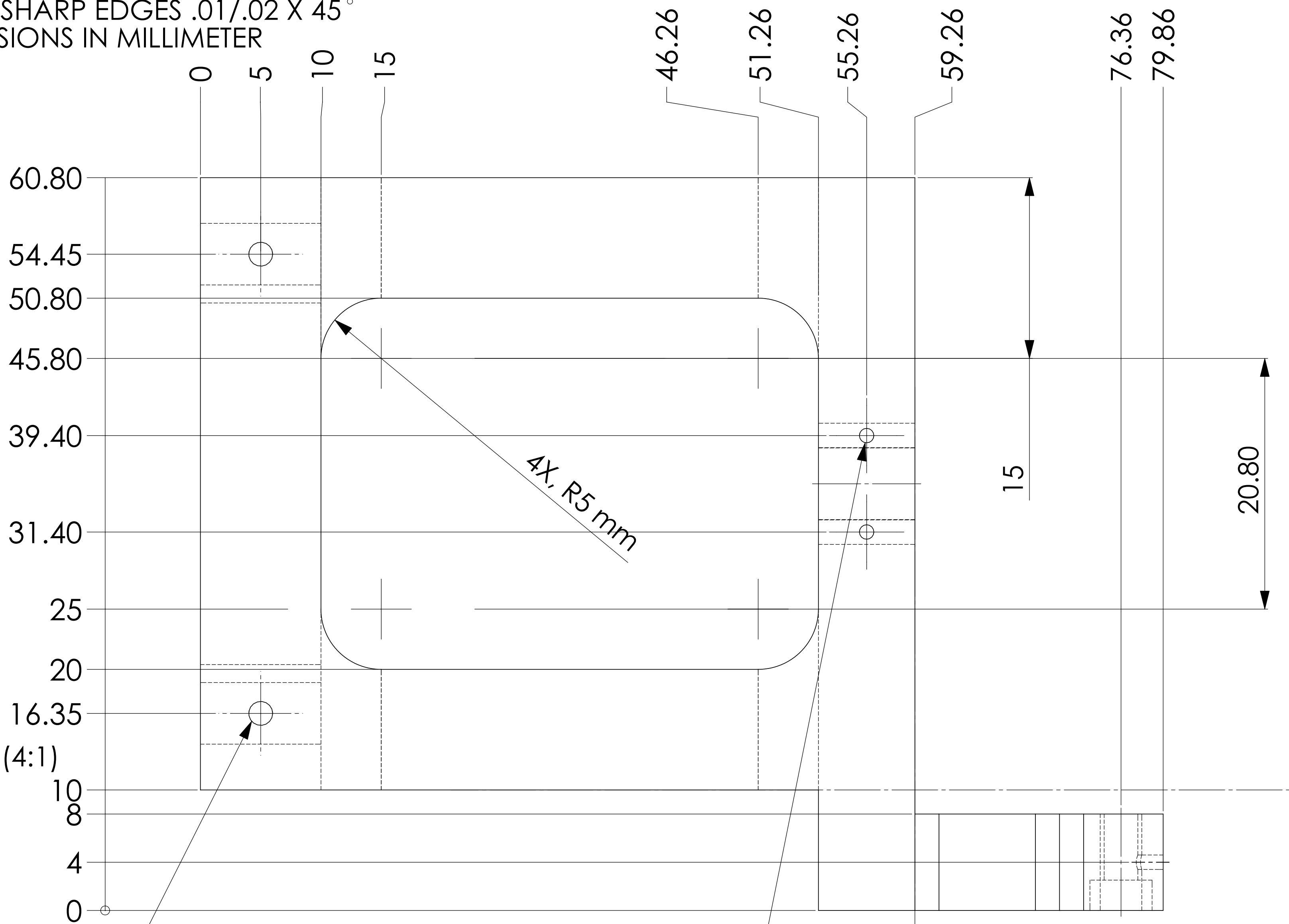

RIGHT VIEW (4:1)

VENT HOLES  $\phi$  2 mm THRU NEXT HOLE  
 2X THIS SIDE  
 2X BACK SIDE

4 x  $\phi$  1.20 mm, THRU TO NEXT HOLE  
 2 THIS SIDE, 2 BACK SIDE

UNLESS OTHERWISE SPECIFIED:		NAME	DATE	Massachusetts Institute of Technology LIGO project
DIMENSIONS ARE IN mm	DRAWN	Edith Innerhofer	02/2006	TITLE: RPI, OSEM-plate-extender, Rev 01, page 2/4
TOLERANCES ARE: $\pm$ 0.05mm	CHECKED			
ANGULAR: $\pm$ .25°	ENG APPR.			
MATERIAL Aluminum	MFG APPR.			Q.A.
FINISH $\sqrt{32}$	COMMENTS:			SCALE: 4:1
DO NOT SCALE DRAWING				REV 01
				SCALE: 4:1 WEIGHT: SHEET 2 OF 4

NOTES: (UNLESS OTHERWISE SPECIFIED)  
 1. BREAK ALL SHARP EDGES .01/.02 X 45°  
 2. ALL DIMENSIONS IN MILLIMETER

2 x  $\phi$  0.11 inch THRU ALL  
 $\square$   $\phi$  0.2031 inch  $\nabla$  0.099 inch  
 (CBORE FOR #3 SOCKET HEAD  
 CAP SCREW)

8-32 UNC-2B THRU ALL

4x, R 5mm

3x, FILET R 2mm

TOP VIEW (3:1)

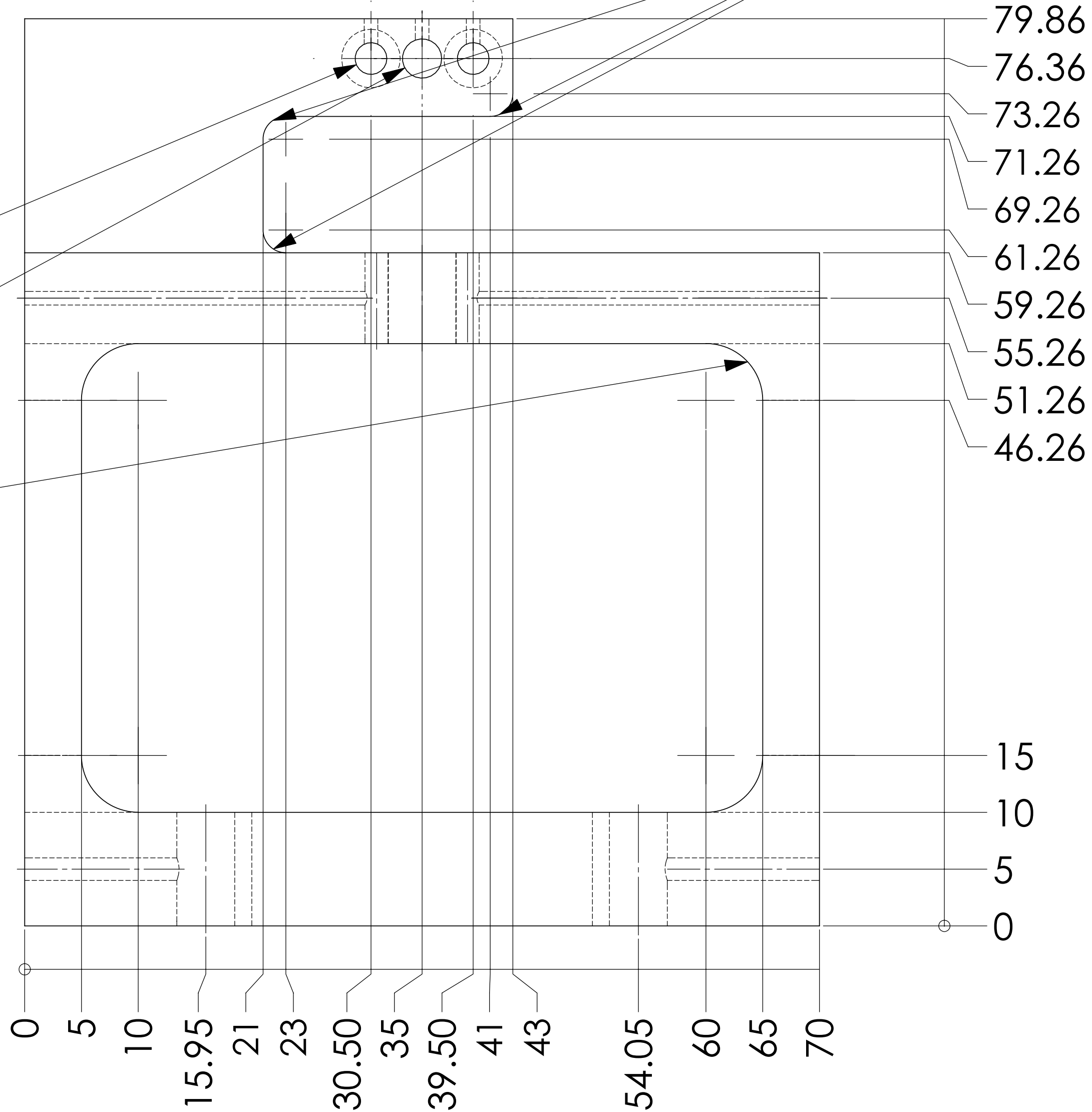

UNLESS OTHERWISE SPECIFIED:		NAME	DATE	Massachusetts Institute of Technology LIGO project
DIMENSIONS ARE IN mm TOLERANCES ARE: $\pm$ 0.05mm ANGULAR: $\pm$ .25°		DRAWN Edith Innerhofer	02/2006	
MATERIAL Aluminum		CHECKED		TITLE: RPI, OSEM-plate-extender, Rev 01, page 3/4
FINISH 32/ $\nabla$		ENG APPR.		
DO NOT SCALE DRAWING		MFG APPR.		SIZE DWG. NO. REV <b>C</b> LIGO-D060036-01-R 01
		COMMENTS:		
		SCALE: 3:1	WEIGHT:	SHEET 3 OF 4

NOTES: (UNLESS OTHERWISE SPECIFIED)  
 1. BREAK ALL SHARP EDGES .01/.02 X 45°  
 2. ALL DIMENSIONS IN MILLIMETER

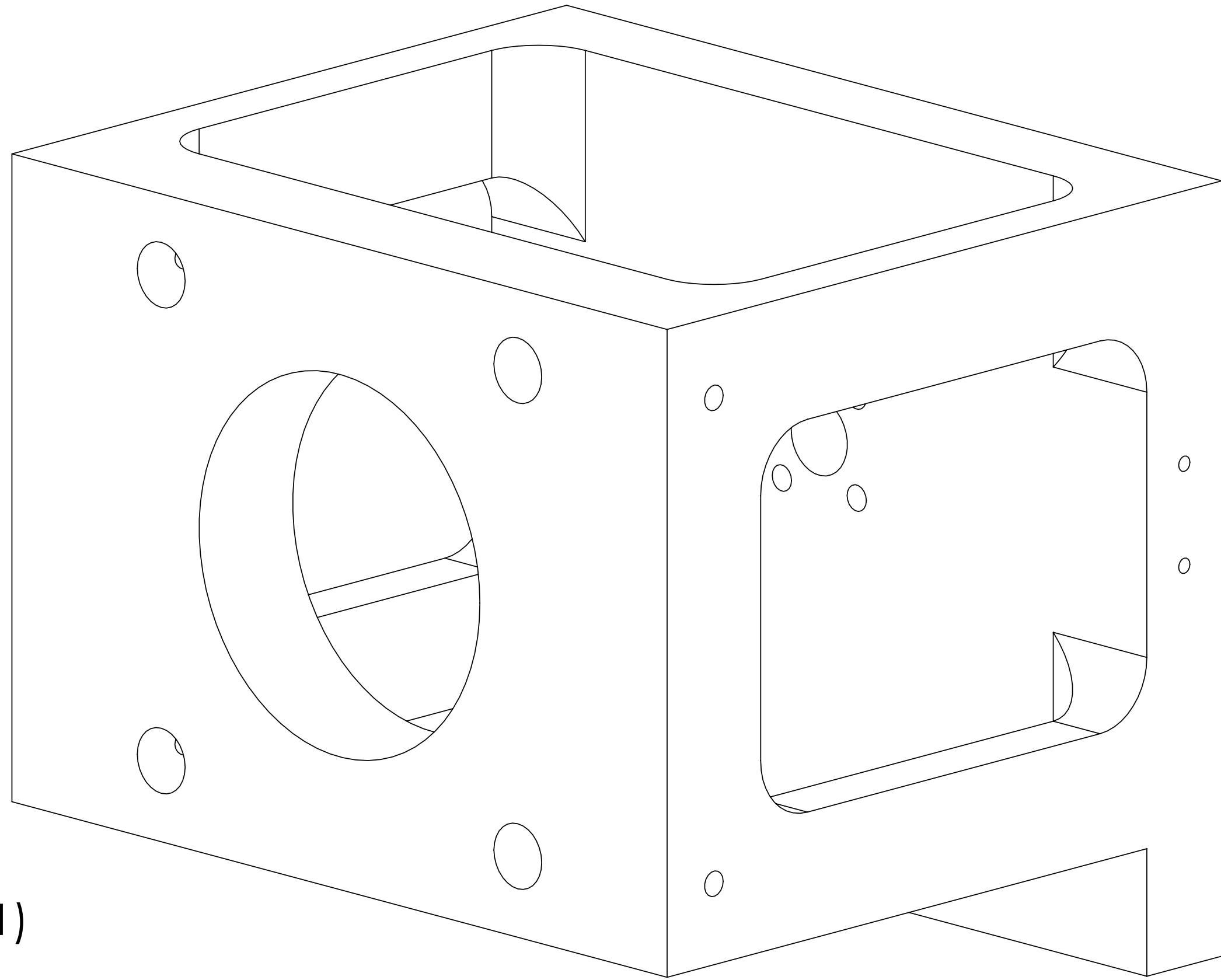

DIMETRIC VIEW (3:1)

UNLESS OTHERWISE SPECIFIED:		NAME	DATE	Massachusetts Institute of Technology LIGO project		
DIMENSIONS ARE IN mm	DRAWN	Edith Innerhofer	02/2006	TITLE:		
TOLERANCES ARE: ± 0.05mm	CHECKED			RPI, OSEM-plate-extender, Rev 01, page 4/4		
ANGULAR: ± .25°	ENG APPR.			SIZE		
	MFG APPR.			DWG. NO.	REV	
MATERIAL	Q.A.			<b>C</b>	LIGO-D060036-01-R	01
Aluminum	COMMENTS:			SCALE: 4:1	WEIGHT:	SHEET 4 OF 4
FINISH						
32/						
DO NOT SCALE DRAWING						