

NOTES: (UNLESS OTHERWISE SPECIFIED)  
 1. BREAK ALL SHARP EDGES .01/.02 X 45°  
 2. ALL DIMENSIONS IN MILLIMETER

HC= HOLE CENTER

4X, 1-72 UNC-2B, THRU ALL  
 STARTING FROM 45deg SURFACE

2 x  $\phi$  2.06 mm  
 THRU ALL

FILET 4x R 0.50 mm

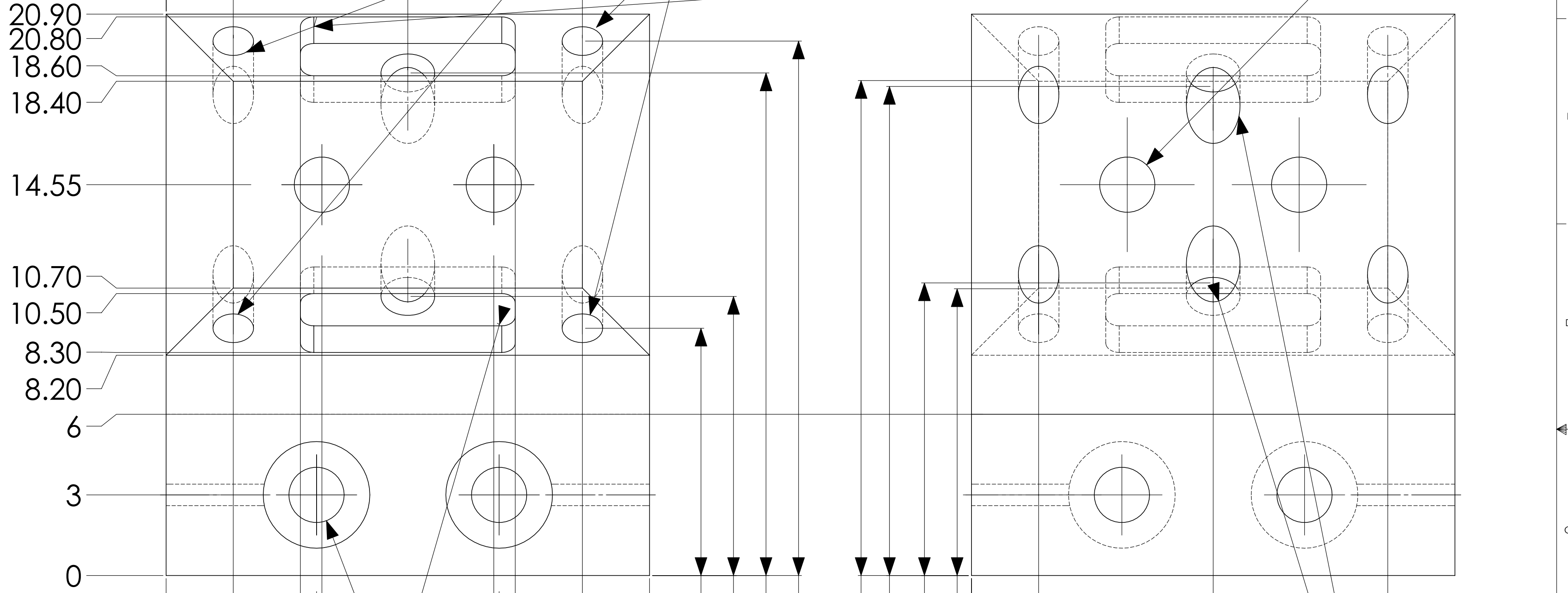

FRONT (9:1)

BACK (9:1)

2X  $\phi$  0.081 inch THRU ALL  
 0.1563 inch  $\nabla$  0.0730 inch  
 (CBORE #1 SOCKET HEAD CAP SCREW)

2x,  $\phi$  2mm  
 STARTING FROM 45deg SURFACE

UNLESS OTHERWISE SPECIFIED:	DRAWN	NAME	DATE	Massachusetts Institute of Technology LIGO project
DIMENSIONS ARE IN mm	Edith Innerhofer		02/2006	
TOLERANCES ARE: $\pm$ 0.05mm	CHECKED			
ANGULAR: $\pm$ .25°	ENG APPR.			
	MFG APPR.			
MATERIAL Aluminum	Q.A.			TITLE: RPI, OSEM-side-base, Rev 01, page 1/3
FINISH 32/	COMMENTS:			SIZE DWG. NO. REV C LIGO-D060027-01-R 01
DO NOT SCALE DRAWING				SCALE: 9:1 WEIGHT: SHEET 1 OF 3

NOTES: (UNLESS OTHERWISE SPECIFIED)  
 1. BREAK ALL SHARP EDGES .01/.02 X 45°  
 2. ALL DIMENSIONS IN MILLIMETER

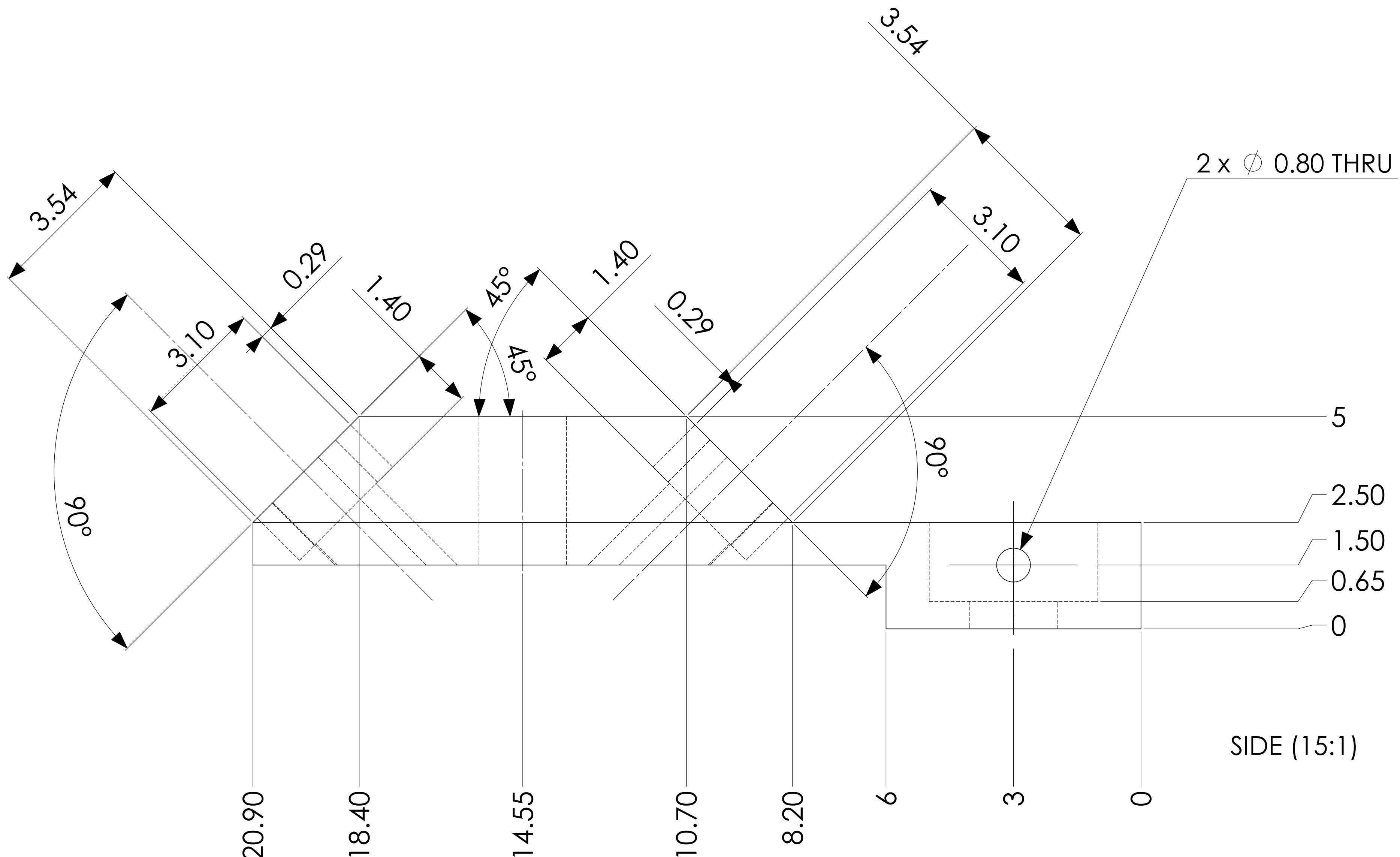

SIDE (15:1)

UNLESS OTHERWISE SPECIFIED:		NAME	DATE	Massachusetts Institute of Technology LIGO project	
DIMENSIONS ARE IN mm		DRAWN	Edith Innerhofer		02/2006
TOLERANCES ARE: ± 0.05mm		CHECKED			
ANGULAR: ± .25°		ENG APPR.			
		MFG APPR.			
MATERIAL Aluminum		Q.A.			
FINISH 32		COMMENTS:		TITLE: RPI, OSEM-side-base, Rev 01, page 2/3	
DO NOT SCALE DRAWING		SIZE	DWG. NO.	REV	
		C	LIGO-D060027-01-R	01	
		SCALE: 9:1	WEIGHT:	SHEET 2 OF 3	

NOTES: (UNLESS OTHERWISE SPECIFIED)  
 1. BREAK ALL SHARP EDGES .01/.02 X 45°  
 2. ALL DIMENSIONS IN MILLIMETER

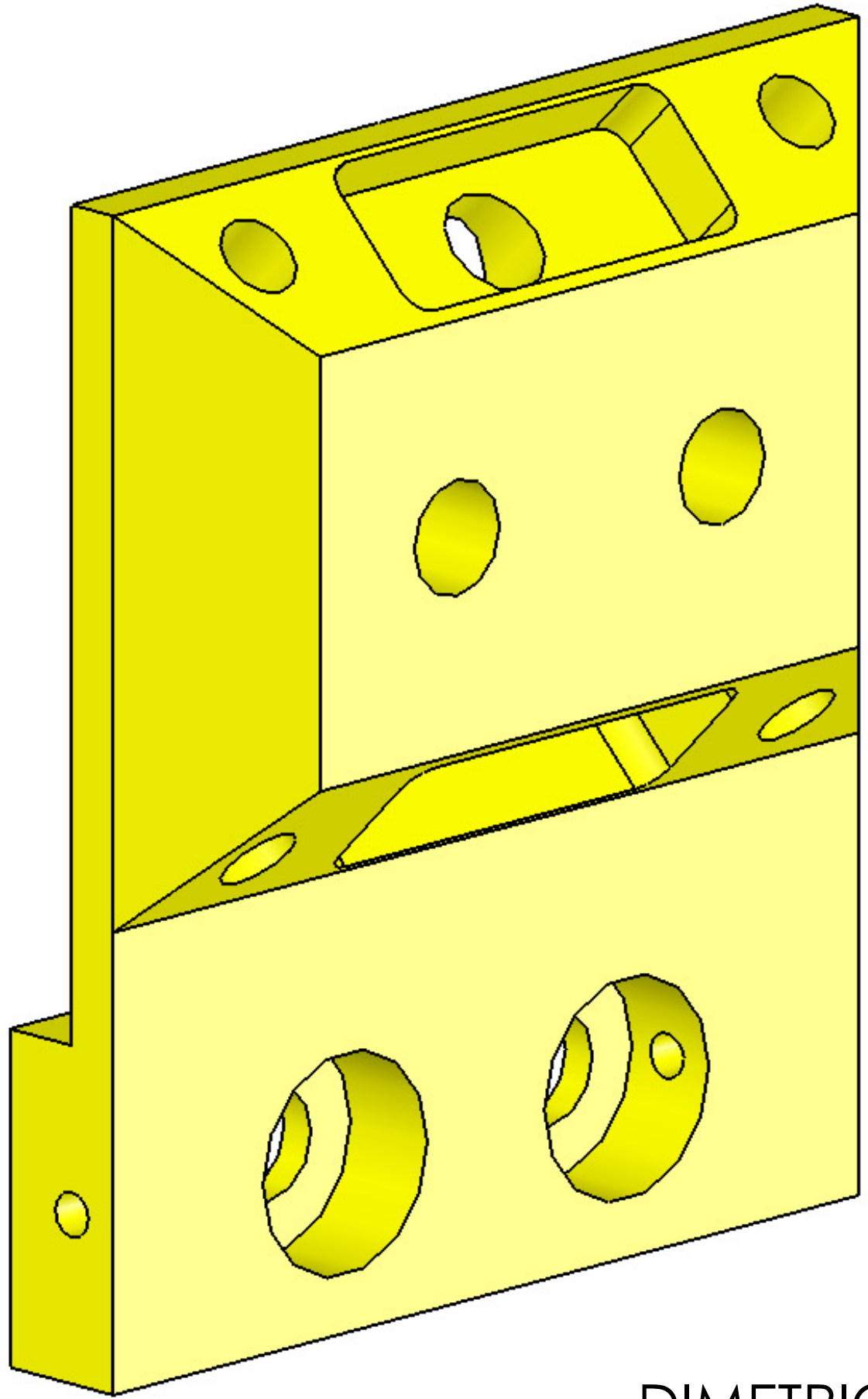

DIMETRIC (10:1)

FILET  
 4x, R 0.50 mm  
 4x, lower extrude

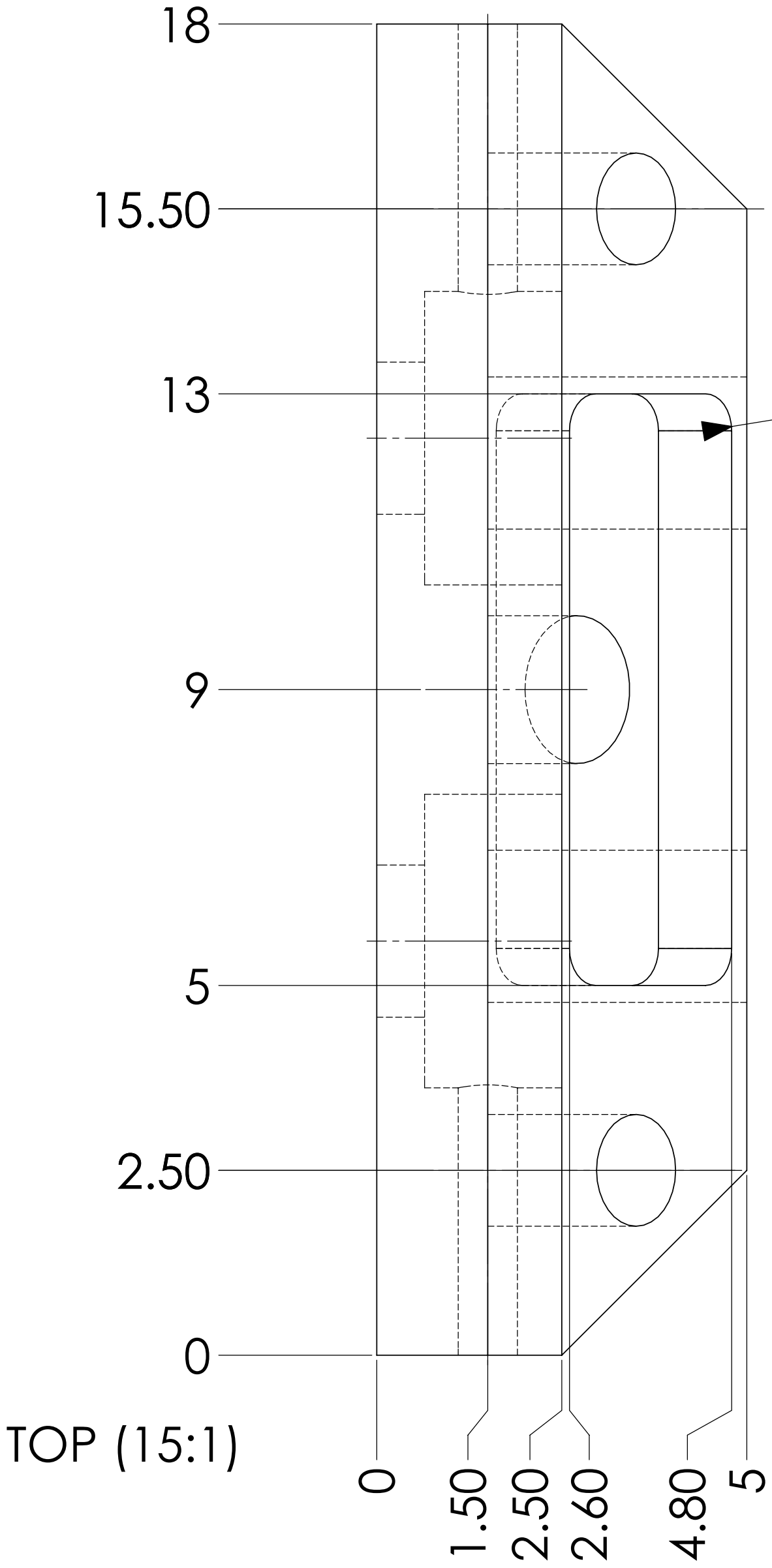

UNLESS OTHERWISE SPECIFIED:		NAME	DATE	Massachusetts Institute of Technology LIGO project	
DIMENSIONS ARE IN mm TOLERANCES ARE: ± 0.05mm ANGULAR: ± .25°		DRAWN Edith Innerhofer	02/2006	TITLE: RPI, OSEM-side-base, Rev 01, page 3/3	
MATERIAL Aluminum		CHECKED		SIZE DWG. NO. REV C LIGO-D060027-01-R 01	
FINISH 32		ENG APPR.		SCALE: 15:1 WEIGHT: 1 SHEET 3 OF 3	
DO NOT SCALE DRAWING		MFG APPR.			
		Q.A.			
		COMMENTS:			