

REV.	DATE	DCN #	DRAWING TREE #
A	1-18-06	LIGO-E060004-00	

NOTES: (UNLESS OTHERWISE SPECIFIED)

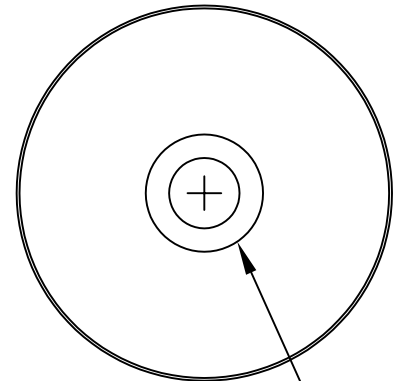

C'BORE .625+/- .015 DIA
X .160+/- .010 DEEP

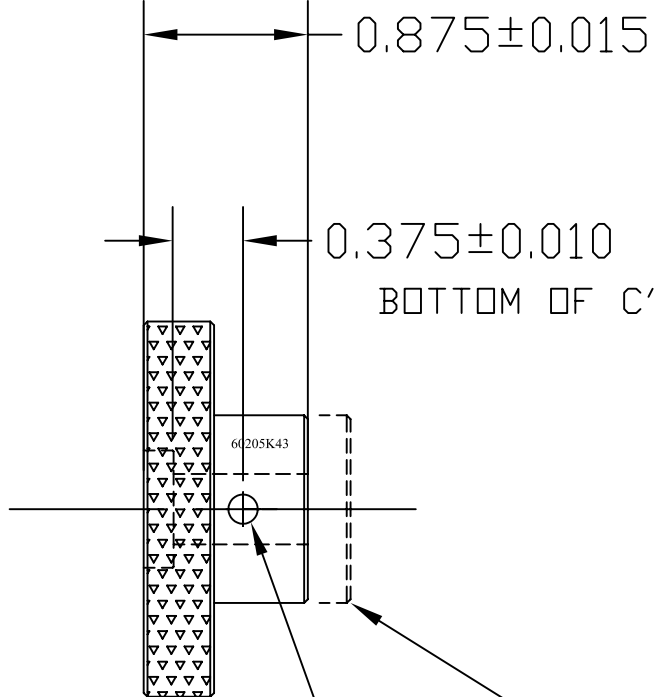

MAKE 1

TRIM TO LENGTH SHOWN

DRILL AND REAM LPF FOR
.156 DIA ROLL PIN THRU
BOTH WALLS INLINE

see assembly for
adjacent part long screw
shaft

ITEM NO.	REQ.	SPARE	TOT.	PART NUMBER	DESCRIPTION	SUPPLIER
PARTS LIST						
UNLESS OTHERWISE SPECIFIED:				DATE	NAME	LIGO CALIFORNIA INSTITUTE OF TECHNOLOGY MASSACHUSETTS INSTITUTE OF TECHNOLOGY
DIMENSIONS ARE IN INCHES				DRAWN 2/11/06	KENM	
TOLERANCES:				CHECKED		SYSTEM LASTI
.XX±:						SUB-SYSTEM QUAD SUSPENSION
.XXX±:						NEXT ASSY D060145-A
ANGULAR±:						PART NAME ROTATION KNOB MOD SHORT C'BORE
MATERIAL				COMMENTS:		SIZE DWG. NO. REV
MCMaster #60205K43 303 stainless w/.37 hole thru						B D060013-A
FINISH						SCALE: SHEET 1 OF 1
N/A						FILE NAME/LOCATION: D060013-A