

215

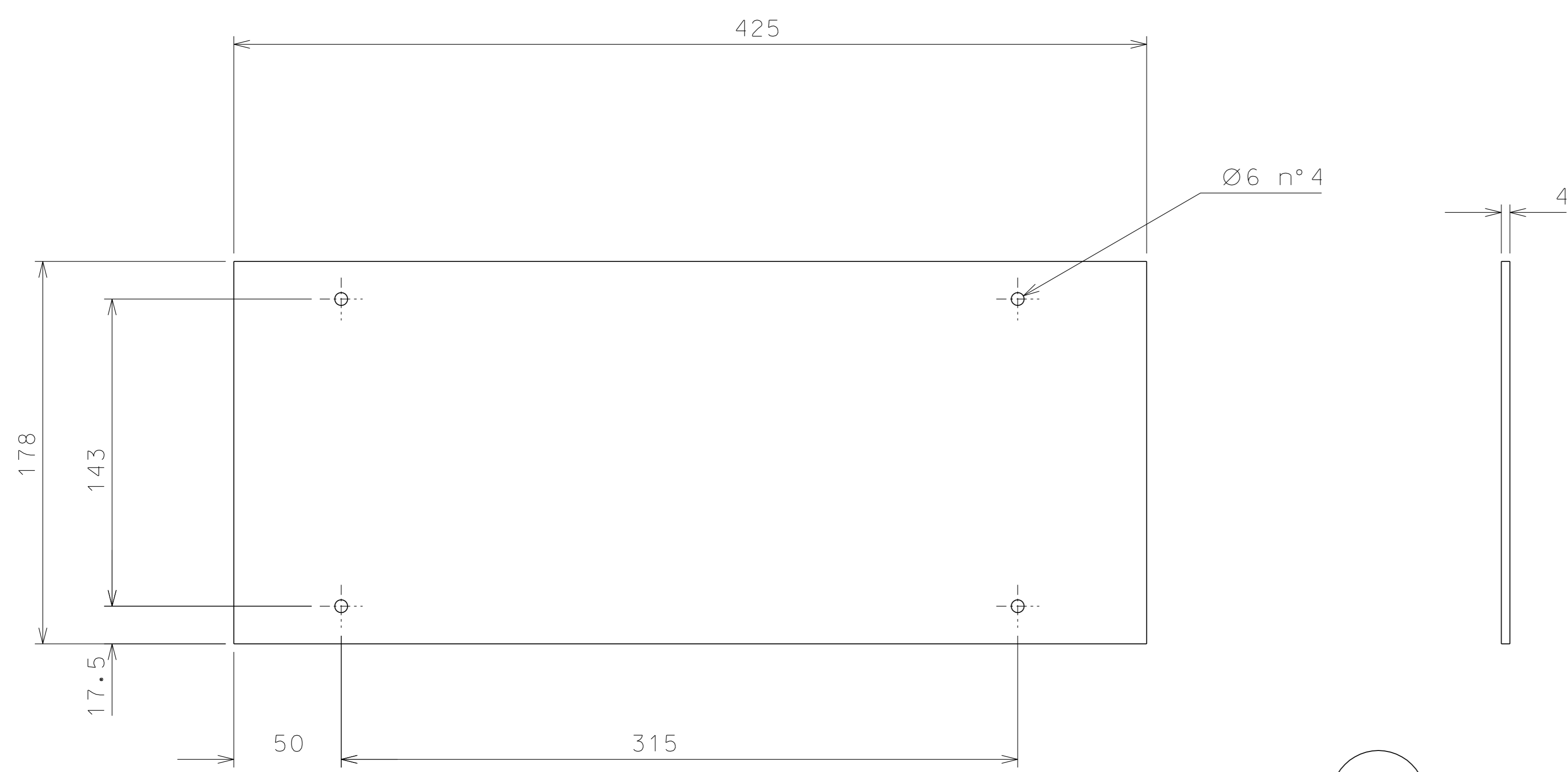

204

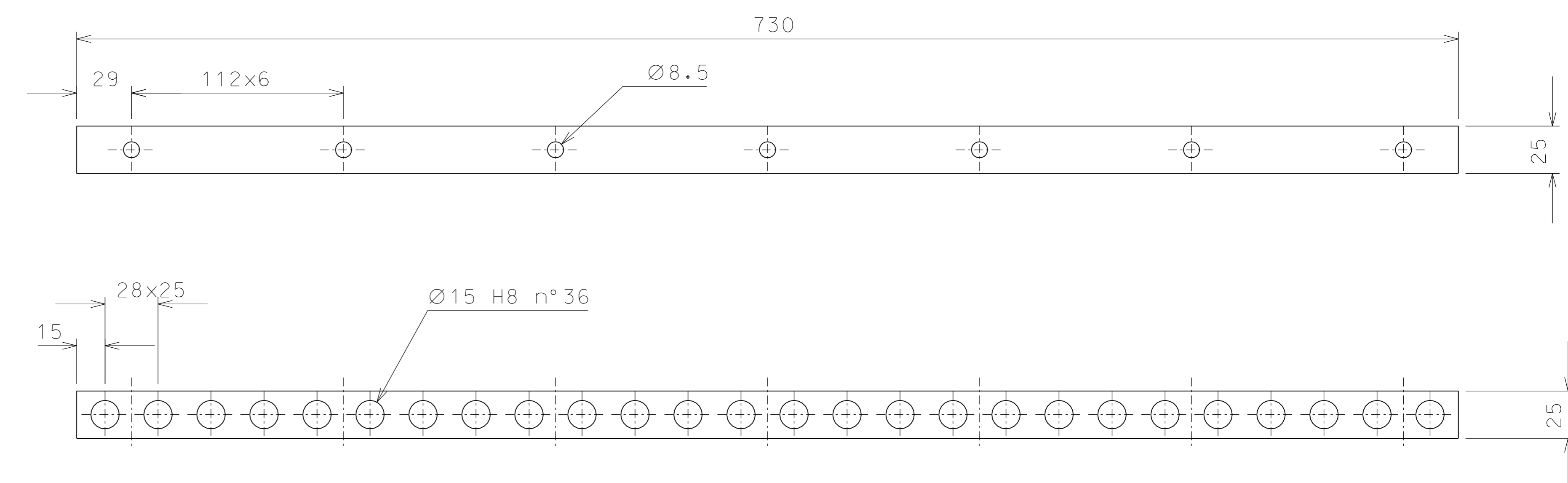

209

Nichel flaching

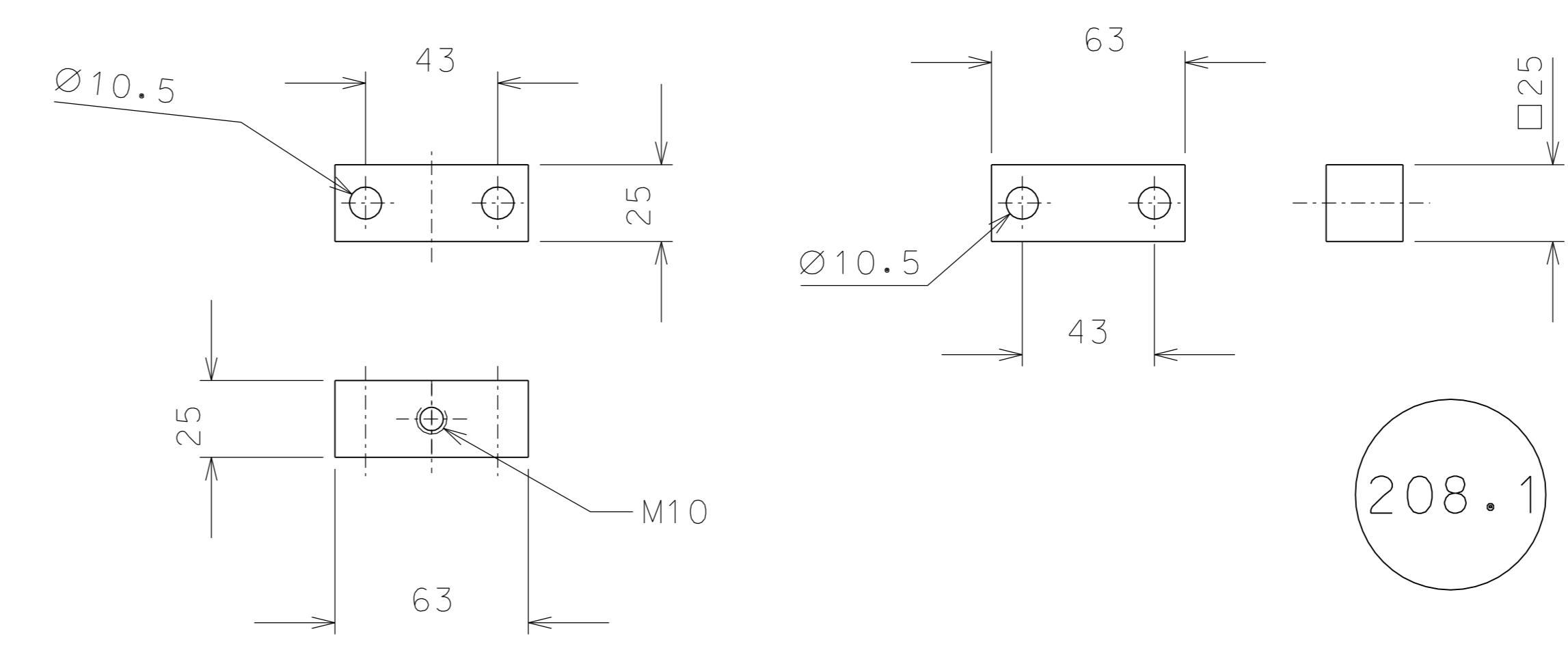

208

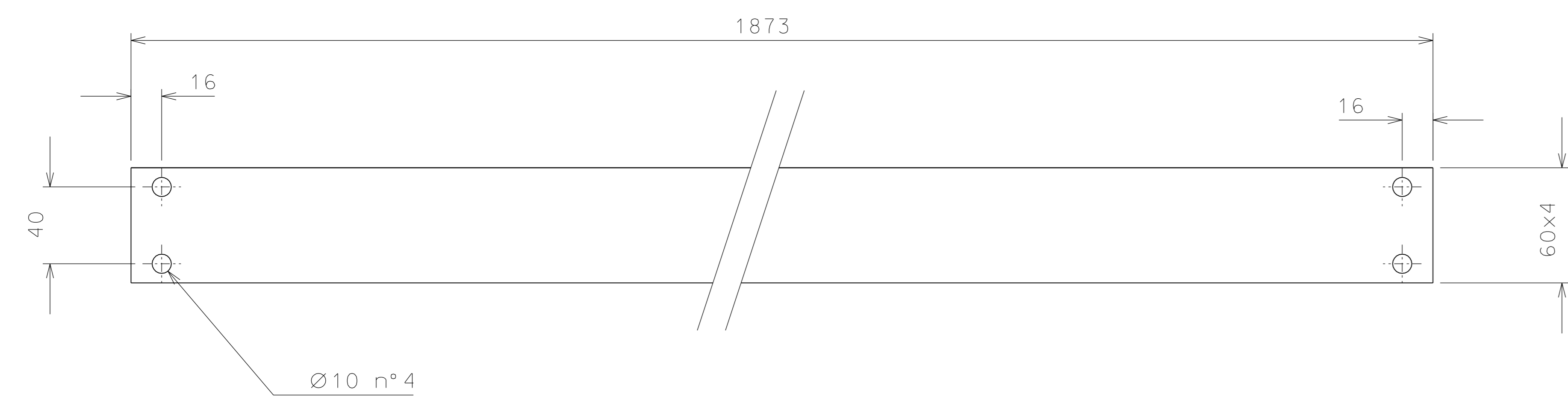

216

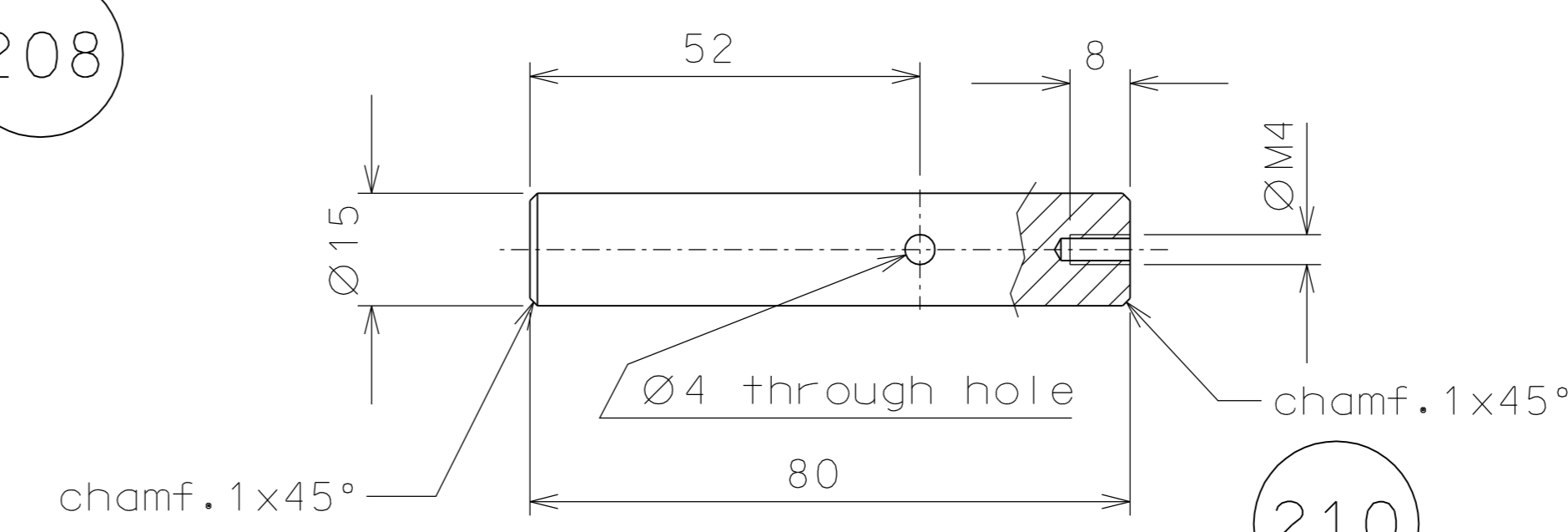

210

Nichel flaching

ref.	note	date	signature
	modified parts 209-210	06-11-06	
	replaced some parts	12-10-06	
modifications			
210	4 C40	1/1.2	
209	4 Fe 360	1/2.5	
208.1	8 AISI 304	1/2.5	
208	4 AISI 304	1/2.5	216 1 EN 6082 1/2.5
204	4 EN 6082	1/2.5	215 4 EN 6082 1/2.5
ref.	pieces	mat. and treatments	scale

General machining tolerances UNI 5307-63							
Dimensions	< 6	> 6-30	> 30-120	> 120-315	> 315-1000	> 1000-2000	> 2000-4000
linear Toli.	± 0.1	± 0.2	± 0.3	± 0.5	± 0.8	± 1.2	± 2
angular Toli.	± 1	± 30'	± 20'	± 10' referred to the shortest side			

designed for		R.De Salvo	
draw. by		G. Gennaro-PROMEC	
date	12-10-06	scale	1/2.5
title		LIGO PROJECT	
HAM OPTICAL BENCH		LIGO-D051205-02-D	
ELEVATOR		detail from	188-192 A 1