

124
welded
(saldato)

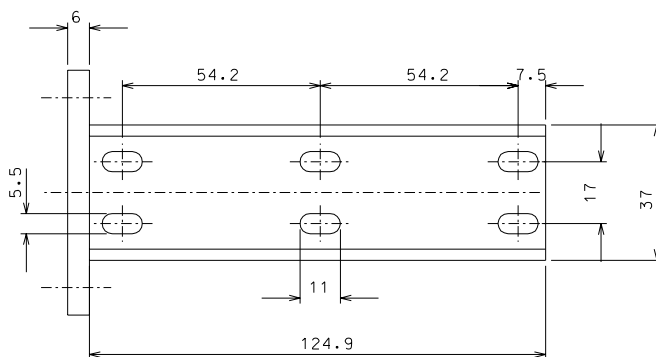
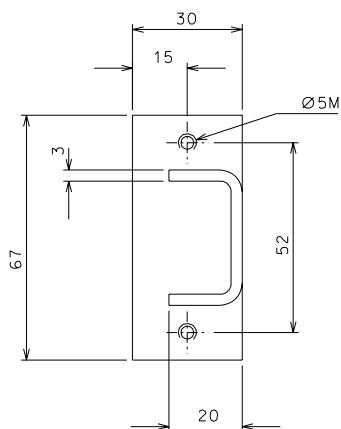

129
welded
(saldato)

ref.	note	date	signature				
modifications							
129	4	AISI 304	1:1				
124	4	AISI 304	1:1				
ref.	pieces	mat. and treatments	scale	ref.	pieces	mat. and treatments	scale

General machining tolerances UNI 5307-63								
Dimensions	< 6	6-30	30-120	120-315	315-1000	>1000-2000	>2000-4000	>4000
Linear Toli.	± 0.1	± 0.2	± 0.3	± 0.5	± 0.8	± 1.2	± 2	± 3
angular Toli.	± 1'	± 30'	± 20'	± 10'				
referred to the shortest side								
designed for			R.De Salvo					
draw. by			G. Gennaro-PROMEC					
date			6-01-05		scale		1/1	
title			HAM-OPTICAL BENCH					
			ACTUATOR					
LIGO PROJECT			LIGO-D051134-00-D		detail		111	
					A		2	