

LTR		ZONE	DESCRIPTION	REVISIONS										
DWN	CHK	ENGR	STRESS	MATL	THRM	ME	PROJ	QA	RELEASE DATE					
A														

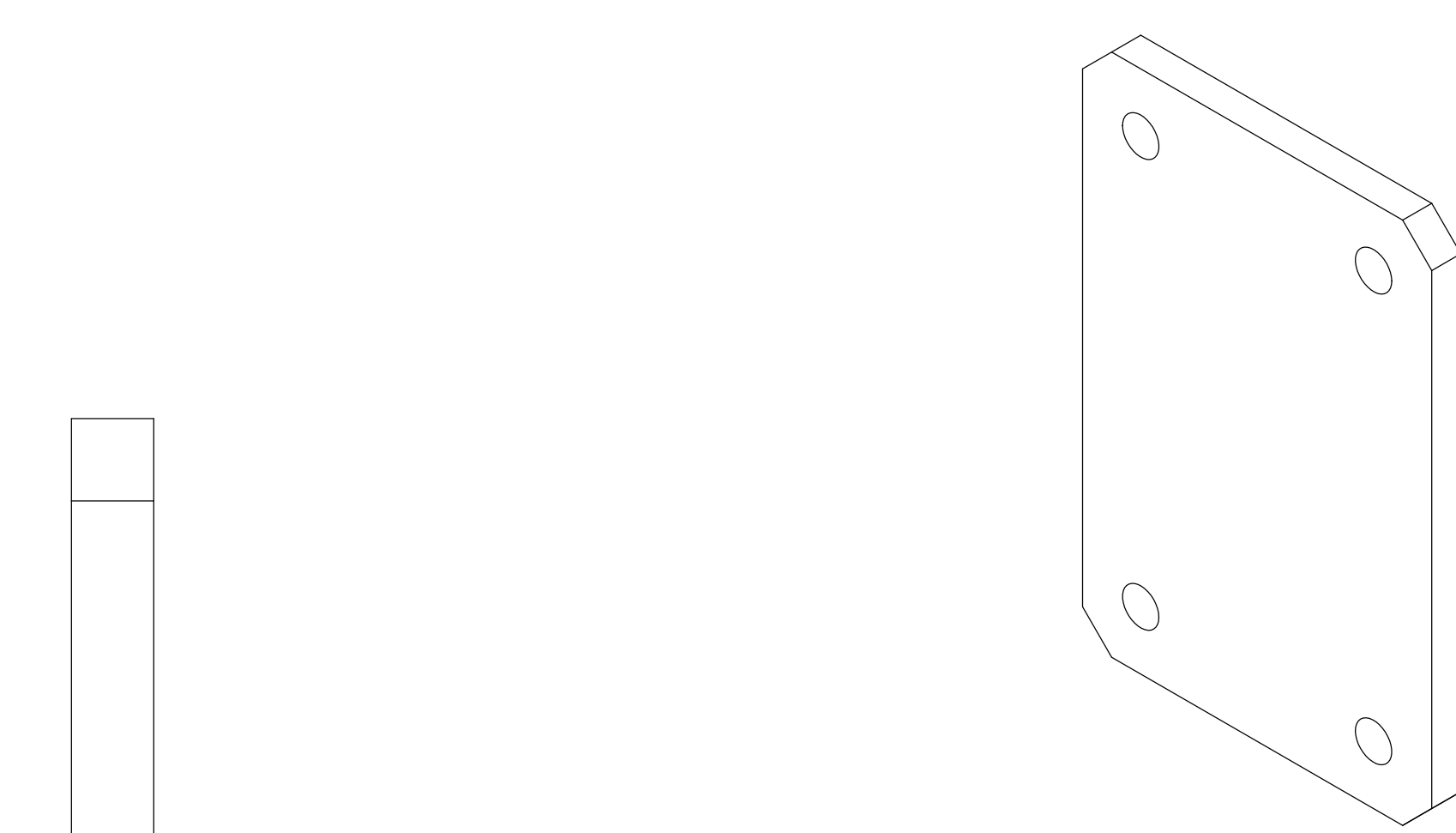
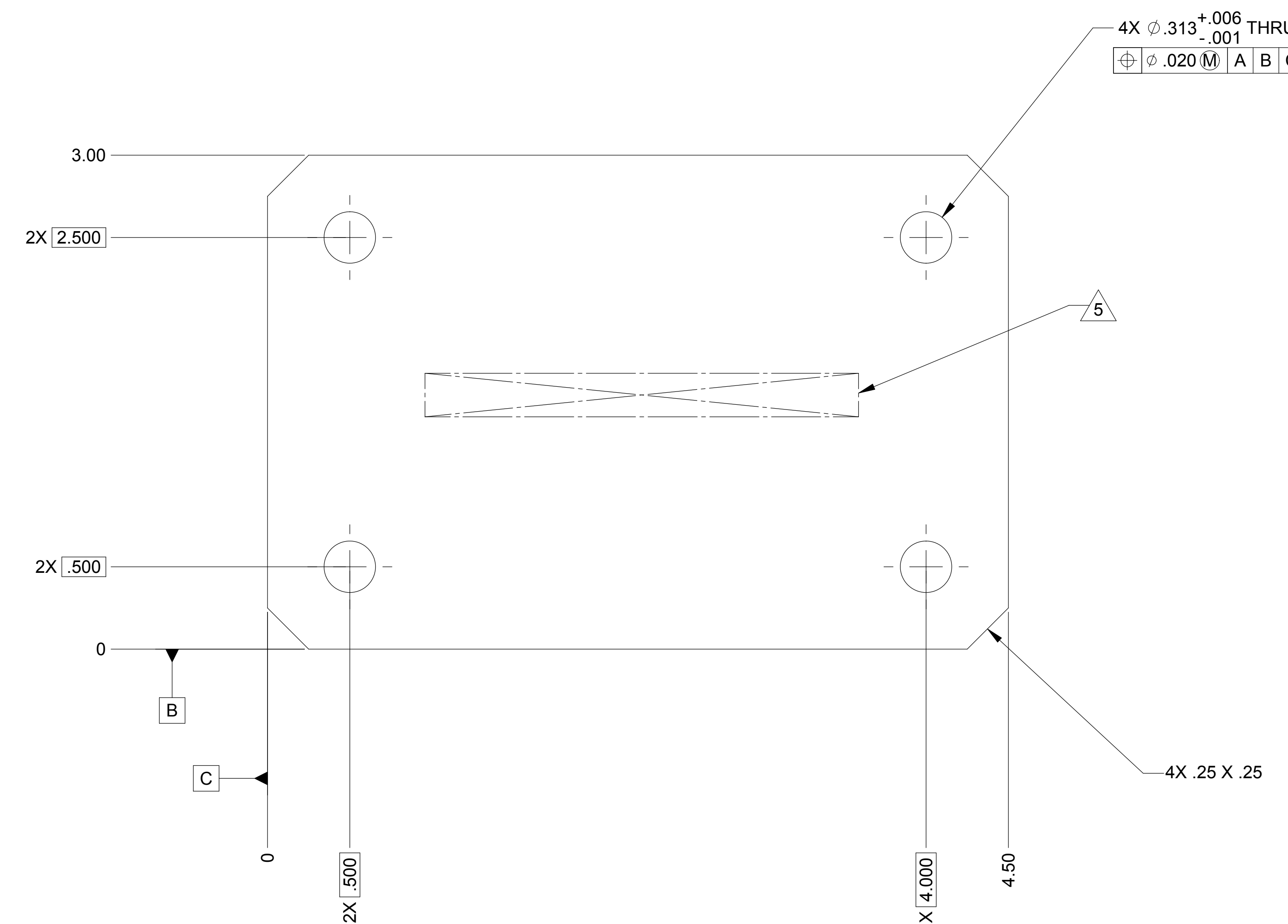

NOTES: UNLESS OTHERWISE SPECIFIED.

- ALL PARTS SHALL BE MANUFACTURED IN ACCORDANCE WITH ASI SPECIFICATION 20008225 (LIGO E048225).
- REMOVE ALL BURRS AND SHARP EDGES .005-.015.
- MACHINE FILLET RADII .003-.015.
- COUNTERSINK 82° ALL DRILLED HOLES .015-.030 DEEP BOTH SIDES.
- MARK PART AND SERIAL NUMBER IN LOCATION APPROXIMATELY SHOWN USING 0.13 INCH HIGH CHARACTERS IN ACCORDANCE WITH 20006686, TYPE I, CLASSES 4, 5, OR 6. SERIAL NUMBERS START AT 001 FOR FIRST PART AND THEN PROCEED CONSECUTIVELY. PARTS TOO SMALL TO MARK SHALL BE IDENTIFIED IN ACCORDANCE WITH 20006686, TYPE II.
- RECORD WEIGHT TO NEAREST 0.1 LB ON INSPECTION REPORT AFTER FINAL MACHINING. ESTIMATED WEIGHT IS 0.3 LBS.

THIS DOCUMENT MAY CONTAIN ITAR CONTROLLED INFORMATION AND/OR COMMERCE CONTROLLED INFORMATION EXPORT RESTRICTIONS MAY APPLY

FILE ATTACHMENTS  
20007868.x\_t

QTY REQD		ITEM NO	REF DES	CAGE NO	20007868-1	PART OR IDENTIFYING NO	NOMENCLATURE OR DESCRIPTION	SPECIFICATION	MATERIAL OR NOTE	ZONE
CONTRACT NO						UNLESS OTHERWISE SPECIFIED DIMENSIONS ARE IN INCHES TOLERANCES DECIMALS .XX ±.03 .XXX ±.010 ANGLES ± 1/2° MACHINE FINISH 125/ DO NOT SCALE DRAWING INTERPRET DWG PER ASME Y14.5M-1994 MATERIAL 7075-T651 AL ALLY PER QQ-A-250/12				
20007970						7075-T651 AL ALLY PER QQ-A-250/12				
NEXT ASSEMBLY						PROJECT CODE 1388				
APPLICATION						PARTS LIST				
20007970						7075-T651 AL ALLY PER QQ-A-250/12				
NEXT ASSEMBLY						PROJECT CODE 1388				
APPLICATION						PARTS LIST				
20007970						7075-T651 AL ALLY PER QQ-A-250/12				
NEXT ASSEMBLY						PROJECT CODE 1388				
APPLICATION						PARTS LIST				
20007970						7075-T651 AL ALLY PER QQ-A-250/12				
NEXT ASSEMBLY						PROJECT CODE 1388				
APPLICATION						PARTS LIST				
20007970						7075-T651 AL ALLY PER QQ-A-250/12				
NEXT ASSEMBLY						PROJECT CODE 1388				
APPLICATION						PARTS LIST				
20007970						7075-T651 AL ALLY PER QQ-A-250/12				
NEXT ASSEMBLY						PROJECT CODE 1388				
APPLICATION						PARTS LIST				
20007970						7075-T651 AL ALLY PER QQ-A-250/12				
NEXT ASSEMBLY						PROJECT CODE 1388				
APPLICATION						PARTS LIST				
20007970						7075-T651 AL ALLY PER QQ-A-250/12				
NEXT ASSEMBLY						PROJECT CODE 1388				
APPLICATION						PARTS LIST				
20007970						7075-T651 AL ALLY PER QQ-A-250/12				
NEXT ASSEMBLY						PROJECT CODE 1388				
APPLICATION						PARTS LIST				
20007970						7075-T651 AL ALLY PER QQ-A-250/12				
NEXT ASSEMBLY						PROJECT CODE 1388				
APPLICATION						PARTS LIST				
20007970						7075-T651 AL ALLY PER QQ-A-250/12				
NEXT ASSEMBLY						PROJECT CODE 1388				
APPLICATION						PARTS LIST				
20007970						7075-T651 AL ALLY PER QQ-A-250/12				
NEXT ASSEMBLY						PROJECT CODE 1388				
APPLICATION						PARTS LIST				
20007970						7075-T651 AL ALLY PER QQ-A-250/12				
NEXT ASSEMBLY						PROJECT CODE 1388				
APPLICATION						PARTS LIST				
20007970						7075-T651 AL ALLY PER QQ-A-250/12				
NEXT ASSEMBLY						PROJECT CODE 1388				
APPLICATION						PARTS LIST				
20007970						7075-T651 AL ALLY PER QQ-A-250/12				
NEXT ASSEMBLY						PROJECT CODE 1388				
APPLICATION						PARTS LIST				
20007970						7075-T651 AL ALLY PER QQ-A-250/12				
NEXT ASSEMBLY						PROJECT CODE 1388				
APPLICATION						PARTS LIST				
20007970						7075-T651 AL ALLY PER QQ-A-250/12				
NEXT ASSEMBLY						PROJECT CODE 1388				
APPLICATION						PARTS LIST				
20007970						7075-T651 AL ALLY PER QQ-A-250/12				
NEXT ASSEMBLY						PROJECT CODE 1388				
APPLICATION						PARTS LIST				
20007970						7075-T651 AL ALLY PER QQ-A-250/12				
NEXT ASSEMBLY						PROJECT CODE 1388				
APPLICATION						PARTS LIST				
20007970						7075-T651 AL ALLY PER QQ-A-250/12				
NEXT ASSEMBLY						PROJECT CODE 1388				
APPLICATION						PARTS LIST				
20007970						7075-T651 AL ALLY PER QQ-A-250/12				
NEXT ASSEMBLY						PROJECT CODE 1388				
APPLICATION						PARTS LIST				
20007970						7075-T651 AL ALLY PER QQ-A-250/12				
NEXT ASSEMBLY						PROJECT CODE 1388				
APPLICATION						PARTS LIST				
20007970						7075-T651 AL ALLY PER QQ-A-250/12				
NEXT ASSEMBLY						PROJECT CODE 1388				
APPLICATION						PARTS LIST				
20007970						7075-T651 AL ALLY PER QQ-A-250/12				
NEXT ASSEMBLY						PROJECT CODE 1388				
APPLICATION						PARTS LIST				
20007970						7075-T651 AL ALLY PER QQ-A-250/12				
NEXT ASSEMBLY						PROJECT CODE 1388				
APPLICATION						PARTS LIST				
20007970						7075-T651 AL ALLY PER QQ-A-250/12				
NEXT ASSEMBLY						PROJECT CODE 1388				
APPLICATION						PARTS LIST				
20007970						7075-T651 AL ALLY PER QQ-A-250/12				
NEXT ASSEMBLY						PROJECT CODE 1388				
APPLICATION						PARTS LIST				
20007970						7075-T651 AL ALLY PER QQ-A-250/12				
NEXT ASSEMBLY						PROJECT CODE 1388				
APPLICATION						PARTS LIST				
20007970						7075-T651 AL ALLY PER QQ-A-250/12				
NEXT ASSEMBLY						PROJECT CODE 1388				
APPLICATION						PARTS LIST				
20007970						7075-T651 AL ALLY PER QQ-A-250/12				
NEXT ASSEMBLY						PROJECT CODE 1388				
APPLICATION						PARTS LIST				
20007970						7075-T651 AL ALLY PER QQ-A-250/12				
NEXT ASSEMBLY						PROJECT CODE 1388				
APPLICATION						PARTS LIST				
20007970						7075-T651 AL ALLY PER QQ-A-250/12				
NEXT ASSEMBLY						PROJECT CODE 1388				
APPLICATION						PARTS LIST				
20007970						7075-T651 AL ALLY PER QQ-A-250/12				
NEXT ASSEMBLY						PROJECT CODE 1388				
APPLICATION						PARTS LIST				
20007970						7075-T651 AL ALLY PER QQ-A-250/12				
NEXT ASSEMBLY						PROJECT CODE 1388				
APPLICATION						PARTS LIST				
20007970						7075-T651 AL ALLY PER QQ-A-250/12				
NEXT ASSEMBLY						PROJECT CODE 1388				
APPLICATION						PARTS LIST				
20007970						7075-T651 AL ALLY PER QQ-A-250/12				
NEXT ASSEMBLY						PROJECT CODE 1388				
APPLICATION						PARTS LIST				
20007970						7075-T651 AL ALLY PER QQ-A-250/12				
NEXT ASSEMBLY						PROJECT CODE 1388				
APPLICATION						PARTS LIST				
20007970						7075-T651 AL ALLY PER QQ-A-250/12				
NEXT ASSEMBLY						PROJECT CODE 1388				
APPLICATION						PARTS LIST				
20007970						7075-T651 AL ALLY PER QQ-A-250/12				
NEXT ASSEMBLY						PROJECT CODE 1388				
APPLICATION						PARTS LIST				
20007970						7075-T651 AL ALLY PER QQ-A-250/12				
NEXT ASSEMBLY						PROJECT CODE 1388				
APPLICATION						PARTS LIST				
20007970						7075-T651 AL ALLY PER QQ-A-250/12				
NEXT ASSEMBLY						PROJECT CODE 1388				
APPLICATION						PARTS LIST				
20007970						7075-T651 AL ALLY PER QQ-A-250/12				
NEXT ASSEMBLY						PROJECT CODE 1388				
APPLICATION						PARTS LIST				
20007970						7075-T651 AL ALLY PER QQ-A-250/12				
NEXT ASSEMBLY						PROJECT CODE 1388				
APPLICATION						PARTS LIST				
20007970						7075-T651 AL ALLY PER QQ-A-250/12				
NEXT ASSEMBLY						PROJECT CODE 1388				
APPLICATION						PARTS LIST				
20007970						7075-T651 AL ALLY PER QQ-A-250/12				
NEXT ASSEMBLY						PROJECT CODE 1388				
APPLICATION						PARTS LIST				
20007970						7075-T651 AL ALLY PER QQ-A-250/12				
NEXT ASSEMBLY						PROJECT CODE 1388				
APPLICATION						PARTS LIST				
20007970						7075-T651 AL ALLY PER QQ-A-250/12				
NEXT ASSEMBLY						PROJECT CODE 1388				
APPLICATION						PARTS LIST				
20007970						7075-T651 AL ALLY PER QQ-A-250/12				
NEXT ASSEMBLY						PROJECT CODE 1388				
APPLICATION						PARTS LIST				
20007970						7075-T651 AL ALLY PER QQ-A-250/12				
NEXT ASSEMBLY						PROJECT CODE 1388				
APPLICATION						PARTS LIST				
20007970						7075-T651 AL ALLY PER QQ-A-250/12				
NEXT ASSEMBLY						PROJECT CODE 1388				
APPLICATION						PARTS LIST				
20007970						7075-T651 AL ALLY PER QQ-A-250/12				
NEXT ASSEMBLY						PROJECT CODE 1388				
APPLICATION						PARTS LIST				
20007970						7075-T651 AL ALLY PER QQ-A-250/12				
NEXT ASSEMBLY						PROJECT CODE 1388				
APPLICATION						PARTS LIST				
20007970						7075-T651 AL ALLY PER QQ-A-250/12				
NEXT ASSEMBLY						PROJECT CODE 1388				
APPLICATION						PARTS LIST				
20007970						7075-T651 AL ALLY PER QQ-A-250/12				
NEXT ASSEMBLY						PROJECT CODE 1388				
APPLICATION						PARTS LIST				
20007970						7075-T651 AL ALLY PER QQ-A-250/12				
NEXT ASSEMBLY						PROJECT CODE 1388				
APPLICATION						PARTS LIST				
20007970						7075-T651 AL ALLY PER QQ-A-250/12				
NEXT ASSEMBLY						PROJECT CODE 1388				
APPLICATION						PARTS LIST				
20007970						7075-T651 AL ALLY PER QQ-A-250/12				
NEXT ASSEMBLY						PROJECT CODE 1388				
APPLICATION						PARTS LIST				
20007970						7075-T651 AL ALLY PER QQ-A-250/12				
NEXT ASSEMBLY						PROJECT CODE 1388				
APPLICATION						PARTS LIST				
20007970						7075-T651 AL ALLY PER QQ-A-250/12				
NEXT ASSEMBLY						PROJECT CODE 1388				
APPLICATION						PARTS LIST				
20007970						7075-T651 AL ALLY PER QQ-A-250/12				
NEXT ASSEMBLY						PROJECT CODE 1388				
APPLICATION						PARTS LIST				
20007970						7075-T651 AL ALLY PER QQ-A-250/12				
NEXT ASSEMBLY						PROJECT CODE 1388				
APPLICATION						PARTS LIST				
20007970						7075-T651 AL ALLY PER QQ-A-250/12				
NEXT ASSEMBLY						PROJECT CODE 1388				
APPLICATION						PARTS LIST				
20007970						7075-T651 AL ALLY PER QQ-A-250/12				
NEXT ASSEMBLY						PROJECT CODE 1388				
APPLICATION						PARTS LIST				
20007970						7075-T651 AL ALLY PER QQ-A-250/12				
NEXT ASSEMBLY						PROJECT CODE 1388				
APPLICATION						PARTS LIST				
20007970						7075-T651 AL ALLY PER QQ-A-250/12				
NEXT ASSEMBLY						PROJECT CODE 1388				
APPLICATION						PARTS LIST				
20007970						7075-T651 AL ALLY PER QQ-A-250/12				
NEXT ASSEMBLY						PROJECT CODE 1388				
APPLICATION						PARTS LIST				
20007970						7075-T651 AL ALLY PER QQ-A-250/12				
NEXT ASSEMBLY						PROJECT CODE 1388				
APPLICATION						PARTS LIST				
20007970						7075-T651 AL ALLY PER QQ-A-250/12				
NEXT ASSEMBLY						PROJECT CODE 1388				
APPLICATION						PARTS LIST				
20007970						7075-T651 AL ALLY PER QQ-A-250/12				
NEXT ASSEMBLY						PROJECT CODE 1388				
APPLICATION						PARTS LIST				
20007970						7075-T651 AL ALLY PER QQ-A-250/12				
NEXT ASSEMBLY						PROJECT CODE 1388				
APPLICATION						PARTS LIST				
20007970						7075-T651 AL ALLY PER QQ-A-250/12				
NEXT ASSEMBLY						PROJECT CODE 1388				
APPLICATION						PARTS LIST				
20007970						7075-T651 AL ALLY PER QQ-A-250/12				
NEXT ASSEMBLY						PROJECT CODE 1388				
APPLICATION						PARTS LIST				
20007970						7075-T651 AL ALLY PER QQ-A-250/12				
NEXT ASSEMBLY						PROJECT CODE 1388				
APPLICATION						PARTS LIST				
20007970						7075-T651 AL ALLY PER QQ-A-250/12				
NEXT ASSEMBLY						PROJECT CODE 1388				
APPLICATION						PARTS LIST				
20007970						7075-T651 AL ALLY PER QQ-A-250/12				
NEXT ASSEMBLY						PROJECT CODE 1388				
APPLICATION						PARTS LIST				
20007970						7075-T651 AL ALLY PER QQ-A-250/12				
NEXT ASSEMBLY						PROJECT CODE 1388				
APPLICATION						PARTS LIST				
20007970						7075-T651 AL ALLY PER QQ-A-250/12				
NEXT ASSEMBLY						PROJECT CODE 1388				
APPLICATION						PARTS LIST				
20007970						7075-T651 AL ALLY PER QQ-A-250/12				
NEXT ASSEMBLY						PROJECT CODE 1388				
APPLICATION						PARTS LIST				
20007970						7075-T651 AL ALLY PER QQ-A-250/12				
NEXT ASSEMBLY						PROJECT CODE 1388				
APPLICATION						PARTS LIST				
20007970						7075-T651 AL ALLY PER QQ-A-250/12				
NEXT ASSEMBLY						PROJECT CODE 1388				
APPLICATION						PARTS LIST				
20007970						7075-T651 AL ALLY PER QQ-A-250/12				
NEXT ASSEMBLY						PROJECT CODE 1388				
APPLICATION						PARTS LIST				
20007970						7075-T651 AL ALLY PER QQ-A-250/12				
NEXT ASSEMBLY						PROJECT CODE 1388				
APPLICATION						PARTS LIST				
20007970						7075-T651 AL ALLY PER QQ-A-250/12				
NEXT ASSEMBLY						PROJECT CODE 1388				
APPLICATION						PARTS LIST				
20007970						7075-T651 AL ALLY PER QQ-A-250/12				
NEXT ASSEMBLY						PROJECT CODE 1388				
APPLICATION						PARTS LIST				
20007970						7075-T651 AL ALLY PER QQ-A-250/12				
NEXT ASSEMBLY						PROJECT CODE 1388				
APPLICATION						PARTS LIST				
20007970						7075-T651 AL ALLY PER QQ-A-250/12				
NEXT ASSEMBLY						PROJECT CODE 1388				
APPLICATION						PARTS LIST				
20007970						7075-T651 AL ALLY PER QQ-A-250/12				
NEXT ASSEMBLY						PROJECT CODE 1388				
APPLICATION						PARTS LIST				
20007970						7075-T651 AL ALLY PER QQ-A-250/12				
NEXT ASSEMBLY						PROJECT CODE 1388				
APPLICATION						PARTS LIST				
20007970						7075-T651 AL ALLY PER QQ-A-250/12				
NEXT ASSEMBLY						PROJECT CODE 1388				
APPLICATION						PARTS LIST				
20007970						7075-T651 AL ALLY PER QQ-A-250/12				
NEXT ASSEMBLY						PROJECT CODE 1388				
APPLICATION						PARTS LIST				
20007970						7075-T651 AL ALLY PER QQ-A-250/12				
NEXT ASSEMBLY						PROJECT CODE 1388				
APPLICATION						PARTS LIST				
20007970						7075-T651 AL ALLY PER QQ-A-250/12				
NEXT ASSEMBLY										