

1

2

3

4

NOTES: (UNLESS OTHERWISE SPECIFIED)

- 1. DIMENSIONS IN INCHES.
- 2. BREAK ALL SHARP EDGES.
- 3. ALL MACHINING FLUIDS SHALL BE WATER SOLUABLE AND FREE OF SULFUR, CHLORINE AND SILICONE, SUCH AS CINCINNATI MILACRON'S CIMTECH 410 (STAINLESS STEEL.)

REV	DATE	DRAWN BY	CHECKED	DCC	DCN/DESCRIPTION
A	9/03	J. Romie			E030462/INITIAL RELEASE

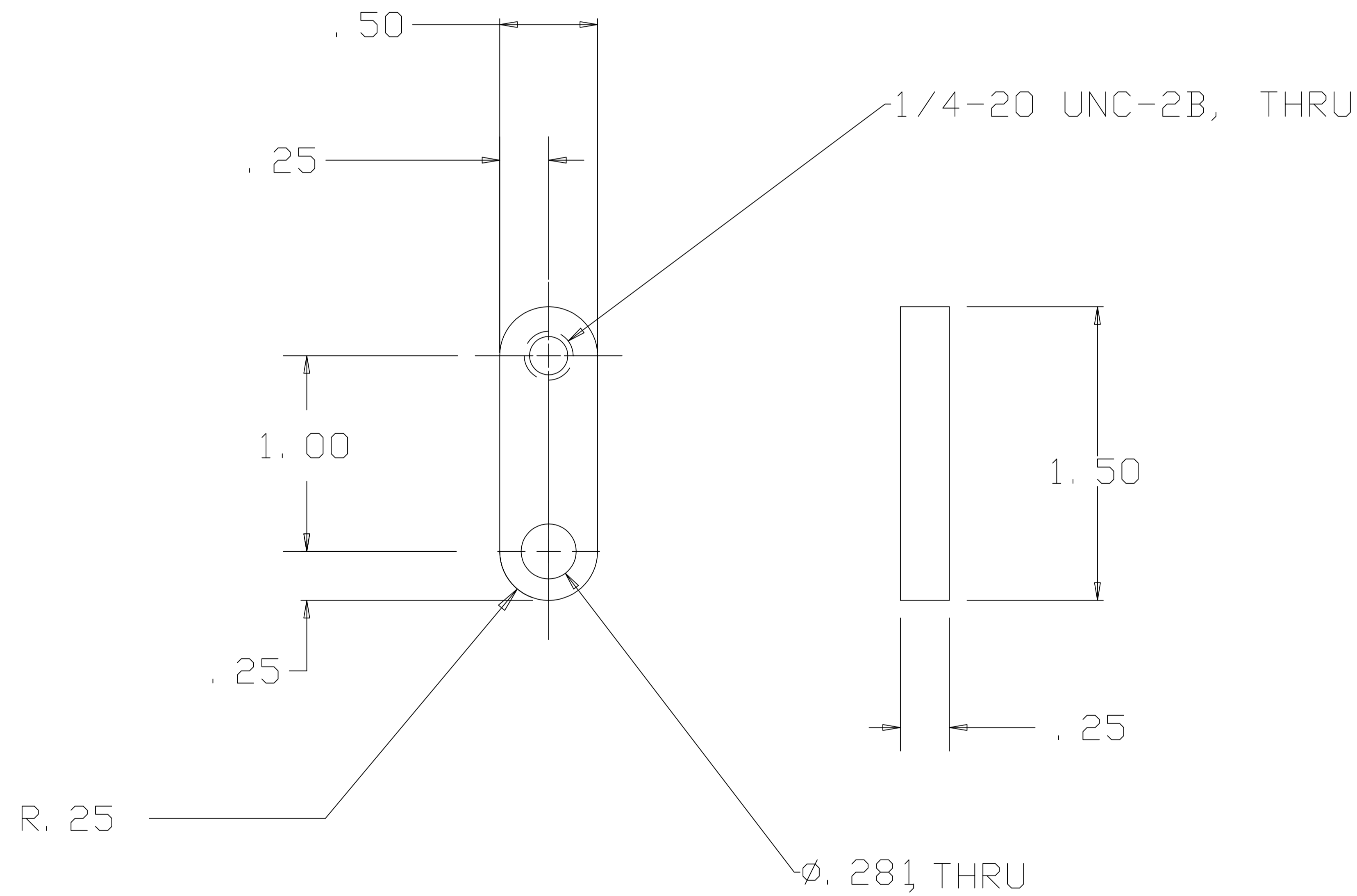

QTY REQD	FSCM NO	PART OR IDENTIFYING NO	NOMENCLATURE OR DESCRIPTION	MATERIAL SPECIFICATION	ITEM NO
PARTS LIST					
UNLESS OTHERWISE SPECIFIED DIMENSIONS ARE IN INCHES TOLERANCES ARE: FRACTIONS DECIMALS 0. XX=±0.01 0. XXX=±0.005 ANGLES=±0.5° DO NOT SCALE DRAWING			APPROVALS DRAWN J. ROMIE CHECKED	DATE 3/03	TITLE GIN GIN ETM FACE BRACKET
NEXT ASSEMBLY D030110			MATERIAL ALUM 6061-T6	DWG NO. D030143	REV A
FILE LOCATION /home/dcc/docs/D030143.pdf			FINISH	SCALE 1/1	SHEET 1 OF 1

1

2

3

4

A

B

C

D

A

B

C

D