

1

2

3

4

NOTES: (UNLESS OTHERWISE SPECIFIED)

- 1. DIMENSIONS IN INCHES.
- 2. BREAK ALL SHARP EDGES.
- 3. ALL MACHINING FLUIDS SHALL BE WATER SOLUABLE AND FREE OF SULFUR, CHLORINE AND SILICONE, SUCH AS CINCINNATI MILACRON'S CIMTECH 410 (STAINLESS STEEL.)
- ④ ETCH OR STAMP THE DRAWING PART NUMBER ON NOTED SURFACE OF PART AND THEN A THREE DIGIT SERIAL NUMBER. SERIAL NUMBERS START AT 001 FOR THE FIRST PART AND PROCEED CONSEQUETIVELY. USE .07" HIGH CHARACTERS. EXAMPLE: ~~D010171-A 001~~
D030112-A 001

REV	DATE	DRAWN BY	CHECKED	DCC	DCN/DESCRIPTION
A	9/03	J. Romie			E030462/INITIAL RELEASE

A

A

B

B

C

C

D

D

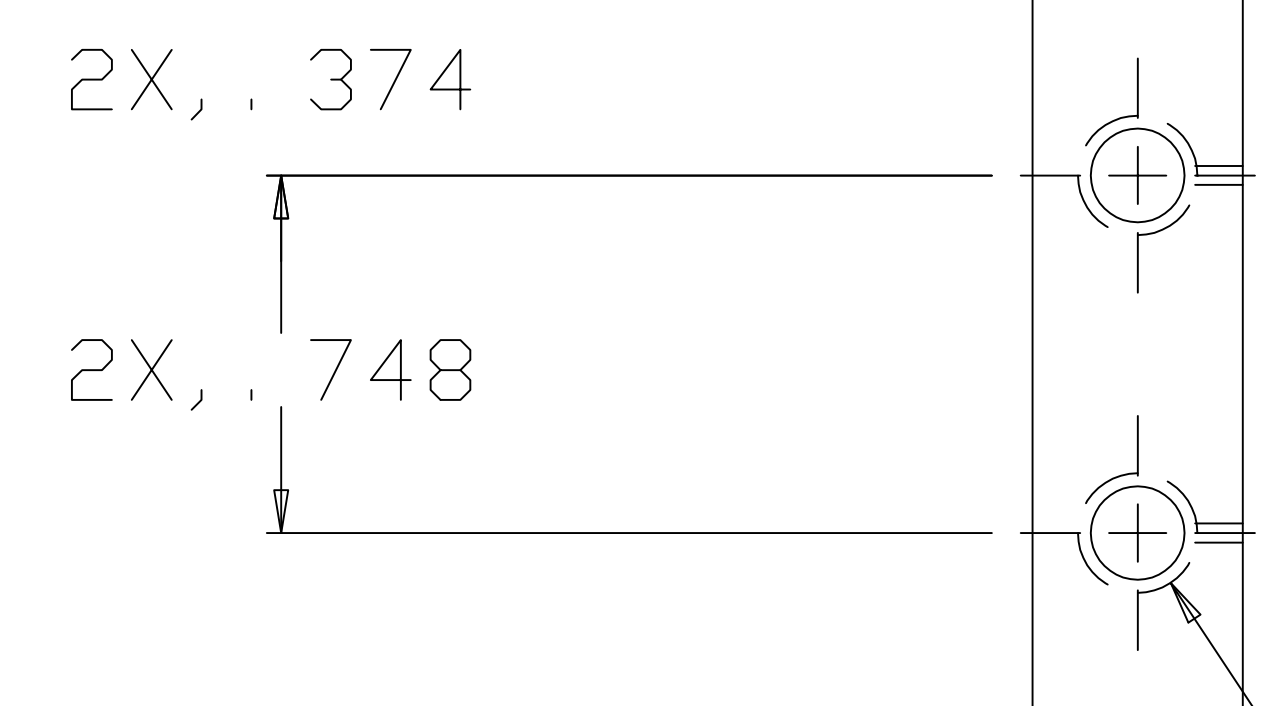
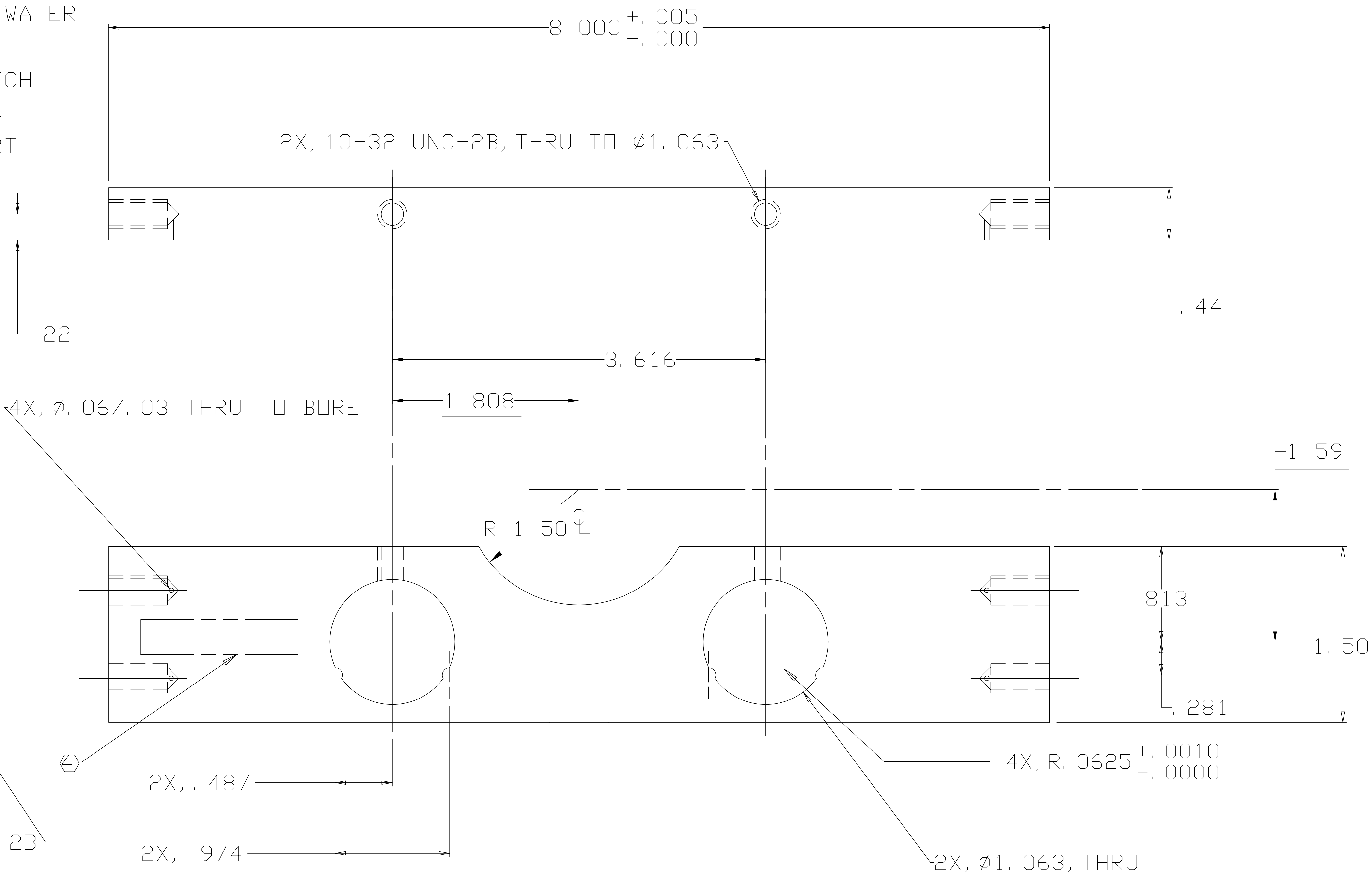

4X, 1/4-20 UNC-2B
√.50 MIN.

QTY REQD	FSCM NO	PART OR IDENTIFYING NO	NOMENCLATURE OR DESCRIPTION	MATERIAL SPECIFICATION	ITEM NO
PARTS LIST					
UNLESS OTHERWISE SPECIFIED DIMENSIONS ARE IN INCHES TOLERANCES ARE:			APPROVALS	DATE	LIGO CALIFORNIA INSTITUTE OF TECHNOLOGY MASSACHUSETTS INSTITUTE OF TECHNOLOGY
FRACTIONS DECIMALS 0.XX=±0.01 0.XXX=±0.005 ANGLES=±0.5°			DRAWN J. ROMIE	3/03	
DO NOT SCALE DRAWING			CHECKED		TITLE GIN GIN ETM HEAD HOLDER, BOTTOM
NEXT ASSEMBLY D030110	MATERIAL 300 SERIES SST	FINISH			DWG NO. D030112
FILE LOCATION /home/dcc/docs/D030112.pdf					REV A
SCALE NTS				SHEET 1 OF 1	

1

2

3

4