

6

5

4

3

2

1

REV	DATE	DRAWN BY	CHECKED	DCC	DCN/DESCRIPTION
A	08-23-02	BILLINGSLEY			E020804-00

- NOTES: (UNLESS OTHERWISE SPECIFIED)
1. ALL DIMENSIONS ARE IN MILLIMETERS AND DEGREE-MINUTES.
 2. DRAWING TO BE INTERPRETED PER ANSI Y14.5M-1982.
 3. POLISH BOTH FACES, PER SPECIFICATION LIGO-E020800.

ETCH OR GRIND 0.25 MM ±0.05MM WIDE × 17MM ±1MM LONG LINE WITH ARROW POINTING TOWARD SURFACE #1, PARALLEL TO -A- WITHIN ±0.10MM, CENTERED BETWEEN SURFACES #1 AND #2, AND AT LOCATION OF MINIMUM PART THICKNESS ±1°0'

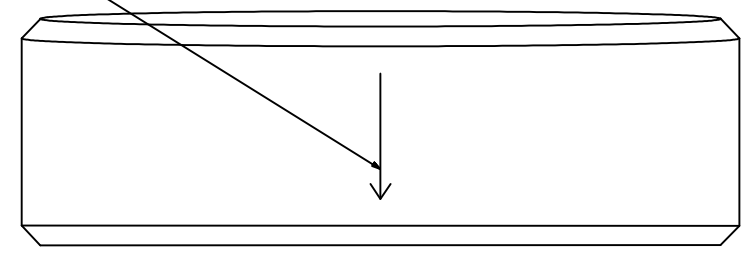

(LOCATION OF MINIMUM THICKNESS)

ETCH OR GRIND 0.25 MM ±0.05MM WIDE × 17MM ±1MM LONG 3× 90°±15' APART FROM LINE WITH ARROW (SEE TOP VIEW) PARALLEL TO -A- WITHIN ±0.10MM, CENTERED BETWEEN SURFACES #1 AND #2

CHAMFER < 2 mm 2 PLACES; AS SUPPLIED

SURFACE #2 (FLAT)

SURFACE #1 (FLAT)

99.34 mm AS SUPPLIED

(-A-)

90° AS SUPPLIED

(-A-)

46 mm NOMINAL FROM THEORETICAL SHARP CORNER

300 ± 50 MICRORADIANS

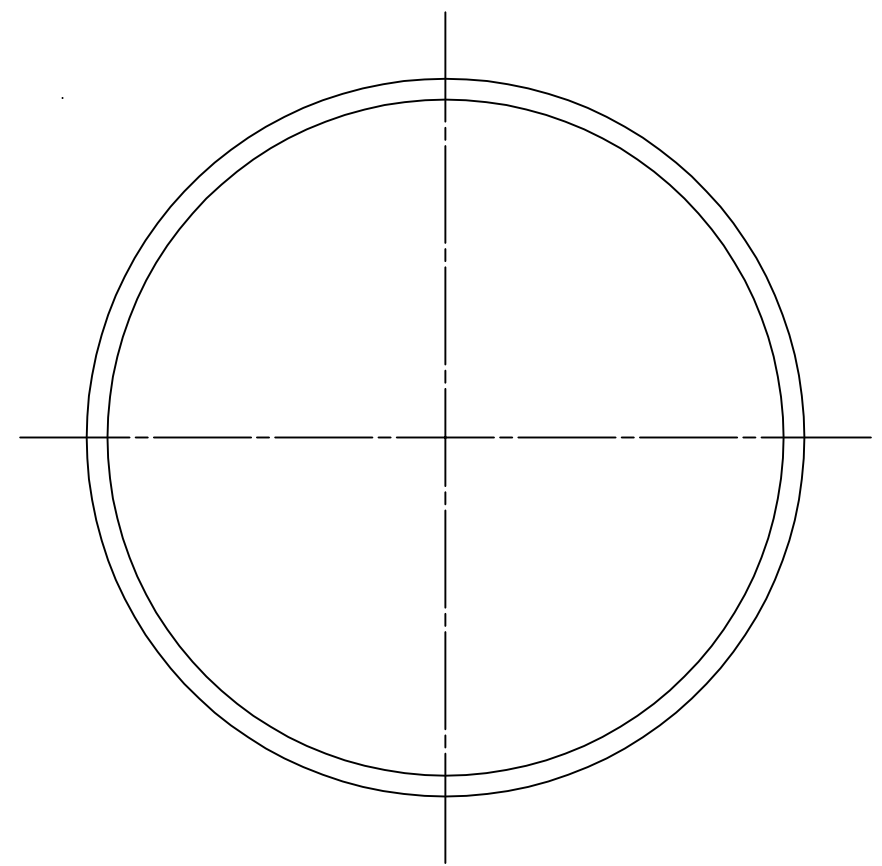

DRWN	BILLINGSLEY	DATE	08-23-02	CALIFORNIA INSTITUTE OF TECHNOLOGY MASSACHUSETTS INSTITUTE OF TECHNOLOGY		LIGO PROJECT	
CHKD				CAD FILE:			
ENGR				SUBSTRATE, INPUT TEST MASS, GIN GIN EXPERIMENT			
APPD				MATERIAL: CIT SUPPLIED A-AXIS SAPPHIRE			
DO NOT SCALE DRAWING				SCALE:	NTS	SIZE	DRAWING NUMBER
				B		D020423-A	SHEET
						1	1 OF 1

6

5

4

3

2

1