

- 7 WASHER (40 REQ' D)  
1/2 INCH, LARGE OD  
(PURCHASED COMPONENT)  
MCMaster-CARR #92140A120
- 6 FASTENER (8 REQ' D)  
1/2-13 X 2 1/4 CAP SCREW  
(PURCHASED COMPONENT)  
MCMaster-CARR #91247A721
- 5 LIFT EYEBOLT (1 REQ' D)  
1/2-13 FORGED STEEL  
(PURCHASED COMPONENT)  
MCMaster-CARR #3016T39

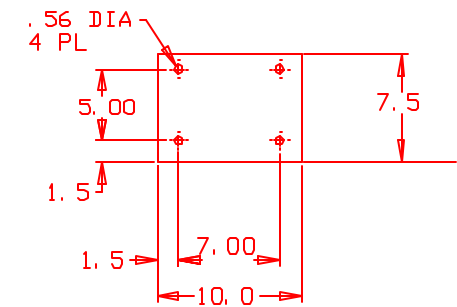

- 2 SHIM 0.25 THK (MAKE 2)
  - 3 SHIM 0.12 THK (MAKE 3)
  - 4 SHIM 0.06 THK (MAKE 2)
- MATERIAL FOR ALL SHIMS: ALUMINUM

NOTES:  
 1. ALL DIMENSIONS ARE IN INCHES  
 2. REMOVE ALL BURRS AND BREAK SHARP EDGES TO A MINIMUM OF 0.015 IN  
 3. ALL MACHINING TO BE PERFORMED AFTER WELDING IS COMPLETED  
 4. THOROUGHLY CLEAN TO REMOVE ALL OIL, GREASE, DIRT & CHIPS  
 5. APPLY PRIMER AND PAINT (BLACK) TO ALL VISIBLE SURFACES

ALL DIMENSIONS ARE IN INCHES  
 TOLERANCES: X.XX: +/- 0.03"  
 X.X: +/- 0.1"

D010227-C-D  
 OVERHEAD BSC CROSSBEAM BRACKET  
 LIGO PROJECT  
 L JONES 6/12/02