

REV	DATE	DRAWN BY	CHECKED	DCC	DCN/DESCRIPTION
A	2-18-00	C CONLEY			E000102/INITIAL RELEASE

- NOTES: (UNLESS OTHERWISE SPECIFIED)
1. ALL DIMENSIONS ARE IN MILLIMETERS AND DEGREES-MINUTES.
 2. DRAWING TO BE INTERPRETED PER ANSI Y14.5M-1982.
 3. POLISH ALL FACES, EDGES AND CHAMFERS.
- △ POLISH SURFACES #1 AND #2 FLAT TO 63 nm PEAK TO VALLEY OVER THE CENTRAL 120 nm.

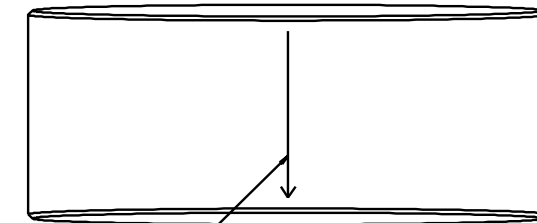

REGISTRATION MARK CENTERED BETWEEN SURFACES #1 AND #2, AND AT LOCATION OF MINIMUM PART THICKNESS ±2°0'.

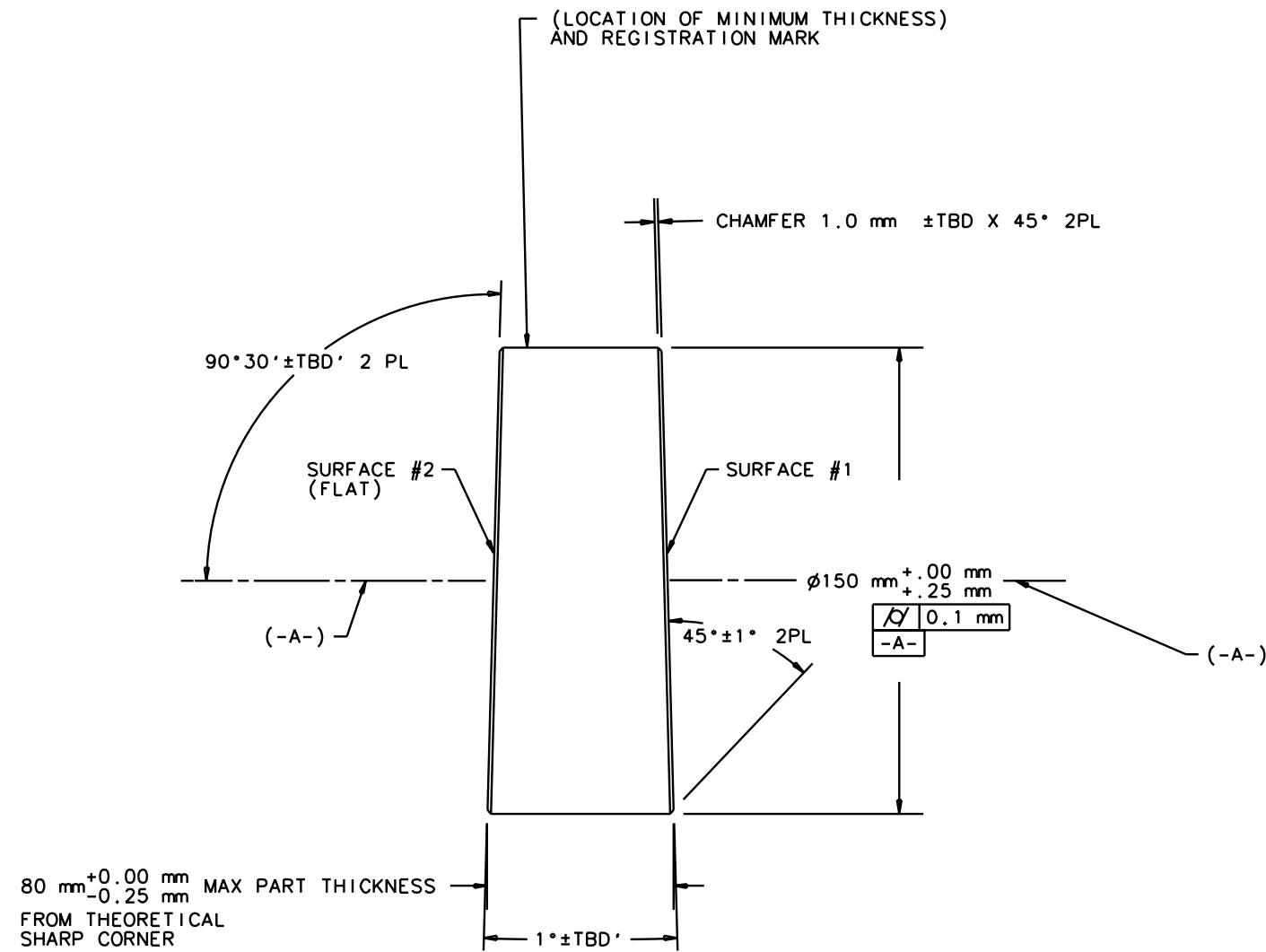
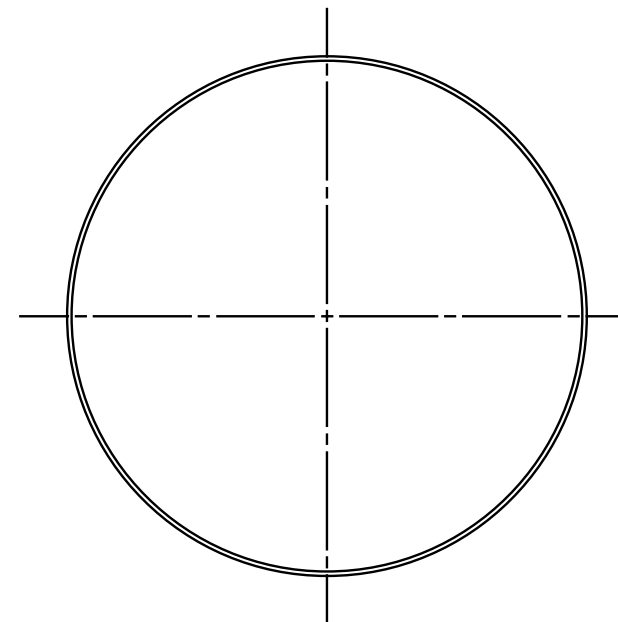

DRWN	C CONLEY	DATE	2-18-00	CALIFORNIA INSTITUTE OF TECHNOLOGY MASSACHUSETTS INSTITUTE OF TECHNOLOGY		LIGO PROJECT	
CHKD				CAD FILE: D000070-A.asc dcc file: /home/dcc/docs/D000070-A.pdf			
ENGR				MATERIAL: CRYSTAL SYSTEMS m AXIS SAPPHIRE			
APPD				LIGO II PATHFINDER SUBSTRATE			
DO NOT SCALE DRAWING				SCALE: NTS	SIZE	DRAWING NUMBER	SHEET
				B	D000070-A	1	1 OF 1