

6

5

4

3

2

1

NOTES:

- 1. CLEAR ANODIZE PER MIL-A-8625
- 2. MIN INSIDE RADIUS .03.
- 3. BREAK SHARP EDGES.
- 4. MARK PART NUMBER D000004-B WHERE SHOWN IN .12 HIGH CHARACTERS

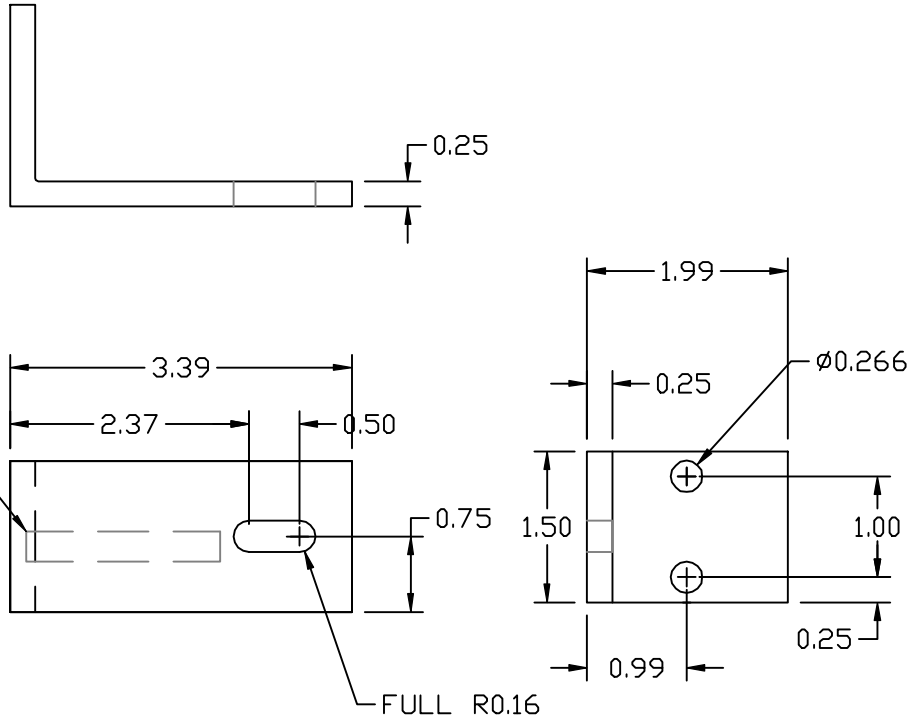

NOTE 4

FULL R0.16

UNLESS OTHERWISE SPECIFIED

DIMENSIONS ARE IN FEET (cm)  
 TOLERANCES: FRACTIONAL ±1/16(1.6) FINISHED SURFACE RMS 63  
 ANGULAR ±1° BREAK CORNERS .02  
 TWO PLACE DECIMAL ±.0025(0.025) REMOVE ALL BURRS  
 THREE PLACE DECIMAL ±.005(.013)

MATERIAL: 6061-T6 ALUM. HEAT TREAT: - FINISH: CLEAR ANOD.  
 USED IN ETM-X MONITOR NEXT ASS'Y: D990414-B

REF	QTY	PART or DRWG No.	CDS	MATERIAL
PARTS and MATERIAL LIST				
B		REDESIGNED TABLE LAYOUT	SMITH 4/00	SUPPORT MOUNT, ETM CAMERA
A		RELEASE	SMITH 1/00	
00		PRE-RELEASE	SMITH 1/00	
REV		DESCRIPTION	DCC SYS DET CDS VE CC BT CHECK DRWN DATE	CAD FILE: D000004-B-D SCALE: FULL SHEET: 1 of 1

6

5

4

3

2

1