

D1002173_AdlIGO_slc_ARM_Cavity Baffle Hinge Assy, PART PDM REV: X-066, DRAWING PDM REV: X-026

REV.	DATE	DCN #	DRAWING TREE #
v1	07 APR 2011	E1100216	E1000674
v2	17 JUL 2011	E1100216	
v3	17 Aug 2011	PRELIM	-
v4	22 SEP 2011	E1100335	

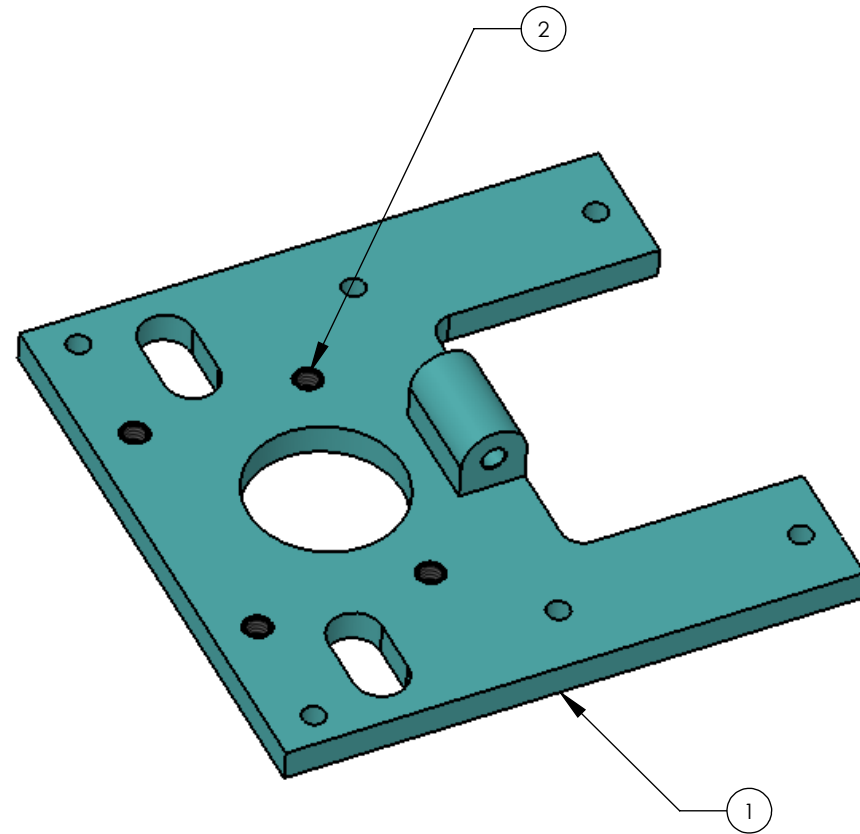

ITEM NO.	PART NUMBER	DESCRIPTION	MATERIAL	REQ	SPARE	TOTAL
2	1185-4EN250	HELI-COIL INSERT, 1/4-20 X 1/4 LG	NITRONIC 60	4		4
1	D1001622	ARM CAVITY BAFFLE LOWER MTG HINGE	6061-T6 Al	1		1

PARTS LIST

<p>NOTES AND TOLERANCES: (UNLESS OTHERWISE SPECIFIED)</p> <p>DIMENSIONS ARE IN INCHES</p> <p>TOLERANCES: .XX ± .XXX ± ANGULAR ± °</p>		<p>1. INTERPRET DRAWING PER ASME Y14.5-1994. 2. REMOVE ALL SHARP EDGES, R.02 MIN. 3. DO NOT SCALE FROM DRAWING. 4. ALL MACHINING FLUIDS MUST BE FULLY SYNTHETIC, FULLY WATER SOLUBLE AND FREE OF SULFUR, SILICONE, AND CHLORINE.</p>		<p>LIGO CALIFORNIA INSTITUTE OF TECHNOLOGY MASSACHUSETTS INSTITUTE OF TECHNOLOGY</p>		<p>PART NAME ARM CAVITY BAFFLE HINGE ASSY</p>	
<p>MATERIAL N/A</p>		<p>FINISH N/A</p>		<p>SYSTEM ADVANCED LIGO</p>		<p>SUB-SYSTEM AOS</p>	
<p>DESIGNER N.Nguyen</p>		<p>DATE 16 Aug 2010</p>		<p>SIZE B</p>		<p>DWG. NO. D1002173</p>	
<p>DRAFTER T.Nguyen</p>		<p>DATE 18 Oct 2010</p>		<p>SCALE 1:2</p>		<p>PROJECTION: </p>	
<p>CHECKER M. Smith</p>		<p>DATE 10 Nov 2010</p>		<p>APPROVAL D. Coyne</p>		<p>REV. v4</p>	
<p>NEXT ASSY D0901376</p>		<p>SCALE 1:2</p>		<p>PROJECTION: </p>		<p>SHEET 1 OF 1</p>	