

NOTES CONTINUED:

5. SCRIBE, ENGRAVE, OR MECHANICALLY STAMP (NO INKS OR DYES) DRAWING PART NUMBER, REVISION (AND VARIANT OR TYPE IF APPLICABLE) ON NOTED SURFACE OF PART FOLLOWED ON THE NEXT LINE WITH A THREE DIGIT SERIAL NUMBER. SERIAL NUMBERS START AT 001 FOR THE FIRST ARTICLE AND PROCEED CONSECUTIVELY. USE MINIMUM 0.12" HIGH CHARACTERS, UNLESS THE SIZE OF THE PART DICTATES SMALLER CHARACTERS. A VIBRATORY TOOL MAY BE USED. EXAMPLE: DXXXXXX-VY, TYPE-XX, S/N XXX

6. APPROXIMATE WEIGHT = 231LB.

REV.	DATE	DCN #	DRAWING TREE #
V1	18 AUG 2010		
V2	20 AUG 2010		
V3	12 OCT 2010	E1000577	

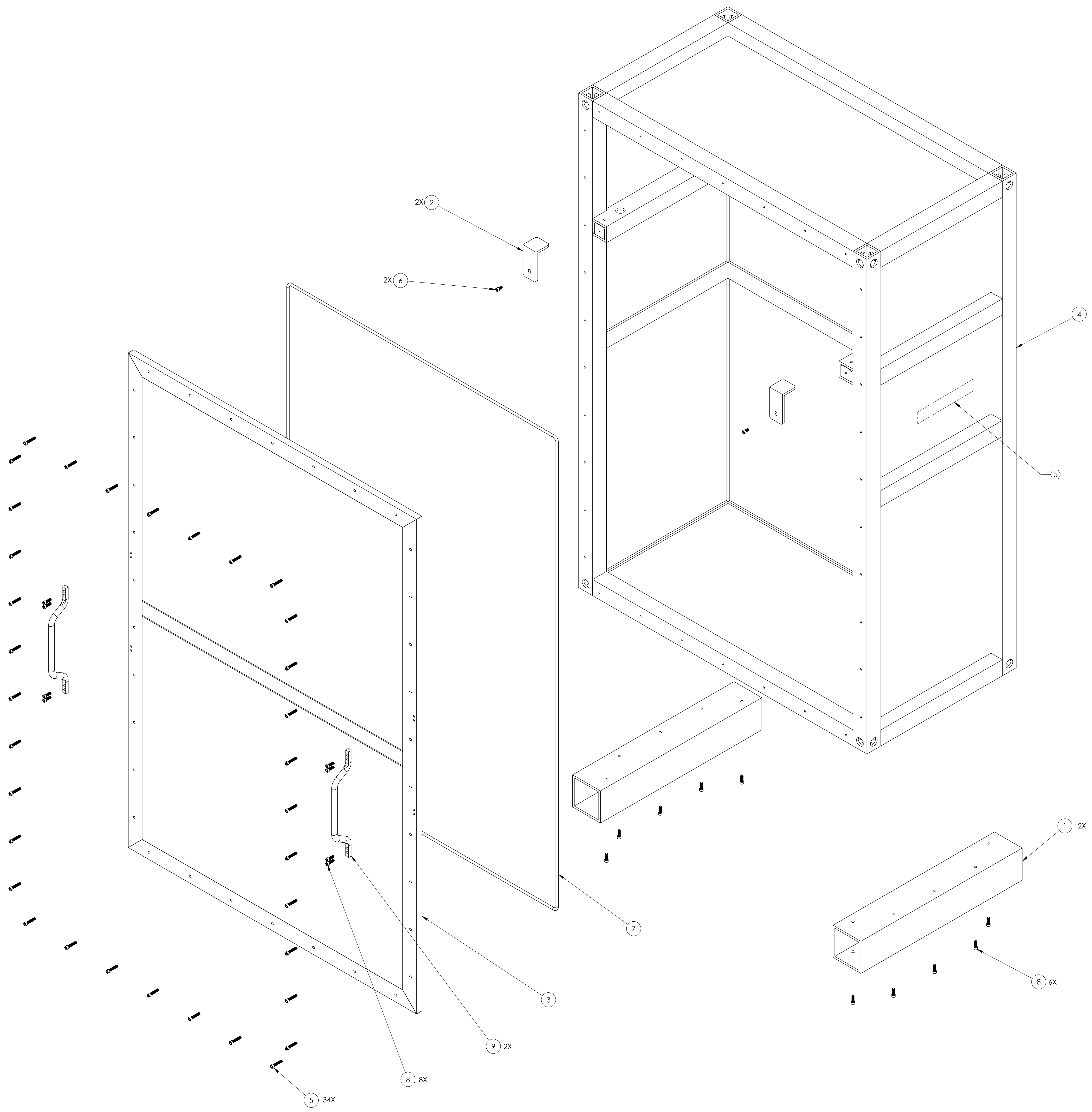

ITEM NO.	PART NUMBER	DESCRIPTION	MATERIAL	REQ	SPARE	TOTAL
9	1B71A65	ROUND GRIP PULL HANDLE	1100-H14 AI	2		2
8	92200A540	SCREW, SHC, 1/4-20 x 3/4, MS16995-50, MC #92200A540	300 S5TL	18		18
7	7 X 4927 O-RING	ROW INC. O-RING, 7mm THICK X 4927 CORD LENGTH ( 275" X 194")	VITON	1		1
6	92200A537	SCREW, SHC, 1/4-20 x 1/2, MS16995-48, MC #92200A537	300 S5TL	2		2
5	92200A540	SCREW, SHC, 1/4-20 x 1 1/4, MS16995-53, MC #92200A544	300 S5TL	34		34
4	D1002119	LOWER STRUCTURE STORAGE CONTAINER WELDMENT	N/A	1		1
3	D1002120	LOWER STRUCTURE STORAGE CONTAINER FRONT PANEL	N/A	1		1
2	D1002247	LOWER STRUCTURE STORAGE CONTAINER LSAT CLAMP	6061-T6 AI	2		2
1	D1002248	LOWER STRUCTURE STORAGE CONTAINER SUPPORT RAILS	6061-T6 AI	2		2

NOTES AND TOLERANCES: (UNLESS OTHERWISE SPECIFIED)	
1. INTERPRET DRAWING PER ASME Y14.5-1994.	
2. REMOVE ALL SHARP EDGES, R.02 MIN.	
3. DO NOT SCALE FROM DRAWING.	
4. ALL MACHINING FLUIDS MUST BE FULLY SYNTHETIC, FULLY WATER SOLUBLE AND FREE OF SULFUR, SILICONE, AND CHLORINE.	
DIMENSIONS ARE IN MILLIMETERS	
TOLERANCES:	
.XX ± .25	
.XXX ± .13	
ANGULAR ± .5°	
MATERIAL	N/A
FINISH	N/A μinch

CALIFORNIA INSTITUTE OF TECHNOLOGY MASSACHUSETTS INSTITUTE OF TECHNOLOGY		<b>PART NAME</b> LOWER QUAD STORAGE CONTAINER	
<b>SYSTEM</b> ADVANCED LIGO	<b>SUB-SYSTEM</b> SUS	<b>DESIGNER</b> K. BUCKLAND	<b>DATE</b> 2 AUG 2010
<b>DRAFTER</b> K. BUCKLAND	<b>DATE</b> 18 AUG 2010	<b>SIZE</b> E	<b>DWG. NO.</b> D1002118
<b>CHECKER</b> [Blank]	<b>APPROVAL</b> [Blank]	<b>SCALE</b> 1:4	<b>PROJECTION</b> 
		<b>REV.</b> v3	SHEET 1 OF 2

D:\000118-SUSC-LS-LOWER STRUCTURE STORAGE CONTAINER PART FROM REV.X.011 DRAWING FROM REV.X.010

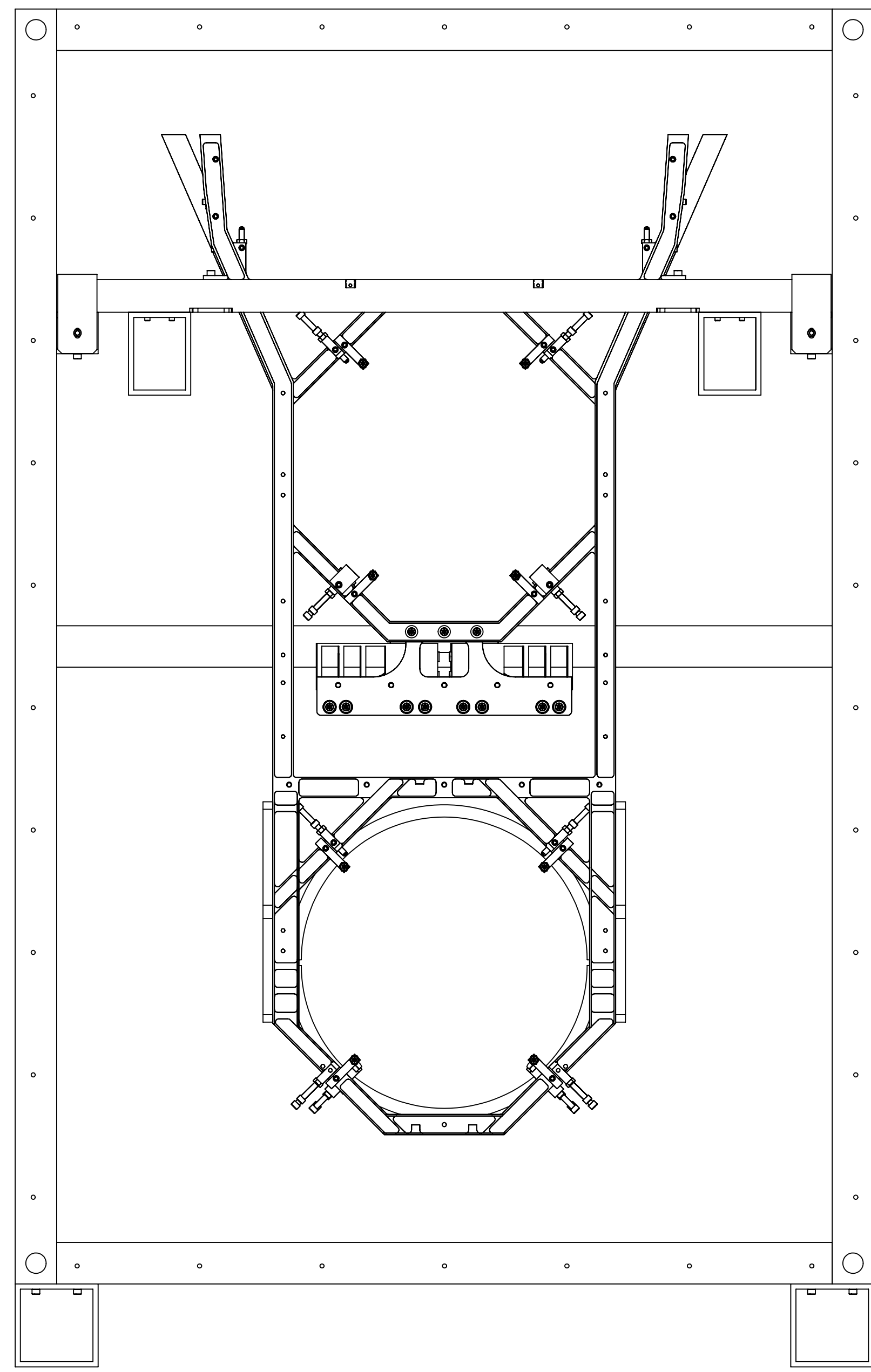

FRONT PANEL AND HARDWARE  
REMOVED FOR CLARITY

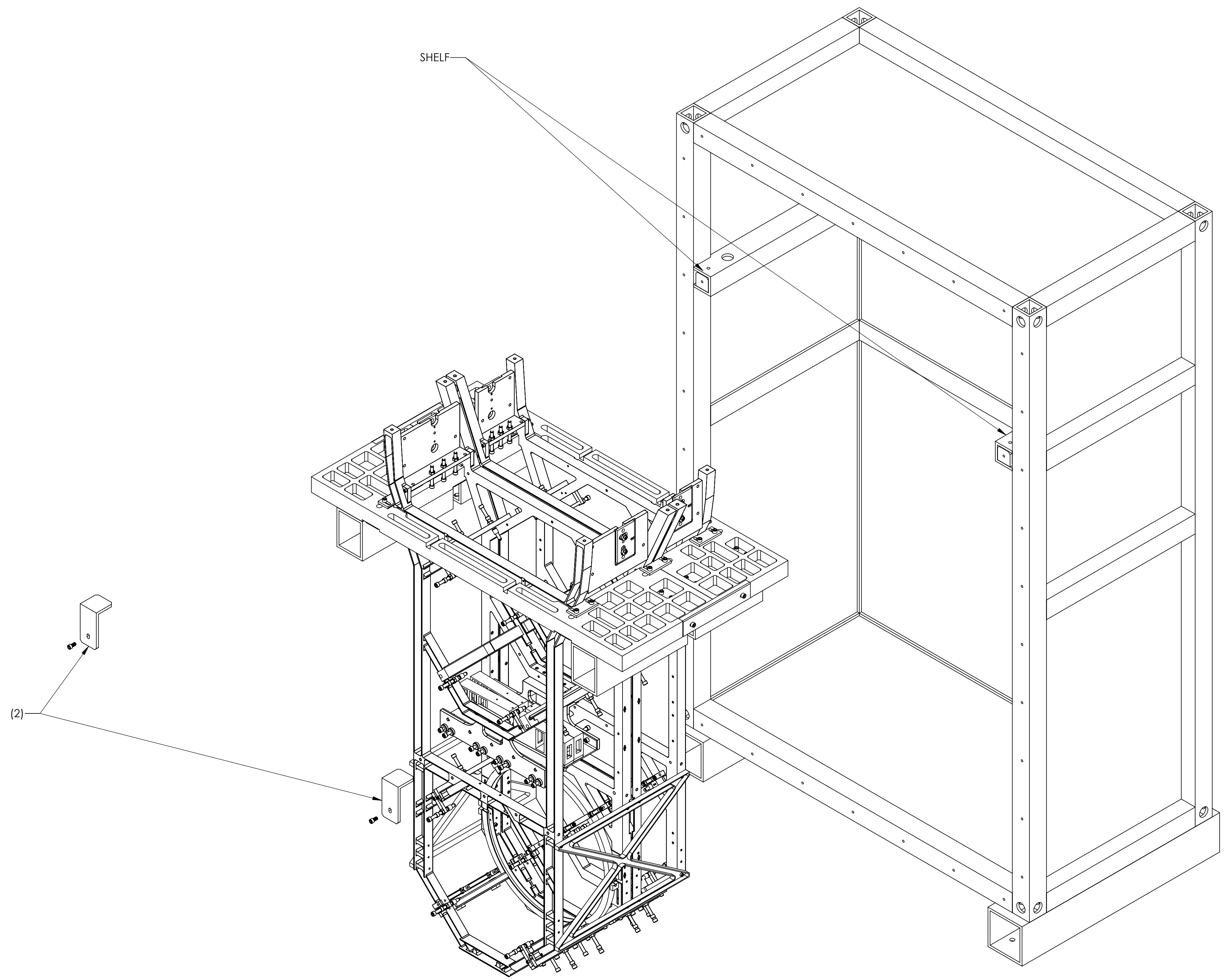

FRONT PANEL AND HARDWARE  
REMOVED FOR CLARITY