

PROPRIETARY AND CONFIDENTIAL
 THE INFORMATION CONTAINED IN THIS
 DRAWING IS THE SOLE PROPERTY OF
 GNB CORPORATION. ANY
 REPRODUCTION IN PART OR AS A WHOLE
 WITHOUT THE WRITTEN PERMISSION OF
 GNB CORPORATION IS PROHIBITED.

REVISIONS				
ZONE	REV.	DESCRIPTION	DATE	APPROVED

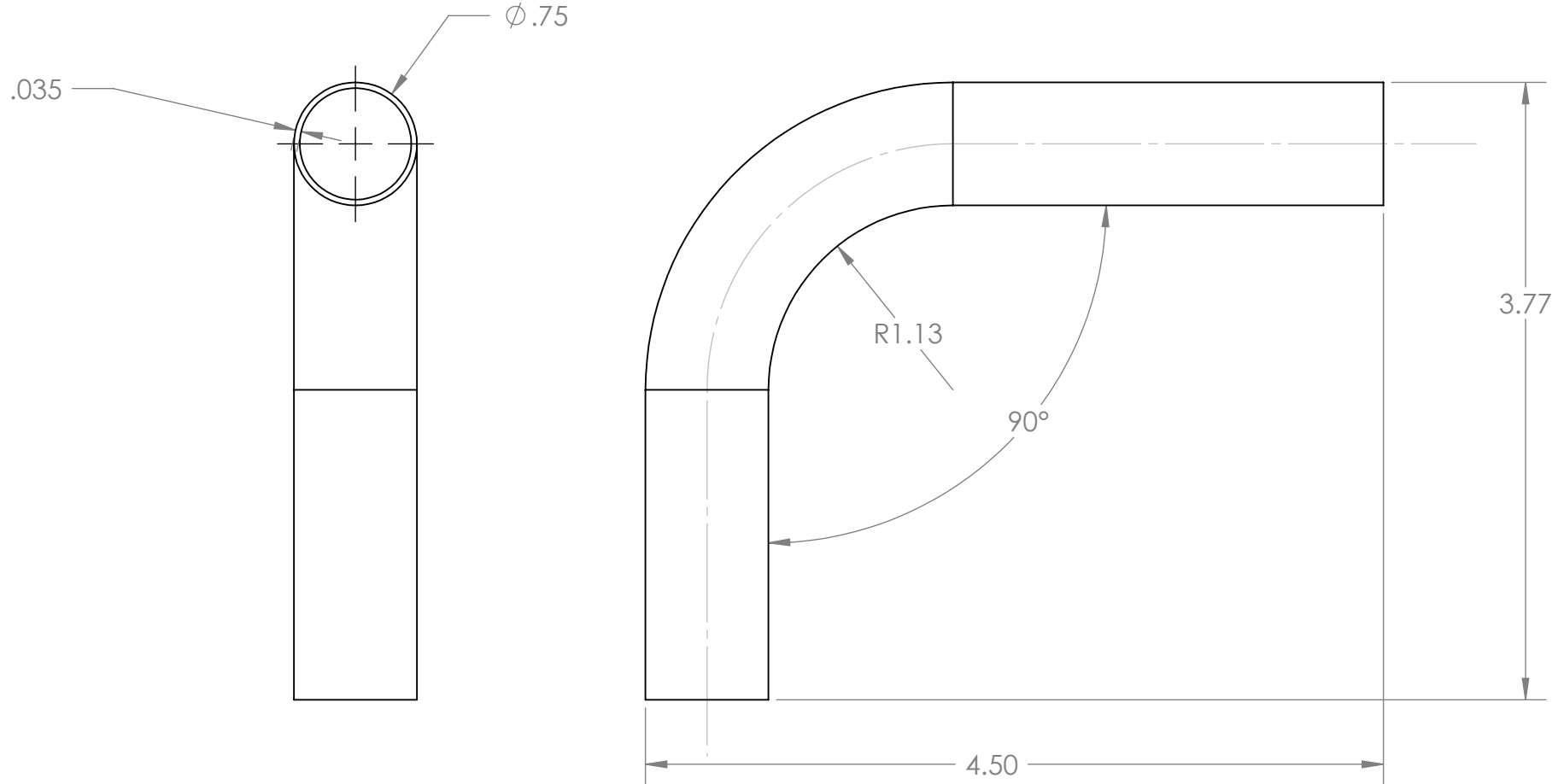

NOTES:

1. THE FOLLOWING ARE NOT ALLOWED: GRINDING, HONING, LAPPING, POLISHING, BUFFING, SANDING, BLASTING.
2. NO HYDROCARBONS ALLOWED IN THE COOLANT. COOLANT LIMITS AS FOLLOWS
 - a. WATER LEACHABLE CHLORIDES: 100PPM
 - b. TOTAL HALOGENS (INCLUDING CHLORIDES): 1000PPM
 - c. TOTAL SULFUR: 1000PPM
3. DO NOT ALLOW PART TO BE CONTAMINATED BY CARBON STEEL OR IRON CONTACT.
4. MACHINING TO BE IN LINE WITH LIGO SPECIFICATION E0900406, LATEST REVISION.
5. WHEN BENDING, PLACE HEAVY PAPER OR STAINLESS STEEL SHEET METAL BETWEEN WORK PIECE AND BENDING TOOL.

DESCRIPTION: TUBE, .035 WALL, .75 OD, 7.0 LG		<p>SCIENTIFIC AND INDUSTRIAL EQUIPMENT</p> <p>3200 DWIGHT RD, SUITE 100 ELK GROVE, CA 95758 916-395-3003 FAX: 916-395-3363 WWW.GNBVALVES.COM</p>															
MATERIAL: AISI 304/AISI 304L DUAL CERT PER SA240																	
UNLESS OTHERWISE SPECIFIED:	WEIGHT: 0.16 #	<table border="1"> <thead> <tr> <th colspan="3">APPROVALS</th> </tr> <tr> <th></th> <th>NAME</th> <th>DATE</th> </tr> </thead> <tbody> <tr> <td>DRAFTER</td> <td>MKM2</td> <td>6/11/10</td> </tr> <tr> <td>CHECKER</td> <td>RW</td> <td>6/14/10</td> </tr> <tr> <td>ENGINEER</td> <td>MKM2</td> <td>6/10/10</td> </tr> </tbody> </table>	APPROVALS				NAME	DATE	DRAFTER	MKM2	6/11/10	CHECKER	RW	6/14/10	ENGINEER	MKM2	6/10/10
APPROVALS																	
	NAME		DATE														
DRAFTER	MKM2		6/11/10														
CHECKER	RW	6/14/10															
ENGINEER	MKM2	6/10/10															
DIMENSIONS ARE IN INCHES	FINISH 125 ANGULAR: ± 0°30' .XX ± .01 .XXX ± .005 UNSPECIFIED FILLETS: R.015 BREAK EDGES .010 x 45° REMOVE ALL BURRS // ◻ ⊥ WITHIN .03 THIRD ANGLE PROJECTION																
TOLERANCES:																	
DO NOT SCALE DRAWING		DWG. NO. A 114236-00S SCALE: 1:1															
		TITLE: TUBE, PORT, PUMP-OUT, 3/4" OD SHEET 1 OF 1															