

NOTES:

1. ALL MONUMENT LOCATIONS ARE TO BE WITHIN +/- 3MM OF TRUE POSITION.
2. AFTER LOCATING ALL MONUMENTS, VERIFY Z-POSITION AND RECORD.

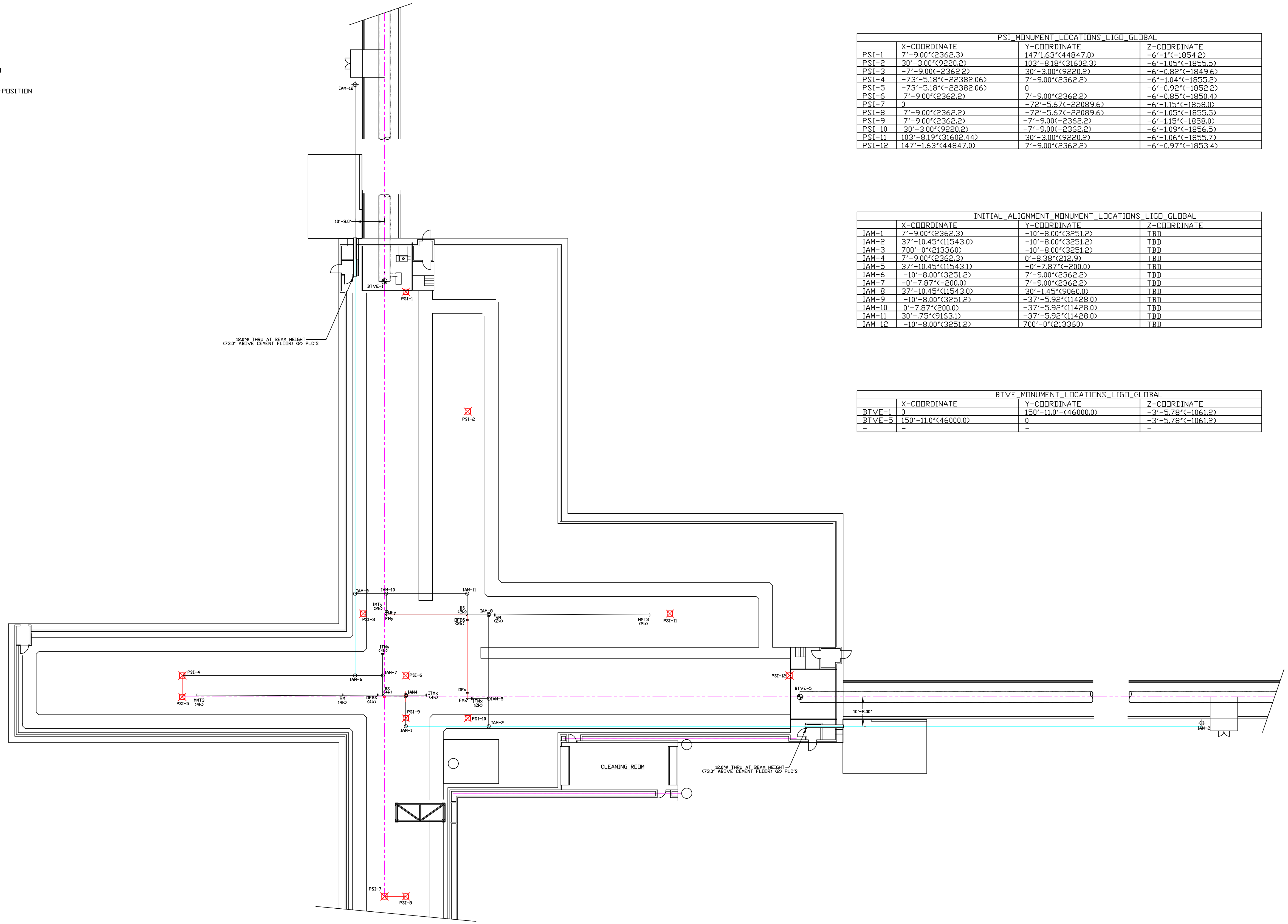

	X-COORDINATE	Y-COORDINATE	Z-COORDINATE
PSI-1	7'-9.00'(2362.3)	147'1.63'(4484.70)	-6'-1'(1854.2)
PSI-2	30'-3.00'(9220.2)	103'-9.18'(31602.3)	-6'-1.05'(1855.5)
PSI-3	-7'-9.00'(2362.2)	30'-3.00'(9220.2)	-6'-0.82'(1849.6)
PSI-4	-73'-5.18'(22382.06)	7'-9.00'(2362.2)	-6'-1.04'(1855.2)
PSI-5	-73'-5.18'(22382.06)	0	-6'-0.92'(1852.2)
PSI-6	7'-9.00'(2362.2)	7'-9.00'(2362.2)	-6'-0.85'(1850.4)
PSI-7	0	-72'-5.67'(22089.6)	-6'-1.15'(1858.0)
PSI-8	7'-9.00'(2362.2)	-72'-5.67'(22089.6)	-6'-1.05'(1855.5)
PSI-9	7'-9.00'(2362.2)	-7'-9.00'(2362.2)	-6'-1.15'(1858.0)
PSI-10	30'-3.00'(9220.2)	-7'-9.00'(2362.2)	-6'-1.09'(1856.5)
PSI-11	103'-8.19'(31602.44)	30'-3.00'(9220.2)	-6'-1.06'(1855.7)
PSI-12	147'-1.63'(4484.70)	7'-9.00'(2362.2)	-6'-0.97'(1853.4)

	X-COORDINATE	Y-COORDINATE	Z-COORDINATE
IAM-1	7'-9.00'(2362.3)	-10'-8.00'(3251.2)	TBD
IAM-2	37'-10.45'(11543.0)	-10'-8.00'(3251.2)	TBD
IAM-3	700'-0'(213360)	-10'-8.00'(3251.2)	TBD
IAM-4	7'-9.00'(2362.3)	0'-8.38'(212.9)	TBD
IAM-5	37'-10.45'(11543.1)	0'-7.87'(200.0)	TBD
IAM-6	-10'-8.00'(3251.2)	7'-9.00'(2362.2)	TBD
IAM-7	0'-7.87'(200.0)	7'-9.00'(2362.2)	TBD
IAM-8	37'-10.45'(11543.0)	30'-1.45'(9060.0)	TBD
IAM-9	-10'-8.00'(3251.2)	-37'-5.92'(11428.0)	TBD
IAM-10	0'-7.87'(200.0)	-37'-5.92'(11428.0)	TBD
IAM-11	30'-7.5'(9163.1)	-37'-5.92'(11428.0)	TBD
IAM-12	-10'-8.00'(3251.2)	700'-0'(213360)	TBD

	X-COORDINATE	Y-COORDINATE	Z-COORDINATE
BTVE-1	0	150'-11.0'(46000.0)	-3'-5.78'(1061.2)
BTVE-5	150'-11.0'(46000.0)	0	-3'-5.78'(1061.2)
-	-	-	-

UNLESS OTHERWISE SPECIFIED
DIMENSIONS ARE IN INCHES

TOLERANCES:
FRACTIONAL ± 1/8 (3 MM)
ANGULAR ± 1°
TWO PLACE DECIMAL ± .01(.025)
THREE PLACE DECIMAL ± .005(.013)

FINISHED SURFACE RMS 63
BREAK CORNERS IN: OUT: .02
REMOVE ALL BURRS

MATERIAL: - HEAT TREAT: - FINISH: -

USED ON: - NEXT ASSY: -

REV	DESCRIPTION	DCC	SYS	DET	CDS	VE	CC	BT	CHECK	DRWN	DATE
A	INITIAL RELEASE									MASON	5/98
01	CH'D MONUMENT LOCATIONS									MASON	2/98
00	PRE-RELEASE									MASON	7/97

LIGO
CALIFORNIA INSTITUTE OF TECHNOLOGY
MASSACHUSETTS INSTITUTE OF TECHNOLOGY

ASC MONUMENT LOCATIONS
CORNER STATION
WASHINGTON SITE

CAD FILE: D970210-A-S1.dwg
SCALE: 1"=20'

SIZE: D
DWG. NO.: D970210-A-D
SHEET: 1 of 5

NOTES:

1. ALL MONUMENT LOCATIONS ARE TO BE WITHIN +/- 3MM OF TRUE POSITION.
2. AFTER LOCATING ALL MONUMENTS, VERIFY Z-POSITION AND RECORD.

MONUMENT_LOCATIONS_LIGO_GLOBAL			
	X-COORDINATE	Y-COORDINATE	Z-COORDINATE
IAM-13	5840'-0.1*(1780032.0)	10'-0.0*(3048.0)	TBD
IAM-14	6631'-3.0*(2021205.0)	10'-0.0*(3048.0)	TBD
IAM-15	6631'-3.0*(2021205.0)	0-7.87*(200.0)	TBD
BTVE-6	6586'-3.35*(2007499.0)	0	-3'-5.54*(-1055.1)
BTVE-7	6650'-3.11*(2026999.0)	0	-3'-5.77*(-1061.1)

12.0"Ø THRU AT BEAM HEIGHT
(73.0" ABOVE CEMENT FLOOR)

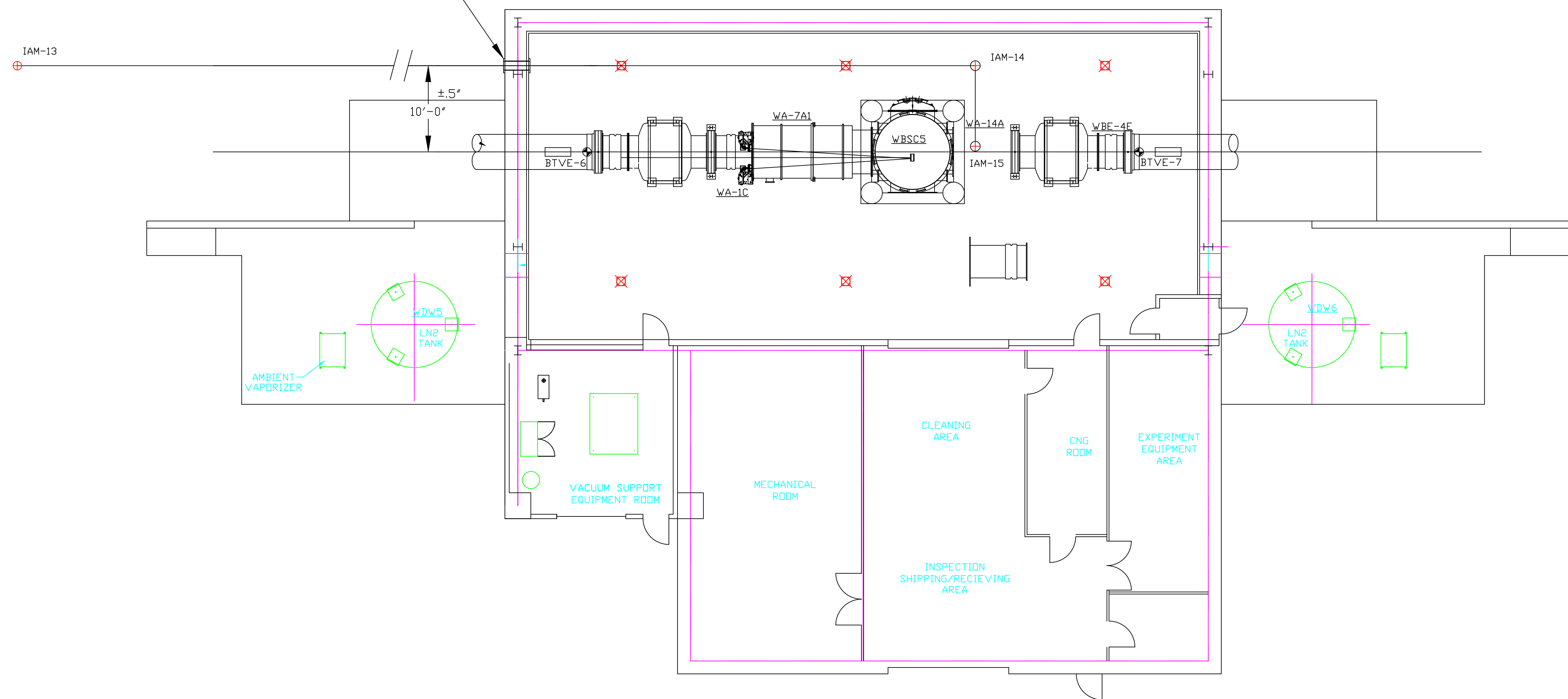

		UNLESS OTHERWISE SPECIFIED DIMENSIONS ARE IN INCHES													LIGO CALIFORNIA INSTITUTE OF TECHNOLOGY MASSACHUSETTS INSTITUTE OF TECHNOLOGY		
		TOLERANCES: FRACTIONAL ± 1/8 (3 mm) ANGULAR ± 1° TWO PLACE DECIMAL ± - THREE PLACE DECIMAL ± -		FINISHED SURFACE RMS 63 BREAK CORNERS IN: OUT: .02 REMOVE ALL BURRS		MATERIAL: -		HEAT TREAT: -		FINISH: -		A INITIAL RELEASE MASON 5/98		ASC MONUMENT LOCATIONS MID STATION- X ARM WASHINGTON SITE			
DWG. NO.		DESCRIPTION		USED ON: -		NEXT ASS'Y: -		REV		DESCRIPTION		DCC SYS DET CDS VE CC BT CHECK DRWN DATE				CAD FILE D970210-A-S2.dwg	
		REFERENCE DRAWINGS								ISSUE DESCRIPTION		SCALE 1" = 8'		SHEET 2 of 5			

NOTES:

1. ALL MONUMENT LOCATIONS ARE TO BE WITHIN +/- 3MM OF TRUE POSITION.
2. AFTER LOCATING ALL MONUMENTS, VERIFY Z-POSITION AND RECORD.

PSI_MONUMENT_LOCATIONS_LIGO_GLOBAL			
	X-COORDINATE	Y-COORDINATE	Z-COORDINATE
IAM-16	12389'-0"(<314680.6)	10'-0"(<3048.0)	TBD
IAM-17	13131'-0.31"(<4002336.75)	10'-0"(<3048.0)	TBD
IAM-18	13131'-0.31"(<4002336.75)	0'-7.87"(<200.0)	TBD
-	-	-	-
BTVE-8	13085'-7.44"(<3988497.0)	0	-3'-5.61"(<-1056.9)

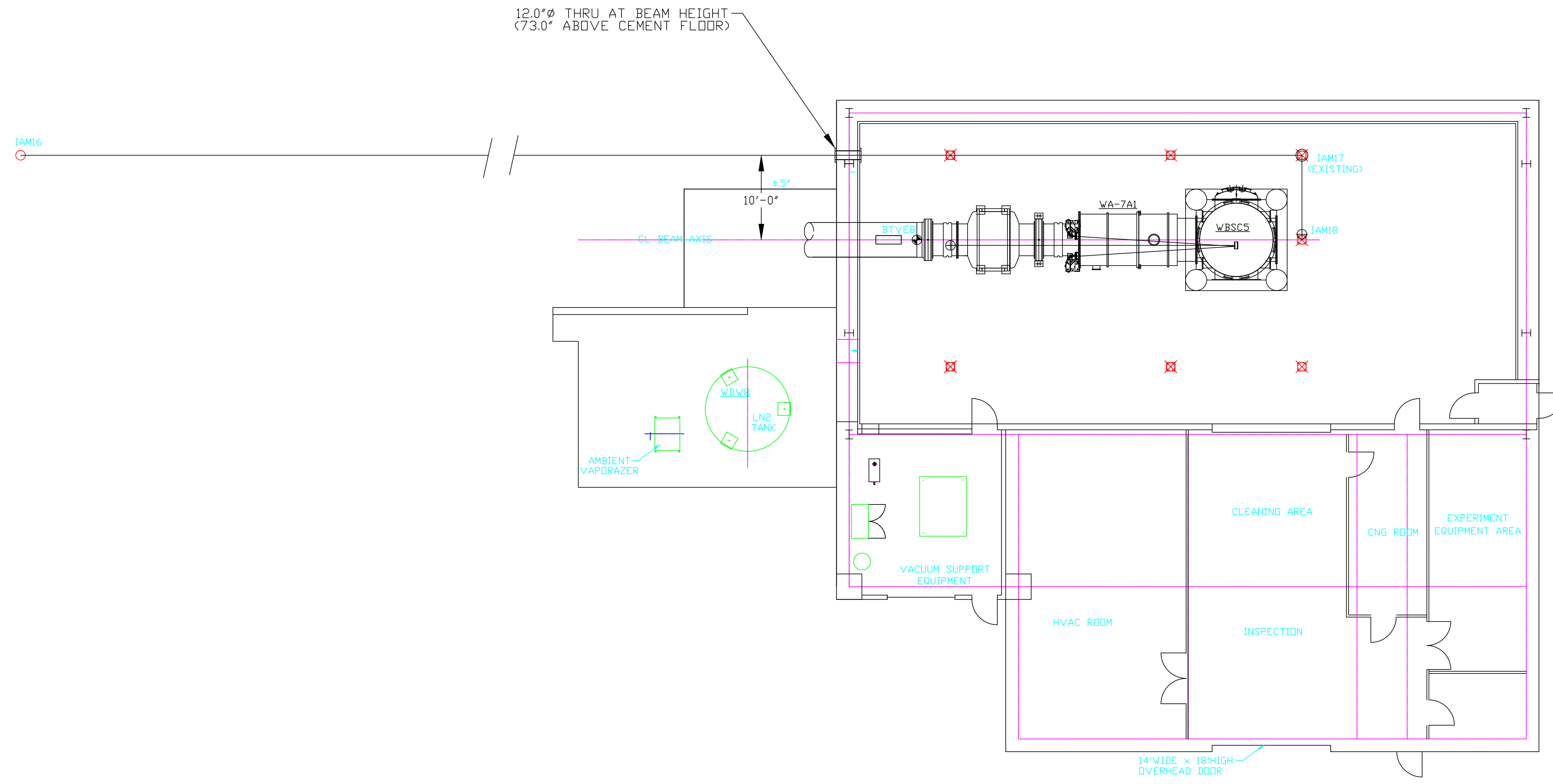

UNLESS OTHERWISE SPECIFIED
DIMENSIONS ARE IN INCHES

TOLERANCES:
FRACTIONAL ± 1/8 (3 mm)
ANGULAR ± 1°
TWO PLACE DECIMAL ± -
THREE PLACE DECIMAL ± -

FINISHED SURFACE RMS 63
BREAK CORNERS IN: OUT: .02
REMOVE ALL BURRS

MATERIAL: HEAT TREAT: FINISH:

REV	DESCRIPTION	DCC	SYS	DET	CDS	VE	CC	BT	CHECK	DRWN	DATE
A	INITIAL RELEASE									MASON	5/98
01	CH'D MONUMENT LOCATIONS									MASON	2/98
00	PRE-RELEASE									MASON	7/97

LIGO

CALIFORNIA INSTITUTE OF TECHNOLOGY
MASSACHUSETTS INSTITUTE OF TECHNOLOGY

ASC MONUMENT LOCATIONS
END STATION- X ARM
WASHINGTON SITE

CAD FILE: D970210-A-S3.dwg SIZE: D DWG. NO: D970210-A-D
SCALE: 1" = 8' SHEET: 3 of 5

NOTES:

- 1. ALL MONUMENT LOCATIONS ARE TO BE WITHIN +/- 3MM OF TRUE POSITION.
- 2. AFTER LOCATING ALL MONUMENTS, VERIFY Z-POSITION AND RECORD.

MONUMENT_LOCATIONS_LIGO_GLOBAL			
	X-COORDINATE	Y-COORDINATE	Z-COORDINATE
IAM-19	10'-0.0"(3048.0)	5840'-0"(17803.20)	TBD
IAM-20	10'-0.0"(3048.0)	6631'-3.25"(2021211.35)	TBD
IAM-21	0'-7.87"(200.0)	6631'-3.25"(2021211.35)	TBD
BTVE-2	0	6586'-3.38"(2007498.5)	-3'-5.61"(-1056.9)
BTVE-3	0	6650'-3.0"(2026996.2)	-3'-5.92"(-1064.8)

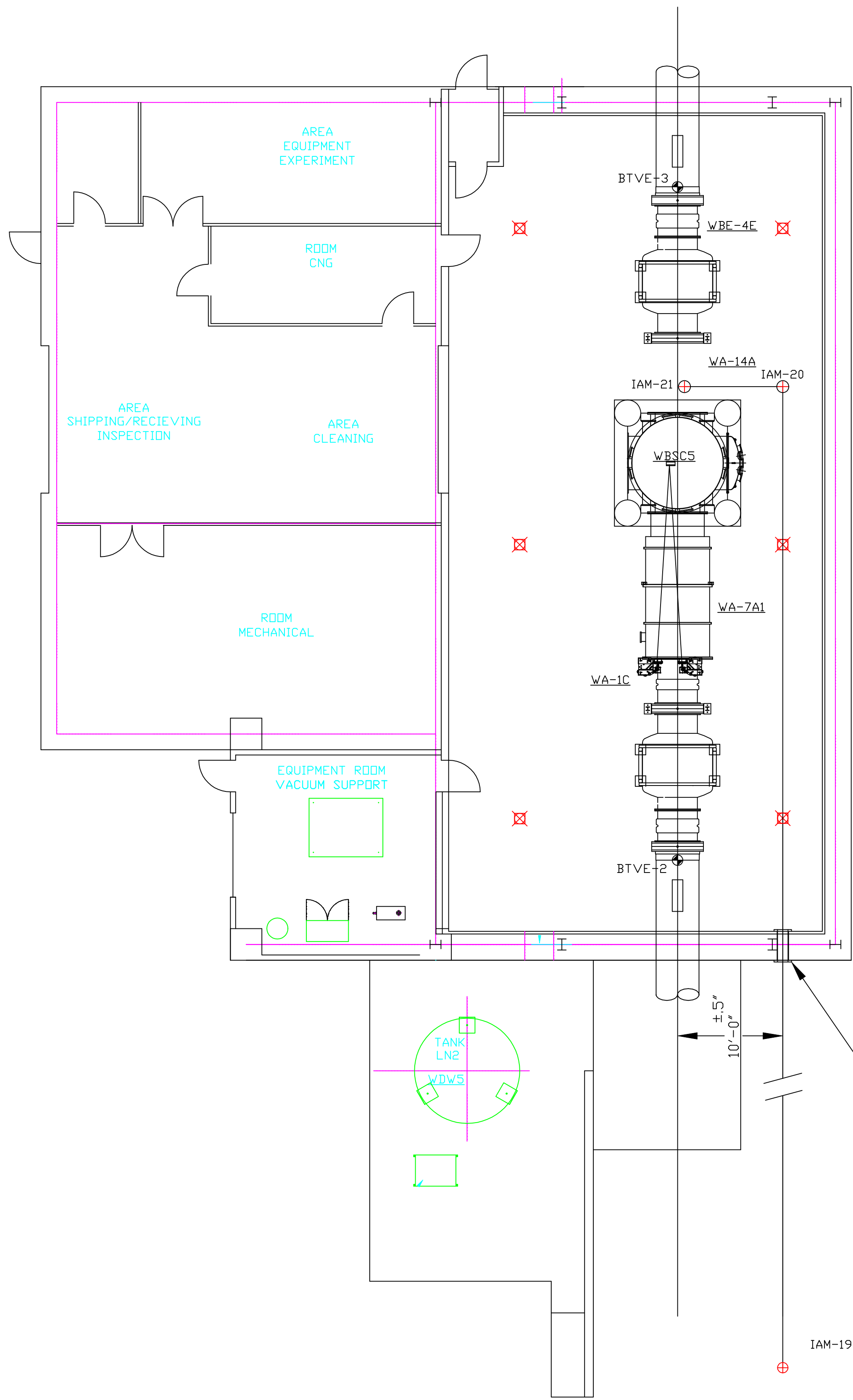

12.0"Ø THRU AT BEAM HEIGHT
(73.0' ABOVE CEMENT FLOOR)

LIGO
CALIFORNIA INSTITUTE OF TECHNOLOGY
MASSACHUSETTS INSTITUTE OF TECHNOLOGY

ASC MONUMENT LOCATIONS
MID STATION- Y ARM
WASHINGTON SITE

CAD FILE: D970210-A-S1.dwg | SIZE: D | DWG. NO.: D970210-A-D
SCALE: 1" = 8' | SHEET: 4 of 5

UNLESS OTHERWISE SPECIFIED
DIMENSIONS ARE IN INCHES

TOLERANCES: FRACTIONAL ± 1/8 (<3 mm) ANGULAR ± 1° TWO PLACE DECIMAL ± - THREE PLACE DECIMAL ± -	FINISHED SURFACE RMS 63 BREAK CORNERS IN: OUT: .02 REMOVE ALL BURRS
MATERIAL: -	HEAT TREAT: -
USED ON: -	NEXT ASS'Y: -

REV	DESCRIPTION	DCC	SYS	DET	CDS	VE	CC	BT	CHECK	DRWN	DATE
A	INITIAL RELEASE									MASON	5/98
01	CH'D MONUMENT LOCATIONS									MASON	2/98
00	PRE-RELEASE									MASON	7/97

DWG. NO.	DESCRIPTION
	REFERENCE DRAWINGS

NOTES:

1. ALL MONUMENT LOCATIONS ARE TO BE WITHIN +/- 3MM OF TRUE POSITION.
2. AFTER LOCATING ALL MONUMENTS, VERIFY Z-POSITION AND RECORD.

PSI_MONUMENT_LOCATIONS_LIGO_GLOBAL			
	X-COORDINATE	Y-COORDINATE	Z-COORDINATE
IAM-22	10'-0" (3048.0)	12389'-0" (376167.2)	TBD
IAM-23	10'-0" (3048.0)	13131'-1.69" (4002371.75)	TBD
IAM-24	0'-7.87" (200.0)	13131'-1.69" (4002371.75)	TBD
-	-	-	-
BTVE-4	0	13085'-7.70" (3988503.6)	-3'-5.61" (-1056.9)

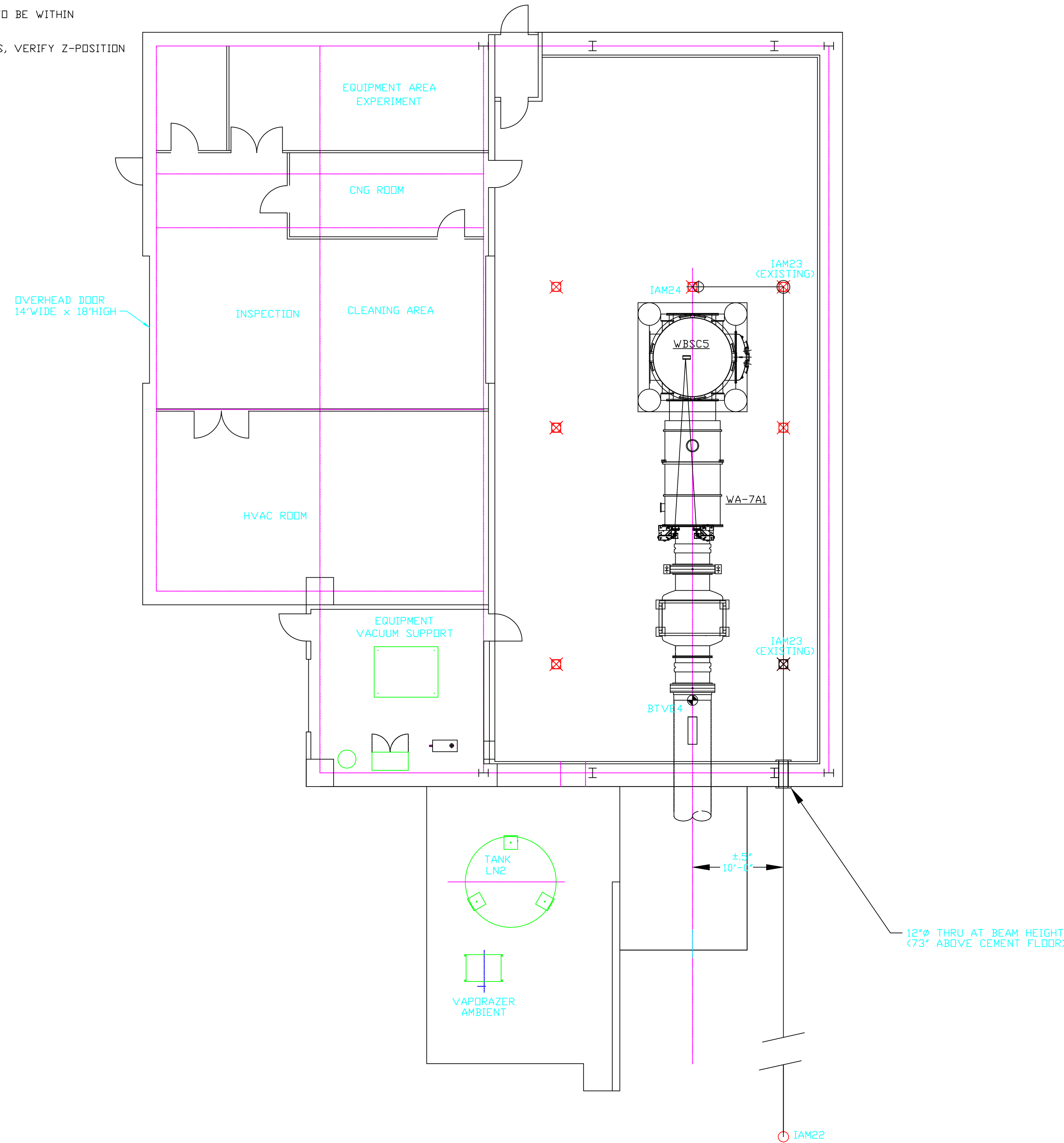

UNLESS OTHERWISE SPECIFIED
DIMENSIONS ARE IN INCHES

TOLERANCES:
FRACTIONAL ± 1/8 (3 mm)
ANGULAR ± 1°
TWO PLACE DECIMAL ± -
THREE PLACE DECIMAL ± -

FINISHED SURFACE RMS 63
BREAK CORNERS IN: OUT: .02
REMOVE ALL BURRS

MATERIAL: HEAT TREAT: FINISH:

USED ON: - NEXT ASS'Y: -

REV	DESCRIPTION	DCC	SYS	DET	CDS	VE	CC	BT	CHECK	DRWN	DATE
A	INITIAL RELEASE									MASON	5/98
01	CH'D MONUMENT LOCATIONS									MASON	2/98
00	PRE-RELEASE									MASON	7/97

LIGO

CALIFORNIA INSTITUTE OF TECHNOLOGY
MASSACHUSETTS INSTITUTE OF TECHNOLOGY

ASC MONUMENT LOCATIONS
END STATION- Y ARM
WASHINGTON SITE

CAD FILE: D970210-A-S5.dwg SIZE: D DWG. NO: D970210-A-D
SCALE: 1" = 8' SHEET: 5 of 5