

NOTES CONTINUED:
 5. SCRIBE, ENGRAVE, OR MECHANICALLY STAMP (NO INKS OR DYES) DRAWING PART NUMBER, REVISION (AND VARIANT OR "TYPE" IF APPLICABLE) ON NOTED SURFACE OF PART FOLLOWED ON THE NEXT LINE WITH A THREE DIGIT SERIAL NUMBER. SERIAL NUMBERS START AT 001 FOR THE FIRST ARTICLE AND PROCEED CONSECUTIVELY. USE MINIMUM 0.12" HIGH CHARACTERS, UNLESS THE SIZE OF THE PART DICTATES SMALLER CHARACTERS. A VIBRATORY TOOL MAY BE USED.
 EXAMPLE: DXXXXXX-VY, TYPE-XX, S/N XXX

REV.	DATE	DCN #	DRAWING TREE #
v1	08/12/2010	E1000318	-
-	-	-	-
-	-	-	-

BAG AND TAG

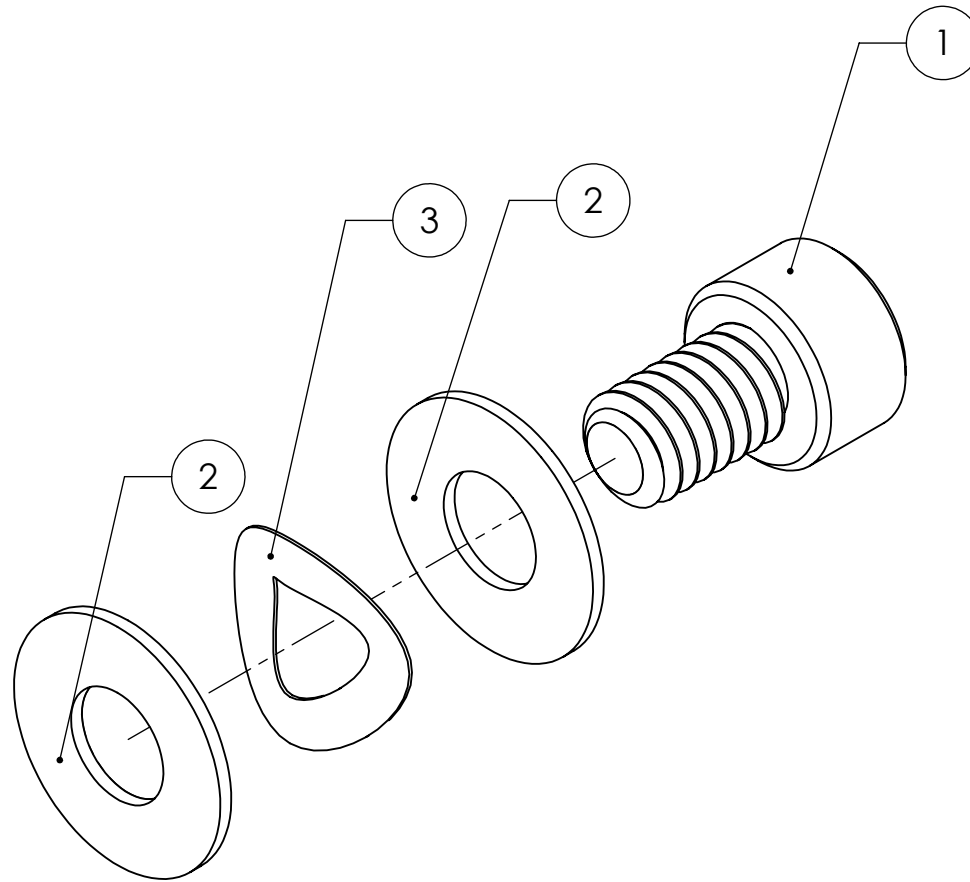

ITEM NO.	PART NUMBER	DESCRIPTION	QTY.
3	9716K36	.174 ID X .322 OD X .005 THK, CURVED DISC SPG., MCMASTER	1
2	98017A625	.170 ID X .38 OD X .02-.04 THK, WASHER, MCMASTER	2
1	92196A190	8-32 X .25 SHCS, MCMASTER	1

DIMENSIONS ARE IN INCHES		NOTES AND TOLERANCES: (UNLESS OTHERWISE SPECIFIED)		CALIFORNIA INSTITUTE OF TECHNOLOGY MASSACHUSETTS INSTITUTE OF TECHNOLOGY		PART NAME																					
TOLERANCES: .XX ± .01 .XXX ± .005		1. INTERPRET DRAWING PER ASME Y14.5-1994. 2. REMOVE ALL SHARP EDGES, R.02 MIN. 3. DO NOT SCALE FROM DRAWING. 4. ALL MACHINING FLUIDS MUST BE FULLY SYNTHETIC, FULLY WATER SOLUBLE AND FREE OF SULFUR, SILICONE, AND CHLORINE.		SYSTEM		LIGO		SUB-SYSTEM		AOS		DESIGNER		K. MAILAND		07/12/2010		SIZE DWG. NO.		B		D1001971		REV.		v1	
ANGULAR ± °		MATERIAL		REF: BOM		FINISH		N/A μinch		NEXT ASSY		D1001600		CHECKER		APPROVAL		SCALE: 4:1		PROJECTION:		SHEET 1 OF 1					

D1001971 qLIGO TMS SLIDE CLAMP LOCK SCREW WASHER ASSY., PART PDM REV: X-013, DRAWING PDM REV: X-008