

~~NOTES CONTINUED:
 5. SCRIBES, ENGRAVE, OR MECHANICALLY STAMP (NO
 DYES OR INKS) A UNIQUE THREE DIGIT SERIAL NUMBER &
 REVISION NUMBER ON EACH PART. SERIAL NUMBERS
 START AT 001 FOR THE FIRST ARTICLE AND PROCEED
 CONSECUTIVELY. BAG AND TAG PARTS WITH THEIR
 DRAWING PART NUMBER, REVISION, VARIANT OR "TYPE"
 (IF APPLICABLE), AND QUANTITY. IF PARTS ARE TOO
 SMALL TO SCRIBE, BAGGING AND TAGGING ALONE IS
 SUFFICIENT. (PART): 001-v1
 EXAMPLE (TAG): DXXXXXX-VY, TYPE-XX, QTY: 10~~

REV.	DATE	DCN #	DRAWING TREE #
v1	-	D1000318	-
-	-	-	-
-	-	-	-

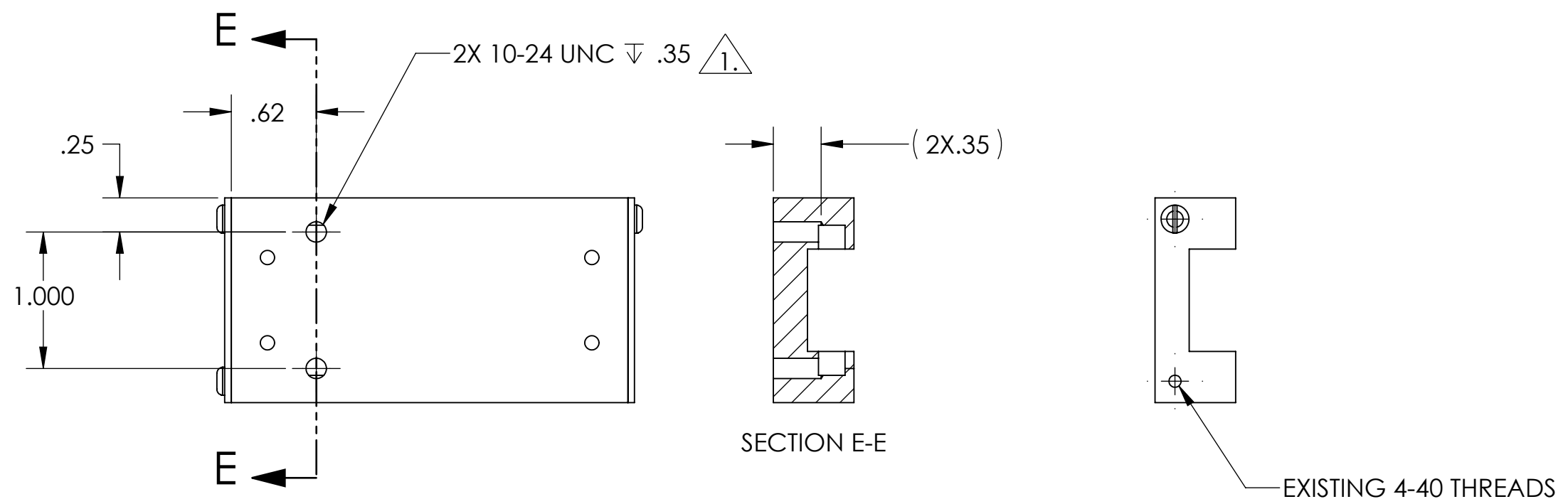
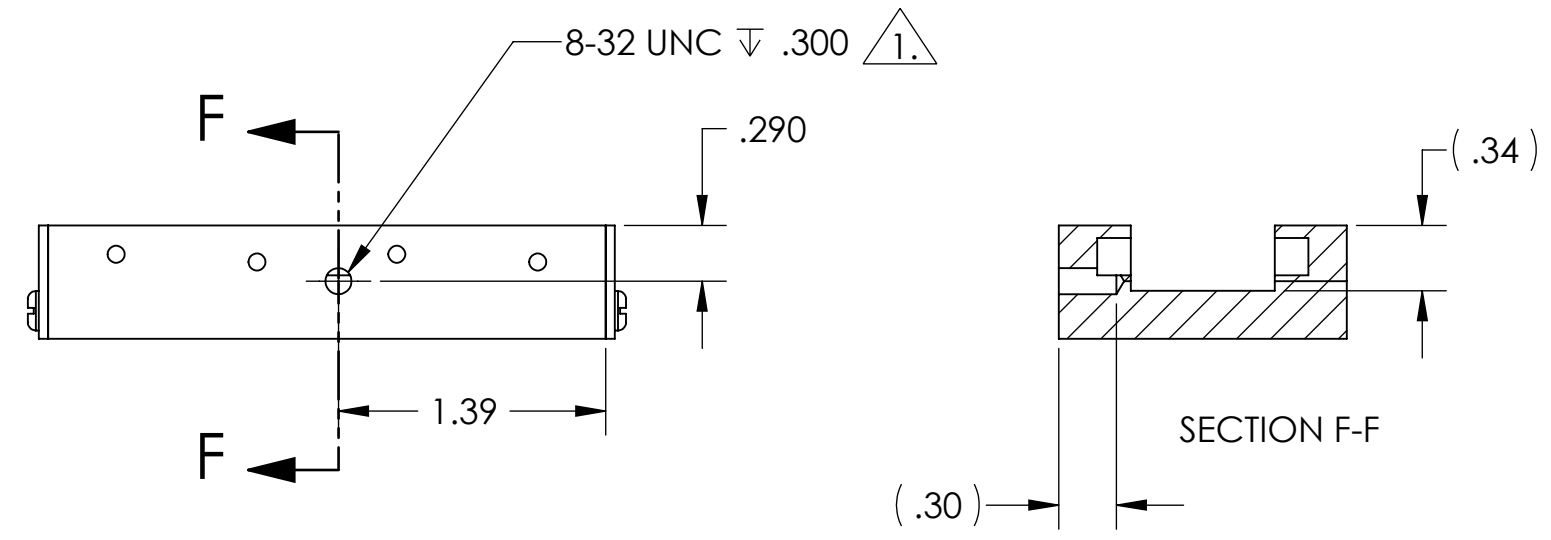
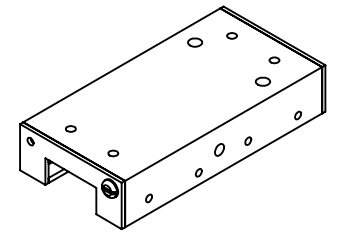

2. MODIFY DEL-TRON RS1-2 CARRIAGE

1. .005 OVERSIZE THREAD.

NOTES AND TOLERANCES: (UNLESS OTHERWISE SPECIFIED)				LIGO CALIFORNIA INSTITUTE OF TECHNOLOGY MASSACHUSETTS INSTITUTE OF TECHNOLOGY		PART NAME	
DIMENSIONS ARE IN INCHES TOLERANCES: .XX ± .10 .XXX ± .005 ANGULAR ± °				1. INTERPRET DRAWING PER ASME Y14.5-1994. 2. REMOVE ALL SHARP EDGES, R.02 MIN. 3. DO NOT SCALE FROM DRAWING. 4. ALL MACHINING FLUIDS MUST BE FULLY SYNTHETIC, FULLY WATER SOLUBLE AND FREE OF SULFUR, SILICONE, AND CHLORINE.		DEL-TRON-RS1-2 FOCUS CARRIAGE	
MATERIAL		FINISH		SYSTEM		SUB-SYSTEM	
RS1-2		N/A μinch		LIGO		AOS	
NEXT ASSY				DESIGNER		DATE	
D1001600				K. Malland		07/17/2010	
APPROVAL				DRAFTER		SIZE	
				M. MILLER		DWG. NO.	
						B D1001952	
				CHECKER		REV.	
						v1	
				APPROVAL		SCALE: 1:1 PROJECTION:	
						SHEET 1 OF 1	

D1001952 CALIGO TMS DEL-TRON RS1-2 FOCUS CARRIAGE, PART PDM REV: X-000, DRAWING PDM REV: X-005