

NOTES CONTINUED:
 ⑤ SCRIBE, ENGRAVE (A VIBRATORY TOOL MAY BE USED), LASER MARK OR MECHANICALLY STAMP (NO INKS OR DYES) DRAWING PART NUMBER (NO INKS OR DYES) DRAWING PART NUMBER, REVISION (AND VARIANT OR TYPE IF APPLICABLE) ON NOTED SURFACE OF PART FOLLOWED ON THE NEXT LINE WITH A THREE DIGIT SERIAL NUMBER. SERIAL NUMBERS START AT 001 FOR THE FIRST ARTICLE AND PROCEED CONSECUTIVELY. USE MINIMUM 0.12" HIGH CHARACTERS, UNLESS THE SIZE OF THE PART DICTATES SMALLER CHARACTERS. EXAMPLE: DXXXXXX-VY, TYPE-XX, S/N-XXX

6. APPROXIMATE WEIGHT = X.XXXX LB.

REV.	DATE	DCN #	DRAWING TREE #
V2	21 JUL 2010	E1000270	
V3	14 SEPT 2010	E1000407	
V4	10 DEC 2010	E1000875	
V5	18 OCT 2011	E1101042	

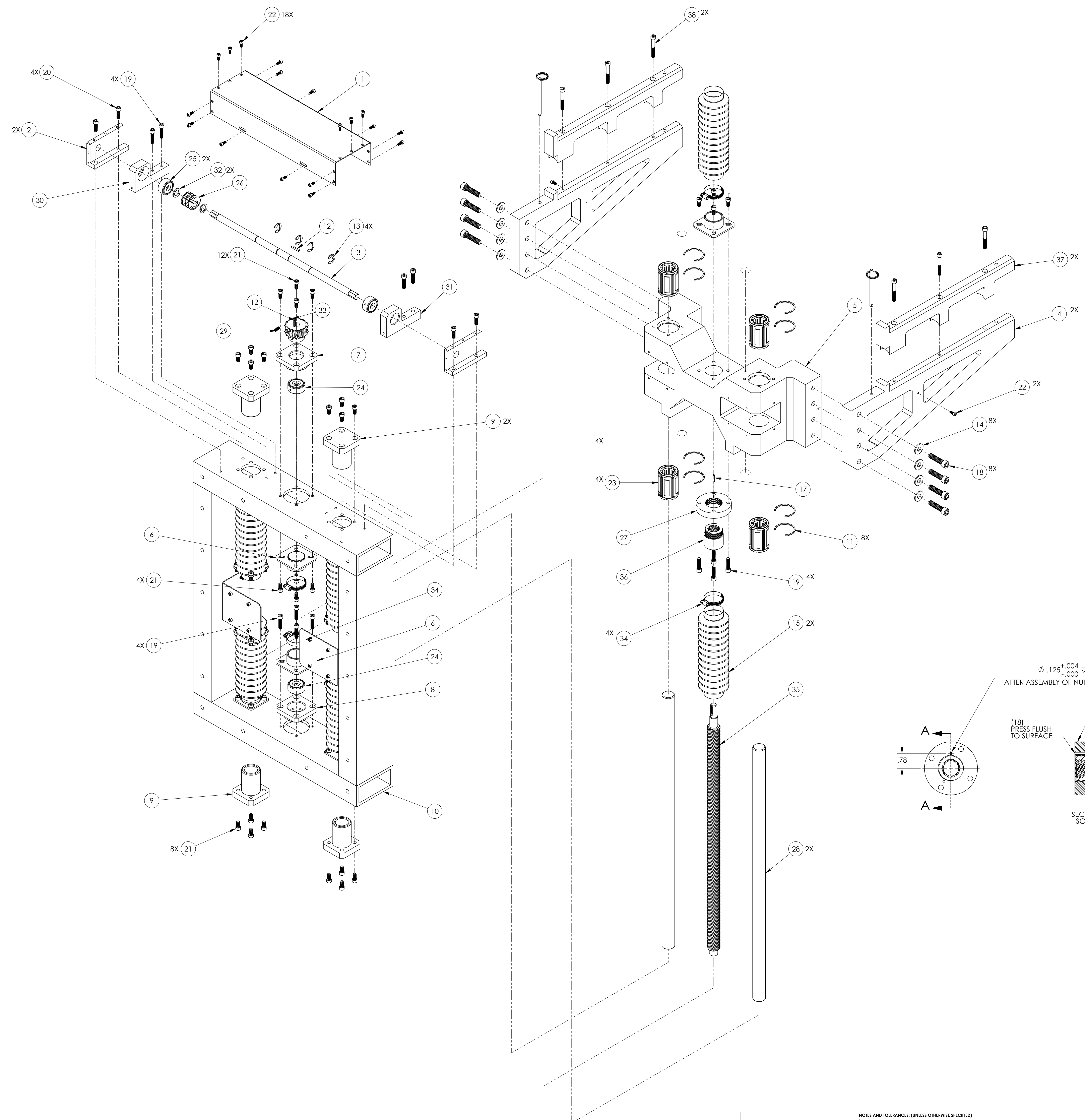

ITEM NO.	PART NUMBER	DESCRIPTION	MATERIAL	REQ	SPARE	TOTAL
40	D1100823	HAM STRUCTURE LIFT SHAFT COVER	5052-H32	2		2
39	D1100818	BELLOWS SUPPORT, HAM STRUCTURE LIFT SHAFT	6061-T6 Al	8		8
38	92200A548	SCREW, SHC, 1/4-20 x 1 3/4, MS16995-55, MC #92200A548	18-8 S316L	6		6
37	D1101053	YOKE ARM EXTENDER, HAM STRUCTURE LIFT	6061-T6 Al	2		2
36	95072A551	NUT, LEAD SCREW, 1"-10 START	Phosphor Bronze 10% D, UNS C55400	1		1
35	D1003174	1"-10 START ACME LEAD SCREW	Plain Carbon Steel	1		1
34	50111261	1 1/2 IN HOSE CLAMP	316 S316L	12		12
33	D1003027	12 PITCH, 20 TOOTH WORM GEAR - MODIFIED	Cast Alloy Steel	1		1
32	7814K14	.50ID X .75OD X .062 THK THRUST WASHER	Commercial Bronze UNS C22000 (Pb-10 Bronze)	2		2
31	D1001777	WORM SHAFT BEARING SUPPORT	6061-T6 Al	1		1
30	D1001777	WORM SHAFT BEARING SUPPORT	6061-T6 Al	1		1
29		10-32 X .50 SET SCREW	Mild steel <not specified>	1		1
28	1144K52	HARDENED PRECISION SHAFT	Alloy Steel	2		2
27	1329K14	FLANGE, LEAD SCREW NUT, HAM STRUCTURE LIFT	300 S316L	1		1
26	5754K527	12 PITCH WORM	Alloy Steel	1		1
25	60715K110	60715K110 THRUST BEARING	AlSi 440C	2		2
24	60715K120	60715K120 THRUST BEARING	AlSi Type A2 Tool Steel	2		2
23	906974	1" ID LINEAR BEARING	AlSi 440C	4		4
22	92200A192	SCREW, SHC, 8-32x 3/8, MS16995-25, MC #92200A192	300 S316L	32		32
21	92200A537	SCREW, SHC, 1/4-20 x 1/2, MS16995-48, MC #92200A537	300 S316L	60		60
20	92200A540	SCREW, SHC, 1/4-20 x 3/4, MS16995-50, MC #92200A540	300 S316L	4		4
19	92200A542	SCREW, SHC, 1/4-20 x 1, MS16995-52, MC #92200A542	300 S316L	12		12
18	92200A684	SCREW, SHC, 3/8-16 x 1 1/2, MS16995-83, MC #92200A684	18-8 S316L	8		8
17	92373A179	.125 X .62LG SLOTTED SPRING PIN	18-8 S316L	1		1
16	94975A185	.25 X 3 QUICK RELEASE PIN WITH LANYARD	18-8 S316L	2		2
15	9741K45	BELLOWS, ULTRA FLEXIBLE, SEALED	POLYURETHANE (11671)	6		6
14	98019A399	WASHER, FLAT, 3/8, MS15795-814, MC #98019A399	18-8 S316L	8		8
13	98408A138	RING, RETAINING, E-STYLE, .50 SHAFT	17-7 PH SS	4		4
12	98870A100	MACHINE KEY	304 S316L	2		2
11	9968K27	EXTERNAL RETAINING RING	316 S316L	8		8
10	D1001768	FRAME, HAM STRUCTURE LIFT	6061-T6 Al	1		1
9	D1001769	GUIDE SHAFT SUPPORT, HAM STRUCTURE LIFT	304 S316L	4		4
8	D1001770	BOTTOM BEARING SUPPORT, HAM STRUCTURE LIFT	6061-T6 Al	1		1
7	D1001771	TOP BEARING SUPPORT, HAM STRUCTURE LIFT	6061-T6 Al	1		1
6	D1001772	BELLOWS SUPPORT, HAM STRUCTURE LIFT	6061-T6 Al	3		3
5	D1001773	YOKE, HAM STRUCTURE LIFT	6061-T6 Al	1		1
4	D1001774	YOKE ARM, HAM STRUCTURE LIFT	6061-T6 Al	2		2
3	D1001776	WORM SHAFT, HAM STRUCTURE LIFT	304 S316L	1		1
2	D1001778	GEAR COVER SUPPORT, HAM STRUCTURE LIFT	6061-T6 Al	2		2
1	D1001779	GEAR COVER, HAM STRUCTURE LIFT	5052-H32	1		1

NOTES AND TOLERANCES: (UNLESS OTHERWISE SPECIFIED)
 1. INTERPRET DRAWING PER ASME Y14.5-1994.
 2. REMOVE ALL SHARP EDGES, R.02 MIN.
 3. DO NOT SCALE FROM DRAWING.
 4. ALL MACHINING FLUIDS MUST BE FULLY SYNTHETIC, FULLY WATER SOLUBLE AND FREE OF SULFUR, SILICONE, AND CHLORINE.

DIMENSIONS ARE IN: .XX ± .XXX ±

ANGULAR ± °

MATERIAL: N/A

FINISH: N/A μinch

CAUTION: CALIFORNIA INSTITUTE OF TECHNOLOGY MASSACHUSETTS INSTITUTE OF TECHNOLOGY

SYSTEM: ADVANCED LIGO SUB-SYSTEM: SUS

PART NAME: HAM STRUCTURE LIFT ASSEMBLY

DESIGNER: K. BUCKLAND 8 APR 2010 SIZE: DWG. NO. E D1001664

DRAFTER: K. BUCKLAND 29 JUN 2010

CHECKER: APPROVAL:

SCALE: 1:3 PROJECTION: SHEET 1 OF 1

D:\01064\HAM STRUCTURE LIFT ASSEMBLY - 05030101 - PART PN:REV.5.G4 - DRAWING PDR:REV.6.014