

D1001083\_ISC\_TRANSMON\_HI\_POWER\_BEAM\_DUMP\_SiC, PART PDM REV: X-006, DRAWING PDM REV:

8 7 6 5 4 3 2 1

NOTES CONTINUED:

- 5. AVOID DINGS AND SCRATCHES
- 6. APPROXIMATE WEIGHT = X.XXX LB.
- 7. MACHINE ALL SURFACES TO REMOVE OXIDES AND MILL FINISH.
- 8. ALL PARTS SHALL BE MANUFACTURED IN ACCORDANCE WITH LIGO SPECIFICATION E0900364.

REV.	DATE	DCN #	DRAWING TREE #
-	-	-	-
-	-	-	-
-	-	-	-

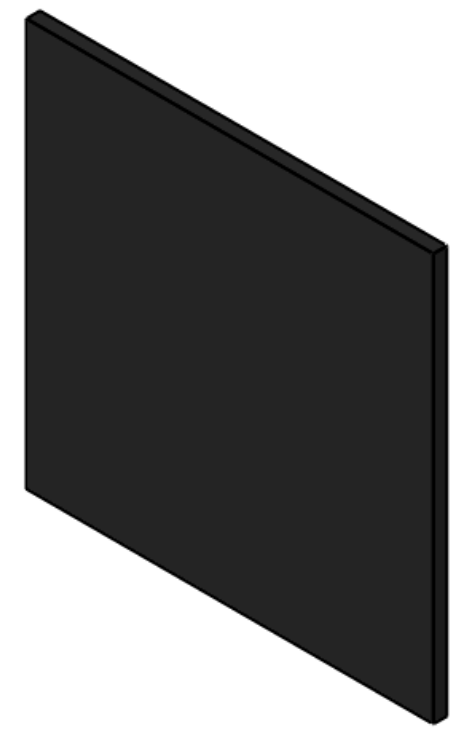
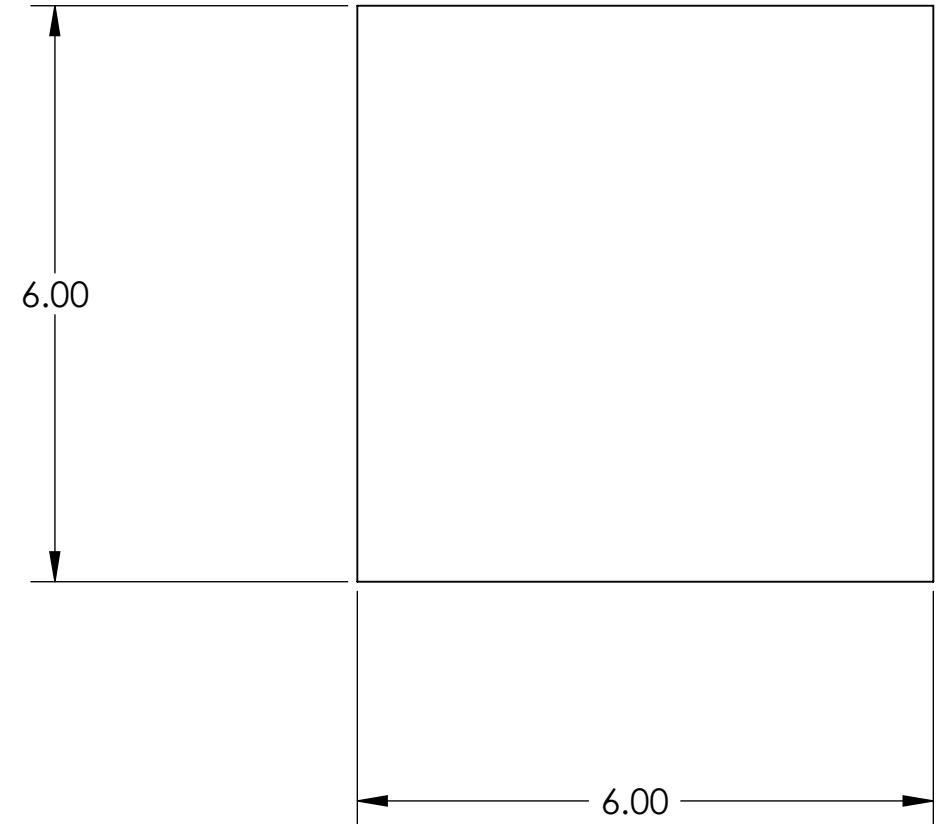
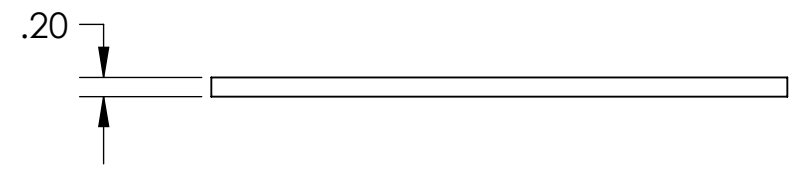

DIMENSIONS ARE IN TOLERANCES: .XX ± .01 .XXX ± .005 ANGULAR ± °		<b>NOTES AND TOLERANCES: (UNLESS OTHERWISE SPECIFIED)</b> 1. INTERPRET DRAWING PER ASME Y14.5-1994. 2. REMOVE ALL SHARP EDGES, R.02 MIN. 3. DO NOT SCALE FROM DRAWING. 4. ALL MACHINING FLUIDS MUST BE FULLY SYNTHETIC, FULLY WATER SOLUBLE AND FREE OF SULFUR, SILICONE, AND CHLORINE.		CALIFORNIA INSTITUTE OF TECHNOLOGY MASSACHUSETTS INSTITUTE OF TECHNOLOGY		PART NAME <b>TRANSMON HI POWER BEAM DUMP - SiC</b>	
<b>MATERIAL</b> Silicon Carbide		<b>FINISH</b> 32 μinch		<b>SYSTEM</b> Advanced LIGO		<b>SUB-SYSTEM</b> ISC	
<b>DESIGNER</b> Fishner		<b>DRAPER</b> Foley		<b>DATE</b> 9/9/2011		<b>SIZE DWG. NO.</b> <b>B D1001083</b>	
<b>CHECKER</b> (blank)		<b>APPROVAL</b> (blank)		<b>SCALE:</b> 1:2		<b>PROJECTION:</b>	
<b>REVISION</b> V1		<b>NEXT ASSY</b> D1001076		<b>SHEET</b> 1 OF 1		<b>REV.</b>	

8 7 6 5 4 3 2 1