

D1001009\_AdlIGO\_AOS\_SLC\_ARM Cavity Baffle Lo Tube, PART PDM REV: X-021, DRAWING PDM REV: X-019

8 7 6 5 4 3 2 1

NOTES CONTINUED:

- 5 SCRIBE, ENGRAVE (A VIBRATORY TOOL MAY BE USED), LASER MARK OR MECHANICALLY STAMP (NO INKS OR DYES) DRAWING PART NUMBER, REVISION (AND VARIANT OR "TYPE" IF APPLICABLE) ON NOTED SURFACE PART FOLLOWED ON THE NEXT LINE WITH A THREE DIGIT SERIAL NUMBER. SERIAL NUMBERS START AT 001 FOR THE FIRST ARTICLE AND PROCEED CONSECUTIVELY. USE MINIMUM 0.12" HIGH CHARACTERS, UNLESS THE SIZE OF THE PART DICTATES SMALLER CHARACTERS.
- EXAMPLE: DXXXXX-VY, TYPE-XX, S/N XXX
- 6. APPROXIMATE WEIGHT=0.397 LB.
- 7. ALL PARTS SHALL BE MANUFACTURED IN ACCORDANCE WITH LIGO SPECIFICATION E0900364.
- 8. ALL MATERIAL IS TO BE VIRGIN MATERIAL (i.e. NO WELD REPAIRS, PLUGS OR RECYCLED MATERIAL). NO REPAIRS SHALL BE MADE UNLESS APPROVED IN ADVANCE, AND IN WRITING, BY LIGO LABORATORY. REFER TO LIGO-E0900364.
- 9 ELECTROPOLISH PER E0900364, SECTION 5.2.1.2, TO REMOVE ALL SURFACE OXIDES AND POTENTIALLY EMBEDDED CONTAMINANTS.

| REV. | DATE        | DCN #    | DRAWING TREE # |
|------|-------------|----------|----------------|
| v1   | 20 AUG 2010 | E1000285 |                |
| v2   | 23 MAR 2011 | E1100216 |                |

D

D

C

C

B

B

A

A

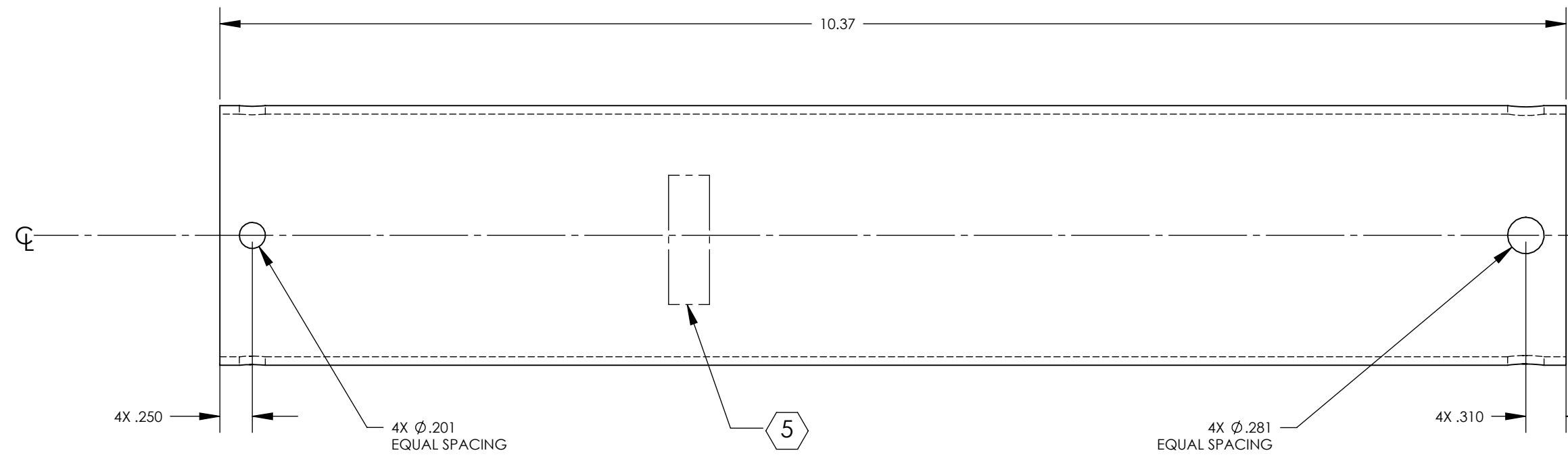
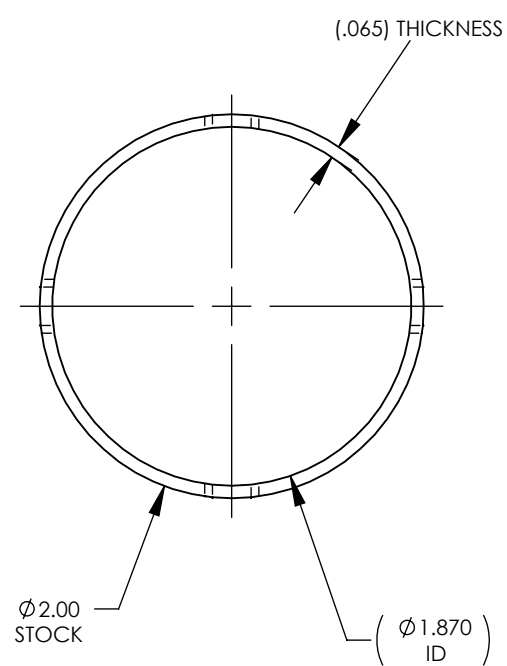
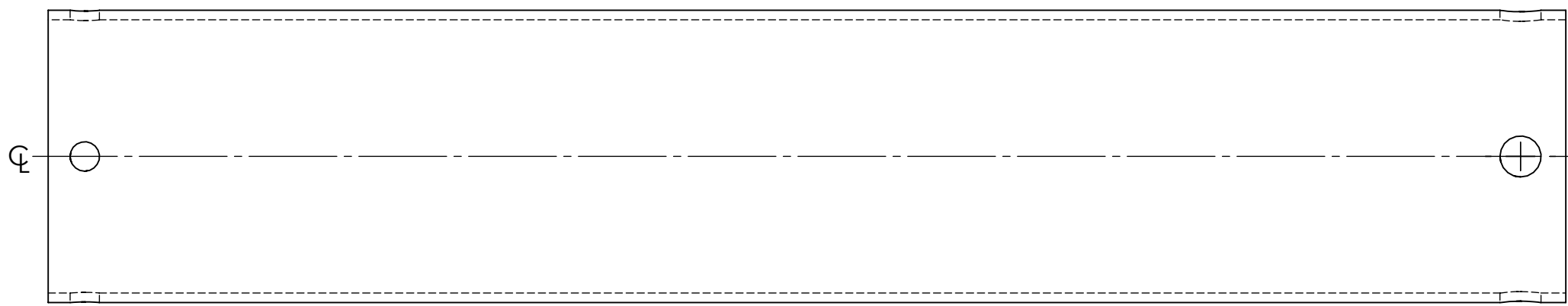

NOTES AND TOLERANCES: (UNLESS OTHERWISE SPECIFIED)

DIMENSIONS ARE IN INCHES  
 TOLERANCES:  
 .XX ± .03  
 .XXX ± .010  
 ANGULAR ± 1.0°

1. INTERPRET DRAWING PER ASME Y14.5-1994.  
 2. REMOVE ALL SHARP EDGES 0.005" TO 0.015".  
 3. DO NOT SCALE FROM DRAWING.  
 4. ALL MACHINING FLUIDS MUST BE FULLY SYNTHETIC, FULLY WATER SOLUBLE AND FREE OF SULFUR, SILICONE, AND CHLORINE REFER TO LIGO E0900237 FOR LIST OF APPROVED COOLANTS.

MATERIAL 6061-T6 Al FINISH 9

|   |            |                           |                                      |
|---|------------|---------------------------|--------------------------------------|
| CALIFORNIA INSTITUTE OF TECHNOLOGY<br>MASSACHUSETTS INSTITUTE OF TECHNOLOGY |            | PART NAME                 |                                      |
| SYSTEM ADVANCED LIGO SUB-SYSTEM AOS   |            | ARM CAVITY BAFFLE LO TUBE |                                      |
| DESIGNER  | N.Nguyen   | 10 AUG 2010               | SIZE DWG. NO.                        |
| DRAFTER   | TQ. NGUYEN | 25 MAY 2010               | B D1001009                           |
| CHECKER   | M. SMITH   | 20 AUG 2010               | REV. v2                              |
| APPROVAL  | D. COYNE   | 30 AUG 2010               | SCALE: 1:1 PROJECTION:  SHEET 1 OF 1 |

8 7 6 5 4 3 2 1