

NOTES CONTINUED:
 ① SCREWS MUST BE OXIDIZED BY MEANS OF AIR FURNACE.

REV.	DATE	DCN #	DRAWING TREE #
v1	07 APR 2011	E1100216	E1000668
v2	18 Aug. 2011	E1100216	E1000668
v3	28 SEP 2011	E1100335	E1000668
v4	18 Oct. 2011	E1100335	E1000668

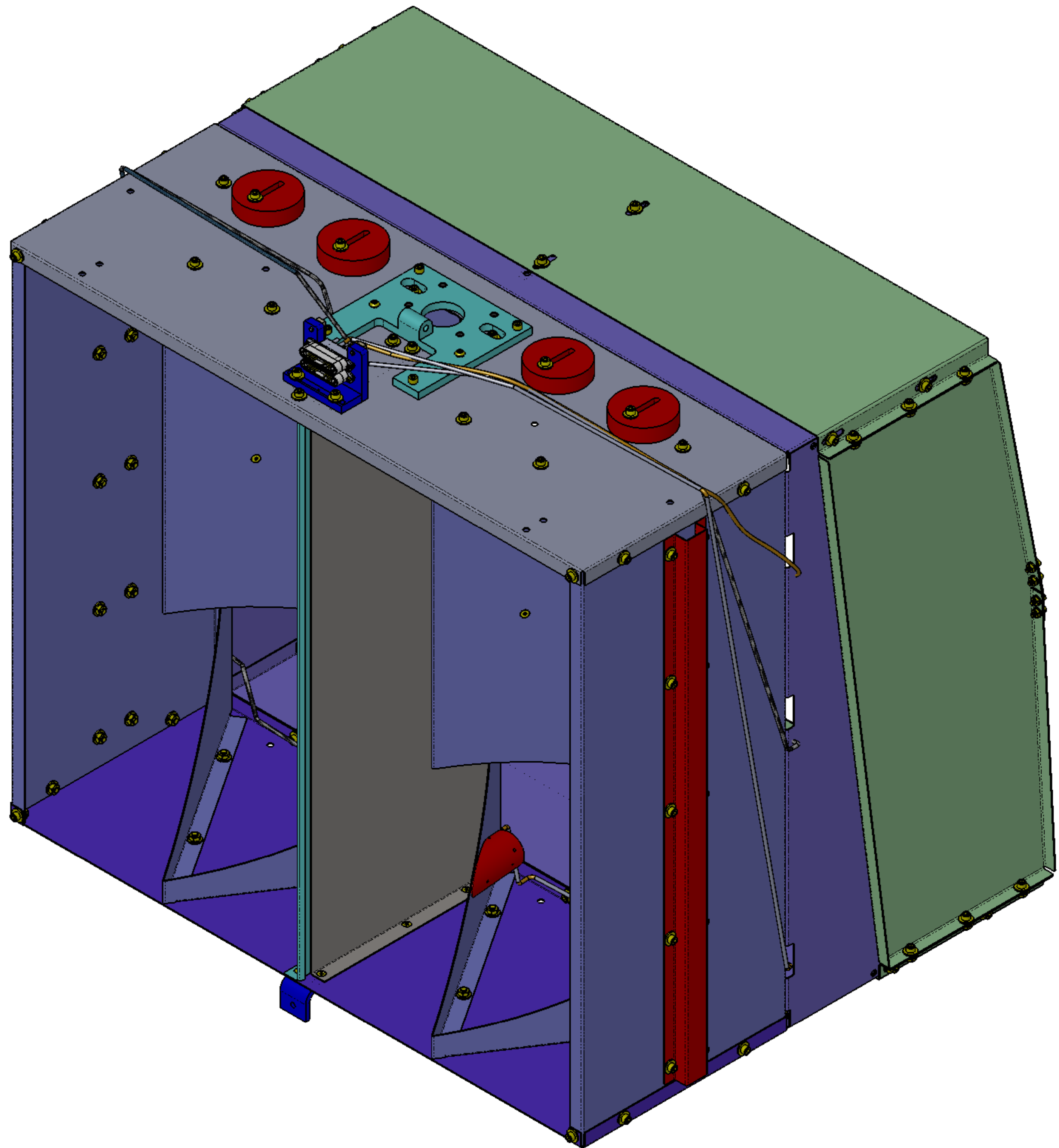

ITEM NO.	PART NUMBER	DESCRIPTION	MATERIAL	BSC8-H2 48mm/QTY.
36	F402-003C	HALF CLIP, 3/16"	SSTL	AR
35	F442-003C	J-CLIP, 3/8"	SSTL	AR
34	92196A114	SHCS 4-40 x 7/8" L	18-8 SSTL	4
33	92200A541	SHCS, .25-20 x .88, 300 SSTL, MS16995-51	300 SSTL	2
32	92200A544	SCREW, SHC, .25-20 X 1.25 LG., MS16995-53	300 SSTL	4
31	98019A330	WASHER #10, NASM 15795-808	300 SSTL	34
① 30	FA-606-NA	FHSC, 6-32 X 3/8 LG, AG PLATED	18-8 SSTL	24
29	92200A242	McMASTER, SOCKET HEAD CAP SCREW, 10-24 X .50 LG, MS 16995-36 (OR EQUIV)	300 SSTL	8
28	BU-2012-N	SCREW, BUTTON HD, SOC, .25-20 X 3/4" LG.	18-8 SSTL	2
① 27	94518A418	FHSC, 10-24 X 3/4 LG, MS24671-22 (OR EQUIV.)	300 SSTL	18
26	92200A540	SHCS, 1/4-20 X 3/4" LG, MS16995-50 (OR EQUIV)	18-8 SSTL	4
25	N-1024-A	HEX NUT, #10-24, AG PLATED,(OR EQUIVALENT)	18-8 SSTL	26
24	98019A355	WASHER FLAT, 1/4" MIL-15795-810	300 SSTL	200
23	C-2008-NA	SHCS, 1/4-20 x .50 AG PLATED	18-8 SSTL	12
22	C-2008-N	SCREW SHCS, 1/4-20 UNC-2A X 1/2" LG, FULL THREAD	300 SSTL	85
21	N-2520-A	U-C COMP. NUT, HEX .25-20 SILVER PLATED, 18-8 SSTL	18-8 SSTL	97
20	D1100391	ACB SHELF ASSY	N/A	1
19	D1003013	ARM CAVITY BAFFLE PD ASSY	N/A	8
18	D1003111	SLC PHOTODETECTOR CABLE LOWER ASSY	N/A	2
17	D1003025	PD HOUSING	304 SSTL	8
16	D1101427	BRACE, LIFTING, ARM CAVITY BAFFLE	6061-T6 Al	1
15	D1002173	ARM CAVITY BAFFLE HINGE ASSY	N/A	1
14	D1001826	SLC ACB BALANCING WEIGHT	304 SSTL	4
13	D1100353	ACB LEFT SIDE EXTENDER	18 GAUGE 304 SSTL	1
12	D1100458	SLC ACB BOTTOM EXTENDER	18 GAUGE 304 SSTL	1
11	D1100354	ACB RIGHT SIDE EXTENDER	18 GAUGE, 304 SSTL	1
10	D1100288	SLC ACB TOP EXTENDER	18 GAUGE 304 SSTL	1
9	D1001346-1	αLIGO, ASSY, CABLE BRACKET, HAM TABLE	N/A	1
8	D1101234	ACB STIFFENER SIDE EXTENDER	6061-T6 Al	2
7	D1101796	ARM CAVITY BAFFLE CTR, MIRROR SKIN	18 GAUGE, 304 SSTL	1
6	D1001363	ACB SIDE REINFORCING HATSECTION	304 SSTL	2
5	D1001365	ARM BAFFLE MIDDLE REINFORCING PLATE	18 GAUGE 304 SSTL	2
4	D1000976	ARM CAVITY BAFFLE CTR SKIN	18 GAUGE 304 SSTL	1
3	D1000974	ARM CAVITY BAFFLE TOP SKIN	18 GAUGE 304 SSTL	1
2	D1000975	ARM CAVITY BAFFLE BTM SKIN	18 GAUGE 304 SSTL	1
1	D1000973	ARM CAVITY BAFFLE SKIN	18 GAUGE, 304 SSTL	1

NOTES AND TOLERANCES: (UNLESS OTHERWISE SPECIFIED)

DIMENSIONS ARE IN INCHES
 TOLERANCES:
 .XX ± N/A
 .XXX ± N/A
 ANGULAR ± N/A °

CALIFORNIA INSTITUTE OF TECHNOLOGY MASSACHUSETTS INSTITUTE OF TECHNOLOGY		PART NAME ARM CAVITY BAFFLE BOX ASSY	
SYSTEM ADVANCED LIGO	SUB-SYSTEM AOS	DESIGNER N.Nguyen	DATE 01 Jun 2010
CHECKER M. Smith	DATE 10 NOV 2010	SIZE D	DWG. NO. D1000977
APPROVAL D. Coyne	DATE 20 NOV 2010	SCALE 1:3	PROJECTION
MATERIAL BOM	FINISH N/A	NEXT ASSY D0901376	REV. v4

D1000977_AduLIGO_AOS_SLC_ARM_Cavity_Baffle_Box Assy, PART PDM REV: X-242, DRAWING PDM REV: X-256

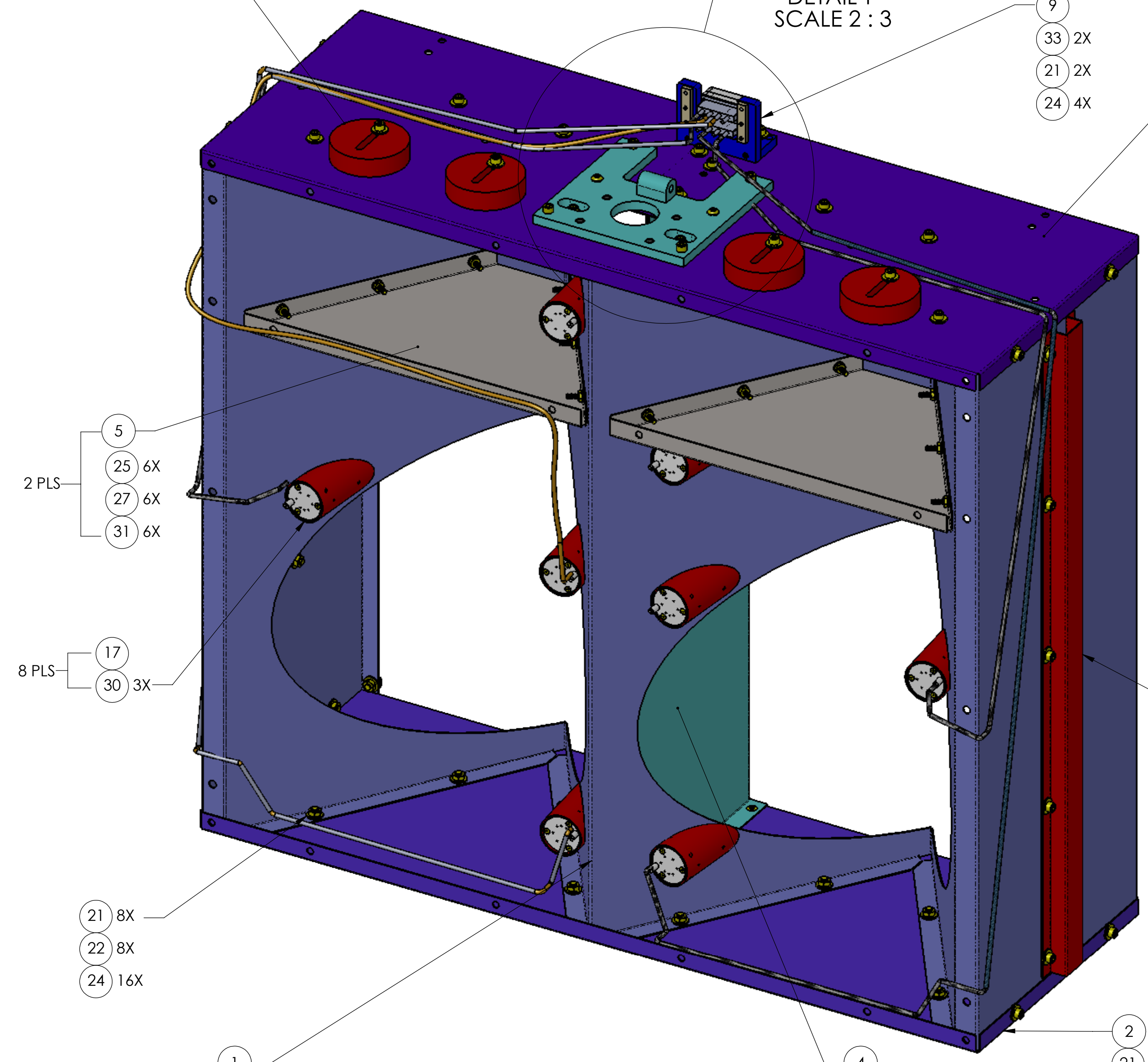
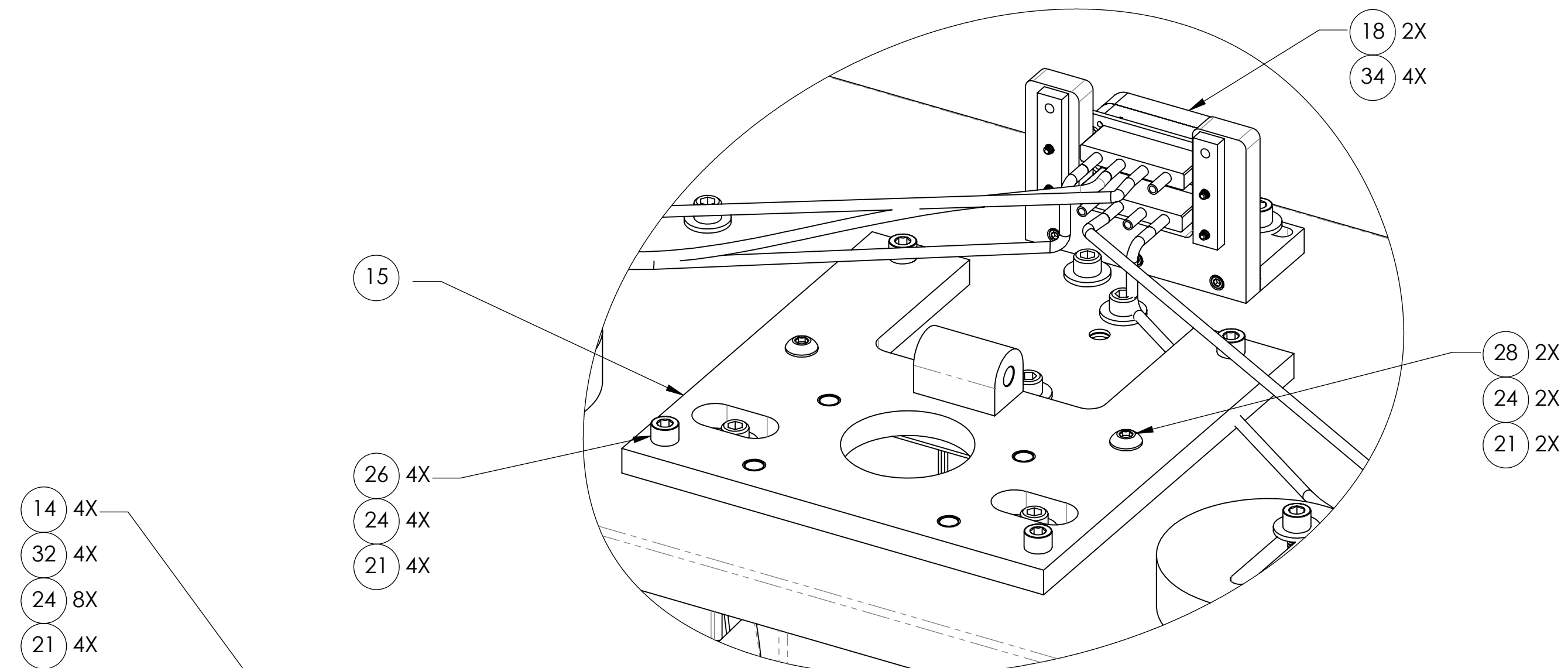

ASSEMBLY STEP 1

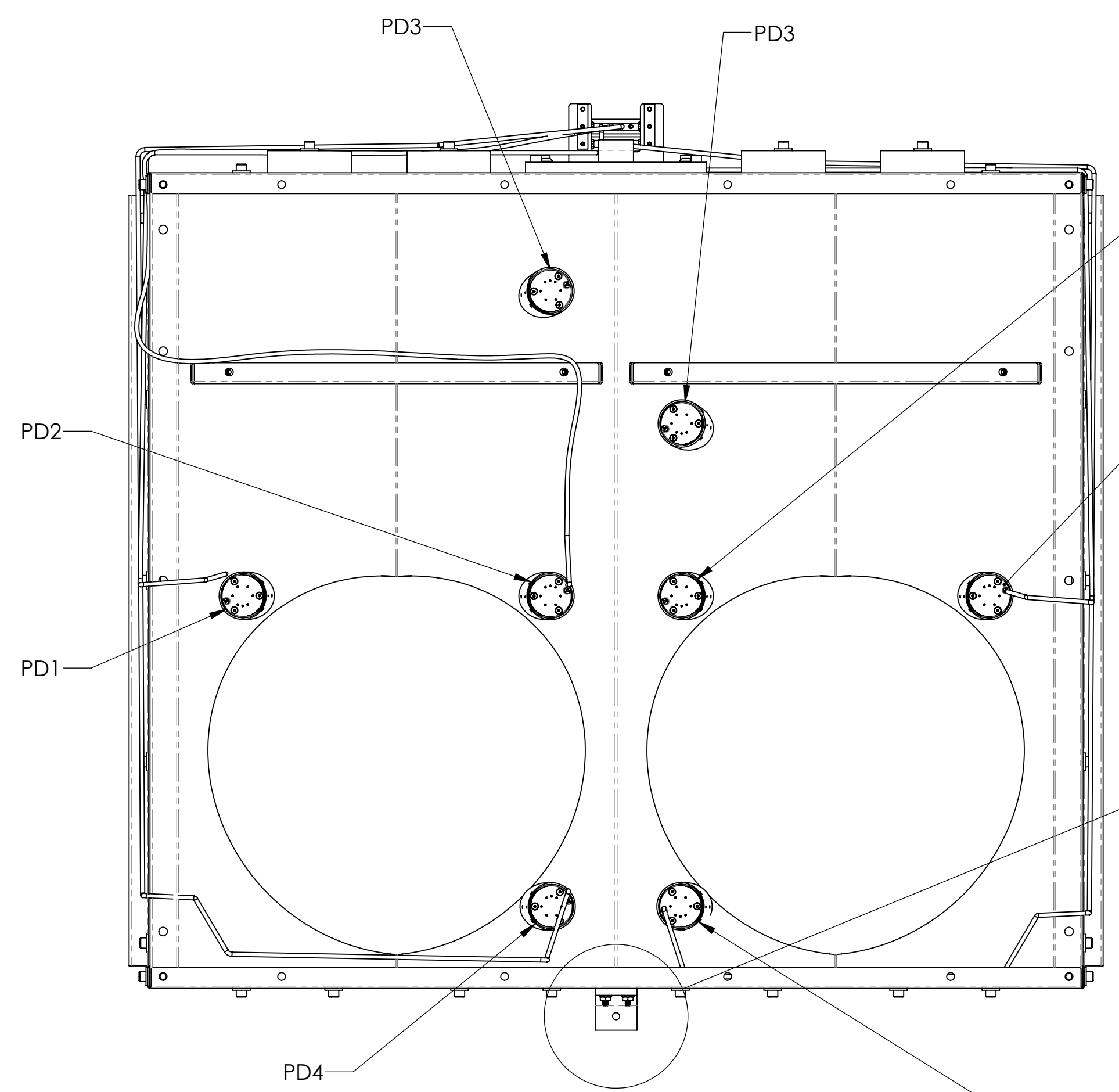

INSTALL ITEMS 5 AND 8 PRIOR TO INSTALLING ITEM 3
INSTALL ITEM 10 (BRACE ALSO)

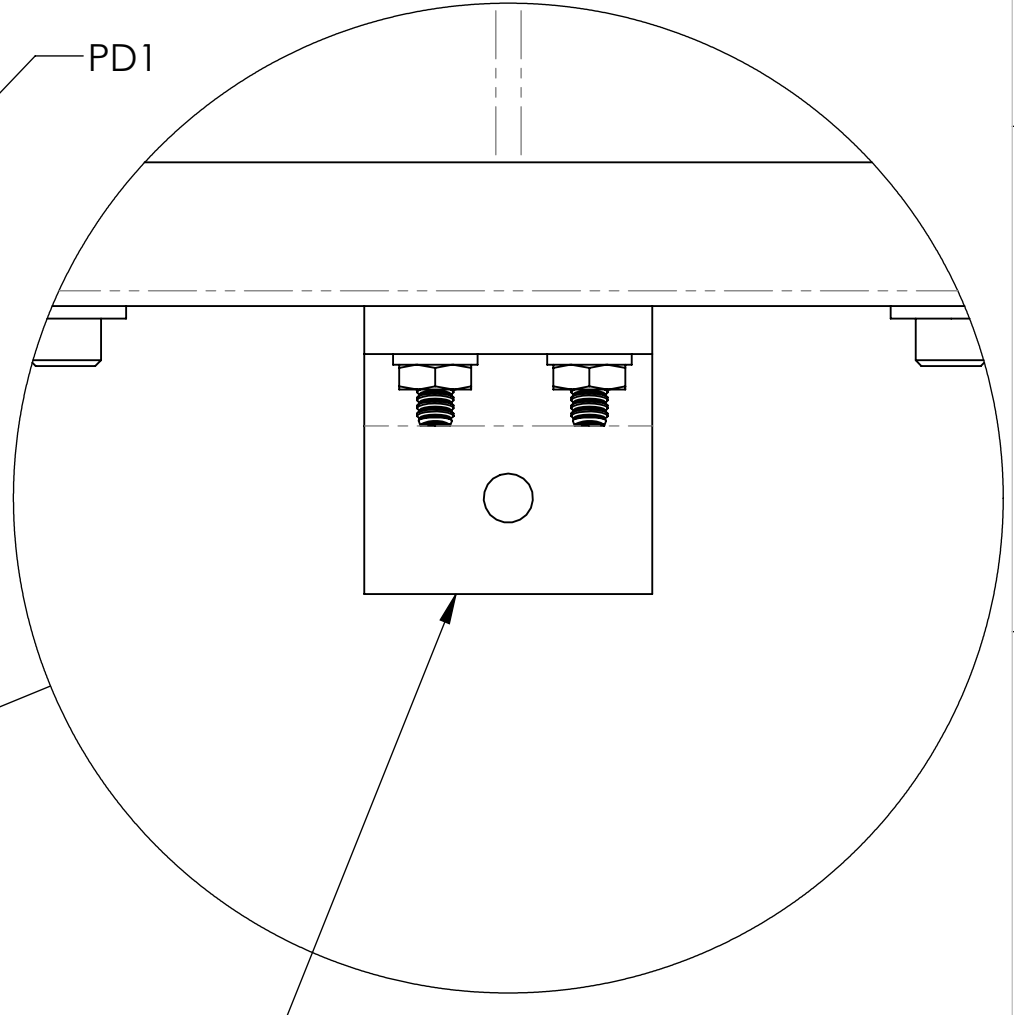

**DETAIL R
SCALE 1:1**

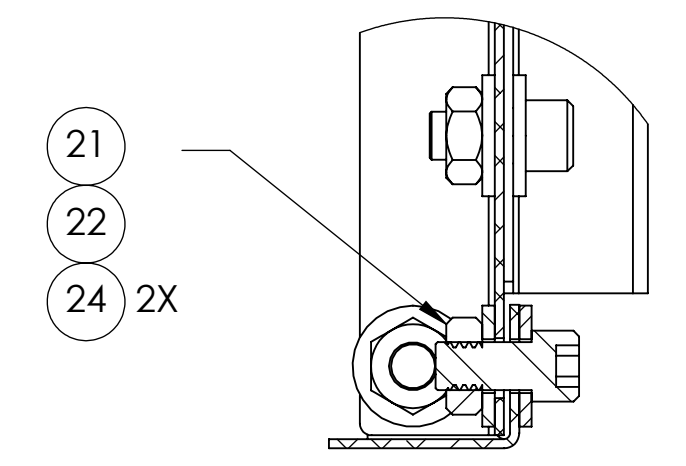
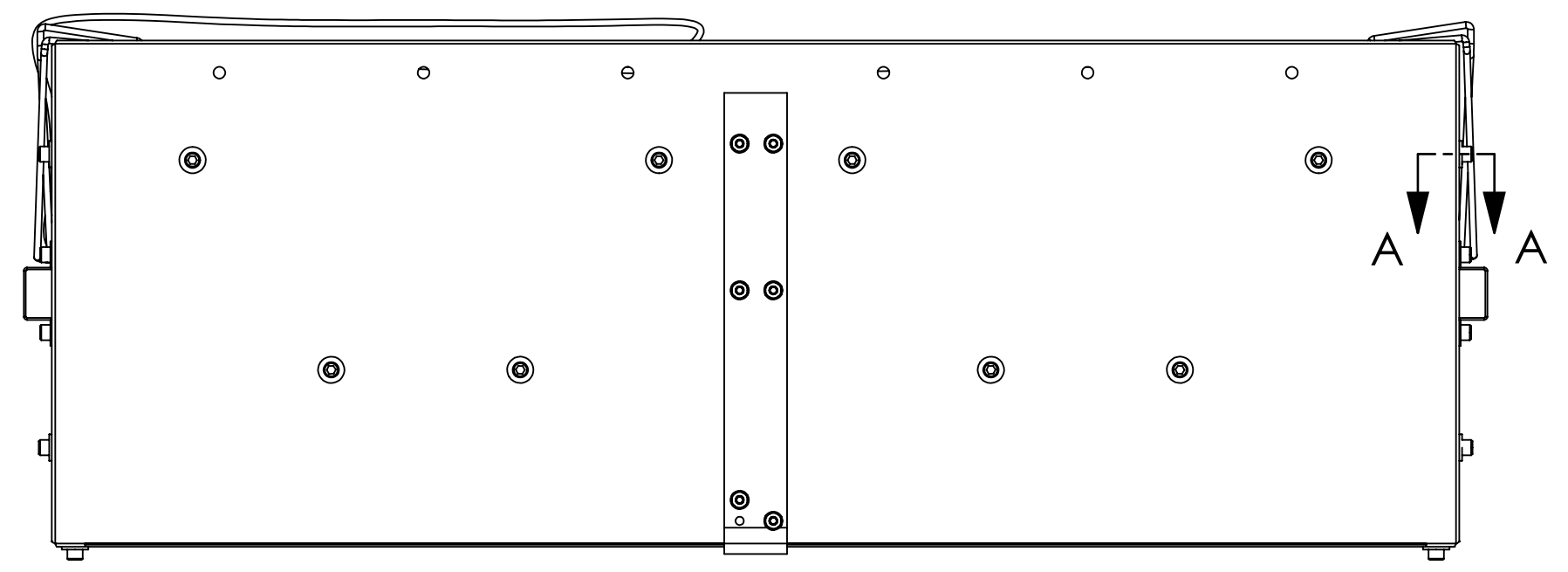

**DETAIL A
SCALE 1:1
(TYPICAL FASTENER ASSEMBLY)**

LIGO CALIFORNIA INSTITUTE OF TECHNOLOGY MASSACHUSETTS INSTITUTE OF TECHNOLOGY		REV.
SIZE DWG. NO.	D1000977	v4
SCALE: 1:3	PROJECTION:	SHEET 2 OF 5

8 7 6 5 4 3 2 1

H G F E D C B A

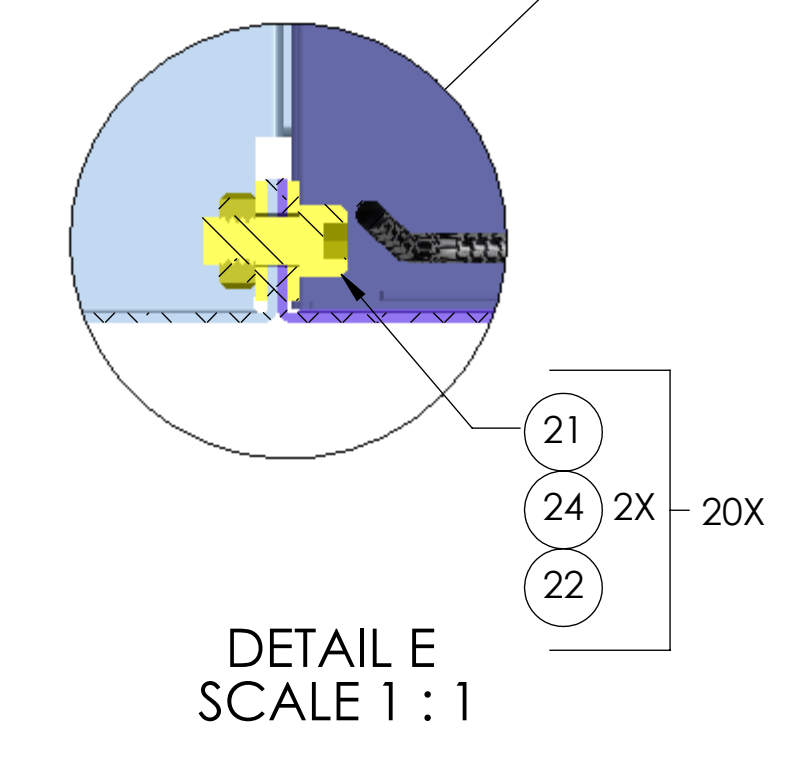
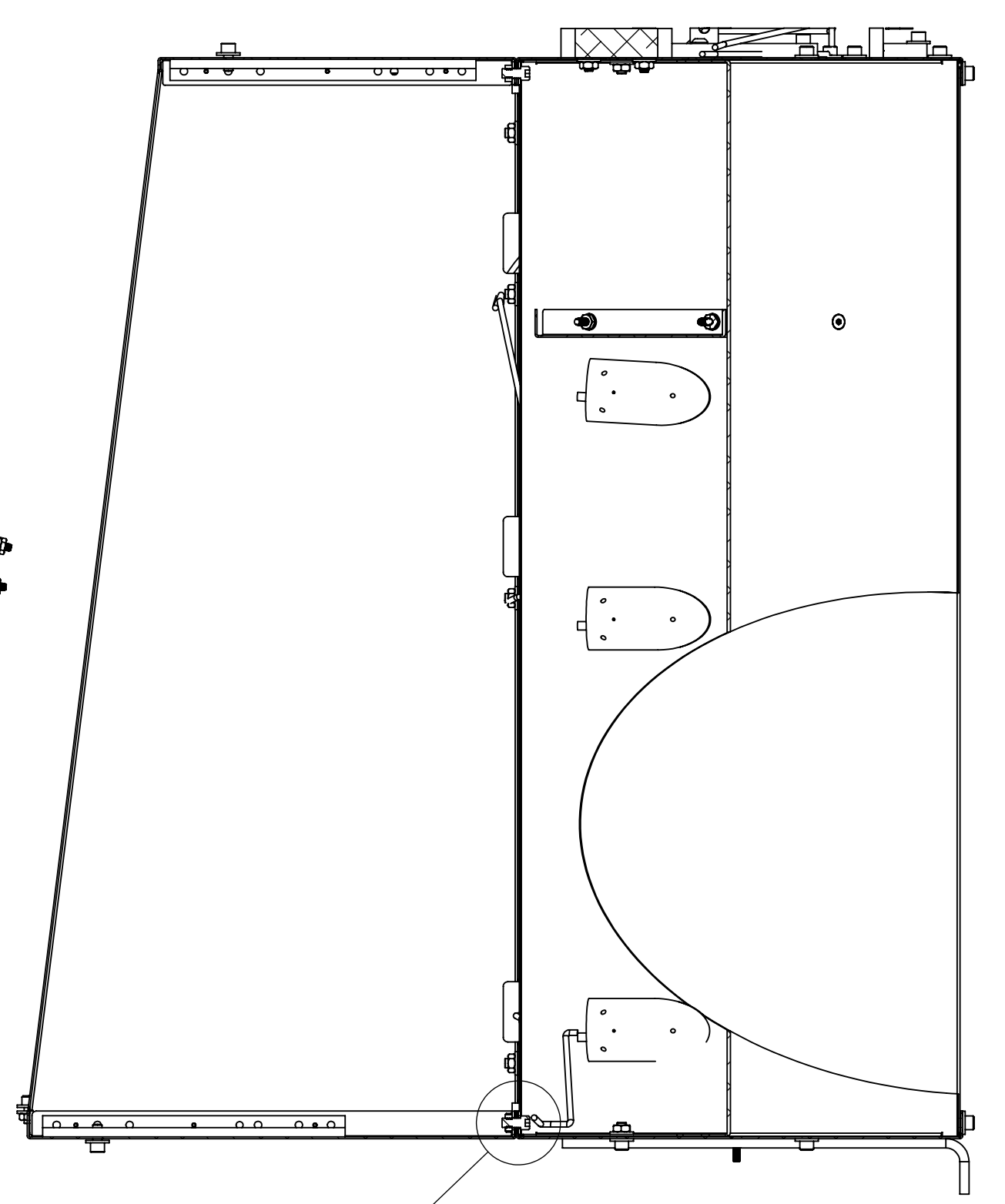
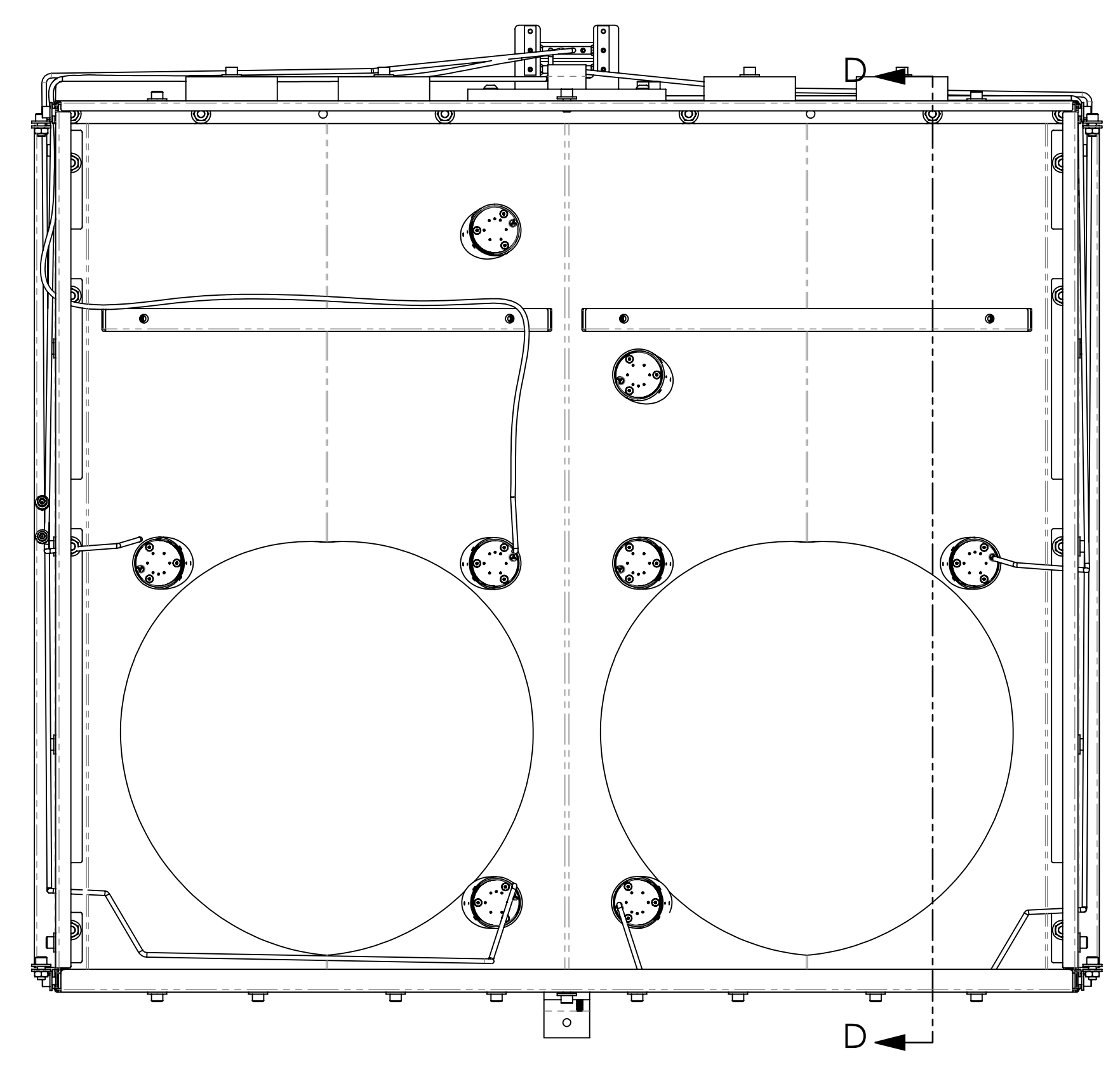
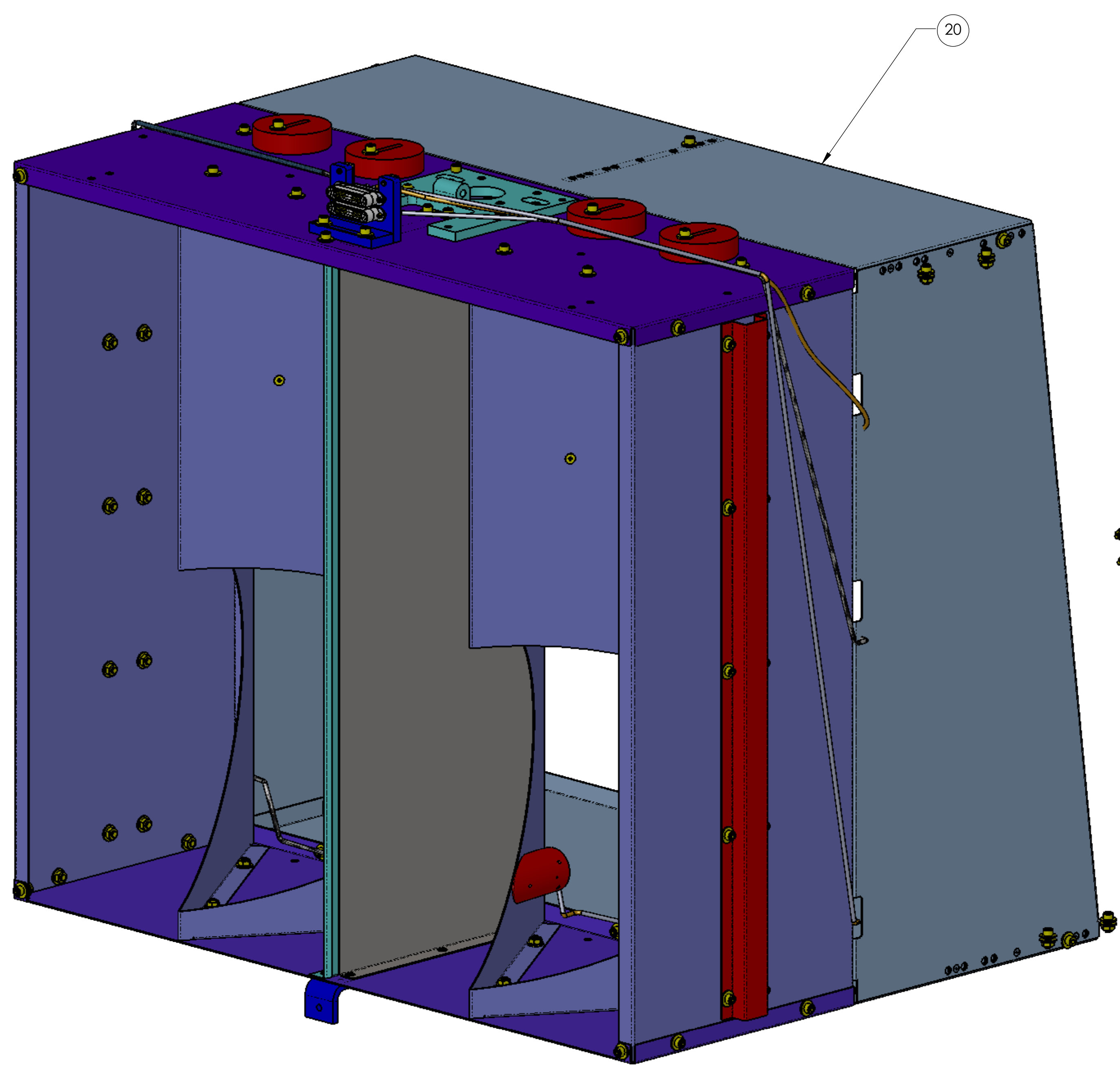

ASSEMBLY STEP 2

LIGO CALIFORNIA INSTITUTE OF TECHNOLOGY MASSACHUSETTS INSTITUTE OF TECHNOLOGY		REV.
SIZE DWG. NO.	D1000977	v4
SCALE: 1:3	PROJECTION:	SHEET 3 OF 5

D1000977_AduIGO_AOS_SLC_ARM_Covilly_Bottle_Box_Asly_PART_PDM_REV_X-202_DRAWING_PDM_REV_X-056

8 7 6 5 4 3 2 1

H G F E D C B A

8 7 6 5 4 3 2 1

H
G
F
E
D
C
B
A

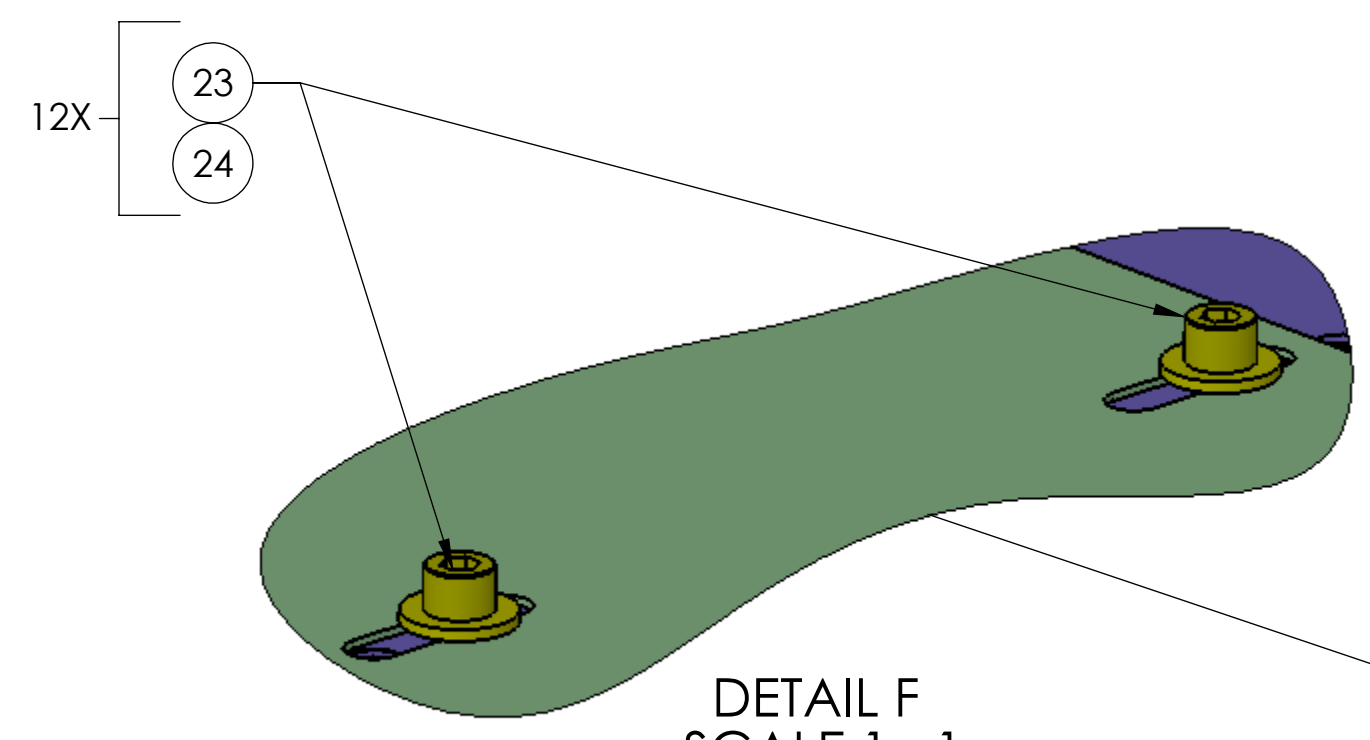

DETAIL F
SCALE 1 : 1
(TOP AND BOTTOM SHOWN)

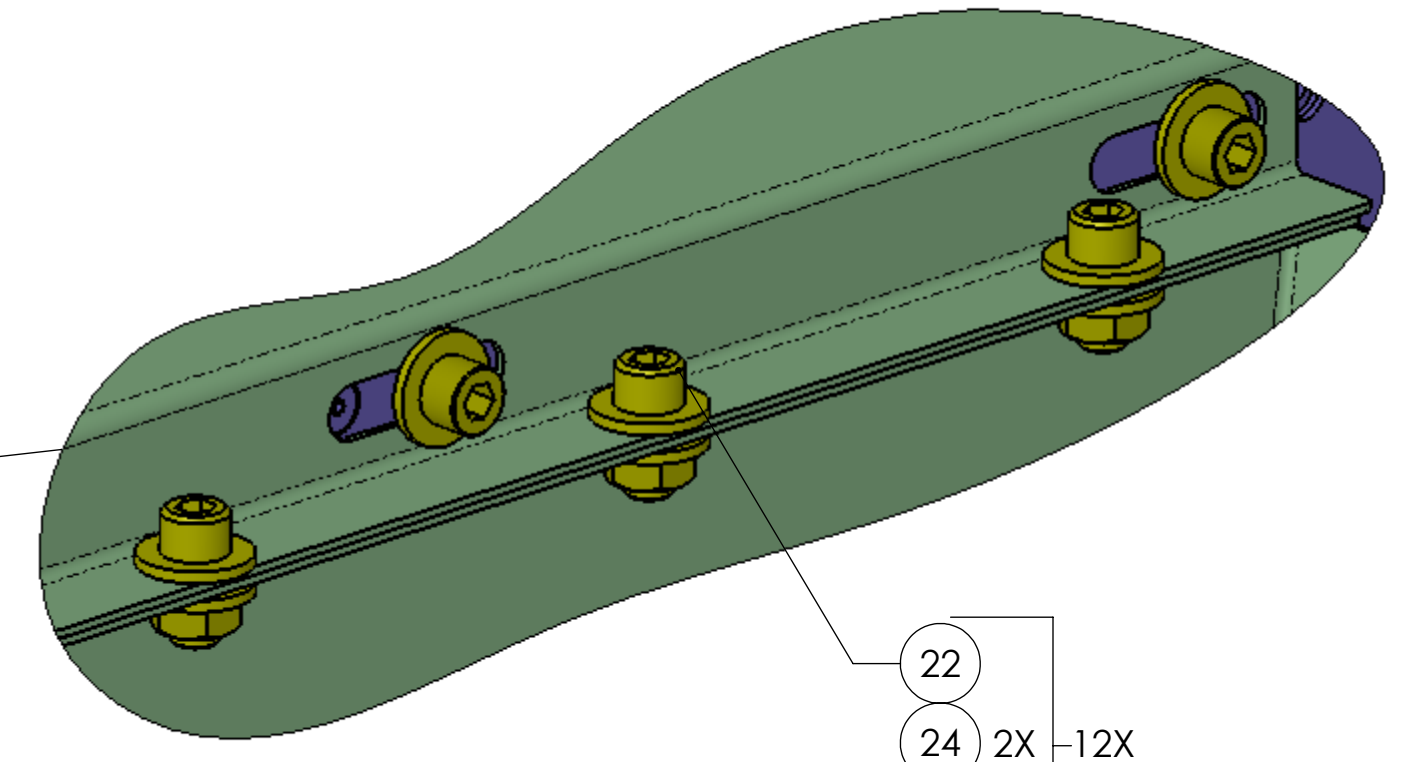
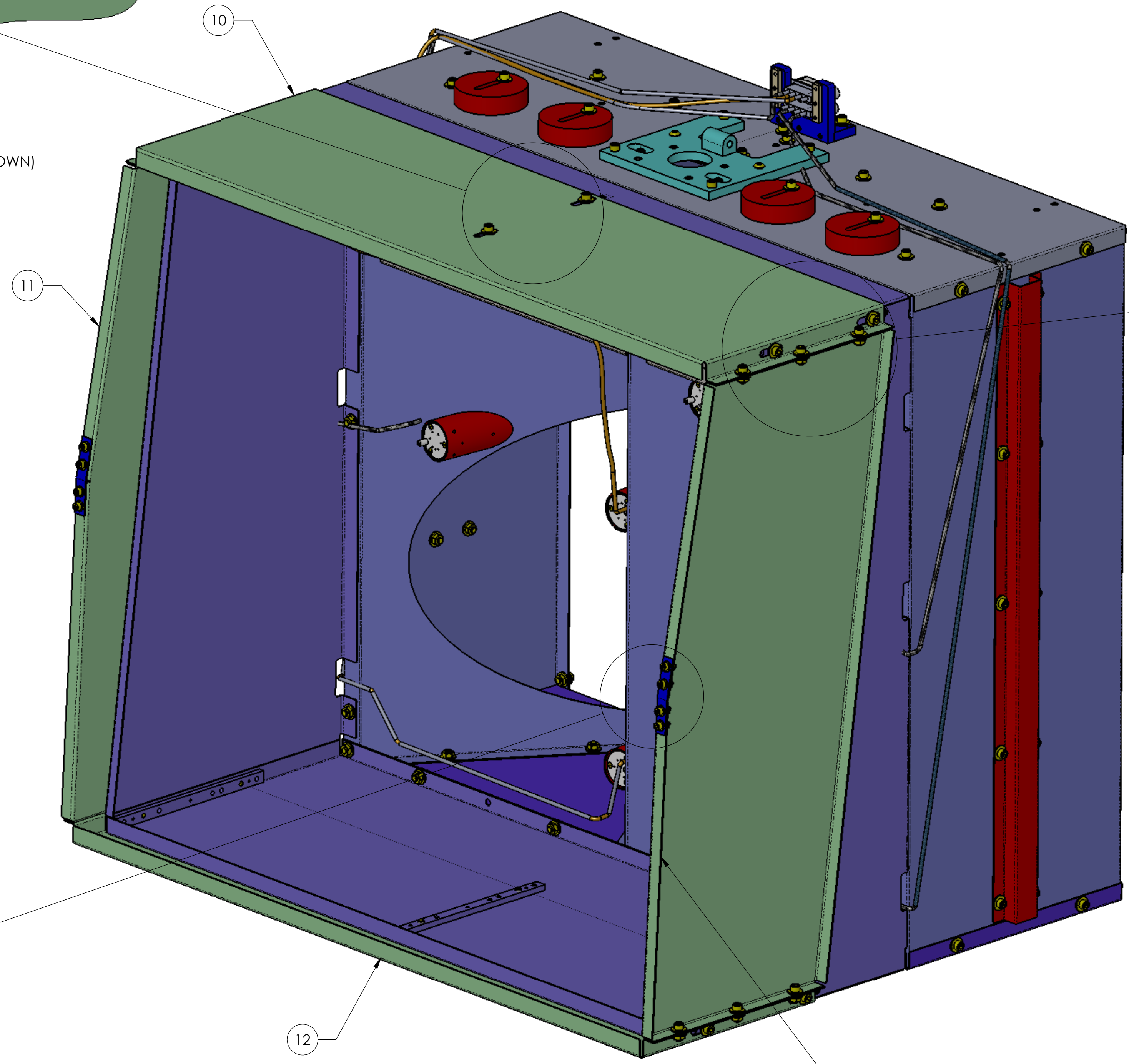

DETAIL G
SCALE 1 : 1

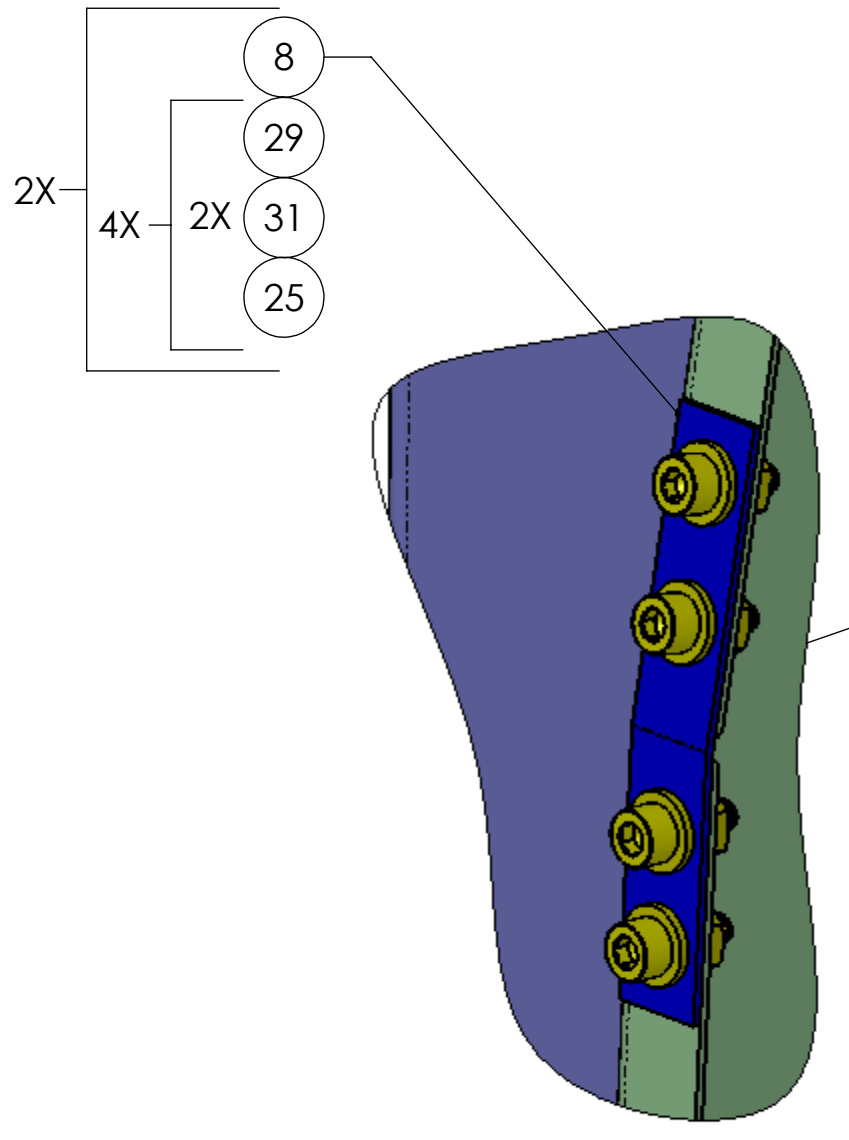

DETAIL H
SCALE 1 : 1

ASSEMBLY STEP 3

LIGO CALIFORNIA INSTITUTE OF TECHNOLOGY MASSACHUSETTS INSTITUTE OF TECHNOLOGY		REV.
SIZE DWG. NO.	D1000977	v4
SCALE: 1:3	PROJECTION:	SHEET 4 OF 5

8 7 6 5 4 3 2 1

H
G
F
E
D
C
B
A

D:\000977_AudiGO_AOS_SLC_ARM_Cavity_Bottle_Box_Assy_PART_PDM_REV_X-242_DRAWING_PDM_REV_X-056

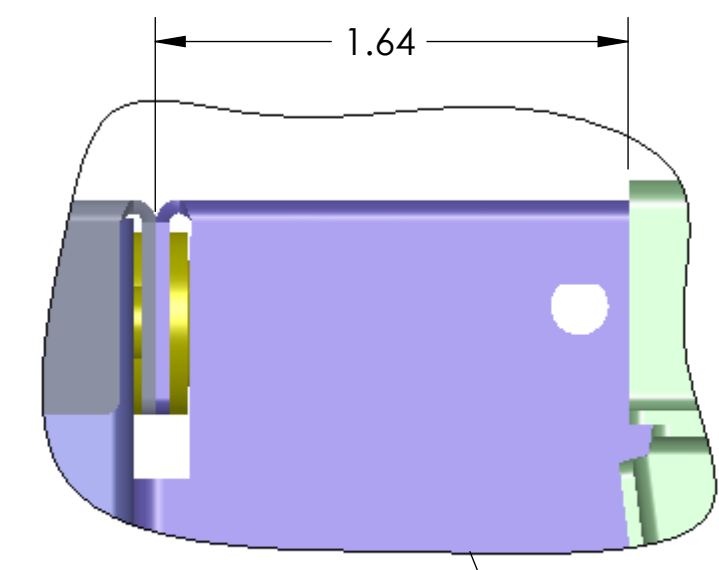
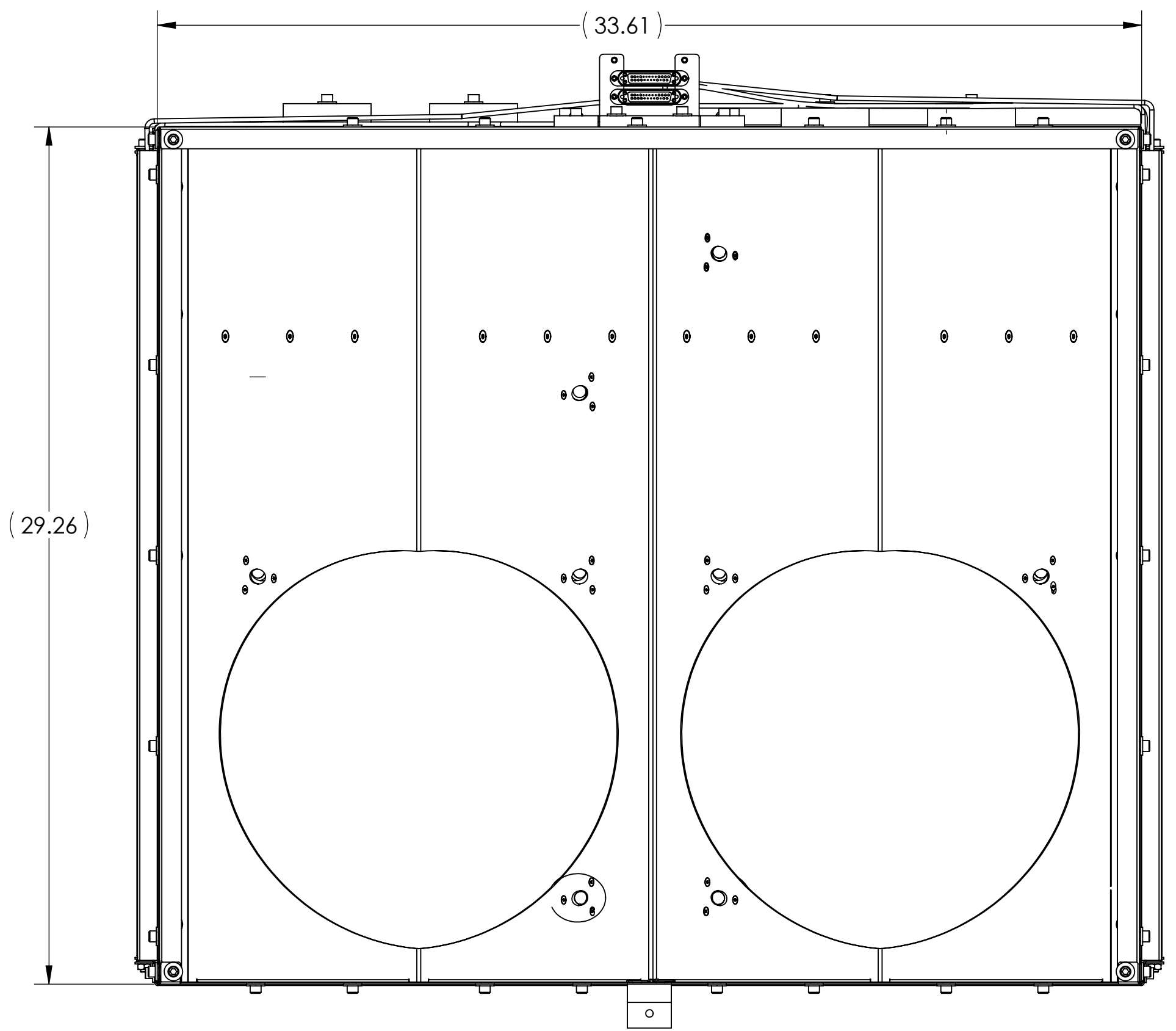
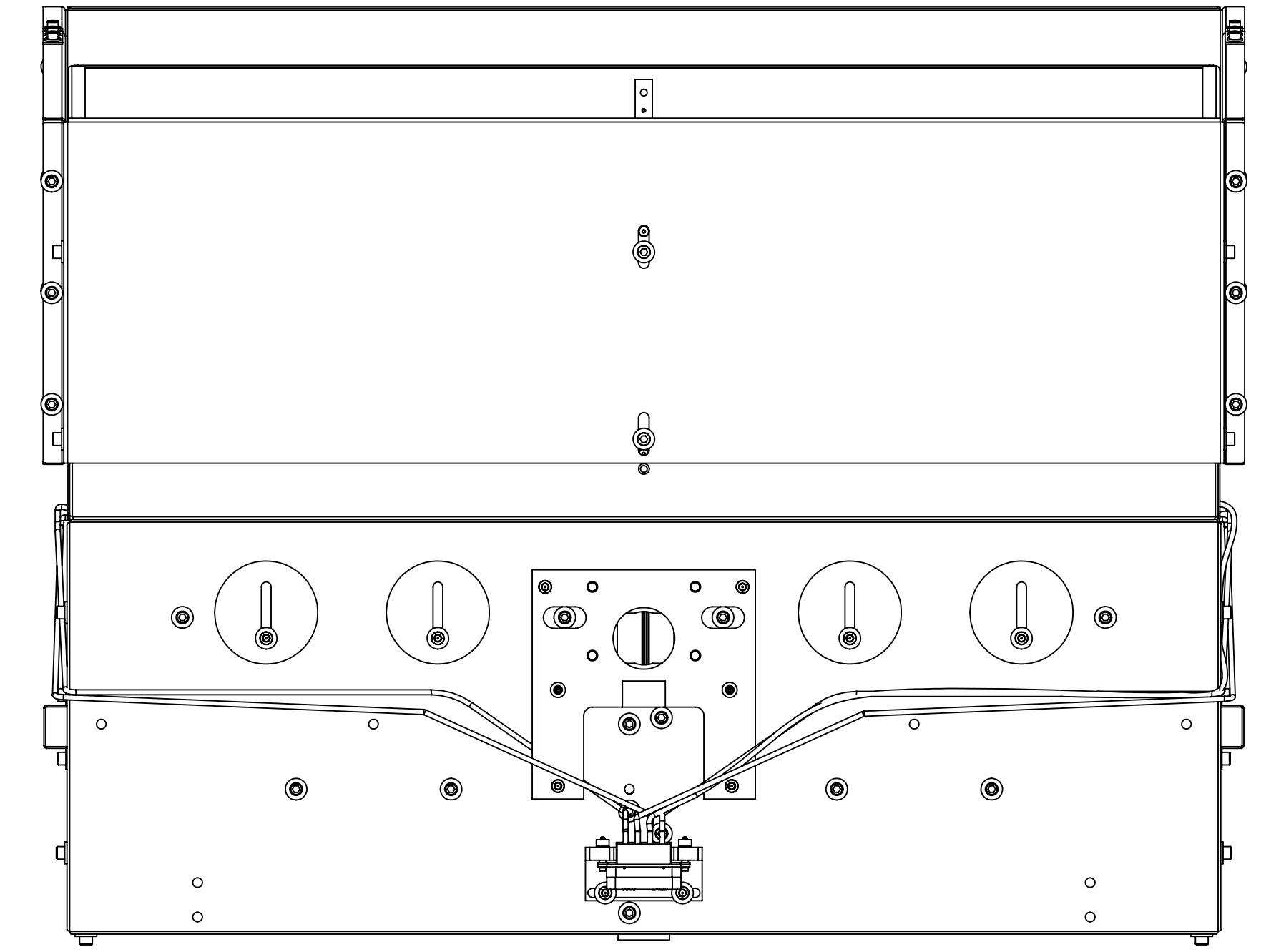

DETAIL K
SCALE 1.5 : 1

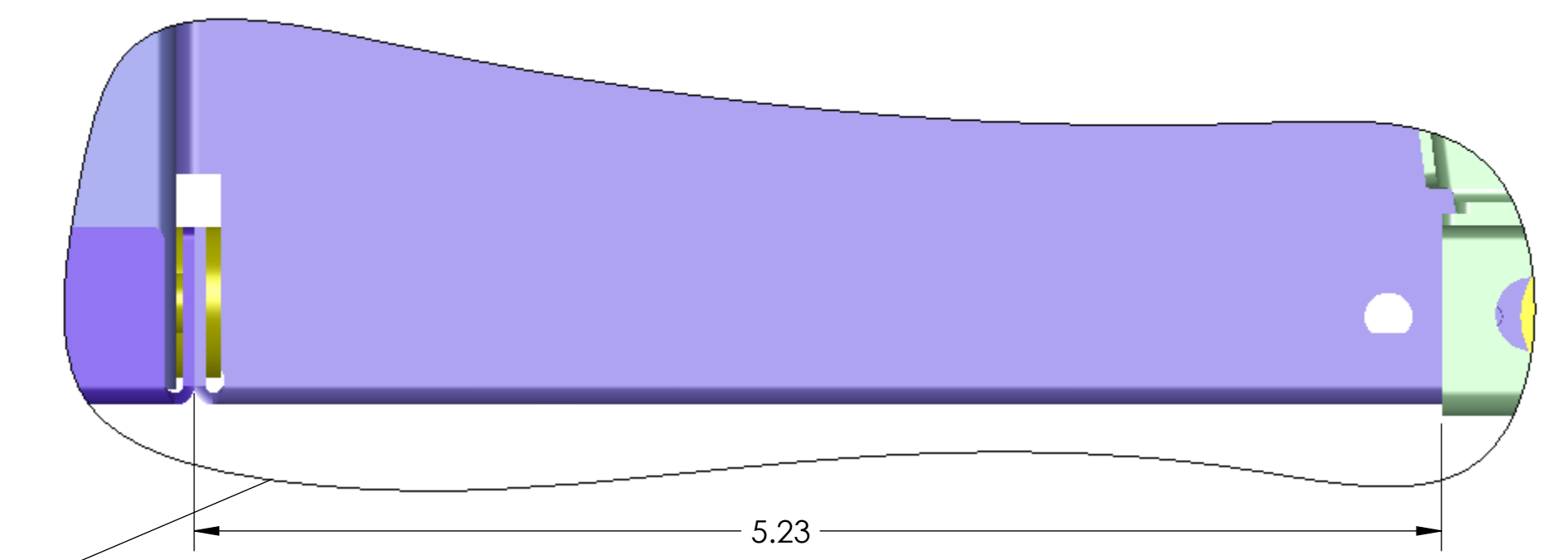
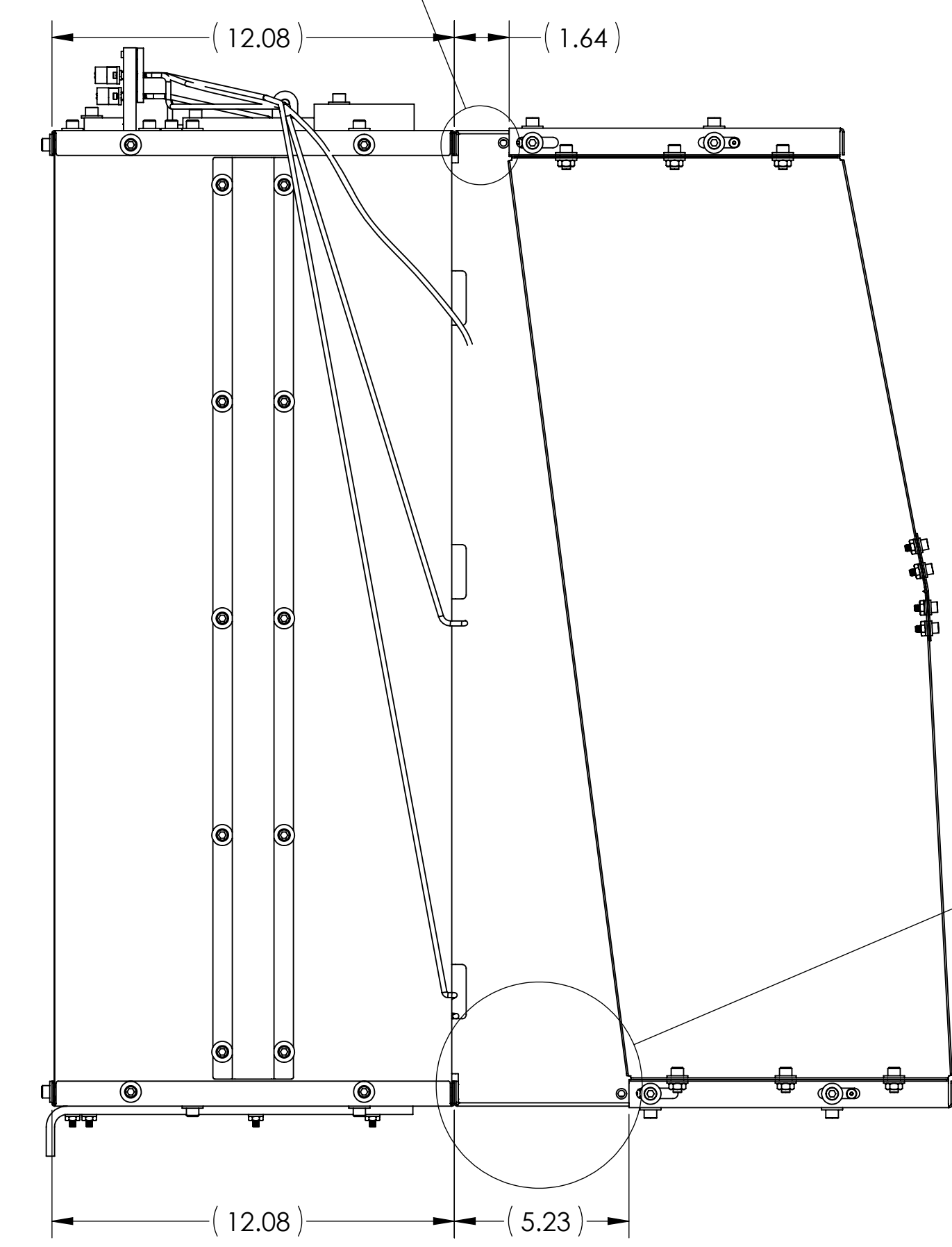
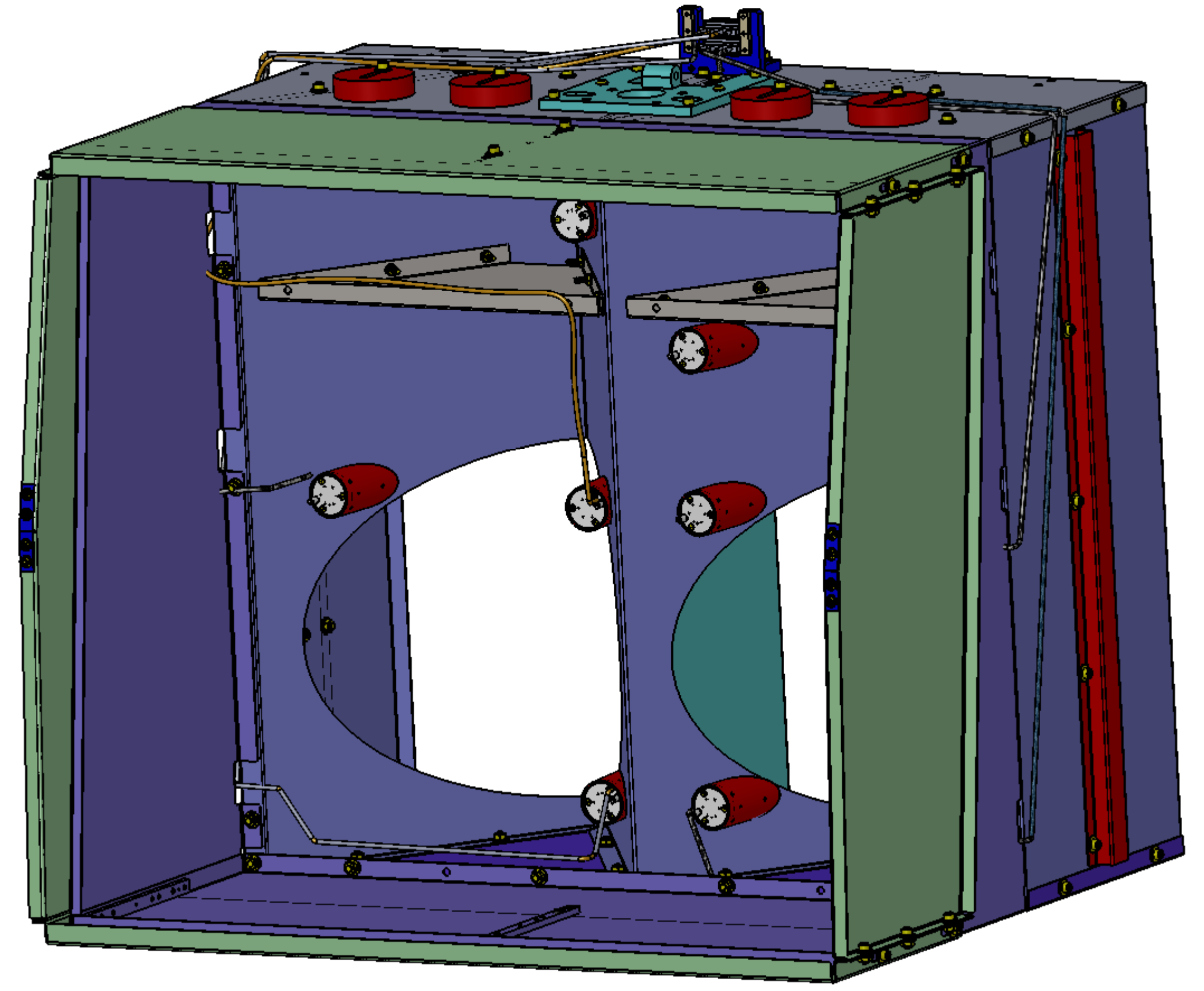

DETAIL J
SCALE 1.5 : 1

ASSEMBLY STEP 4

D1000977_AduIGO_ACS_SLC_ARM_Cavity_Bottle_Box_Asly_PART_PDM_REV_X-202_DRAWING_PDM_REV_X-056