

NOTES CONTINUED:
 ③ SCRIBE, ENGRAVE, OR MECHANICALLY STAMP (NO INKS OR DYES) DRAWING PART NUMBER AND REVISION ON NOTED SURFACE FOLLOWED ON THE NEXT LINE BY A THREE DIGIT SERIAL NUMBER. SERIAL NUMBERS START AT 001 FOR THE FIRST ARTICLE AND PROCEED CONSECUTIVELY. USE 27 HIGH CHARACTERS. EXAMPLE: DXXXXXX-VY, S/N 001. A VIBRATORY TOOL MAY BE USED.

V25AM-33-B CABLE ASSEMBLY CIRCUIT SUMMARY					
μD25 M/1S-33-4_μD9 F/5S:B					
FROM					
CONNECTOR J1 - 25 PIN MALE MICRO_D CONNECTOR					
PIN	WIRE NAME	COLOR	LENGTH	TWISTED PAIR	
E1	(CONNECTOR SHELL)			(CABLE 1 SHIELD)	
E1	(CABLE 1) WIRE 1	White	33 in.	SINGLE WIRE	
E14	(CABLE 1) WIRE 14	White	33 in.	TP-1A	
E2	(CABLE 1) WIRE 2	White	33 in.	TP-1A	
E15	(CABLE 1) WIRE 15	White	33 in.	TP-2A	
E3	(CABLE 1) WIRE 3	White	33 in.	TP-2A	
E16	(CABLE 1) WIRE 16	White	33 in.	TP-3A	
E4	(CABLE 1) WIRE 4	White	33 in.	TP-3A	
E1	(CABLE 2 SHIELD)			(CABLE 2 SHIELD)	
E17	(CABLE 2) WIRE 17	White	33 in.	TP-1B	
E5	(CABLE 2) WIRE 5	White	33 in.	TP-1B	
E18	(CABLE 2) WIRE 18	White	33 in.	TP-2B	
E6	(CABLE 2) WIRE 6	White	33 in.	TP-2B	
E19	(CABLE 2) WIRE 19	White	33 in.	TP-3B	
E7	(CABLE 2) WIRE 7	White	33 in.	TP-3B	
E1	(CABLE 3 SHIELD)			(CABLE 3 SHIELD)	
E20	(CABLE 3) WIRE 20	White	33 in.	TP-1C	
E8	(CABLE 3) WIRE 8	White	33 in.	TP-1C	
E21	(CABLE 3) WIRE 21	White	33 in.	TP-2C	
E9	(CABLE 3) WIRE 9	White	33 in.	TP-2C	
E22	(CABLE 3) WIRE 22	White	33 in.	TP-3C	
E10	(CABLE 3) WIRE 10	White	33 in.	TP-3C	
E1	(CABLE 4 SHIELD)			(CABLE 4 SHIELD)	
E23	(CABLE 4) WIRE 23	White	33 in.	TP-1D	
E11	(CABLE 4) WIRE 11	White	33 in.	TP-1D	
E24	(CABLE 4) WIRE 24	White	33 in.	TP-2D	
E12	(CABLE 4) WIRE 12	White	33 in.	TP-2D	
E25	(CABLE 4) WIRE 25	White	33 in.	TP-3D	
E13	(CABLE 4) WIRE 13	White	33 in.	TP-3D	

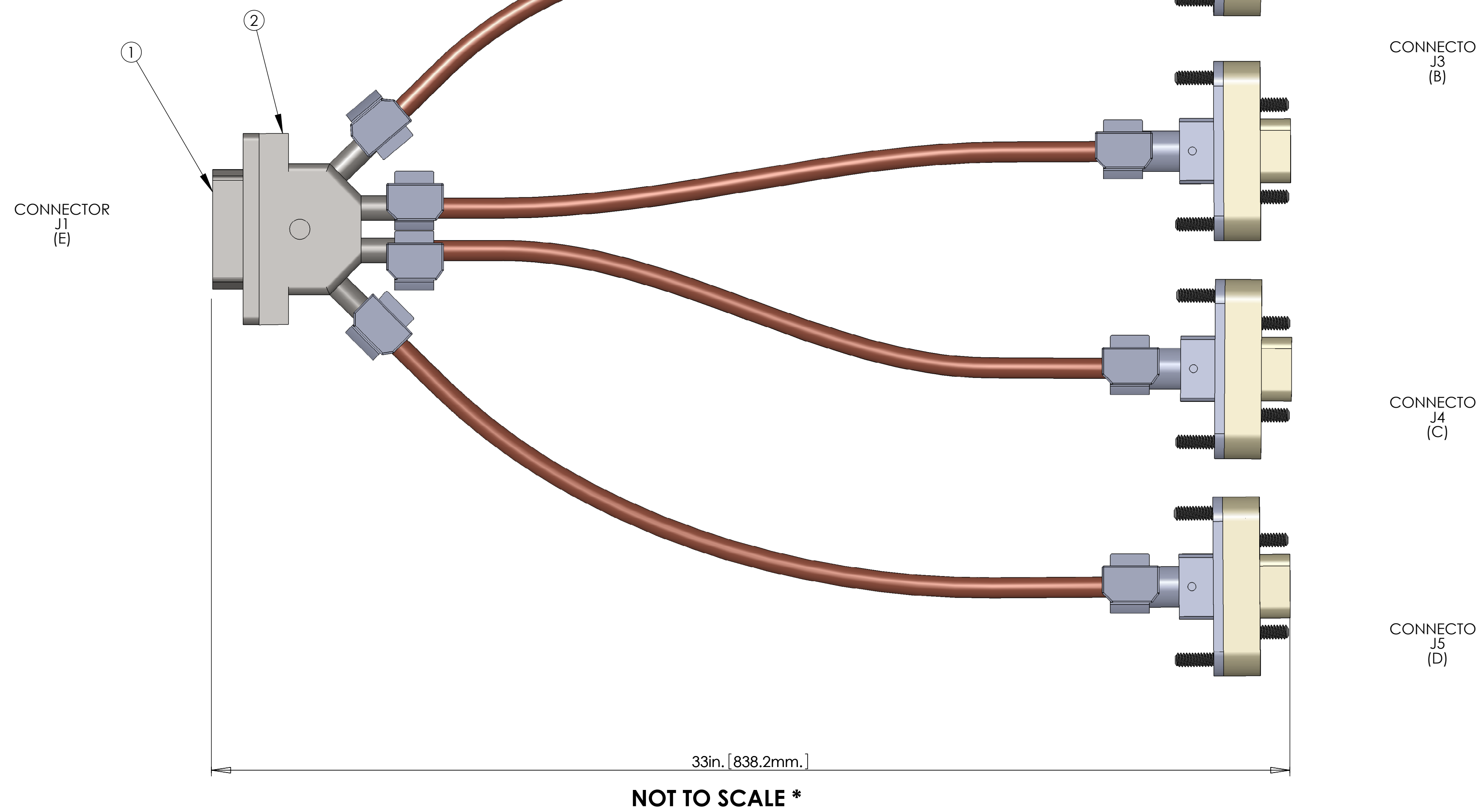
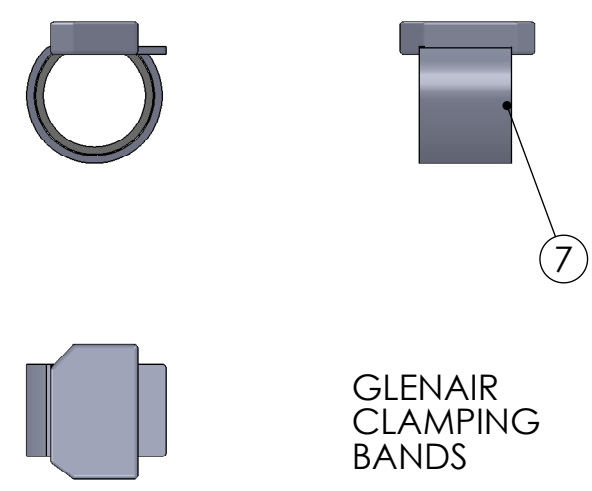
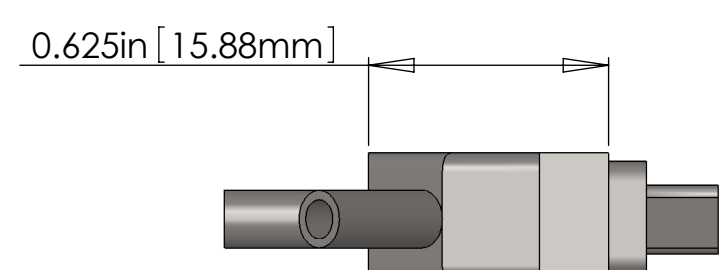
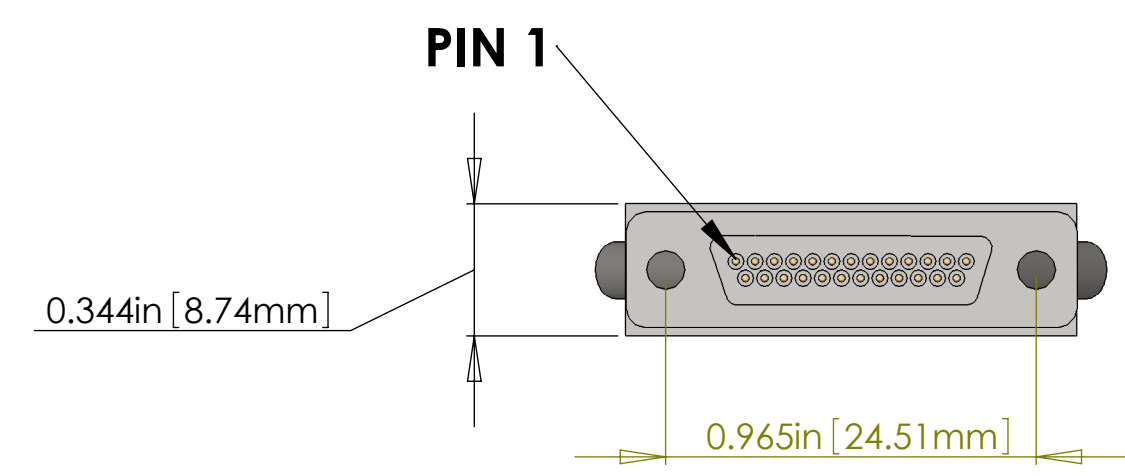
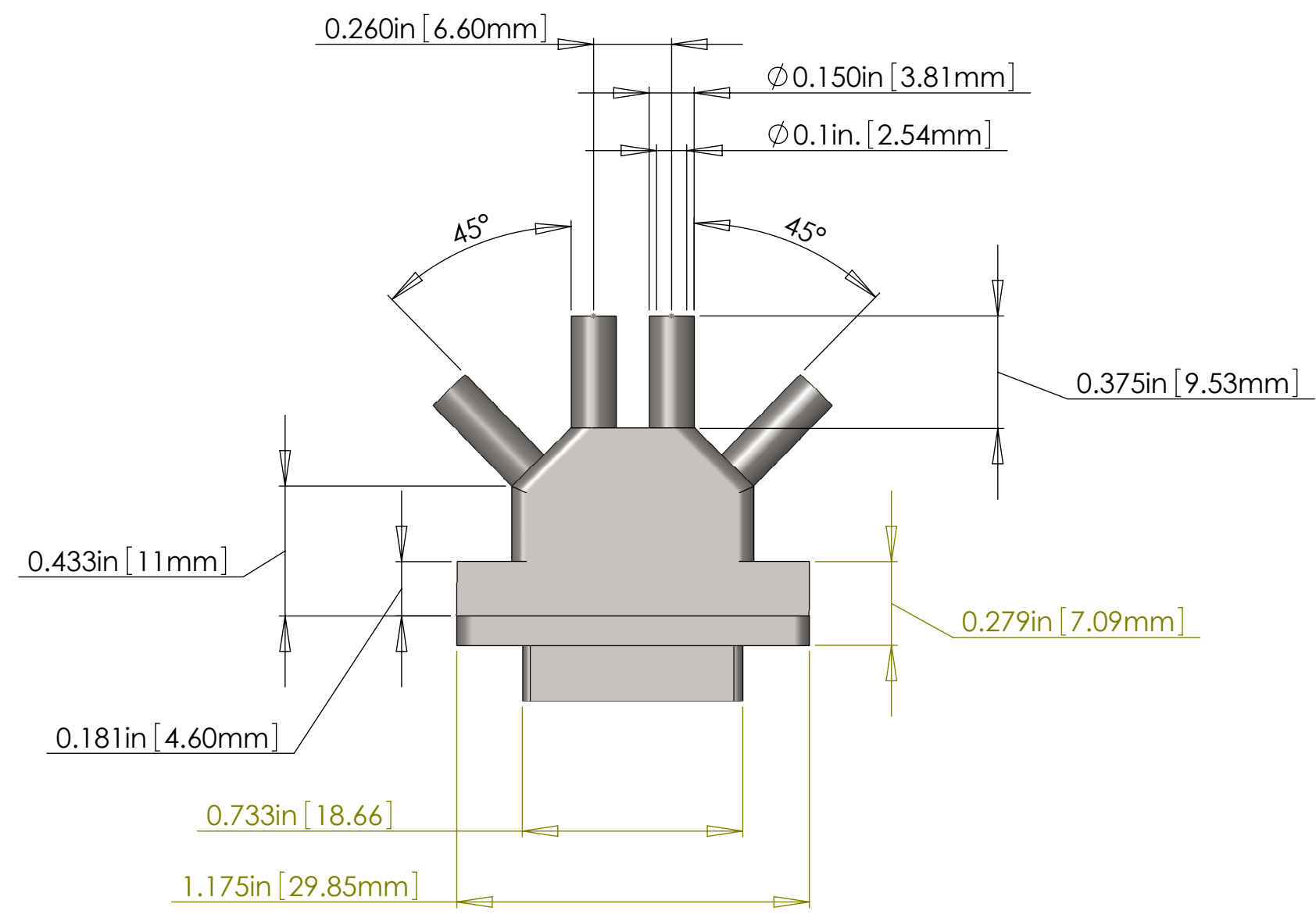
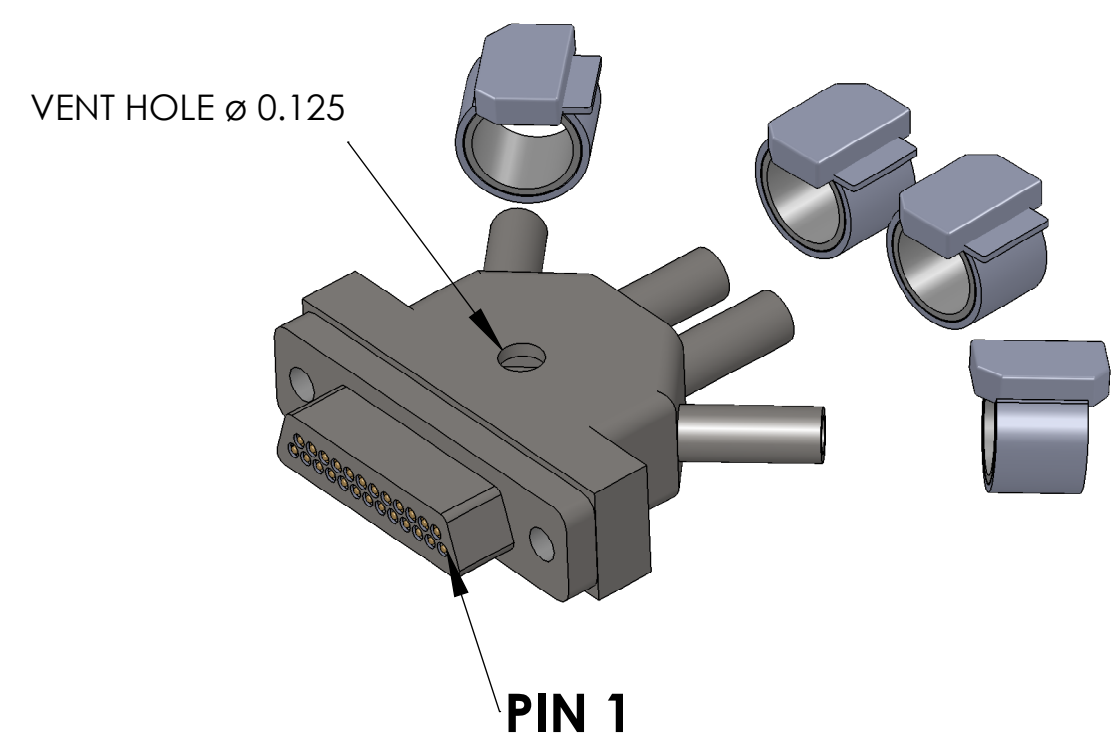

V25AM-33-B CABLE ASSEMBLY CIRCUIT SUMMARY		
TO		
CONNECTOR J2 - 9 PIN FEMALE MICRO_D CONNECTOR (PEEK)		
PIN	WIRE NAME	SIGNAL
A5	(CONNECTOR SHELL)	SHIELD
A5	(CABLE 1) SHIELD	SHIELD
A1	(CABLE 1) WIRE 1	PD1-K
A6	(CABLE 1) WIRE 2	PD1-A
A2	(CABLE 1) WIRE 15	LED1-A
A7	(CABLE 1) WIRE 3	LED1-K
A4	(CABLE 1) WIRE 16	COIL1-FN
A9	(CABLE 1) WIRE 4	COIL1-ST

V25AM-33-B CABLE ASSEMBLY CIRCUIT SUMMARY		
TO		
CONNECTOR J3 - 9 PIN FEMALE MICRO_D CONNECTOR (PEEK)		
PIN	WIRE NAME	SIGNAL
B5	(CONNECTOR SHELL)	SHIELD
B5	(CABLE 2) SHIELD	SHIELD
B5	(CABLE 2) WIRE 1	SHIELD
B1	(CABLE 2) WIRE 17	PD2-K
B6	(CABLE 2) WIRE 5	PD2-A
B2	(CABLE 2) WIRE 18	LED2-A
B7	(CABLE 2) WIRE 6	LED2-K
B4	(CABLE 2) WIRE 19	COIL2-FN
B9	(CABLE 2) WIRE 7	COIL2-ST

V25AM-33-B CABLE ASSEMBLY CIRCUIT SUMMARY		
TO		
CONNECTOR J4 - 9 PIN FEMALE MICRO_D CONNECTOR (PEEK)		
PIN	WIRE NAME	SIGNAL
C5	(CONNECTOR SHELL)	SHIELD
C5	(CABLE 3) SHIELD	SHIELD
C5	(CABLE 3) WIRE 1	SHIELD
C1	(CABLE 3) WIRE 20	PD3-K
C6	(CABLE 3) WIRE 8	PD3-A
C2	(CABLE 3) WIRE 21	LED3-A
C7	(CABLE 3) WIRE 9	LED3-K
C4	(CABLE 3) WIRE 22	COIL3-FN
C9	(CABLE 3) WIRE 10	COIL3-ST

V25AM-33-B CABLE ASSEMBLY CIRCUIT SUMMARY		
TO		
CONNECTOR J5 - 9 PIN FEMALE MICRO_D CONNECTOR (PEEK)		
PIN	WIRE NAME	SIGNAL
D5	(CONNECTOR SHELL)	SHIELD
D5	(CABLE 4) SHIELD	SHIELD
D5	(CABLE 4) WIRE 1	SHIELD
D1	(CABLE 4) WIRE 23	PD4-K
D6	(CABLE 4) WIRE 11	PD4-A
D2	(CABLE 4) WIRE 24	LED4-A
D7	(CABLE 4) WIRE 12	LED2-K
D4	(CABLE 4) WIRE 25	COIL4-FN
D9	(CABLE 4) WIRE 13	COIL4-ST

BILL OF MATERIALS				
ITEM NO.	PART NUMBER	DESCRIPTION	QTY.	LENGTH
①	GLENAIR #DCDM25P-S-MC225-240	MicroD25 MALE CONNECTOR (J1) FOR UHV	1	
②	TICOR # 040-1243-0025	MicroD25 CONNECTOR BACKSHELL FOR UHV (STAINLESS)	1	
③	TICOR # TS0094 WITH 60in. FLYING LEADS WITH BACKSHELL	MicroD9 FEMALE CONNECTOR (J2,J3,J4,J5) FOR UHV (PEEK)	4	
④		MicroD9 CONNECTOR BACKSHELL FOR UHV (STAINLESS)	4	
⑤	C1	7 COND. (3 TWISTED PAIR) CABLE (ADD COPPER BRAID (SHIELD) ⑥)	4	33in.*
⑥	COPPER BRAID	CONTINENTAL CORDAGE PART # 24x3x40BC	4	33in.*
⑦	GLENAIR 600-052	GLENAIR 600-052 STANDARD BRAID CLAMP	8	

* NOTE: THE OVERALL LENGTH IS MEASURED FROM PIN TIP (25 PIN) TO PIN TIP (9 PIN) OF THE CABLE. Use whatever length is necessary for the internal wiring of the connectors and strip length to achieve the correct overall length.

NOTES: (UNLESS OTHERWISE SPECIFIED)

- MATERIAL:
 - 9 PIN CONNECTOR SHELL - PEEK - VICTREX 450GL30.
 - BACKSHELL - STAINLESS STEEL WITH VENT HOLE.
 - CONTACTS - BERYLLIUM COPPER ALLOW C17300
 - HARDWARE: CORROSION RESISTANCE STEEL, PASSIVATED
 - PEEK BRAID - PEEK CARBON FIBRE LOADED
- CABLE 7 COND. 28 AWG, (40 STRD 44 AWG)
 3 TWISTED PAIRS (4 TO 5 TWISTS PER INCH)
 OVERALL 40AWG COPPER BRAID 90% COVERAGE
 OVERALL PEEK BRAID MIN. 50% COVERAGE
 OVERALL CABLE O.D. WILL BE APPROX. 0.240 IN.
- CONNECTORS WILL BE SUPPLIED WITH HARDWARE (LENGTH OF SCREWS AS SHOWN ARE APPROXIMATE SCREWS SHOULD BE THE PROPER LENGTH FOR PROPER MATING)

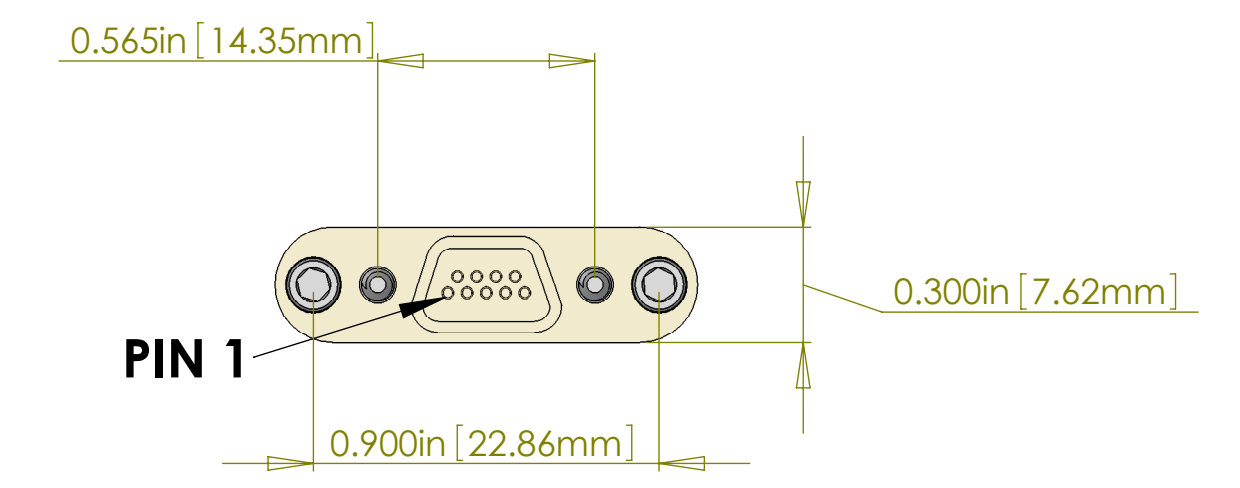
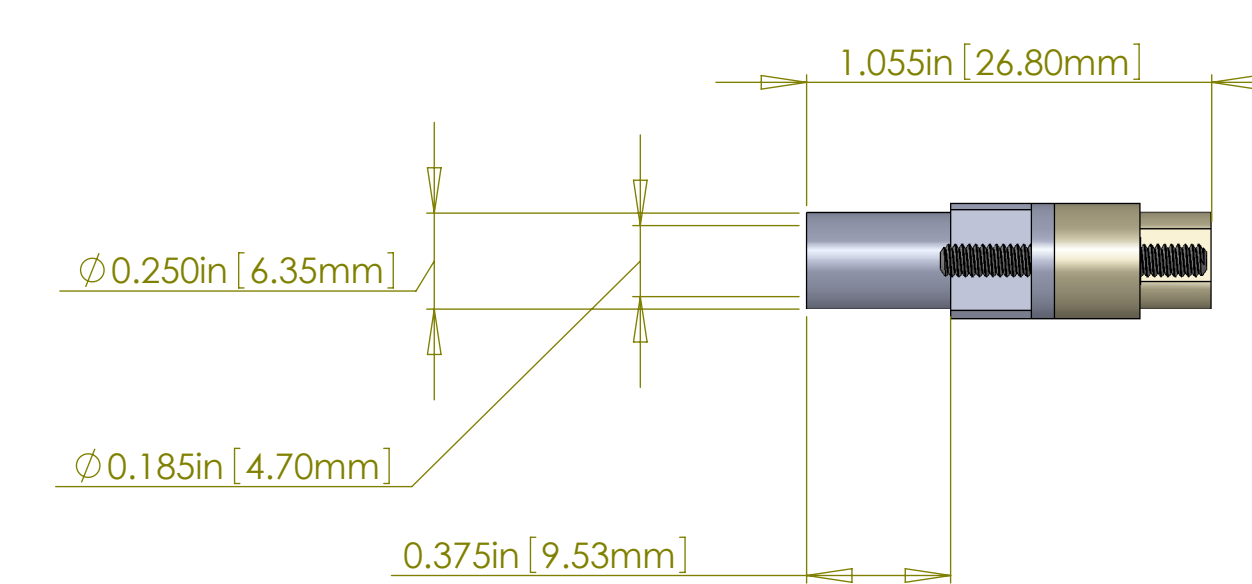
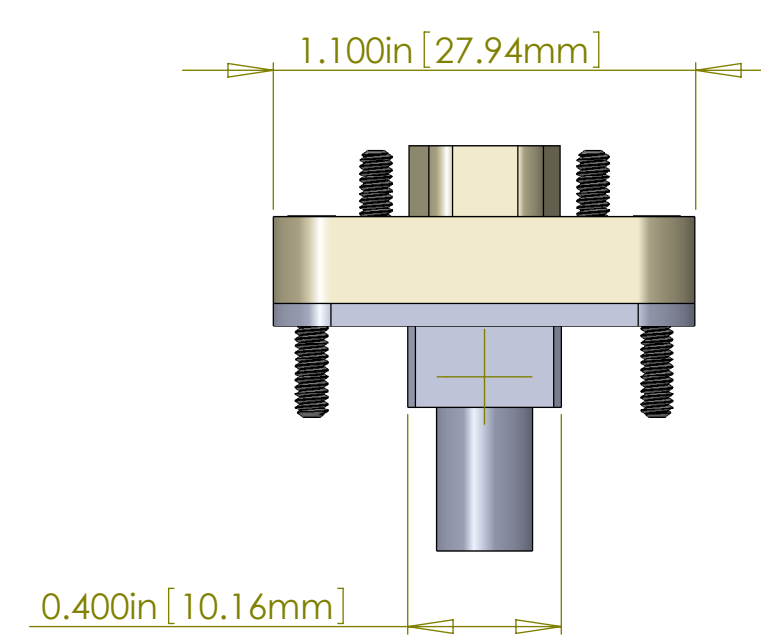
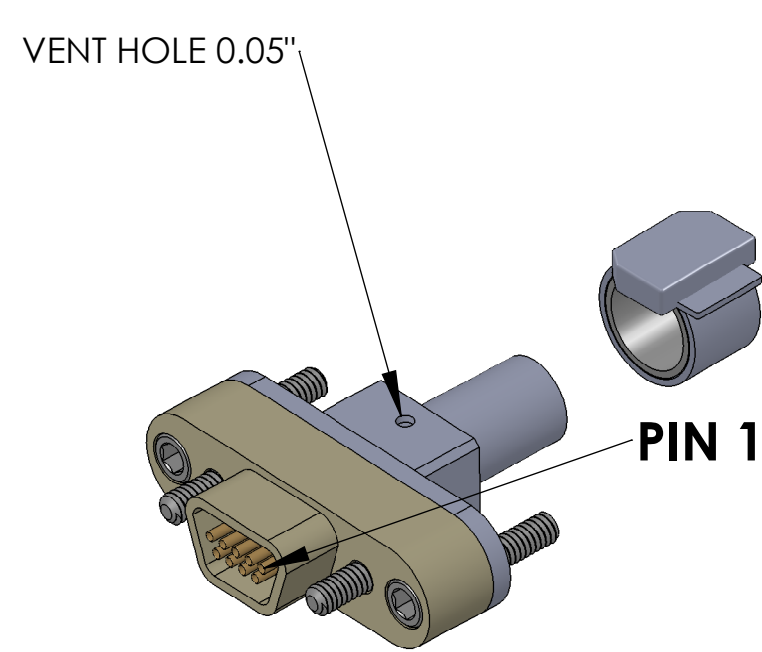

NOTES AND TOLERANCES: (UNLESS OTHERWISE SPECIFIED)				CALIFORNIA INSTITUTE OF TECHNOLOGY MASSACHUSETTS INSTITUTE OF TECHNOLOGY		PART NAME CUSTOM CABLE SPECIFICATION V25AM-33-B	
DIMENSIONS ARE IN				SYSTEM		SUB-SYSTEM	
TOLERANCES: .XX ± .XXX ±				SUS		DESIGNER J. HEENER	
ANGULAR ± °				NEXT ASSY		DRAWER E. BROWN	
MATERIAL				FINISH		CHECKER	
				μinch		APPROVAL	
						SIZE DWG. NO.	
						E D1000565-v3	
						SCALE: 2:1	
						PROJECTION:	
						SHEET 1 OF 1	