

NOTES CONTINUED:
 ③ SCRIBE, ENGRAVE, OR MECHANICALLY STAMP (NO INKS OR DYES) DRAWING PART NUMBER AND REVISION ON NOTED SURFACE FOLLOWED ON THE NEXT LINE BY A THREE DIGIT SERIAL NUMBER. SERIAL NUMBERS START AT 001 FOR THE FIRST ARTICLE AND PROCEED CONSECUTIVELY. USE 27 HIGH CHARACTERS. EXAMPLE: DXXXXXX-VY S/N 001. A VIBRATORY TOOL MAY BE USED.

V25AM-23-B CABLE ASSEMBLY CIRCUIT SUMMARY
V-μD25 M/S1-23-4 μD9 F/S5:B

| FROM | | | | |
|--|-------------------|-------|--------|------------------------------|
| CONNECTOR J1 - 25 PIN MALE MICRO_D CONNECTOR | | | | |
| PIN | WIRE NAME | COLOR | LENGTH | TWISTED PAIR |
| E1 | (CONNECTOR SHELL) | | | |
| E1 | (CABLE 1) WIRE 1 | White | 23 in. | (CABLE 1) SHIELD SINGLE WIRE |
| E14 | (CABLE 1) WIRE 14 | White | 23 in. | TP-1A |
| E2 | (CABLE 1) WIRE 2 | White | 23 in. | TP-1A |
| E15 | (CABLE 1) WIRE 15 | White | 23 in. | TP-2A |
| E3 | (CABLE 1) WIRE 3 | White | 23 in. | TP-2A |
| E16 | (CABLE 1) WIRE 16 | White | 23 in. | TP-3A |
| E4 | (CABLE 1) WIRE 4 | White | 23 in. | TP-3A |
| E1 | (CABLE 2) SHIELD | | | (CABLE 2) SHIELD |
| E17 | (CABLE 2) WIRE 17 | White | 23 in. | TP-1B |
| E5 | (CABLE 2) WIRE 5 | White | 23 in. | TP-1B |
| E18 | (CABLE 2) WIRE 18 | White | 23 in. | TP-2B |
| E6 | (CABLE 2) WIRE 6 | White | 23 in. | TP-2B |
| E19 | (CABLE 2) WIRE 19 | White | 23 in. | TP-3B |
| E7 | (CABLE 2) WIRE 7 | White | 23 in. | TP-3B |
| E1 | (CABLE 3) SHIELD | | | (CABLE 3) SHIELD |
| E20 | (CABLE 3) WIRE 20 | White | 23 in. | TP-1C |
| E8 | (CABLE 3) WIRE 8 | White | 23 in. | TP-1C |
| E21 | (CABLE 3) WIRE 21 | White | 23 in. | TP-2C |
| E9 | (CABLE 3) WIRE 9 | White | 23 in. | TP-2C |
| E22 | (CABLE 3) WIRE 22 | White | 23 in. | TP-3C |
| E10 | (CABLE 3) WIRE 10 | White | 23 in. | TP-3C |
| E1 | (CABLE 4) SHIELD | | | (CABLE 4) SHIELD |
| E23 | (CABLE 4) WIRE 23 | White | 23 in. | TP-1D |
| E11 | (CABLE 4) WIRE 11 | White | 23 in. | TP-1D |
| E24 | (CABLE 4) WIRE 24 | White | 23 in. | TP-2D |
| E12 | (CABLE 4) WIRE 12 | White | 23 in. | TP-2D |
| E25 | (CABLE 4) WIRE 25 | White | 23 in. | TP-3D |
| E13 | (CABLE 4) WIRE 13 | White | 23 in. | TP-3D |

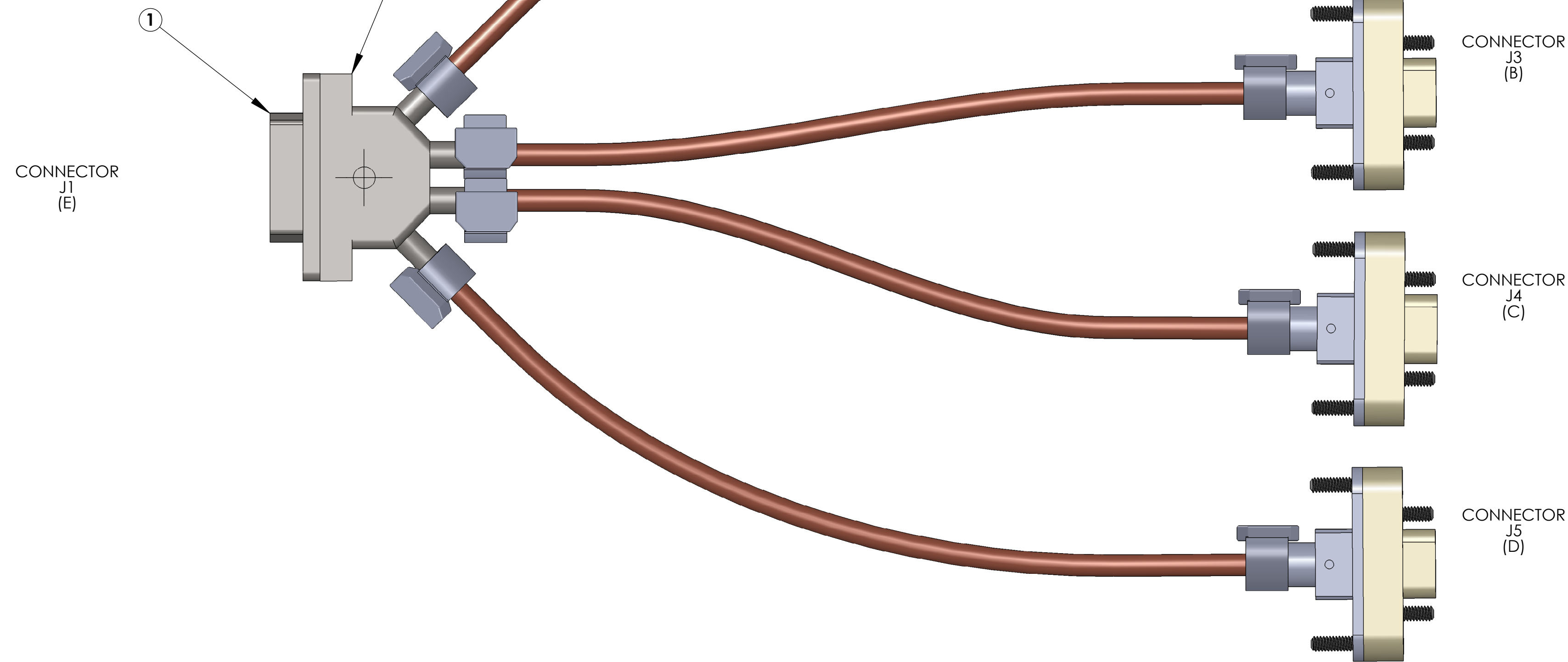
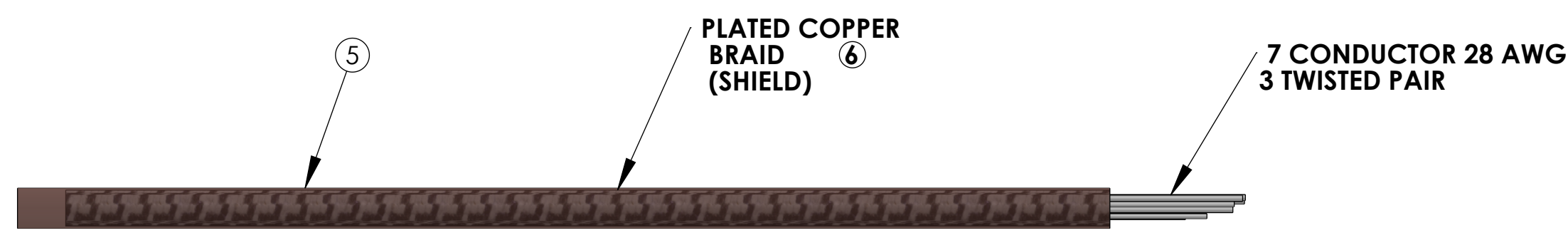
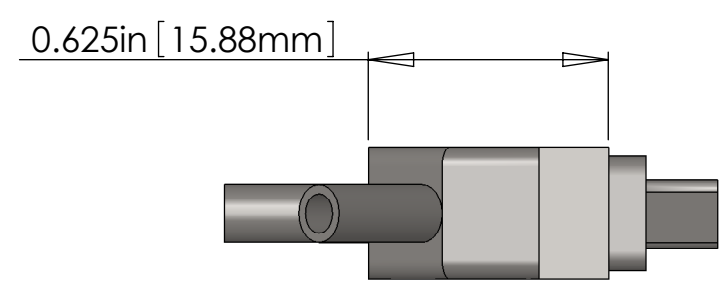
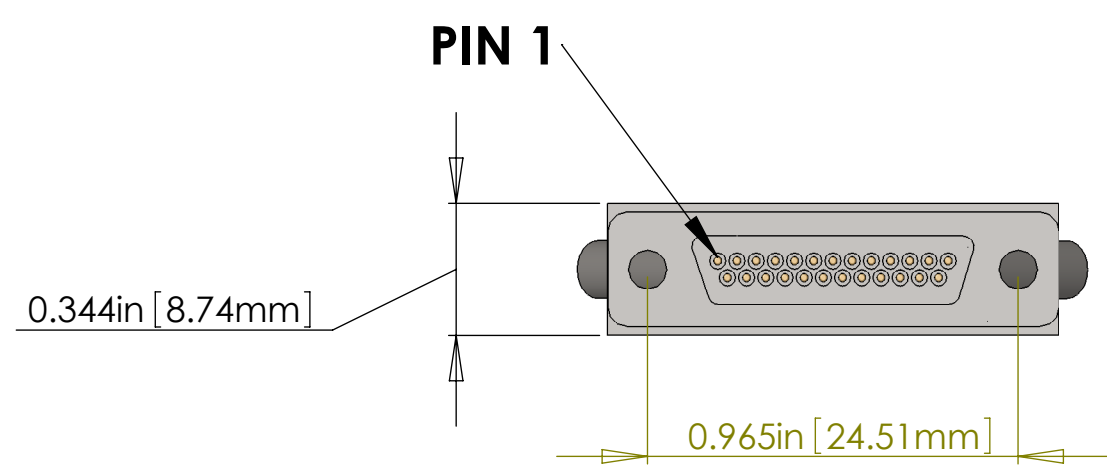
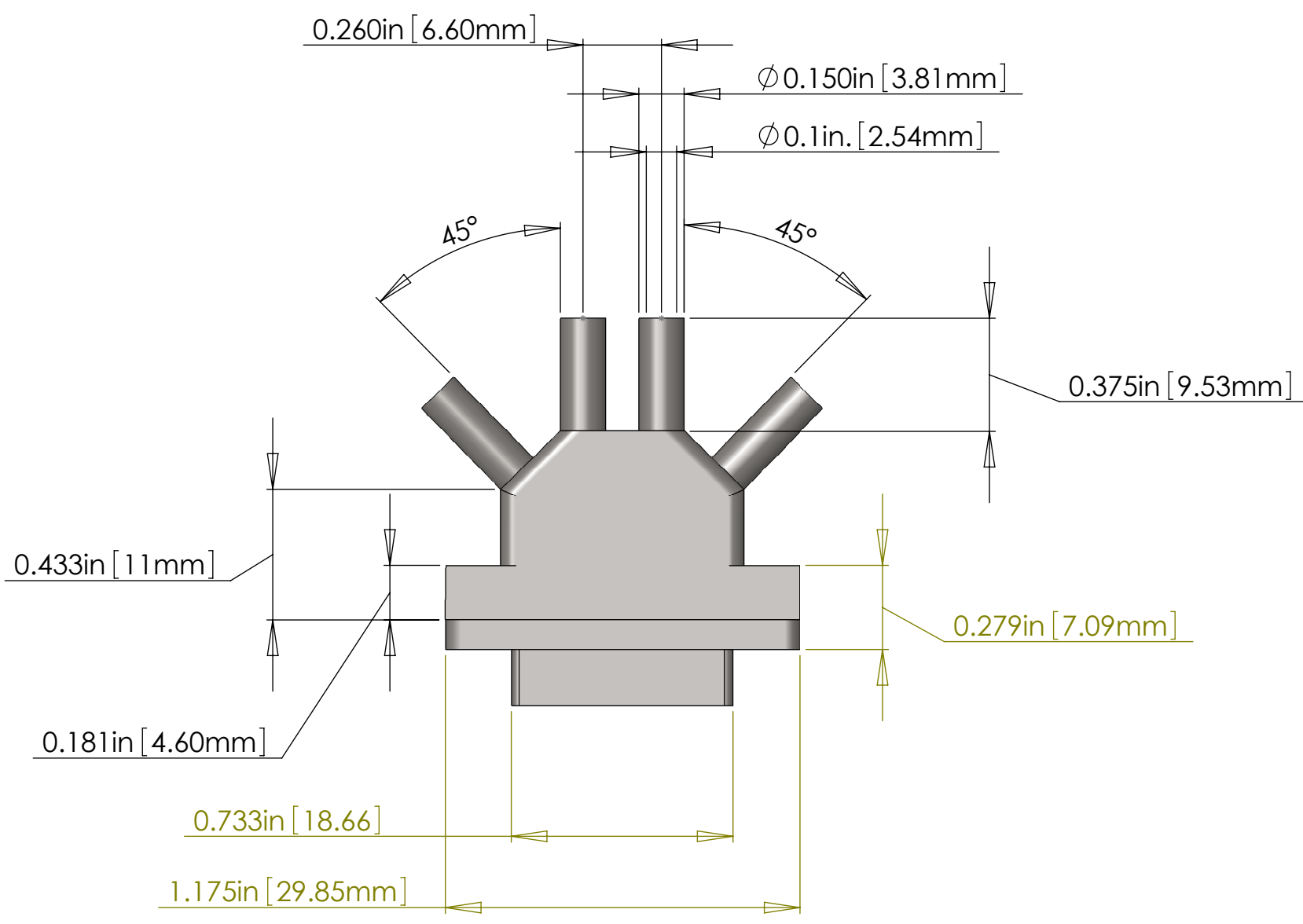
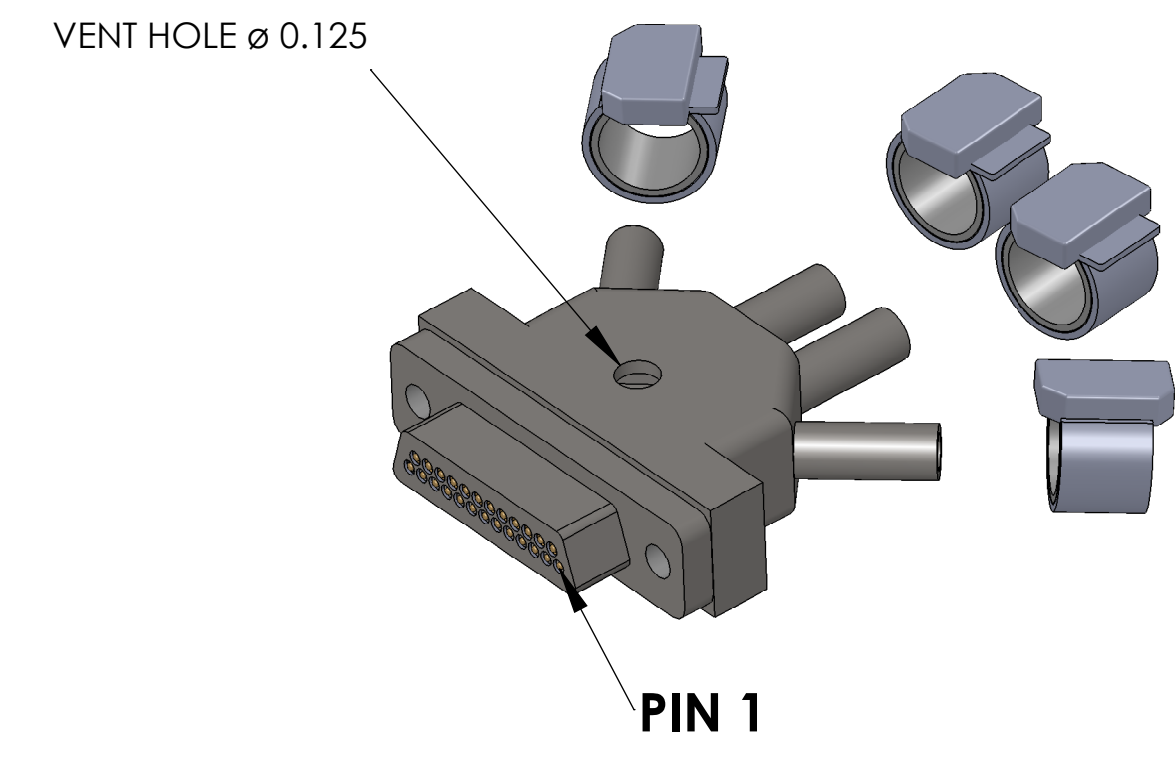

V25AM-23-B CABLE ASSEMBLY CIRCUIT SUMMARY

| TO | | |
|--|-------------------|----------|
| CONNECTOR J2 - 9 PIN FEMALE MICRO_D CONNECTOR (PEEK) | | |
| PIN | WIRE NAME | SIGNAL |
| A5 | (CONNECTOR SHELL) | SHIELD |
| A5 | (CABLE 1) SHIELD | SHIELD |
| A5 | (CABLE 1) WIRE 1 | SHIELD |
| A1 | (CABLE 1) WIRE 14 | PD1-K |
| A6 | (CABLE 1) WIRE 2 | PD1-A |
| A2 | (CABLE 1) WIRE 15 | LED1-A |
| A7 | (CABLE 1) WIRE 3 | LED1-K |
| A4 | (CABLE 1) WIRE 16 | COIL1-FN |
| A9 | (CABLE 1) WIRE 4 | COIL1-ST |

V25AM-23-B CABLE ASSEMBLY CIRCUIT SUMMARY

| TO | | |
|--|-------------------|----------|
| CONNECTOR J3 - 9 PIN FEMALE MICRO_D CONNECTOR (PEEK) | | |
| PIN | WIRE NAME | SIGNAL |
| B5 | (CONNECTOR SHELL) | SHIELD |
| B5 | (CABLE 2) SHIELD | SHIELD |
| B5 | (CABLE 2) WIRE 1 | SHIELD |
| B1 | (CABLE 2) WIRE 17 | PD2-K |
| B6 | (CABLE 2) WIRE 5 | PD2-A |
| B2 | (CABLE 2) WIRE 18 | LED2-A |
| B7 | (CABLE 2) WIRE 6 | LED2-K |
| B4 | (CABLE 2) WIRE 19 | COIL2-FN |
| B9 | (CABLE 2) WIRE 7 | COIL2-ST |

V25AM-23-B CABLE ASSEMBLY CIRCUIT SUMMARY

| TO | | |
|--|-------------------|----------|
| CONNECTOR J4 - 9 PIN FEMALE MICRO_D CONNECTOR (PEEK) | | |
| PIN | WIRE NAME | SIGNAL |
| C5 | (CONNECTOR SHELL) | SHIELD |
| C5 | (CABLE 3) SHIELD | SHIELD |
| C5 | (CABLE 3) WIRE 1 | SHIELD |
| C1 | (CABLE 3) WIRE 20 | PD3-K |
| C6 | (CABLE 3) WIRE 6 | PD3-A |
| C2 | (CABLE 3) WIRE 21 | LED3-A |
| C7 | (CABLE 3) WIRE 9 | LED3-K |
| C4 | (CABLE 3) WIRE 22 | COIL3-FN |
| C9 | (CABLE 3) WIRE 10 | COIL3-ST |

V25AM-23-B CABLE ASSEMBLY CIRCUIT SUMMARY

| TO | | |
|--|-------------------|----------|
| CONNECTOR J5 - 9 PIN FEMALE MICRO_D CONNECTOR (PEEK) | | |
| PIN | WIRE NAME | SIGNAL |
| D5 | (CONNECTOR SHELL) | SHIELD |
| D5 | (CABLE 4) SHIELD | SHIELD |
| D5 | (CABLE 4) WIRE 1 | SHIELD |
| D1 | (CABLE 4) WIRE 23 | PD4-K |
| D6 | (CABLE 4) WIRE 11 | PD4-A |
| D2 | (CABLE 4) WIRE 24 | LED4-A |
| D7 | (CABLE 4) WIRE 12 | LED4-K |
| D4 | (CABLE 4) WIRE 25 | COIL4-FN |
| D9 | (CABLE 4) WIRE 13 | COIL4-ST |

BILL OF MATERIALS

| ITEM NO. | PART NUMBER | DESCRIPTION | QTY. | LENGTH |
|----------|---|---|------|--------|
| ① | GLENAIR #DCDM25P-S-MC225-240 | MicroD25 MALE CONNECTOR (J1) FOR UHV (METAL SHELL) | 1 | |
| ② | TICOR # 040-1243-0025 | MicroD25 CONNECTOR BACKSHELL FOR UHV (STAINLESS) | 1 | |
| ③ | TICOR # TS0094 WITH 60in. FLYING LEADS WITH BACKSHELL | MicroD9 FEMALE CONNECTOR (J2,J3,J4,J5) FOR UHV (PEEK) | 4 | |
| ④ | | MicroD9 CONNECTOR BACKSHELL FOR UHV (STAINLESS) | 4 | |
| ⑤ | C1 | 7 COND. (3 TWISTED PAIR) CABLE (ADD COPPER BRAID (SHIELD) ⑥) | 4 | 23in.* |
| ⑥ | COPPER BRAID | CONTINENTAL CORDAGE PART #24x3x40BC | 4 | 23in.* |
| ⑦ | GLENAIR 600-052 | GLENAIR 600-052 STANDARD BRAID CLAMP | 8 | |

* NOTE: THE OVERALL LENGTH IS MEASURED FROM PIN TIP (25 PIN) TO PIN TIP (9 PIN) OF THE CABLE. Use whatever length is necessary for the internal wiring of the connectors and strip length to achieve the correct overall length.

NOTES: (UNLESS OTHERWISE SPECIFIED)

- MATERIAL: a. 9 PIN CONNECTOR SHELL - PEEK - VICTREX 450GL30.
 b. BACKSHELL - STAINLESS STEEL WITH VENT HOLE.
 c. CONTACTS - BERYLLIUM COPPER ALLOW C17300 0.00050 MIN. GOLD OVER NICKEL
 d. HARDWARE - CORROSION RESISTANCE STEEL, PASSIVATED
 e. PEEK BRAID - PEEK CARBON FIBRE LOADED
- CABLE 7 COND. 28 AWG (40 STRD 44 AWG) 3 TWISTED PAIRS (4 TO 5 TWISTS PER INCH) OVERALL 40AWG COPPER BRAID 90% COVERAGE OVERALL PEEK BRAID MIN. 50% COVERAGE OVERALL CABLE O.D. WILL BE APPROX. 0.240 IN.
- CONNECTORS WILL BE SUPPLIED WITH HARDWARE (LENGTH OF SCREWS AS SHOWN ARE APPROXIMATE SCREWS SHOULD BE THE PROPER LENGTH FOR PROPER MATING)

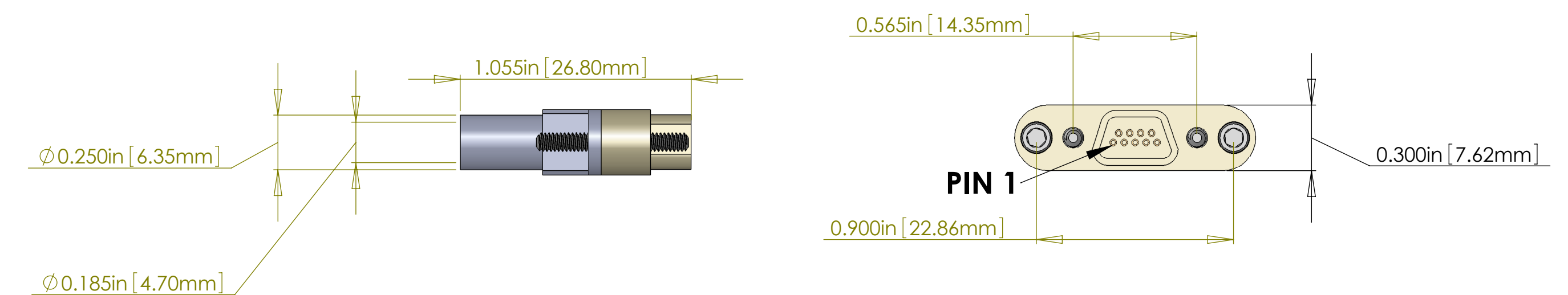
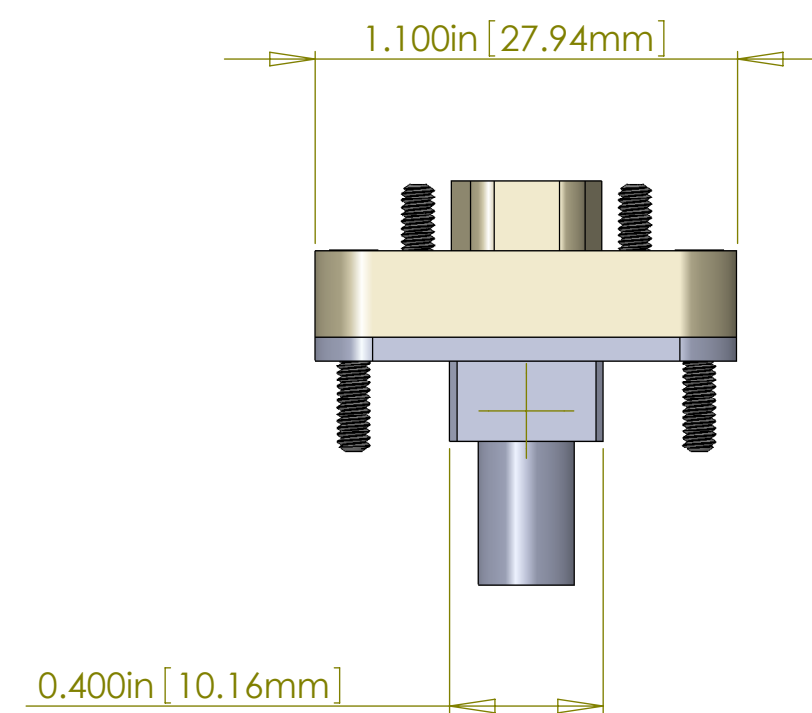
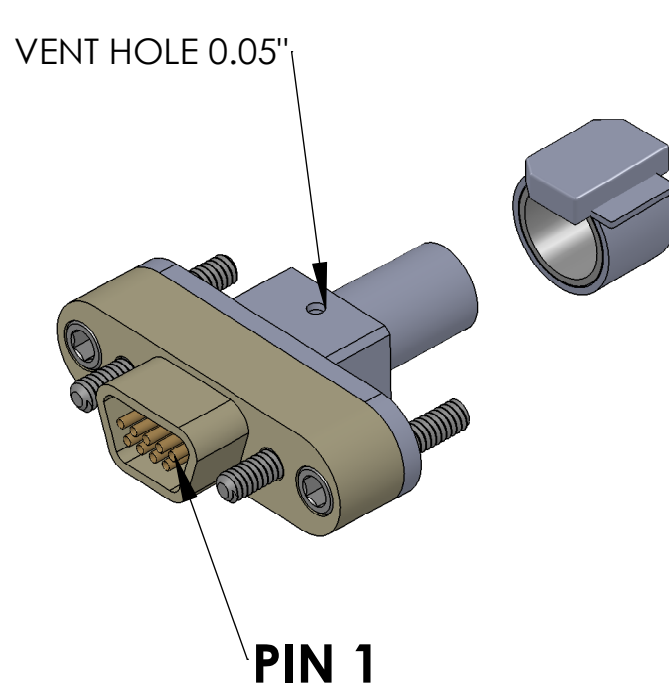

| V-μD25 M/S1-23-4 μD9 F/S5:B (no peek) | |
|---------------------------------------|----------------------|
| STANDARD USE FOR THIS CABLE | |
| SUBSYSTEM | STANDARD USE |
| SUS | QUAD SUSPENSIONS UIM |

| NOTES AND TOLERANCES: (UNLESS OTHERWISE SPECIFIED) | | CALIFORNIA INSTITUTE OF TECHNOLOGY MASSACHUSETTS INSTITUTE OF TECHNOLOGY | | PART NAME | |
|--|--|--|--|--|--|
| DIMENSIONS ARE IN TOLERANCES: .XX ± .XXX ± ANGULAR ± ° | | 1. INTERPRET DRAWING PER ASME Y14.5-1994. 2. REMOVE ALL SHARP EDGES, R.02 MIN. 3. DO NOT SCALE FROM DRAWING. 4. ALL MACHINING FLUIDS MUST BE FULLY SYNTHETIC, FULLY WATER SOLUBLE AND FREE OF SULFUR, SILICONE, AND CHLORINE. | | CUSTOM CABLE SPECIFICATION V25AM-23-B | |
| MATERIAL N/A | | SUB-SYSTEM SUS | | DESIGNER J. HEFFNER SEP/21/2011 DRAFTER E. BROWN SEP/21/2011 CHECKER APPROVAL | |
| FINISH N/A μinch | | NEXT ASSY | | SIZE DWG. NO. E SCALE: 2:1 PROJECTION: SHEET 1 OF 1 | |
| | | | | REV. v3 | |