

**NOTES CONTINUED:**  
 5. SCRIBE, ENGRAVE, OR MECHANICALLY STAMP (NO DYES OR INKS) A UNIQUE THREE DIGIT SERIAL NUMBER & REVISION NUMBER ON EACH PART. SERIAL NUMBERS START AT 001 FOR THE FIRST ARTICLE AND PROCEED CONSECUTIVELY. BAG AND TAG PARTS WITH THEIR DRAWING PART NUMBER, REVISION, VARIANT OR "TYPE" (IF APPLICABLE), AND QUANTITY. IF PARTS ARE TOO SMALL TO SCRIBE, BAGGING AND TAGGING ALONE IS SUFFICIENT.  
 EXAMPLE (PART): 001-v1  
 EXAMPLE (TAG): DXXXXXX-VY, TYPE-XX, QTY: TBD  
 6. APPROXIMATE WEIGHT = 0.78 LB [.35 KG].  
 7. PART TO BE FREE OF SCRATCHES, NO ABRASION AT CUT EDGES.  
 8. AR COATING < .3% REFLECTANCE @1064 NM WAVELENGTH @NORMAL INCIDENCE PER MIL - C - 675A, ONE SIDE (CUT SIDE) AS SHOWN.  
 9. MAKE FROM .125" BLACK GLASS, SHADE #12.  
 VENDOR:  
 EMERALD VIEW GLASS, WESTLAKE, OHIO, 44145  
 DONALD O'SHEA 216-226-5100

REV.	DATE	DCN #	DRAWING TREE #
v1	01/20/2011	E1100019-v1	-
-	-	-	-
-	-	-	-

D  
C  
B  
A

D  
C  
B  
A

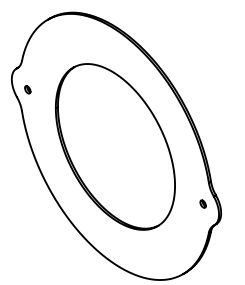
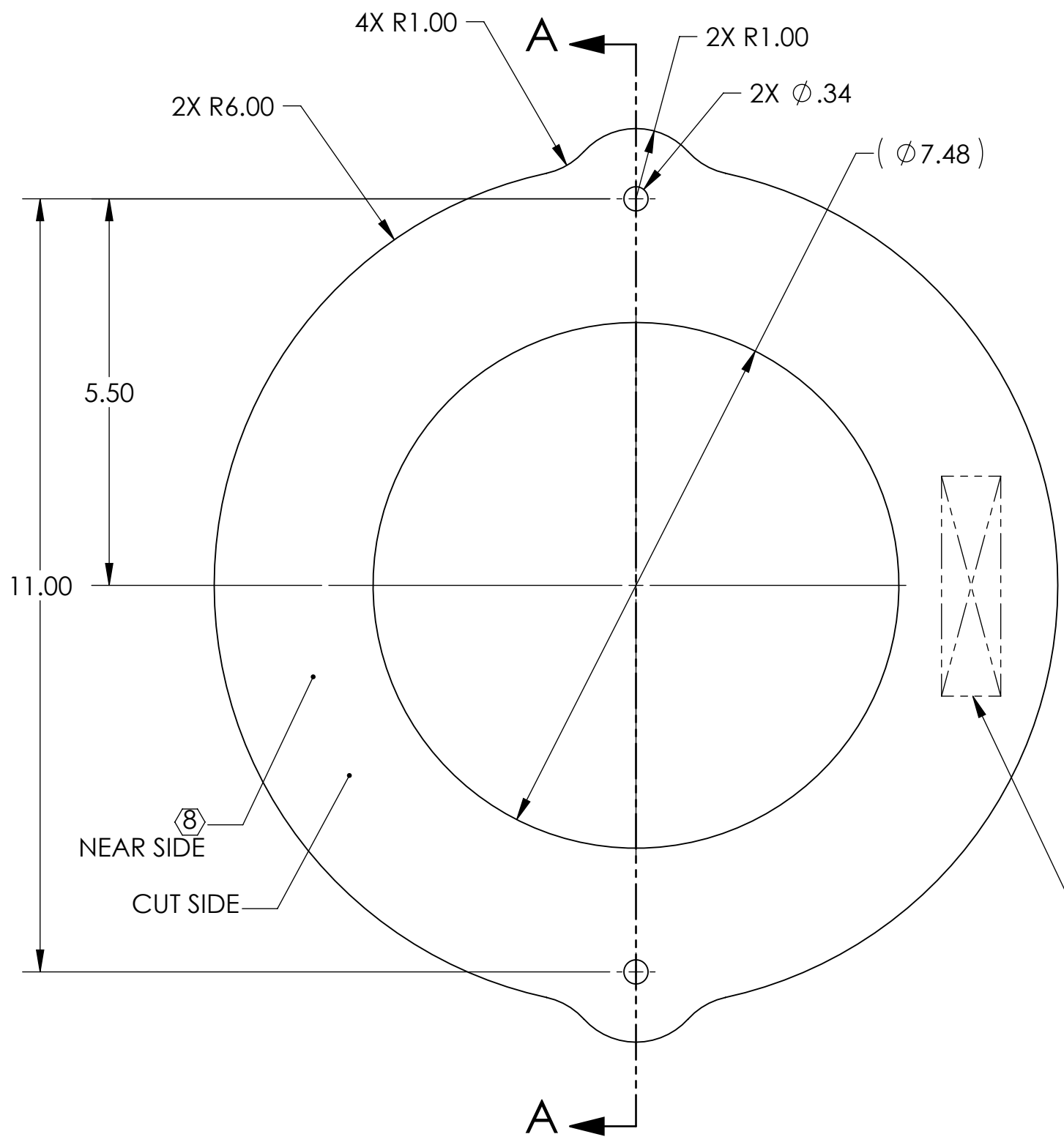
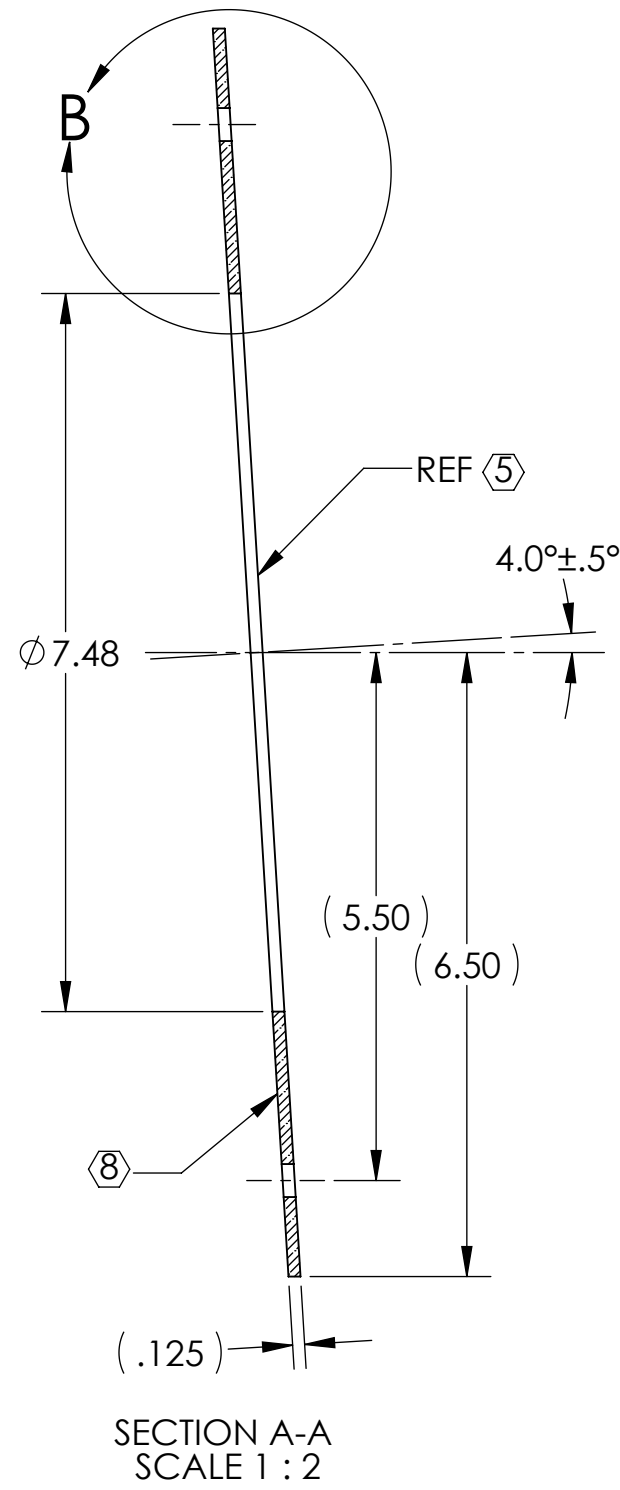
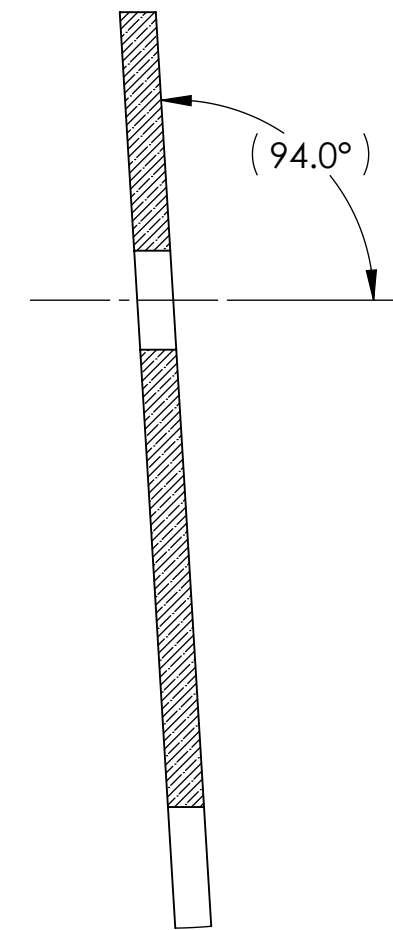

NOTES AND TOLERANCES: (UNLESS OTHERWISE SPECIFIED)				LIGO CALIFORNIA INSTITUTE OF TECHNOLOGY MASSACHUSETTS INSTITUTE OF TECHNOLOGY		PART NAME	
DIMENSIONS ARE IN INCHES TOLERANCES: .XX ± .01 .XXX ± .005 ANGULAR ± 1.0°				1. INTERPRET DRAWING PER ASME Y14.5-1994. 2. REMOVE ALL SHARP EDGES, R.02 MIN. 3. DO NOT SCALE FROM DRAWING. 4. ALL MACHINING FLUIDS MUST BE FULLY SYNTHETIC, FULLY WATER SOLUBLE AND FREE OF SULFUR, SILICONE, AND CHLORINE.		ALIGO TRANSMON TELE BLACK GLASS PLATE	
MATERIAL		FINISH		SYSTEM		SUB-SYSTEM	
9		N/A		ADVANCED LIGO		AOS	
NEXT ASSY				DESIGNER		DATE	
D1003120				K. MAILAND		1/5/2011	
				DRAFTER		DATE	
				M. MILLER		1/6/2011	
				CHECKER			
				APPROVAL			
				SIZE		DWG. NO.	
				B		D1000275	
				SCALE: 1:4		PROJECTION:	
						SHEET 1 OF 1	
				REV.			
				v1			

D1000275 ALIGO\_TRANSMON\_TELE\_BLACK\_GLASS\_PLATE, PART PDM REV: X-034, DRAWING PDM REV: X-036