

**NOTES CONTINUED:**  
 ⑤ SCRIBE, ENGRAVE, OR MECHANICALLY STAMP (NO INKS OR DYES) DRAWING PART NUMBER, REVISION (AND VARIANT OR "TYPE" IF APPLICABLE) ON NOTED SURFACE OF PART FOLLOWED ON THE NEXT LINE WITH A THREE DIGIT SERIAL NUMBER. SERIAL NUMBERS START AT 001 FOR THE FIRST ARTICLE AND PROCEED CONSECUTIVELY. USE MINIMUM 0.12" HIGH CHARACTERS, UNLESS THE SIZE OF THE PART DICTATES SMALLER CHARACTERS. A VIBRATORY TOOL MAY BE USED.  
 EXAMPLE: DXXXXXX-VY, TYPE-XX, S/N XXX

REV.	DATE	DCN #	DRAWING TREE #
v1	03-SEPT-2010	E1000365-v1	-
-	-	-	-
-	-	-	-

D  
C  
B  
A

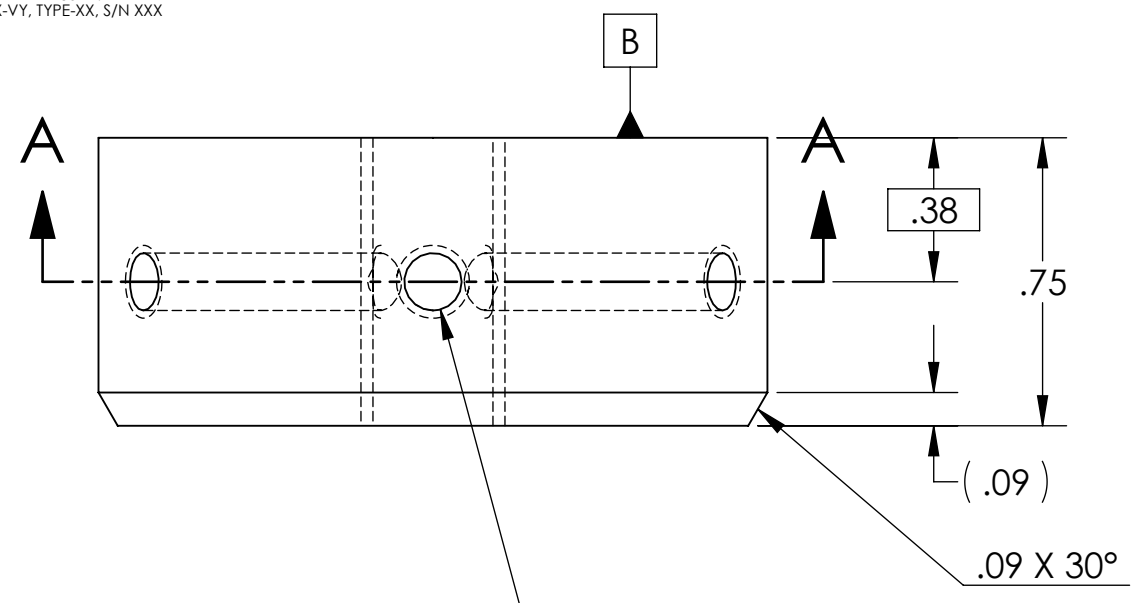

3X  $\phi$  .150 THRU ALL  
 6X 10-24 UNC - 2B  $\nabla$  .35 MIN  
 $\oplus \phi$  .017 A(S) B

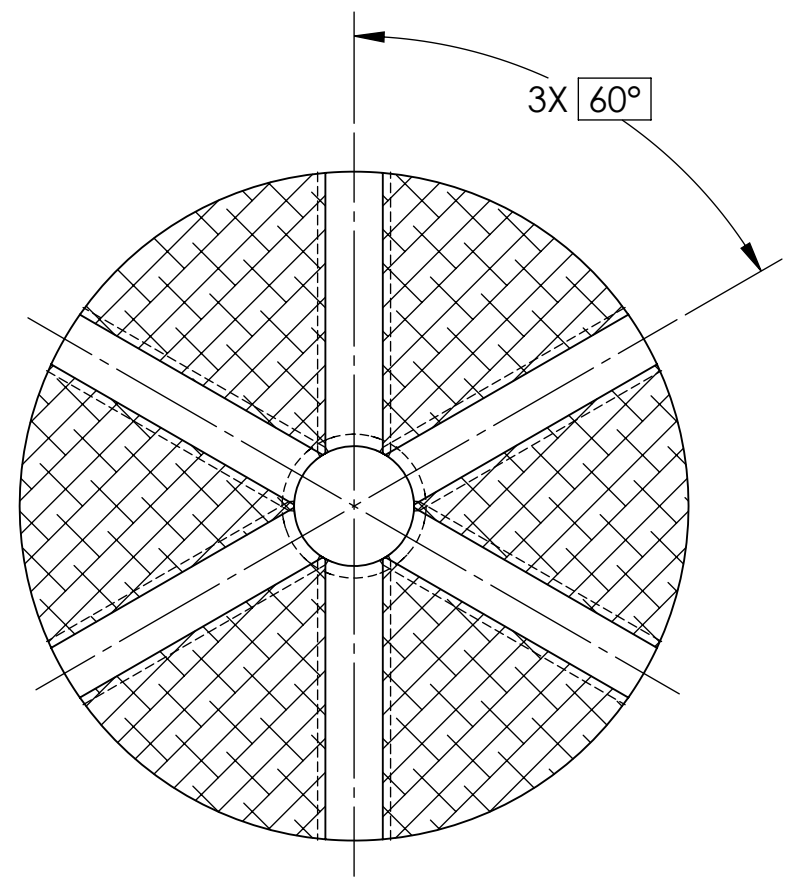
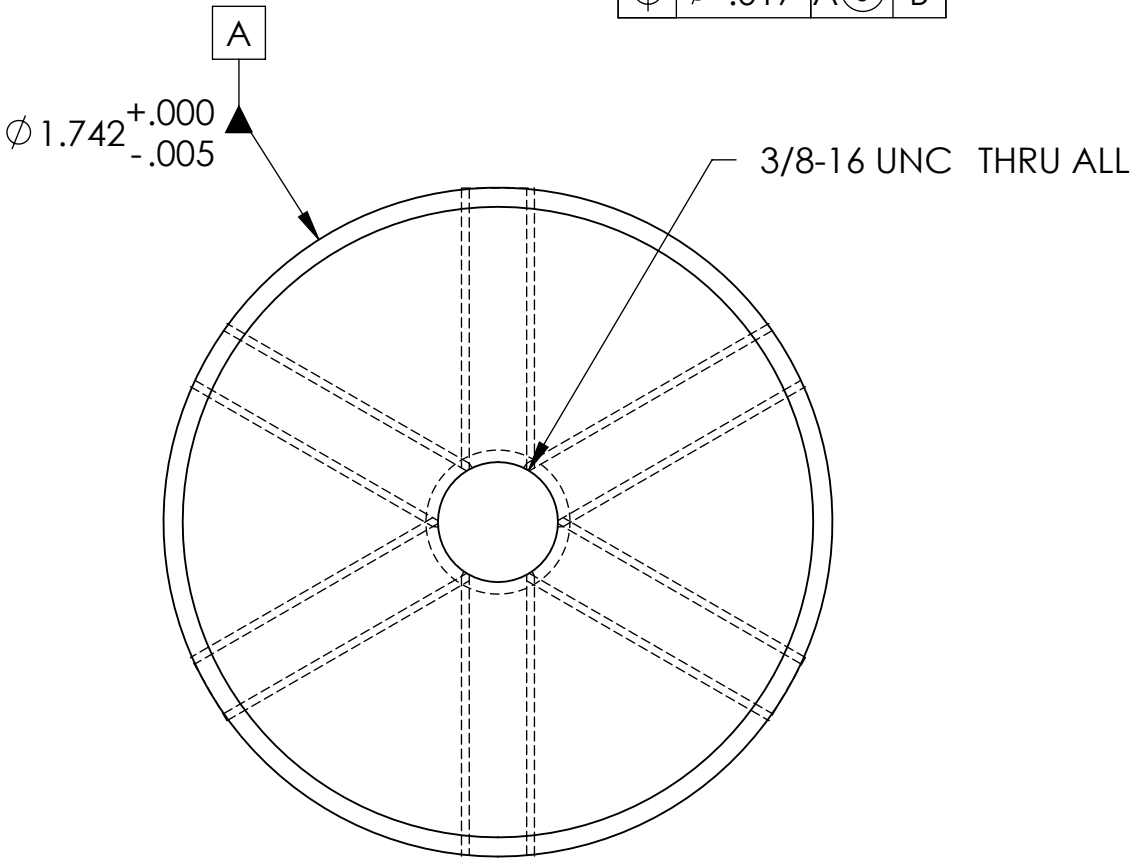

SECTION A-A

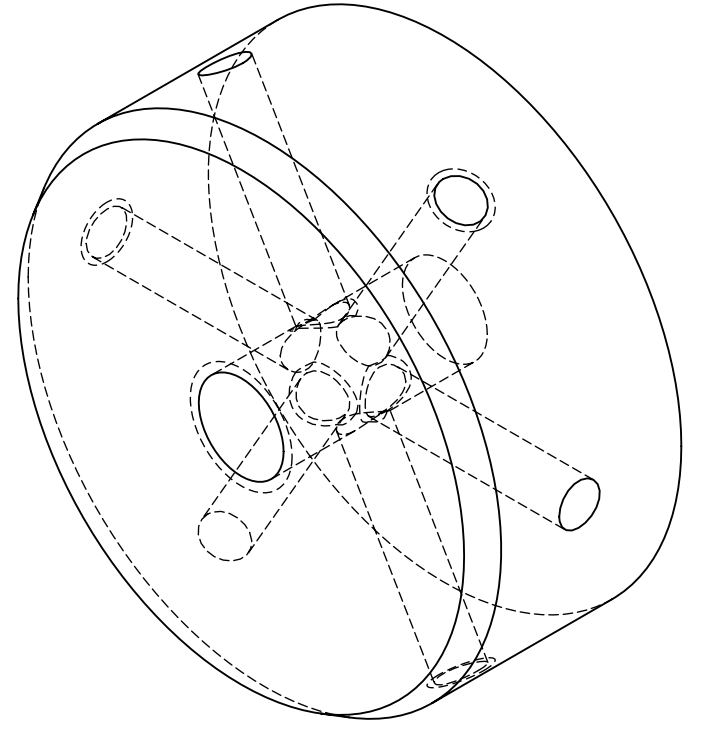

D  
C  
B  
A

D1000242 cLIGO\_ETM\_Tele\_Tube\_THD\_Insert, Part PDM Rev: X-013, Drawing PDM Rev: X-003

NOTES AND TOLERANCES: (UNLESS OTHERWISE SPECIFIED)				LIGO CALIFORNIA INSTITUTE OF TECHNOLOGY MASSACHUSETTS INSTITUTE OF TECHNOLOGY		PART NAME	
DIMENSIONS ARE IN INCHES				SYSTEM aLIGO AOS		SUB-SYSTEM AOS	
TOLERANCES: .XX $\pm$ .01 .XXX $\pm$ .005				NEXT ASSY D1000243		DESIGNER	
ANGULAR $\pm$ 0.5°				MATERIAL 6061-T6 Al		DRAFTER I ROMERO 04/MAY/2010	
1. INTERPRET DRAWING PER ASME Y14.5-1994. 2. REMOVE ALL SHARP EDGES, R.02 MIN. 3. DO NOT SCALE FROM DRAWING. 4. ALL MACHINING FLUIDS MUST BE FULLY SYNTHETIC, FULLY WATER SOLUBLE AND FREE OF SULFUR, SILICONE, AND CHLORINE.				FINISH 63 $\mu$ inch		CHECKER K MAILAND 04/MAY/2010	
						APPROVAL K MAILAND 04/MAY/2010	
						SCALE: 2:1	
						PROJECTION:	
						SHEET 1 OF 1	
						PART NAME ALIGO ETM TELE TUBE THD INSERT	
						SIZE DWG. NO. B D1000242	
						REV. v1	