

REV.	DATE	DCN #	DRAWING TREE #
v1	21 DEC 2009	E0900484	-
v2	06 JUN 2011	E1100531-x0	-
-	-	-	-

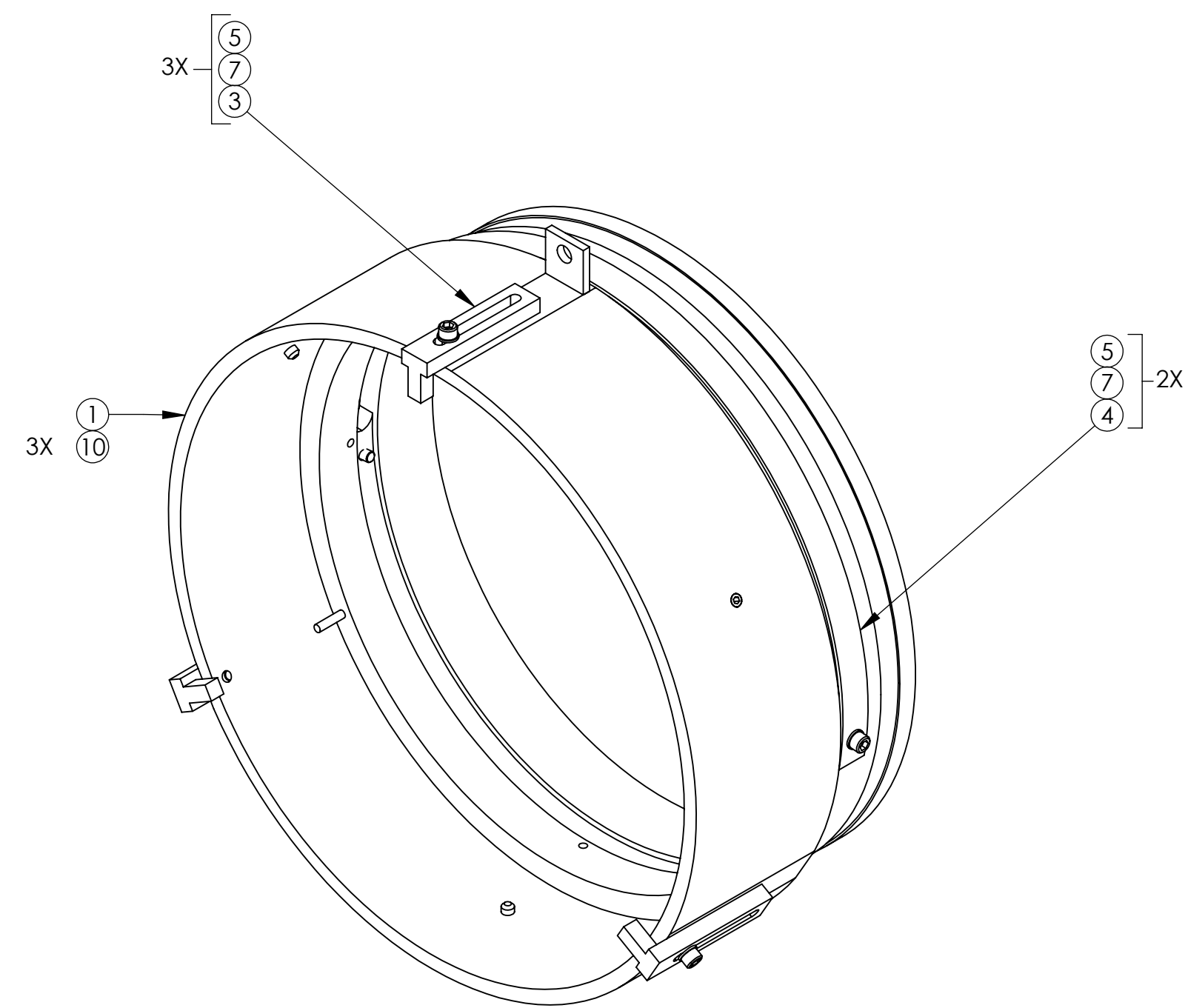

-1 DETAIL  
(WITH DUST COVER)

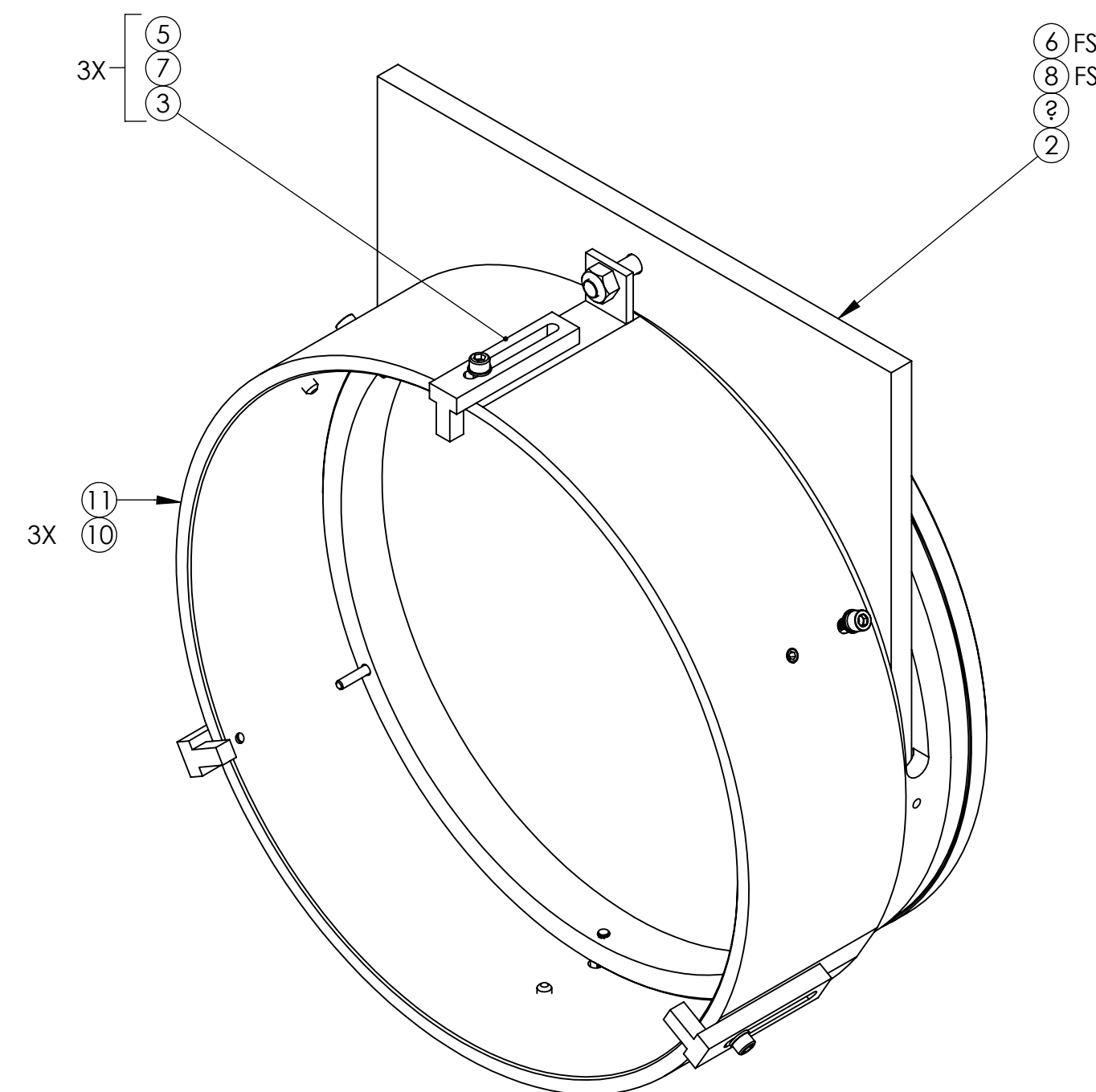

-2 DETAIL  
(WITH SHIELD)

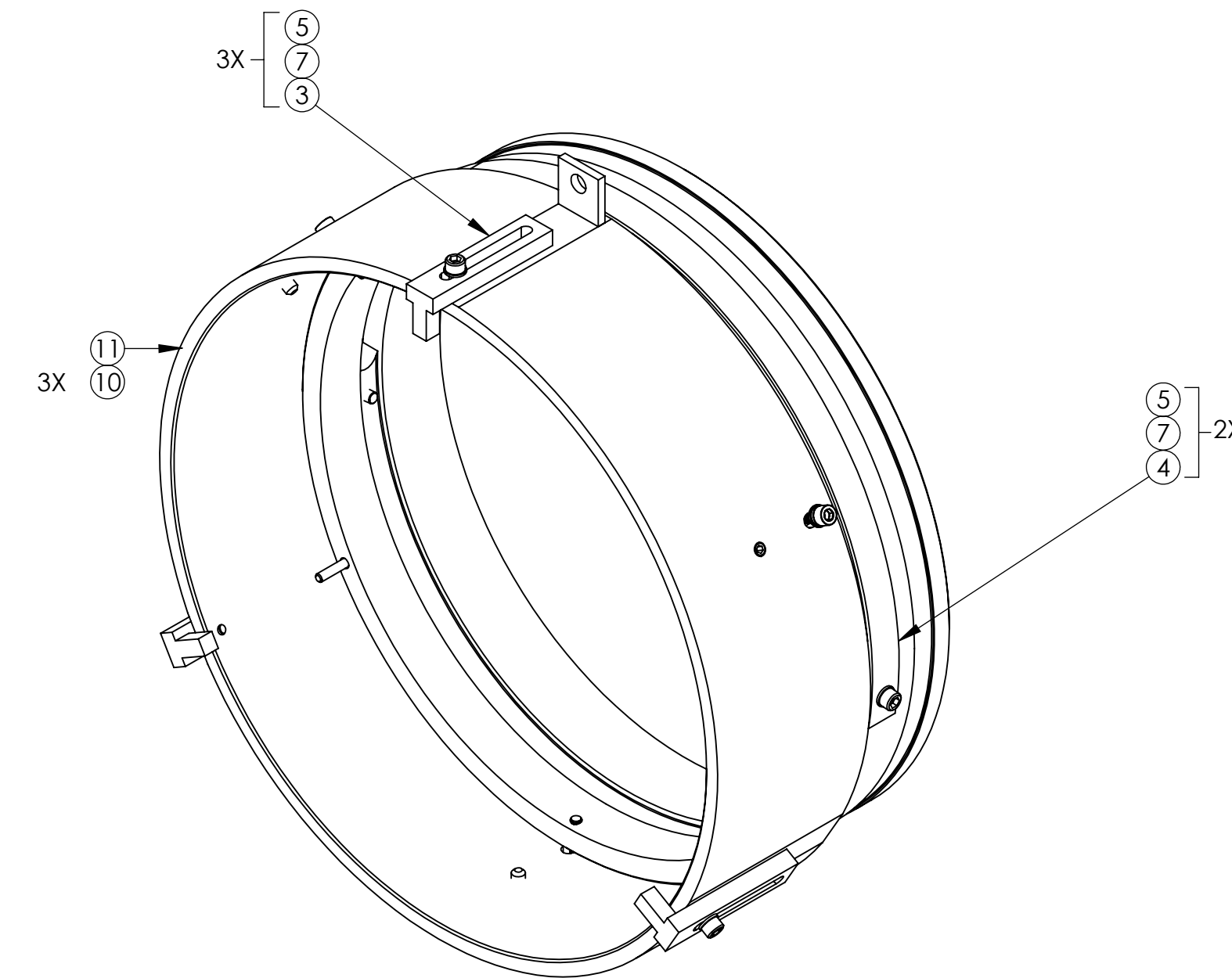

-3 DETAIL  
(WITH DUST COVER)

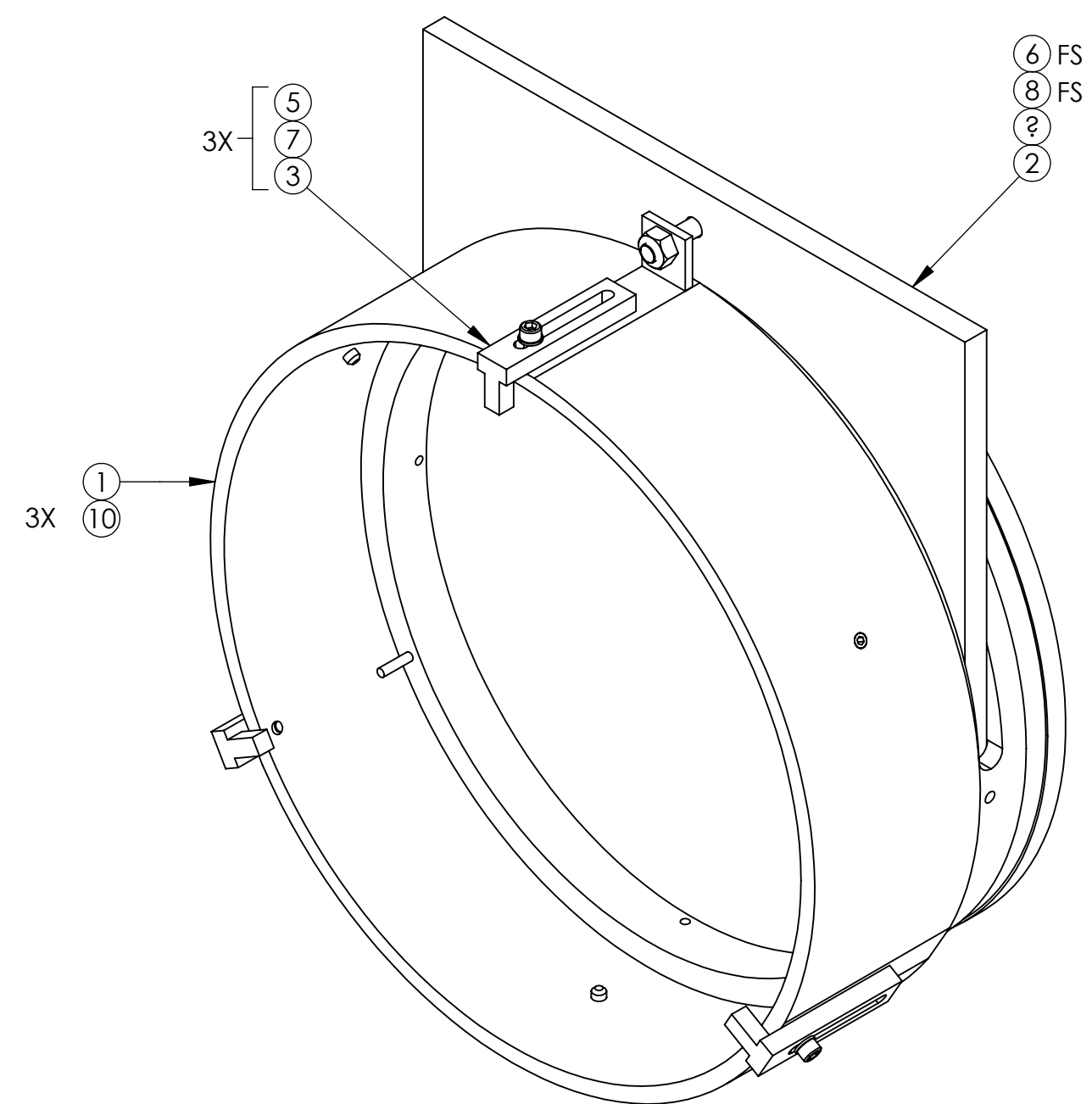

BASIC DETAIL  
(WITH SHIELD)

ITEM NO.	PART NUMBER	DESCRIPTION	MATERIAL	D080367/QTY.	D080367-1/QTY.	D080367-2/QTY.	D080367-3/QTY.
11	D1101171	ALIGO, VE, VIEWPORT GUARD ASSY., MULTI-PIECE	N/A	-	-	1	1
10	90251A256	SCREW, SOCKET SET, #10-32 UNF-2A X 0.375 LONG	18-8 SSSL	3	3	3	3
9	N-2520-A	HEX NUT 1/4-20	Ag-PLATED 300 SSSL	1	-	1	-
8	NAS620-C416	WASHER, FLAT, 1/4	300 SSSL	1	-	1	-
7	NAS620-C8	WASHER, FLAT, NO.8	300 SSSL	3	5	3	5
6	MS16995-53	SCREW, SHC, 1/4-20 X 1.25 LG.	300 SSSL	1	-	1	-
5	MS16995-26	SCREW, SHC, 8-32 X 0.5 LG.	300 SSSL	3	5	3	5
4	D0902791	VIEWPORT GUARD DUST COVER	6061-T6 Al	-	1	-	1
3	D080391	CLAMP, VIEWPORT GUARD	6061-T6 Al	3	3	3	3
2	D080366	VIEWPORT SHIELD	AR POLYCARBONATE	1	-	1	-
1	D080365	VIEWPORT GUARD	N/A	1	1	-	-

**NOTES**  
1. DUST COVER (ITEM 4) IS TO BE USED WHENEVER SHIELD (ITEM 3) IS NOT IN PLACE.

**LIGO** CALIFORNIA INSTITUTE OF TECHNOLOGY  
MASSACHUSETTS INSTITUTE OF TECHNOLOGY

SYSTEM: ADVANCED LIGO  
SUB-SYSTEM: VE  
NEXT ASSY: MULTIPLE

**PART NAME**  
VIEWPORT GUARD ASSEMBLY

DESIGNER: M. MEYER, 17 JUL 2008  
DRAFTER: M. MEYER, 11 DEC 2009  
CHECKER: D. BRIDGES, 14 DEC 2009  
APPROVAL:

SCALE: 1:2  
PROJECTION:

SIZE: D  
DWG. NO.: D080367  
REV.: v2

SHEET 1 OF 1

D080367\_d1101171\_V1\_ViewPort Guard Assembly\_PART PDM\_REV: X:007\_DRAWING PDM\_REV: V1:006