

REV.	DATE	DCN #	DRAWING TREE #
A	24 JUNE 2004	E040303-00	-
v1	30 DEC 2009	E0900503	E0900353
-	-	-	-

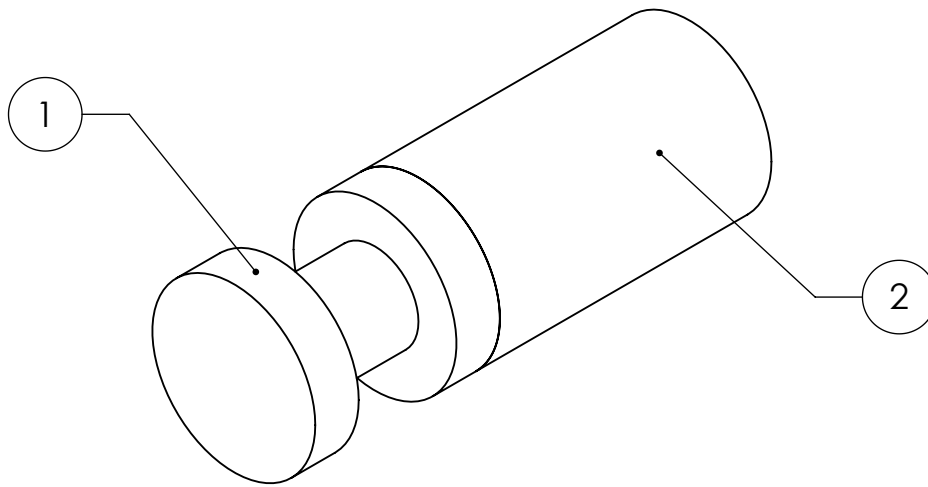

ITEM NO.	PART NUMBER	DESCRIPTION	MATERIAL	REQ	SPARE	TOTAL
3	-	UHV-COMPATIBLE ADHESIVE (CERAMABOND #835M OR EQUIVALENT)	-	A/R	-	A/R
2	D0901927	SINTERED SmCo MAGNET, \varnothing 0.075 X 0.125 LONG	SmCo	1	-	1
1	D970075	DUMBBELL STANDOFF	6061-T6 Al	1	-	1
PARTS LIST						

NOTES: (UNLESS OTHERWISE SPECIFIED)

1. INTERPRET DRAWING PER ASME Y14.5-1994.
2. DO NOT SCALE FROM DRAWING.
3. ASSEMBLE ACCORDING TO LIGO-E990196, MAGNET/STANDOFF ASSEMBLY PREPARATION SPECIFICATION.



CALIFORNIA INSTITUTE OF TECHNOLOGY
MASSACHUSETTS INSTITUTE OF TECHNOLOGY

SYSTEM
ADVANCED LIGO
NEXT ASSY

SUB-SYSTEM
SUS

D0901873

PART NAME

MAGNET-STANDOFF ASSEMBLY, INT. MASS

DESIGNER J. ROMIE FEB 2003
DRAFTER M. MEYER 19 NOV 2009
CHECKER D. BRIDGES 19 NOV 2009
APPROVAL

SIZE DWG. NO.
A D020661

REV.
v1

SCALE: 16:1 PROJECTION: SHEET 1 OF 1