

D0902663_Advanced_LIGO_SUS_HLTS_Sapphire_Holder_Assembly, PART PDM REV: X-007, DRAWING PDM REV: X-003

REV.	DATE	DCN #	DRAWING TREE #
v1	22 OCT 2009	E0900369	E080191
-	-	-	-
-	-	-	-

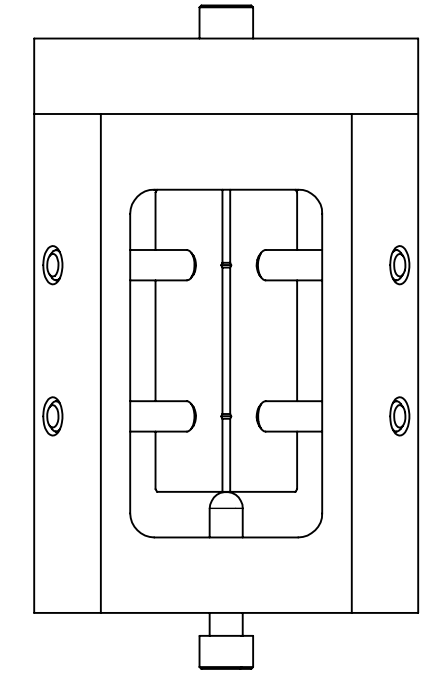
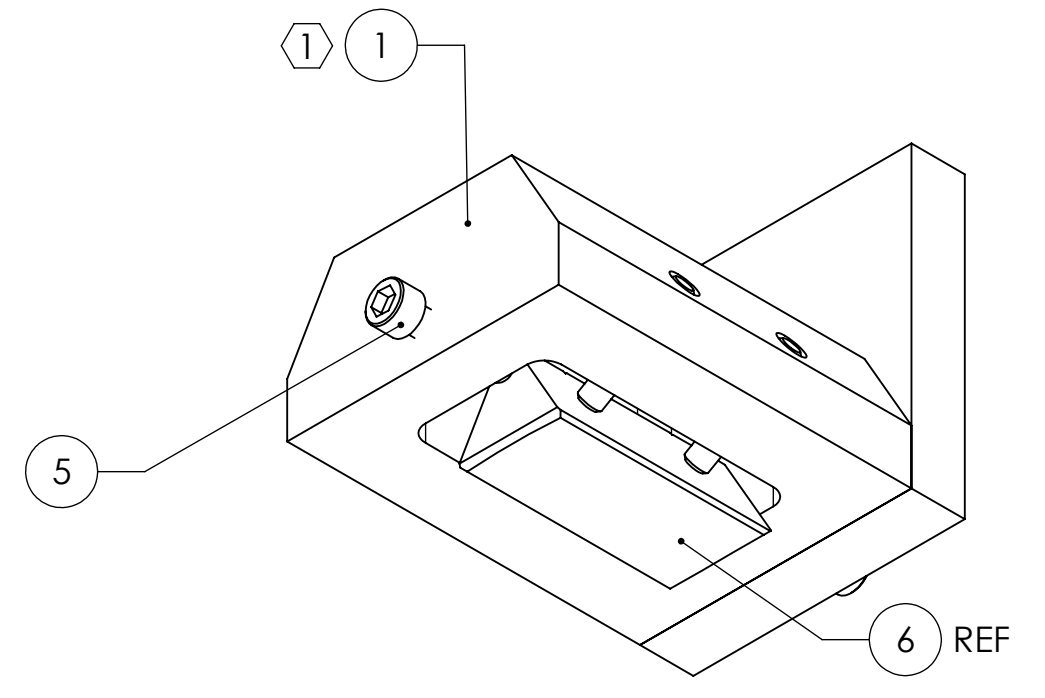
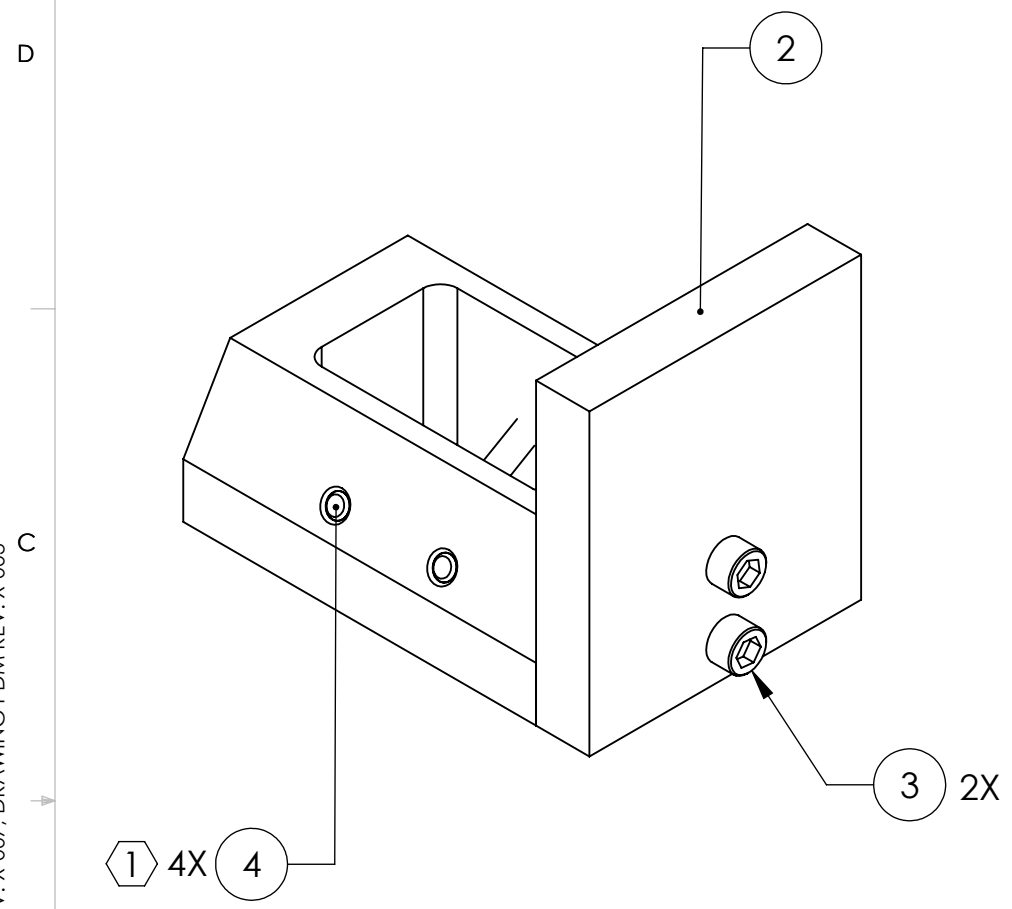

TOP VIEW

ITEM NO.	PART NUMBER	DESCRIPTION	MATERIAL	REQ	SPARE	TOTAL
6	D070441	PRISM BREAKOFF WIRE LOOP	SAPPHIRE	REF	0	0
5	D080468	SCREW, SOCKET HEAD CAP, #2-56 UNC-2A X 0.375 LONG, FULLY THREADED, ROUNDED END	300 SSSL	1	1	2
4	91585A018	DOWEL PIN, ϕ 2 mm X 10 mm LONG (MCMaster CARR P/N) 1	300 SSSL	4	1	5
3	-	SCREW, SOCKET HEAD CAP, #2-56 UNC-2A X 0.375 LONG	300 SSSL	2	1	3
2	D0902722	SAPPHIRE PRISM HOLDER EXTENSION	6061-T6 Al	1	0	1
1	D0902664	SAPPHIRE PRISM HOLDER 1	6061-T6 Al	1	1	2

PARTS LIST

NOTES AND TOLERANCES: (UNLESS OTHERWISE SPECIFIED)

1 PRESS FIT DOWEL PINS INTO HOLES FLUSH WITH PRISM HOLDER SURFACE, AFTER ALL PARTS ARE CLEANED AND BAKED.

MATERIAL: N/A
FINISH: N/A μ inch

LIGO CALIFORNIA INSTITUTE OF TECHNOLOGY
MASSACHUSETTS INSTITUTE OF TECHNOLOGY

SYSTEM: **ADVANCED LIGO** SUB-SYSTEM: **SUS**

NEXT ASSY: **SAPPHIRE PRISM BONDING JIG, HLTS**

PART NAME: **SAPPHIRE PRISM HOLDER ASSY**

DESIGNER	D. BRIDGES	12 NOV 2009	SIZE	DWG. NO.	REV.
DRAFTER	D. BRIDGES	18 NOV 2009	B	D0902663	v1
CHECKER	M. MEYER	19 NOV 2009			
APPROVAL					

SCALE: 2:1 PROJECTION: SHEET 1 OF 1

8 7 6 5 4 3 2 1

8 7 6 5 4 3 2 1