

NOTES:
 ① HELICOILS TO BE INSTALLED INTO ITEM NO. 3 BY LIGO PRIOR TO ASSEMBLY AND AFTER ALL PARTS ARE CLEANED AND BAKED.

REV.	DATE	DCN #	DRAWING TREE #
v1	09 APR 2010	E0900502	E0900353
v2	02 SEP 2010	E1000347	E0900353
-	-	-	-

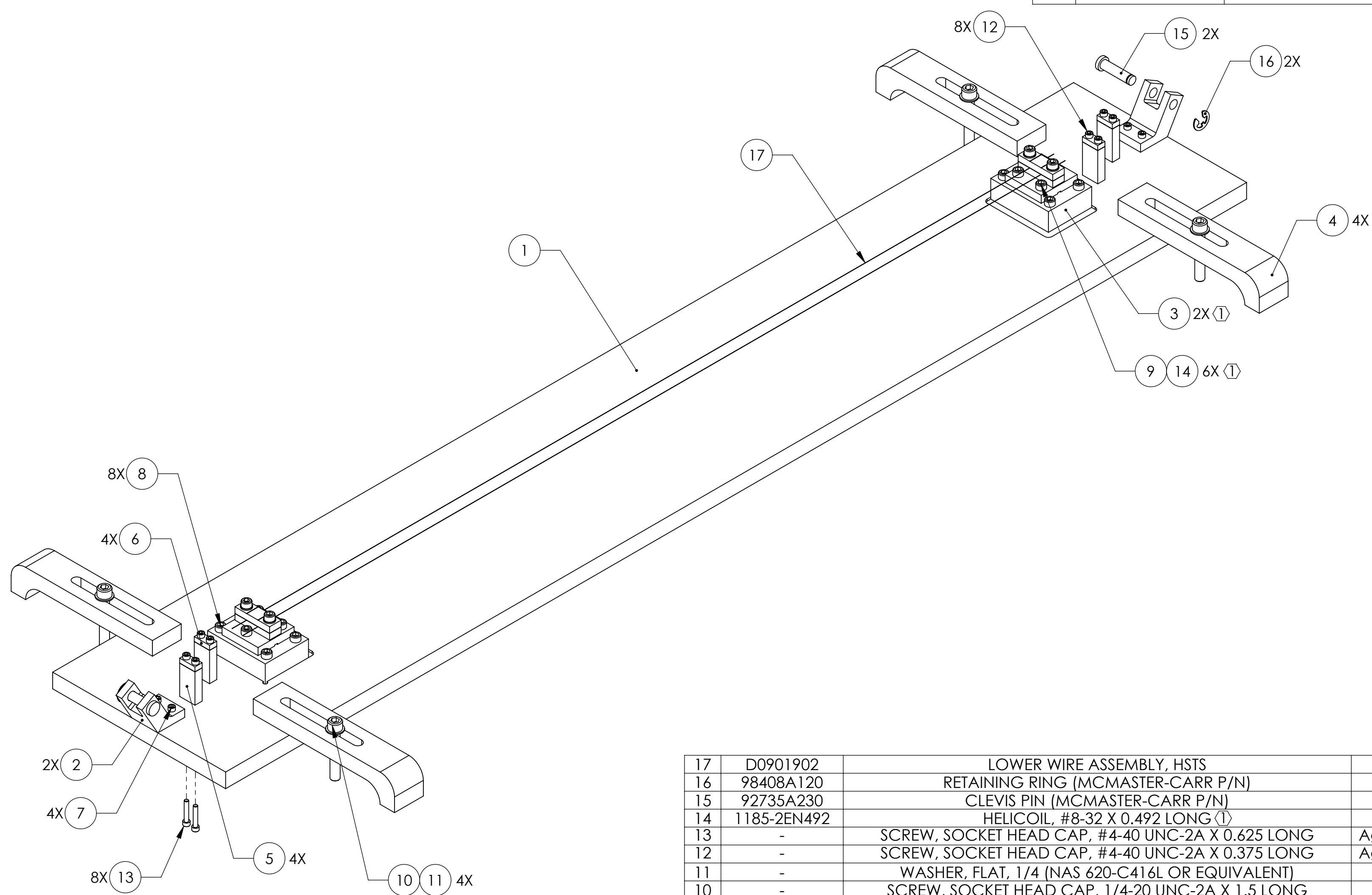

ITEM NO.	PART NUMBER	DESCRIPTION	MATERIAL	REQ	SPARE	TOTAL
17	D0901902	LOWER WIRE ASSEMBLY, HSTS	N/A	REF	-	REF
16	98408A120	RETAINING RING (MCMMASTER-CARR P/N)	300 SSSL	2	1	3
15	92735A230	CLEVIS PIN (MCMMASTER-CARR P/N)	300 SSSL	2	-	2
14	1185-2EN492	HELICOIL, #8-32 X 0.492 LONG ①	NITRONIC 60	6	2	8
13	-	SCREW, SOCKET HEAD CAP, #4-40 UNC-2A X 0.625 LONG	Ag-PLATED 300 SSSL	8	2	10
12	-	SCREW, SOCKET HEAD CAP, #4-40 UNC-2A X 0.375 LONG	Ag-PLATED 300 SSSL	8	2	10
11	-	WASHER, FLAT, 1/4 (NAS 620-C416L OR EQUIVALENT)	300 SSSL	4	1	5
10	-	SCREW, SOCKET HEAD CAP, 1/4-20 UNC-2A X 1.5 LONG	300 SSSL	4	1	5
9	-	SCREW, SOCKET HEAD CAP, #8-32 UNC-2A X 0.5 LONG	300 SSSL	6	1	7
8	-	SCREW, SOCKET HEAD CAP, #8-32 UNC-2A X 1 LONG	300 SSSL	8	2	10
7	-	SCREW, SOCKET HEAD CAP, #4-40 UNC-2A X 0.5 LONG	300 SSSL	4	1	5
6	D1000583	WIRE START CLAMP, TOP	304, 316 OR 302 SSSL	4	-	4
5	D1000588	WIRE START POST, LOWER WIRE JIG	304, 316 OR 302 SSSL	4	-	4
4	D980184	LOS CLAMP, LONG	304, 316 OR 302 SSSL	4	-	4
3	D0902539	WIRE CLAMP BLOCK, HSTS LOWER WIRE JIG ①	6061-T6 Al	2	-	2
2	D0900563	PIN SUPPORT, WIRE JIG	6061-T6 Al	2	-	2
1	D0902540	BASE PLATE, HSTS LOWER LOOP WIRE JIG	6061-T6 Al	1	-	1

PARTS LIST

CALIFORNIA INSTITUTE OF TECHNOLOGY MASSACHUSETTS INSTITUTE OF TECHNOLOGY		PART NAME				LOWER WIRE JIG ASSY, HSTS	
		SYSTEM ADVANCED LIGO		SUB-SYSTEM SUS			
NEXT ASSY D040391		DESIGNER M. MEYER		29 OCT 2009		SIZE DWG. NO.	
		DRAFTER W. RASCH		02 NOV 2009		D0902524	
CHECKER M. MEYER		02 NOV 2009		SCALE: 1:2			
		APPROVAL		SHEET 1 OF 1		REV. v2	