

REV.	DATE	DCN #	DRAWING TREE #
v1	15 SEP 2009	E0900302	E080191
-	-	-	-
-	-	-	-

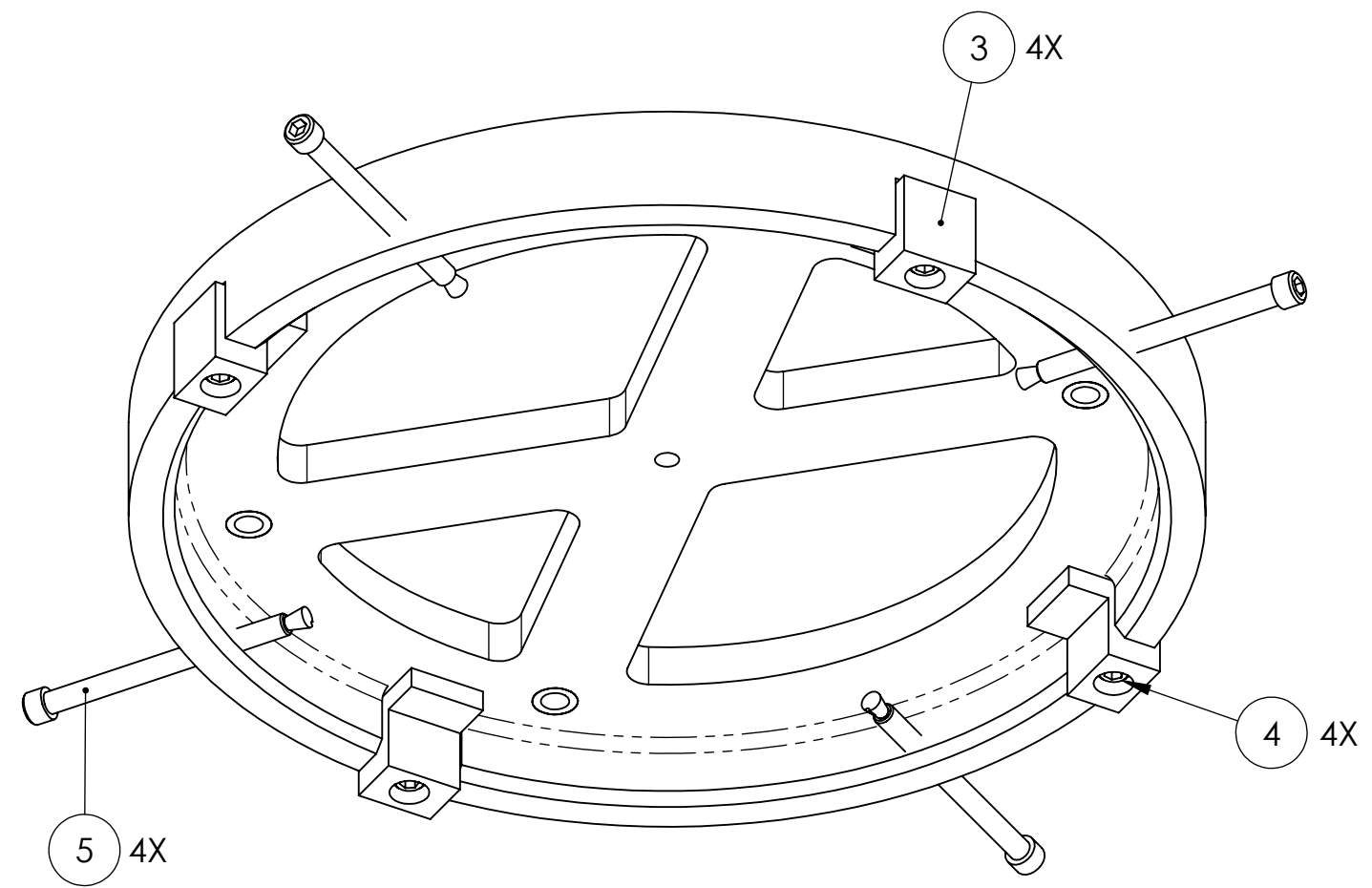
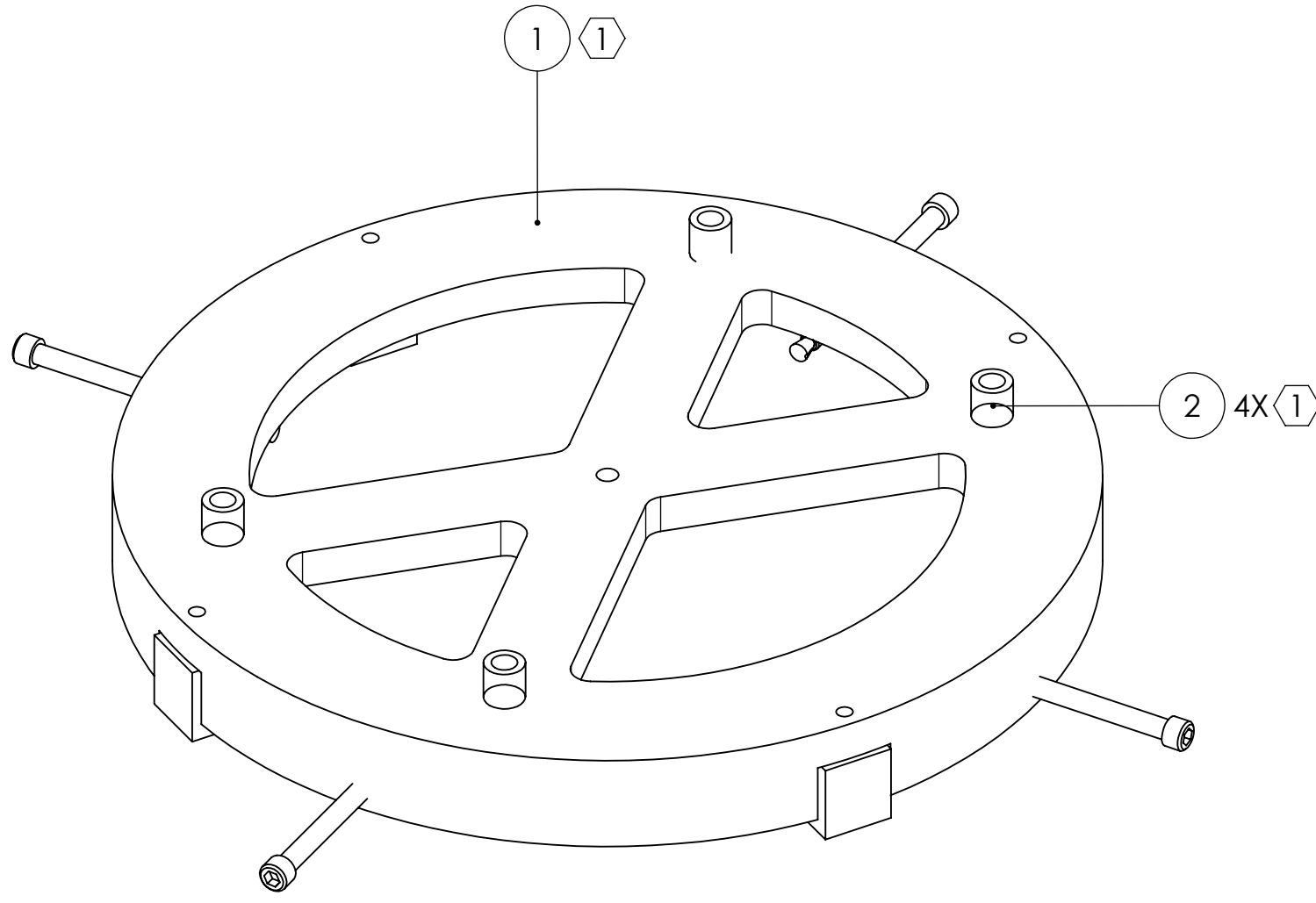

ITEM NO.	PART NUMBER	DESCRIPTION	MATERIAL	REQ	SPARE	TOTAL
5	D970562	BEAMSPLITTER CHAMFER STOP	N/A	4	1	5
4	-	SCREW, SOCKET HEAD CAP, 1/4-20 UNC-2A X 1 LONG	300 SSTL	4	1	5
3	D0902069	STANDOFF BLOCK	PFA440 HP (PRESHRUNK)	4	1	5
2	8504A135	PRESS-FIT DRILL BUSHING (MCMASTER CARR P/N) (1)	300 SSTL	4	1	5
1	D0902068	STANDOFF RING (1)	6061-T6 AI	1	0	1
PARTS LIST						

NOTES AND TOLERANCES: (UNLESS OTHERWISE SPECIFIED)

(1) DRILL BUSHING (ITEM NO. 2) TO BE PRESS-FIT INTO ITEM NO. 1 AFTER ALL PARTS ARE CLEANED AND BAKED.

MATERIAL: N/A

FINISH: N/A μ inch

LIGO CALIFORNIA INSTITUTE OF TECHNOLOGY
 MASSACHUSETTS INSTITUTE OF TECHNOLOGY

SYSTEM: ADVANCED LIGO SUB-SYSTEM: SUS

NEXT ASSY: MAGNET PLACEMENT FIXTURE, TEST MASS

PART NAME: **POSITIONING STANDOFF**

DESIGNER: D. BRIDGES 16 SEP 2009 SIZE: C DWG. NO.: **D0902087** REV.: v1

DRAFTER: D. BRIDGES 4 OCT 2009

CHECKER: M. MEYER 5 OCT 2009

APPROVAL: _____

SCALE: 1:2 PROJECTION: SHEET 1 OF 1