

4 HOLES DR Ø2 TO BREAK INTO Ø6.6 HOLE

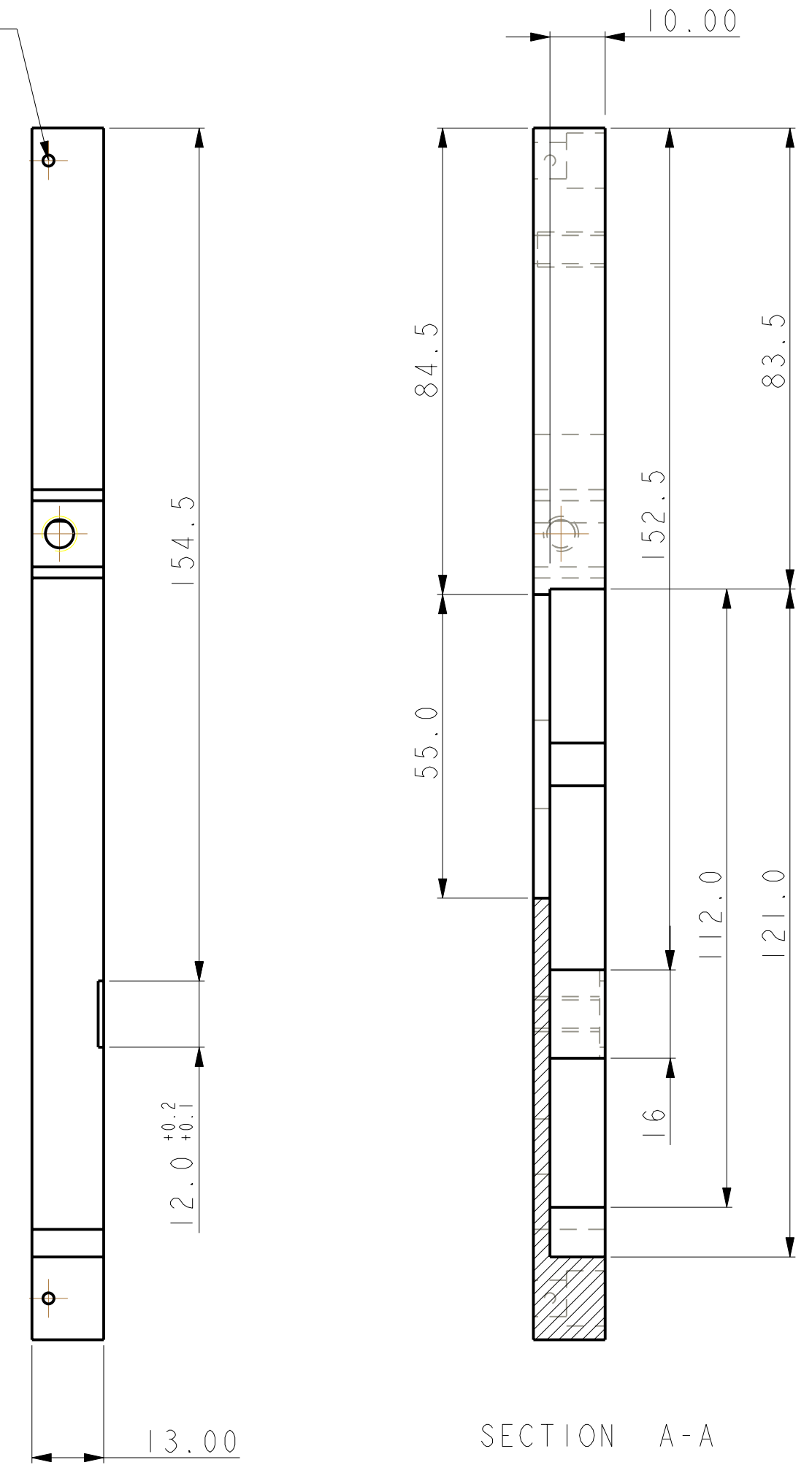

SECTION A-A

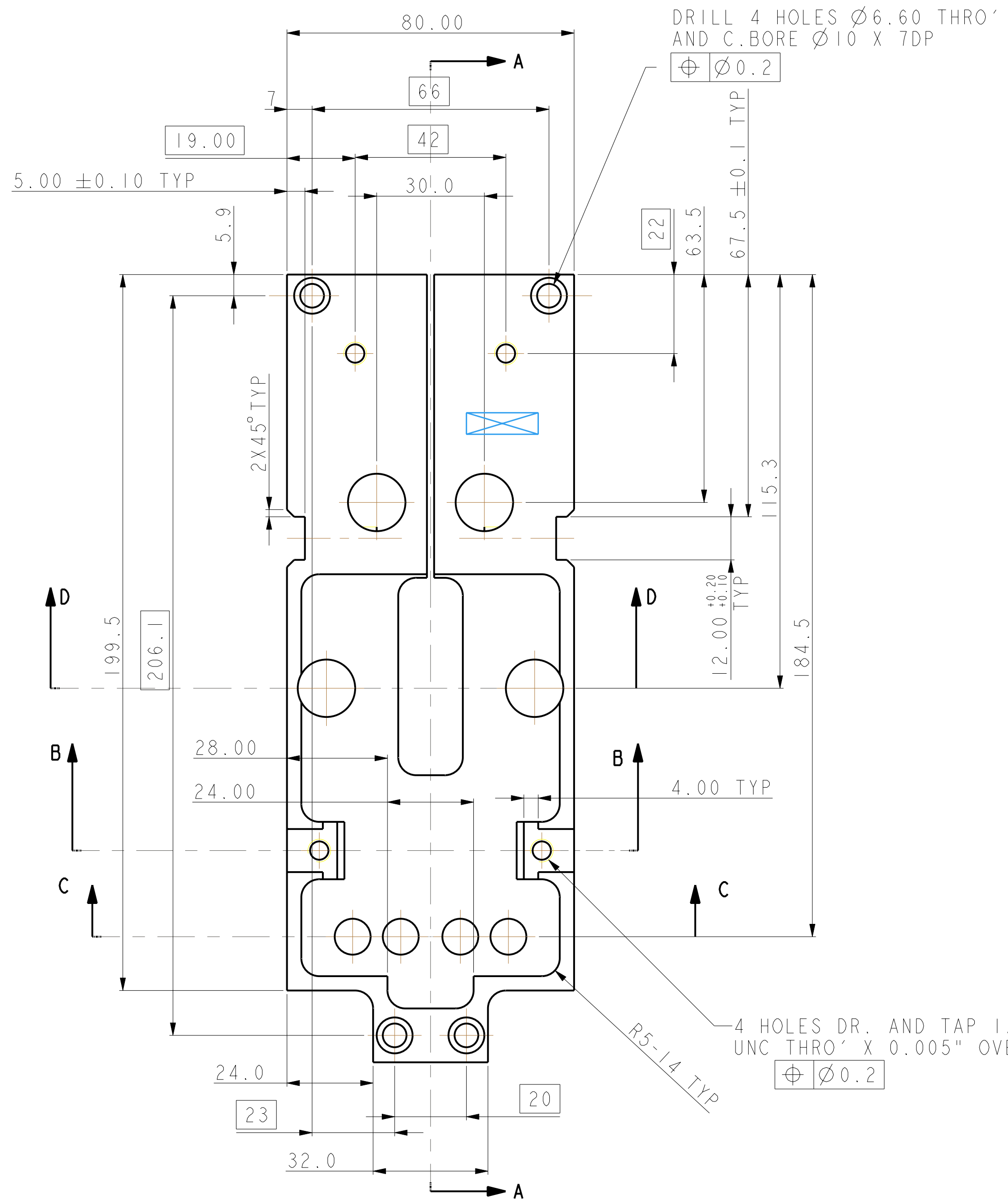

4 HOLES DR. AND TAP 1/4 - 20 UNC THRO' X 0.005" OVERSIZE
Ø0.2

SECTION D-D

SECTION B-B

SECTION C-C

PART # (SEE NOTE 4) TO BE ETCHED OR STAMPED IN APPROX. POSITION SHOWN

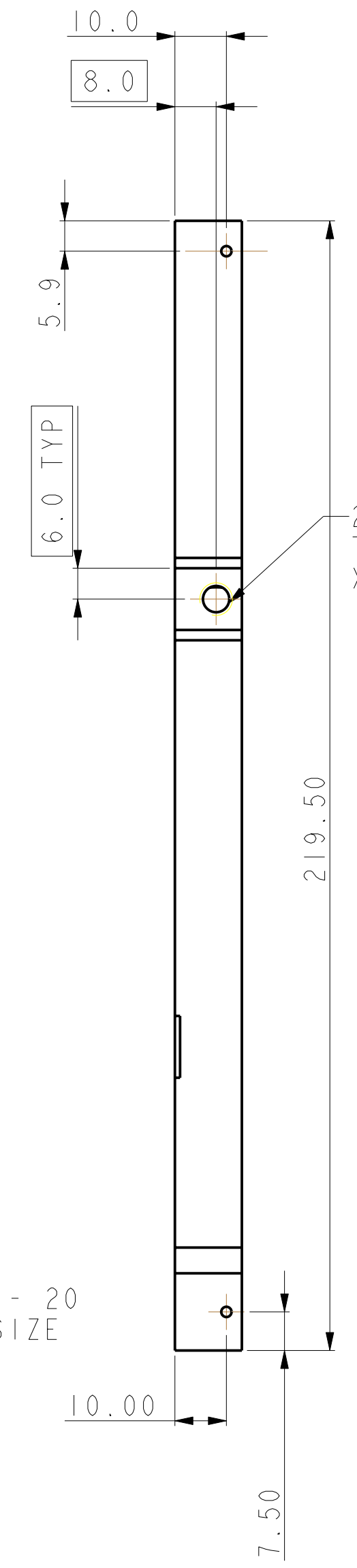

2 HOLES DR 24 DEEP & TAP 1/4" - 20UNC 22 DEEP X 0.005" OVERSIZE
Ø0.2

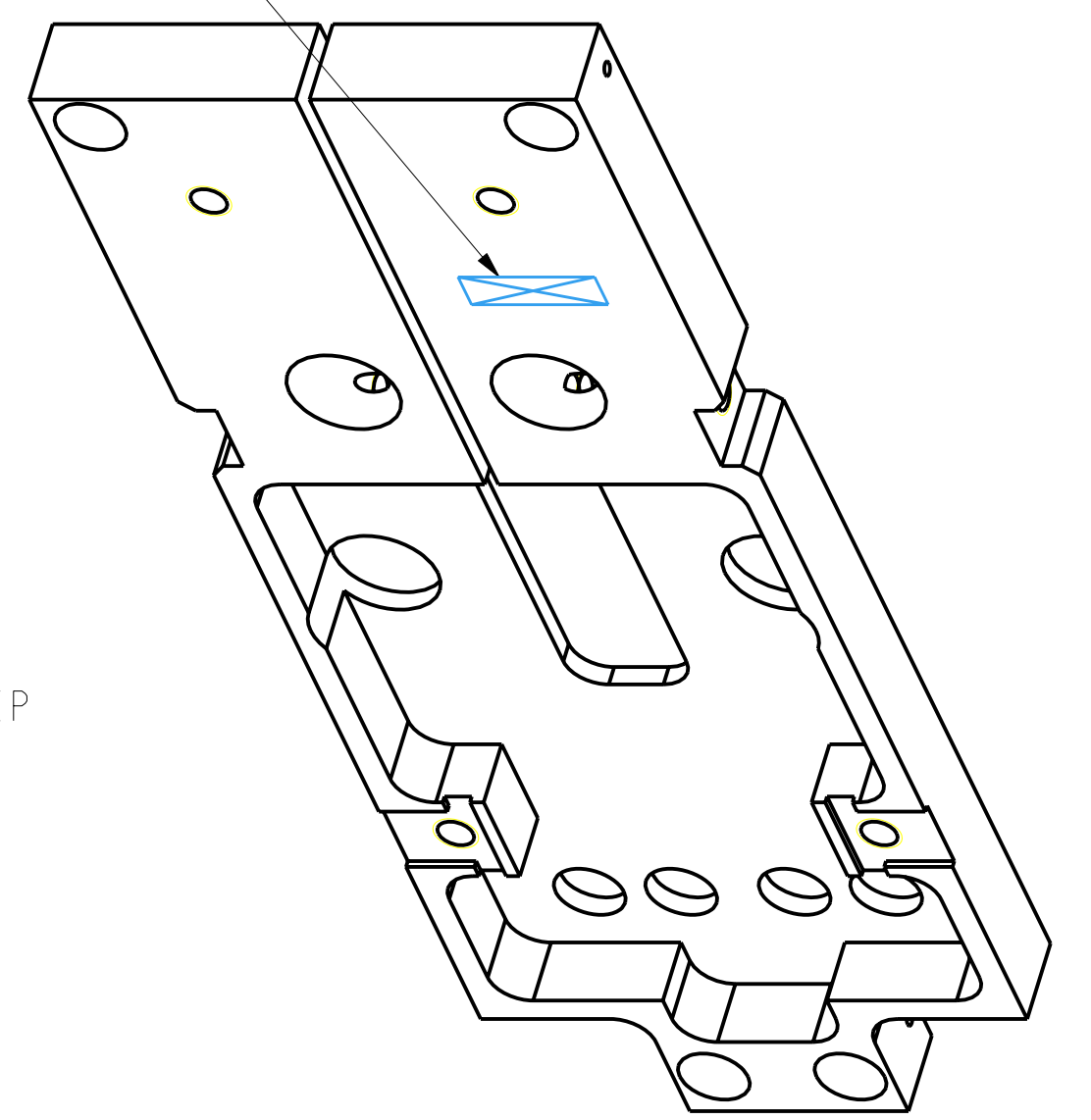

3D VIEW

NOTES: (UNLESS OTHERWISE SPECIFIED)

- REMOVE ALL SHARP EDGES. R.02 MIN.
- DO NOT SCALE FROM DRAWING.
- ALL MACHINING FLUIDS SHALL BE WATER SOLUBLE AND FREE OF SULFUR, CHLORINE AND SILICONE. SUCH AS CINCINNATI MILACRON'S CIMTECH 410 (STAINLESS STEEL).
- SCRIBE, ENGRAVE OR STAMP DRAWING PART NUMBER ON NOTED SURFACE OF PART AND A THREE DIGIT SERIAL NUMBER. SERIAL NUMBERS START AT 001 FOR THE FIRST PART AND PROCEED CONSECUTIVELY. USE 07* HIGH CHARACTERS. EXAMPLE: 000100-001 - A VIBRATORY TOOL MAY BE USED.

DIMENSIONS ARE IN mm (INCHES)
TOLERANCES:
X XX ± 0.2
ANGULAR ±0.250°

MATERIAL: AL ALLOY
S803 OR SIMILAR

FINISH: CLEAN, GREASE FREE
√(um) (10µin) Ra = 1.6

NAME	DATE	BY

DRAWN: J'00
CHECKED: J'00
APPROVED: J'00

SCALE: 1:1 PROJECTION:

SYSTEM: ADVANCED LIGO	SUB-SYSTEM: SUS	NEXT ASSY: D070435	PART NAME: TOP PLATE
DRG. NO.: D070430	BY: E	SHEET 1 OF 1	