

⑤ PLEASE SEE E1200145 FOR OPTIC ORIENTATION AND WEDGE ANGLE.
 ⑥ ALIGN SPACER, F/N 10, AT A 45° ANGLE.

REV.	DATE	DCN #	DRAWING TREE #
v1	30 DEC 2009	E0900507	E0900353
v2	20 JUN 2011	E1100590	E0900353
v3	09 OCT 2012	E1200887	E0900353

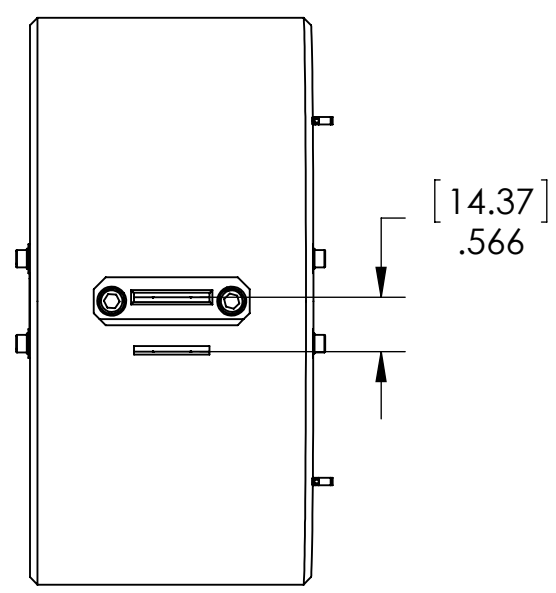
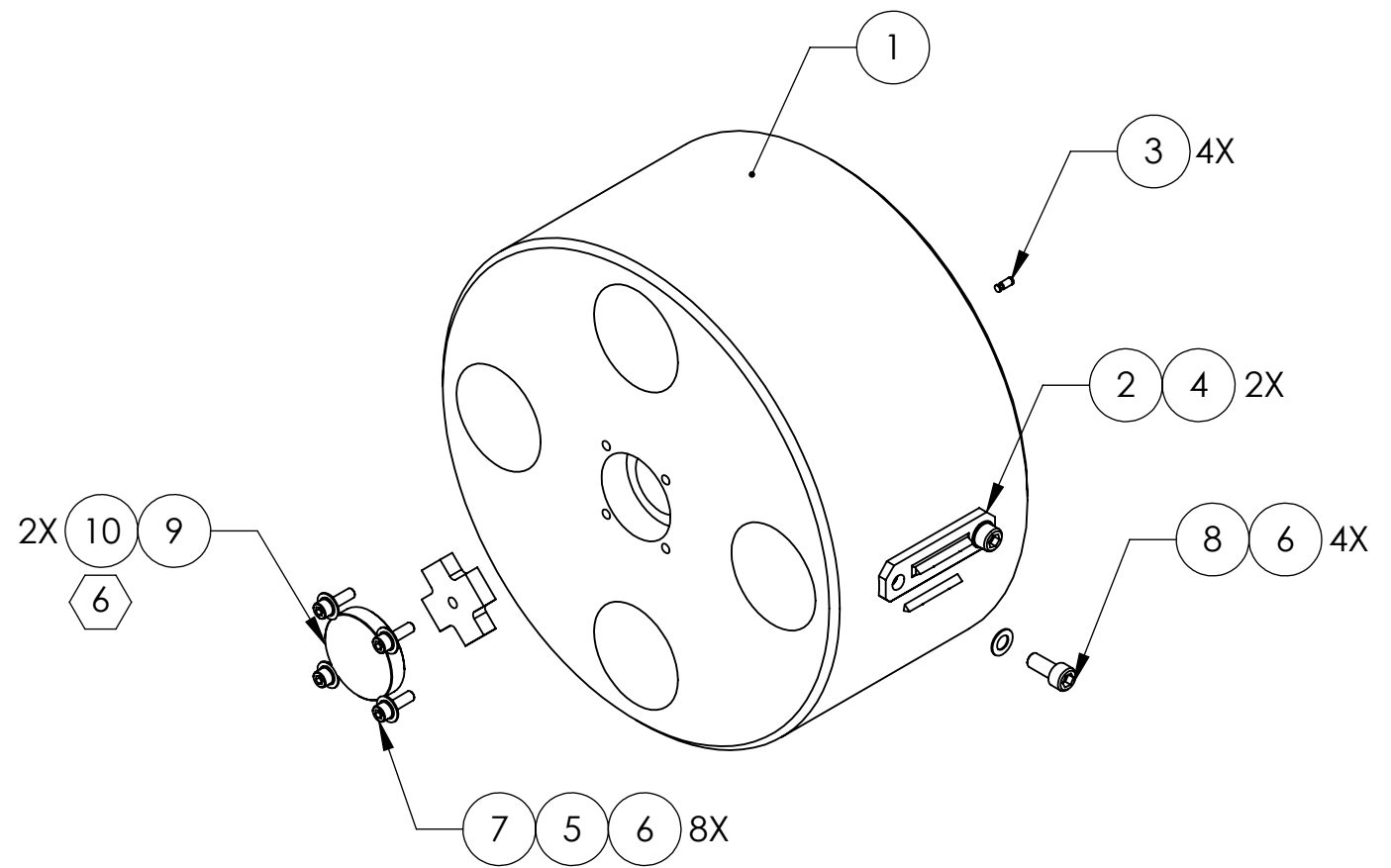
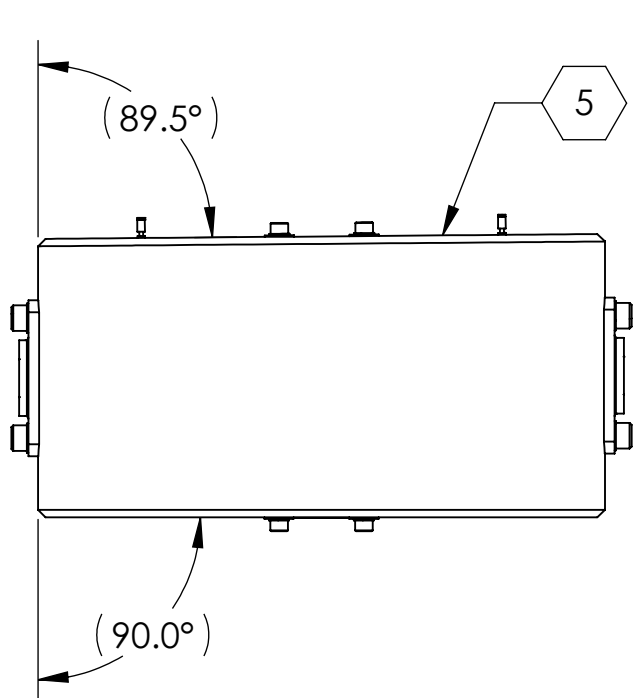

ITEM NO.	PART NUMBER	DESCRIPTION	MATERIAL	REQ	SPARE	TOTAL
11	-	UHV-COMPATIBLE ADHESIVE (MASTERBOND EP30-2 OR EQUIVALENT)	-	A/R	-	A/R
10	D1100197	SPACER, BOTTOM MASS OPTIC, HLTS/HSTS	-	2	1	3
9		METALLIZED MIRROR, ROUND (OPTOSIGMA P/N 033-0280 OR EQUIVALENT)	-	2	1	3
8	-	SCREW, SOCKET HEAD CAP, #8-32 UNC-2A X 0.375 LONG	300 SSSL	4	1	5
7	-	SCREW, SOCKET HEAD CAP, #4-40 UNC-2A X 0.375 LONG	300 SSSL	8	2	10
6	-	WASHER, FLAT, #8 (NAS 620-C8L OR EQUIVALENT)	300 SSSL	12	3	15
5	-	WASHER, FLAT, #4 (NAS 620-C4L OR EQUIVALENT)	300 SSSL	8	2	10
4	D0901278	HSTS SECONDARY METAL PRISM	304, 316 OR 302 SSSL	2	1	3
3	D0902432	MAGNET/STANDOFF ASSEMBLY, HSTS TEST MASS	N/A	4	1	5
2	D0901790	PRIMARY METAL BREAKOFF PRISM, HSTS	304, 316 OR 302 SSSL	2	-	2
1	D020234	METAL LOWER MASS (MC), HSTS	6061-T6 Al	1	-	1
PARTS LIST						

NOTES: (UNLESS OTHERWISE SPECIFIED)
 1. PARTS TO BE ASSEMBLED ACCORDING TO E030518, HSTS ASSEMBLY SPECIFICATION, USING D020427, HSTS MAGNET PLACEMENT FIXTURE.

CALIFORNIA INSTITUTE OF TECHNOLOGY MASSACHUSETTS INSTITUTE OF TECHNOLOGY		PART NAME METAL LOWER MASS ASSEMBLY (MC), HSTS	
SYSTEM ADVANCED LIGO	SUB-SYSTEM SUS	DESIGNER M. MEYER	DATE 17 AUG 2009
DRAFTER B. MOORE	CHECKER D. BRIDGES	DATE 23 OCT 2012	DATE 08 JUN 2012
NEXT ASSY D020700	APPROVAL	SIZE B	DWG. NO. D0901791
		SCALE: 1:2	PROJECTION:
		SHEET 1 OF 1	REV. v3

D0901791_alIGO_SUS_HSTS_Metal Lower Mass (MC) Assembly, PART PDM REV: V1-031, DRAWING PDM REV: V1-000