

SECTION A-A

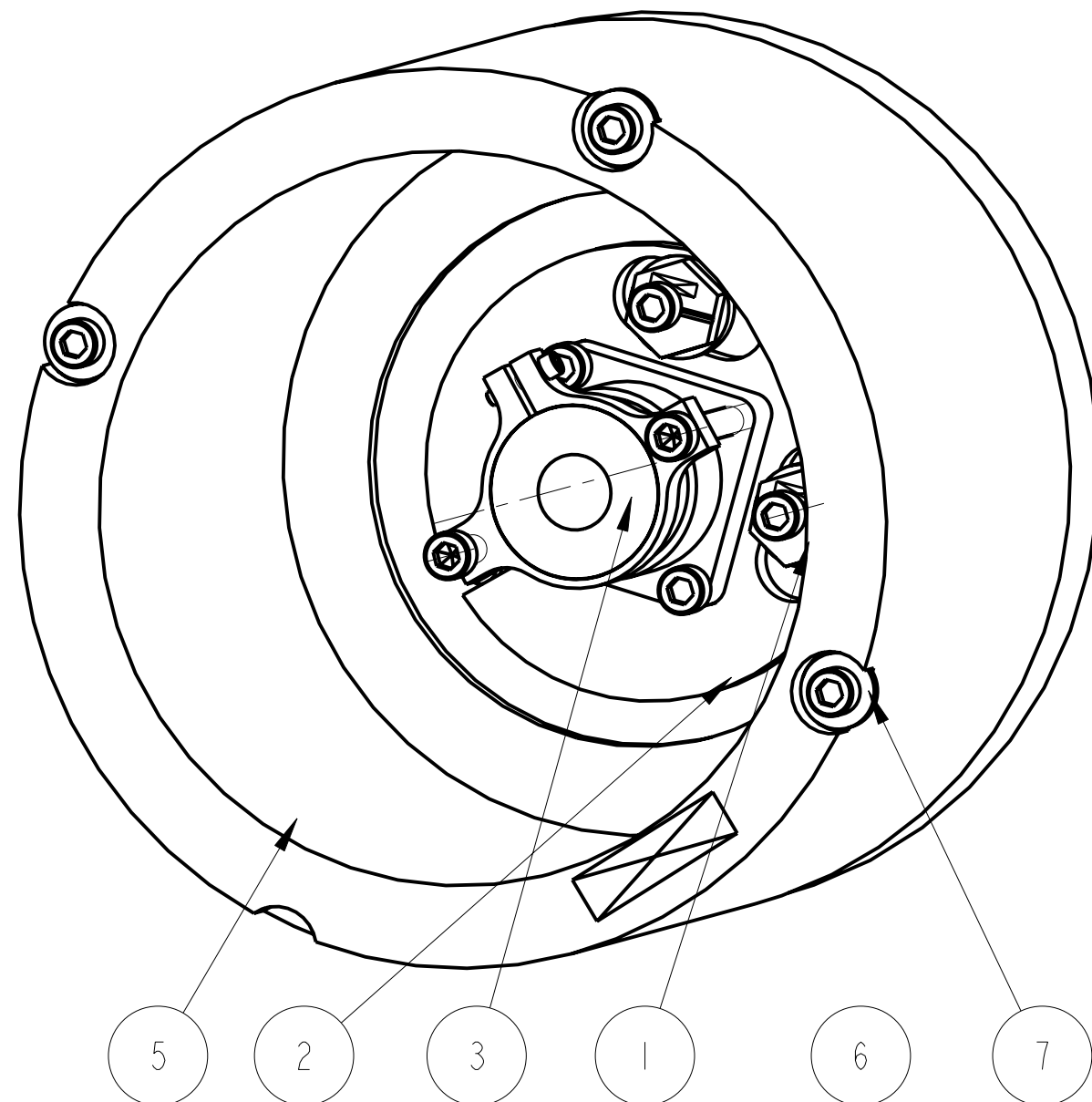
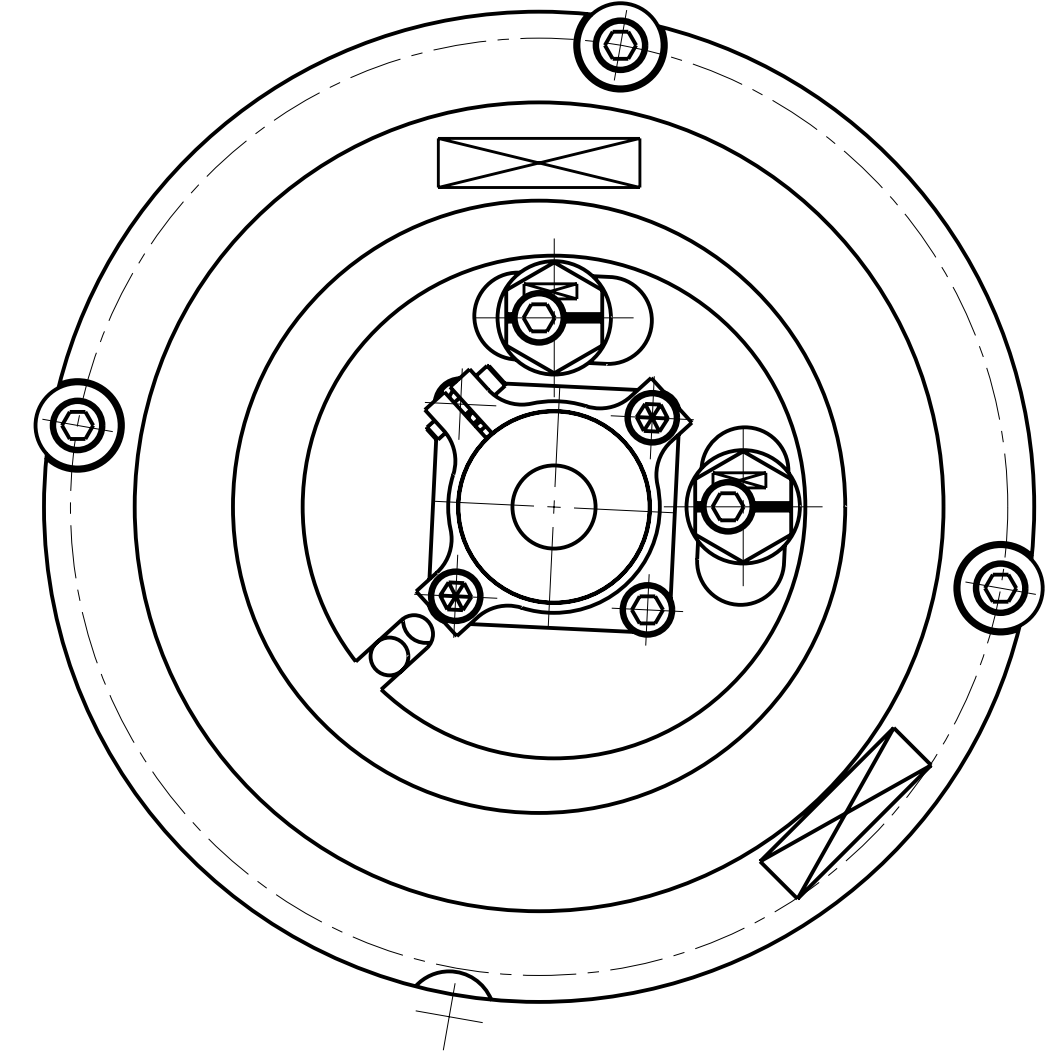

3-D VIEW

ITEM	QTY	SPARE	TOTAL	PART NUMBER	DESCRIPTION	MATERIALS
1	2			D060336	2MM CAM; OSEM ADJUSTER	PH BRONZE: -----
2	1			D060348	OSEM TRANSLATION PLATE; ETM PEN RE MASS CAN	AL ALLOY: 5083
3	1			D060349	LIGO 1 OSEM MOUNT; (FOR PENRE MASS)	AS DRW: ---
4	1			D080167	CAN FRONT PLATE; ITM PEN RE MASS CAN	ST. STEEL: 304 OR 316
5	1			D080168	CAN BODY; ITM PEN RE MASS CAN	ST. STEEL: 300 SERIES
6	11				8-32 UNC X 0.625" CAP HEAD; .	ST. STEEL: 300 SERIES
7	3				8-32 UNC WASHER; .	ST. STEEL: 300 SERIES

NOTES: (UNLESS OTHERWISE SPECIFIED)

- REMOVE ALL SHARP EDGES, R. 02 MIN.
- DO NOT SCALE FROM DRAWING.
- ALL MACHINING FLUIDS SHALL BE WATER SOLUBLE AND FREE OF SULFUR, CHLORINE AND SILICONE, SUCH AS CINCINNATI MILACRON'S CIMTECH 410 (STAINLESS STEEL)
- SCRIBE, ENGRAVE OR STAMP DRAWING PART NUMBER ON NOTED SURFACE OF PART AND A THREE DIGIT SERIAL NUMBER. SERIAL NUMBERS START AT 001 FOR THE FIRST PART AND PROCEED CONSECUTIVELY. USE .07" HIGH CHARACTERS. EXAMPLE: D020188-001. A VIBRATORY TOOL MAY BE USED.

DIMENSIONS ARE IN INCHES (mm)

TOLERANCES:

X.XX ± 0.01 (- mm)

X.XXX ± 0.005

ANGULAR ±

MATERIAL: AS DRW

FINISH: AS DRW

μm (μin) Ra =

NAME	DATE
DRAWN J O'DELL	08/APR/08
CHECKED IW	--/--/--
APPROVED IW	--/--/--

SCALE 1:1 PROJECTION

CALIFORNIA INSTITUTE OF TECHNOLOGY
 MASSACHUSETTS INSTITUTE OF TECHNOLOGY
 IGR, GLASGOW UNIVERSITY GEO 600 GROUP
 RUTHERFORD APPLETON LABORATORIES

SYSTEM **ADVANCED LIGO**

SUB-SYSTEM **SUS**

NEXT ASSY **PENRE ITM QUAD N-PTYPE**

PART NAME **ITM OSEM CAN**

DRG. NO. **D080166**

REV **01**

SHEET 1 OF 1