

FIRST ANGLE PROJECTION

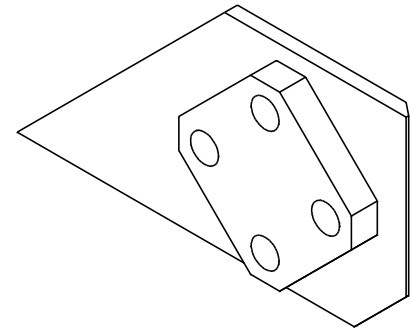
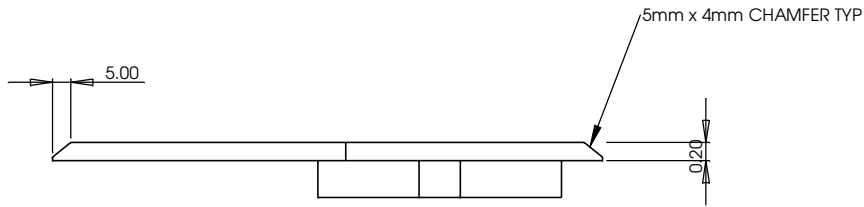
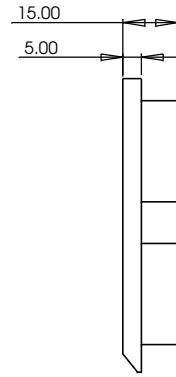
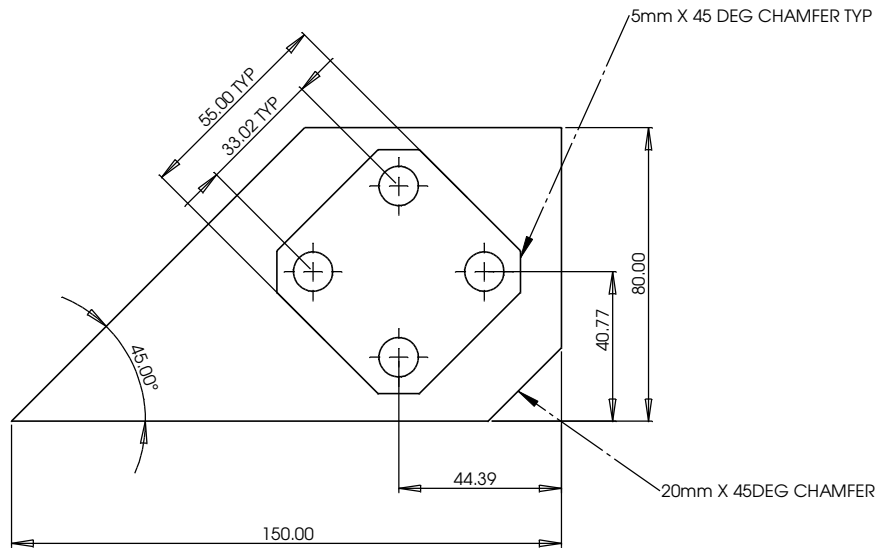

ITEM No 8

NOTES: (UNLESS OTHERWISE SPECIFIED)		PARTS LIST	
1. DO NOT SCALE FROM DRAWING. 2. REMOVE ALL SHARP EDGES, R.02 MAX. 3. ALL MACHINING FLUIDS SHALL BE WATER SOLUBLE AND FREE OF SULFUR, CHLORINE AND SILICONE.		DIMENSIONS ARE IN INCHES TOLERANCES: .X.X ± 0.01 .XXX ± 0.005 ANGULAR ± 0.1°	
4. SCRIBE, ENGRAVE OR MECHANICALLY STAMP DRAWING (NO INKS OR DYES) PART NUMBER, REVISION, ON NOTED SURFACE OF PART FOLLOWED ON THE NEXT LINE WITH A THREE DIGIT SERIAL NUMBER. SERIAL NUMBERS START AT 001 FOR THE FIRST ARTICLE AND PROCEED CONSECUTIVELY. USE 12" HIGH CHARACTERS, UNLESS THE SIZE OF THE PART DICTATES SMALL CHARACTERS. A VIBRATORY TOOL MAY BE USED. EXAMPLE: 0 0 5 0 2 4 7 -A S/N 001		CALIFORNIA INSTITUTE OF TECHNOLOGY MIT MASSACHUSETTS INSTITUTE OF TECHNOLOGY IGR, GLASGOW UNIVERSITY GEO 605 GROUP	
MATERIAL: ALUMINIUM ALLOY 6082		SYSTEM SUB-SYSTEM NEXT ASSY PART NAME	
FINISH: CLEAN		CORNER BRACKET No 2	
DRAWN: AXB CHECKED: APPROVED:	DATE: 27-10-06	SIZE: C DWG NO: NTE UPPER 008 SCALE: 1:1 PROJECTION:	REV: A SHEET 01