

REV.	DATE	DCN #	DRAWING TREE #
A	30-OCT-06	E060260-00	
B	21/DEC/07	E060260-B	

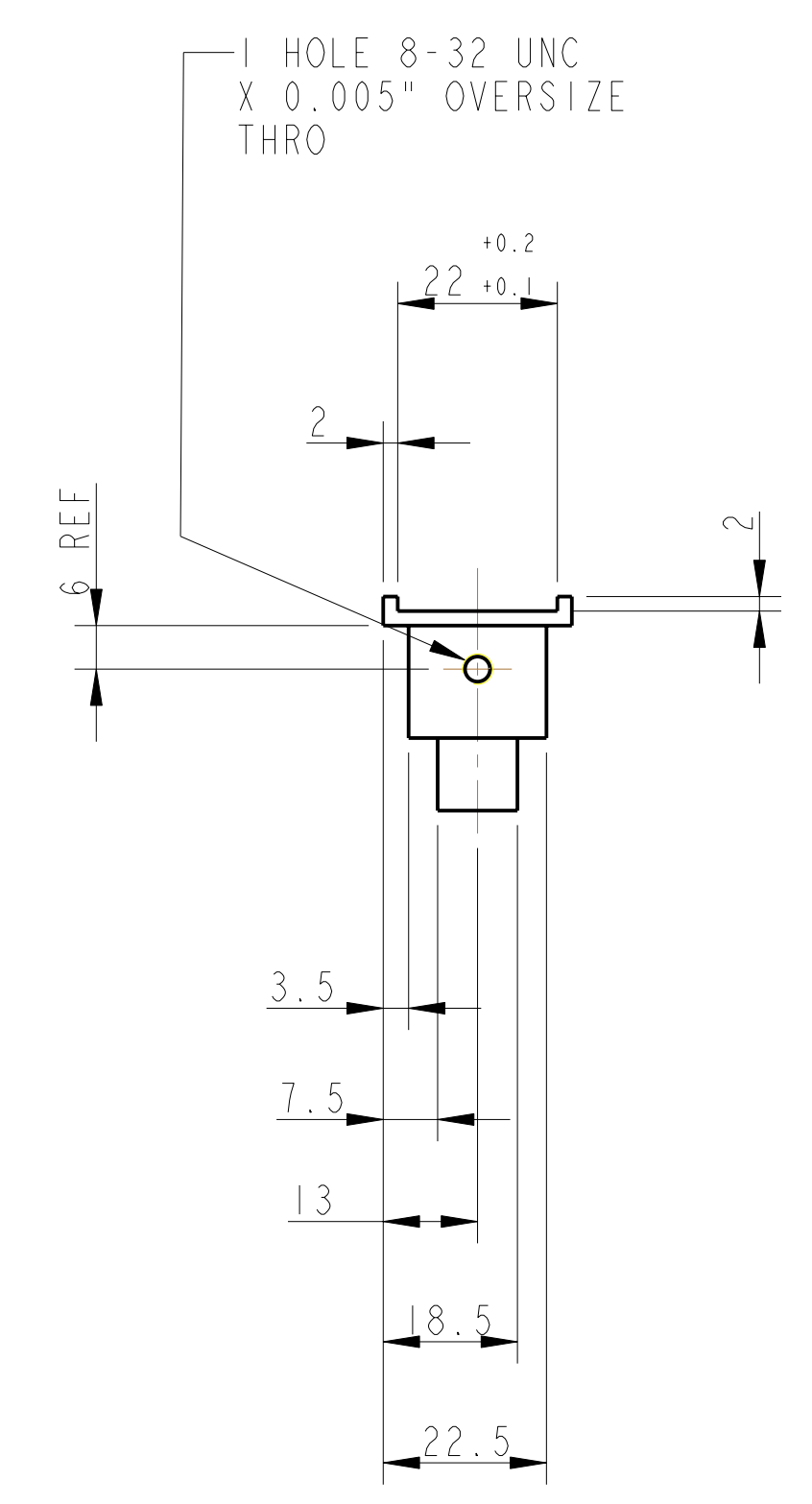

2 HOLES 8-32 X 0.005" OVERSIZE THRO

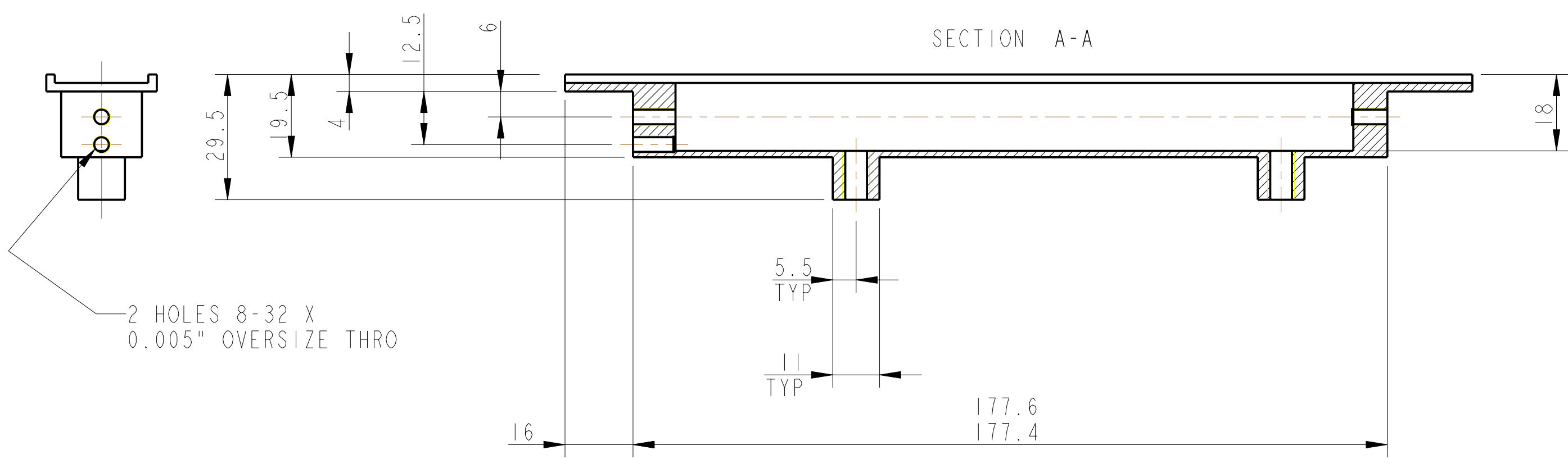
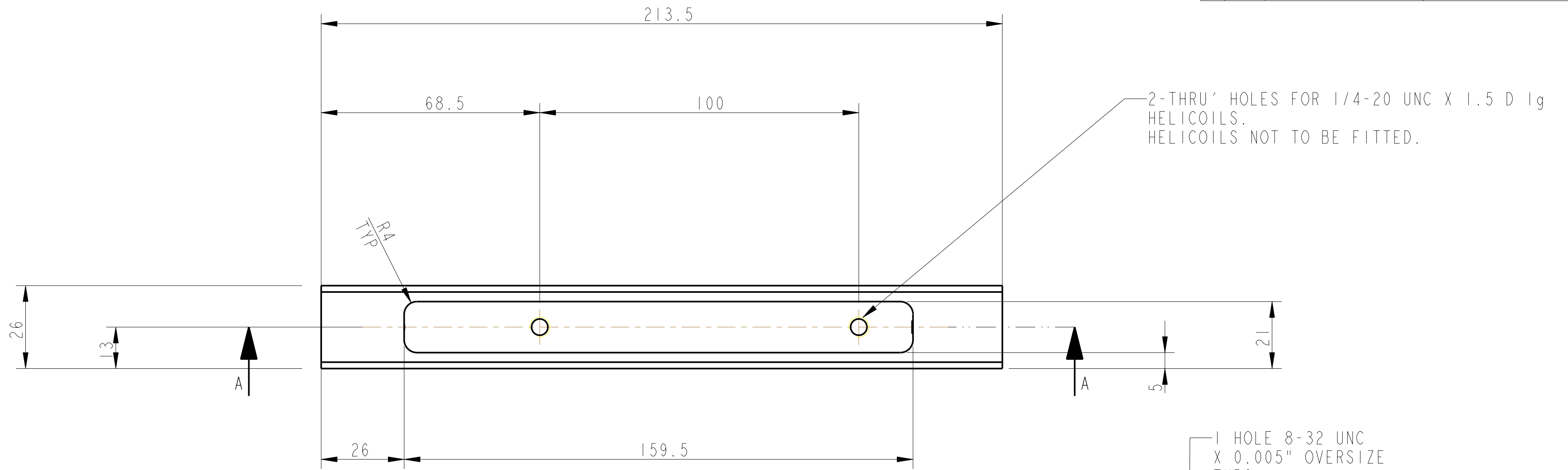
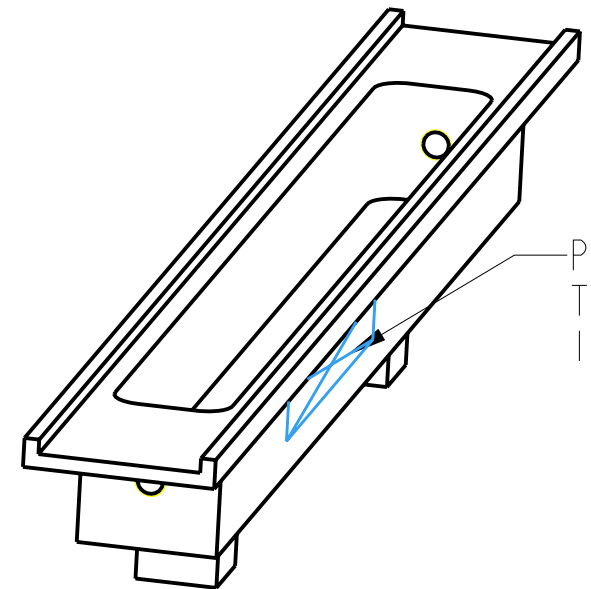

PART NO. (SEE NOTE 4) TO BE ETCHED OR STAMPED IN APPROX POSITION SHOWN.

NOTES: (UNLESS OTHERWISE SPECIFIED)

- REMOVE ALL SHARP EDGES, R. 02 MIN.
- DO NOT SCALE FROM DRAWING.
- ALL MACHINING FLUIDS SHALL BE WATER SOLUBLE AND FREE OF SULFUR, CHLORINE AND SILICONE, SUCH AS CINCINNATI MILACRON'S CIMTECH 410 (STAINLESS STEEL).
- SCRIBE, ENGRAVE OR STAMP DRAWING PART NUMBER ON NOTED SURFACE OF PART AND A THREE DIGIT SERIAL NUMBER. SERIAL NUMBERS START AT 001 FOR THE FIRST PART AND PROCEED CONSECUTIVELY. USE .07" HIGH CHARACTERS. EXAMPLE: D020188-001. A VIBRATORY TOOL MAY BE USED.

DIMENSIONS ARE IN mm (INCHES)		TOLERANCES:	
X.XX ± 0.2 mm (INCHES)		ANGULAR ± 0.25°	
MATERIAL: AL. ALLOY 5083 H4 OR 6061		FINISH: CLEAN Ra = 1.6	
DRAWN	NJS/FEL	DATE	17/JULY/06
CHECKED	MB	DATE	15/MAR/10
APPROVED	JOD	DATE	15/MAR/10

CALIFORNIA INSTITUTE OF TECHNOLOGY		GLASGOW UNIVERSITY GEO 600 GROUP	
RUTHERFORD APPLETON LABORATORIES		RUTHERFORD APPLETON LABORATORIES	
SYSTEM		aLIGO	
SUB-SYSTEM		SUS	
NEXT ASSY		QUAD LOWER STRUCTURE	
PART NAME		PENULTIMATE MASS LWR STOP MT 2	
SCALE	1:1	PROJECTION	1ST ANGLE
DRG. NO.	D060478	REV	C
SHEET		1 OF 1	