

SECTION A-A

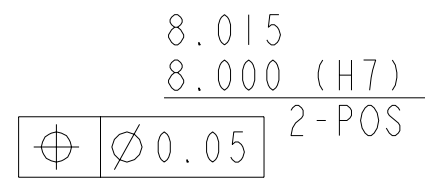

2-THRU' HOLES AND DRILL FOR
1/4-20 UNC X 1.5 D 1g HELICOILS
HELICOILS NOT TO
BE FITTED.

$\phi \phi 0.3$

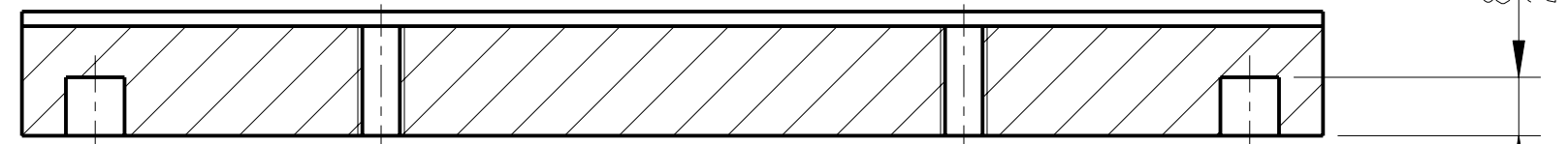
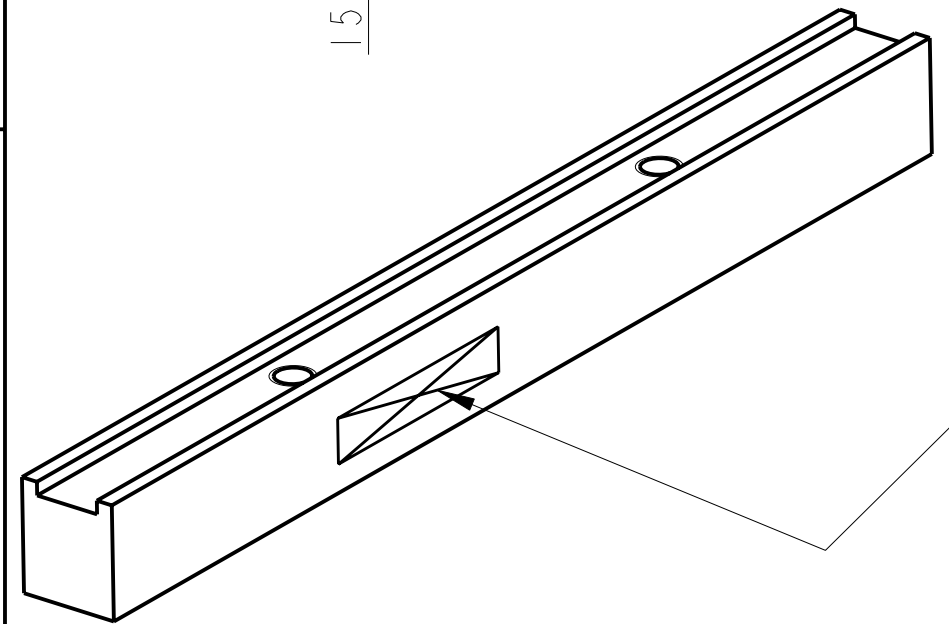
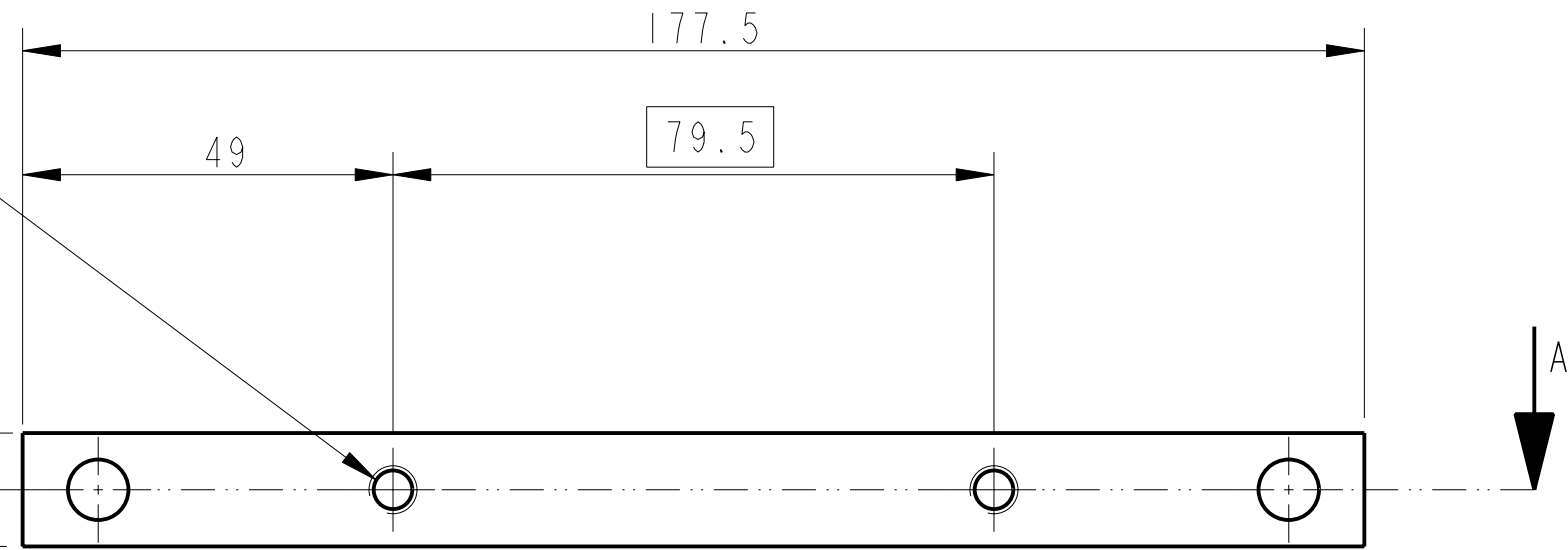

PART NO. (SEE NOTE 4)
TO BE ETCHED OR STAMPED
IN APPROX POSITION SHOWN.

NOTES: (UNLESS OTHERWISE SPECIFIED)

- REMOVE ALL SHARP EDGES, R.02 MIN.
- DO NOT SCALE FROM DRAWING.
- ALL MACHINING FLUIDS SHALL BE WATER SOLUBLE AND FREE OF SULFUR, CHLORINE AND SILICONE, SUCH AS CINCINNATI MILACRON'S CIMTECH 410 (STAINLESS STEEL)
- SCRIBE, ENGRAVE OR STAMP DRAWING PARTNUMBER ON NOTED SURFACE OF PART AND A THREE DIGIT SERIAL NUMBER. SERIAL NUMBERS START AT 001 FOR THE FIRST PART AND PROCEED CONSECUTIVELY. USE .07" HIGH CHARACTERS. EXAMPLE: D020188- 001. A VIBRATORY TOOL MAY BE USED.

DIMENSIONS ARE IN mm [INCHES]
TOLERANCES:
X.XX ±0.2 mm
ANGULAR ±0.25 °

MATERIAL: AL. ALLOY
5083 H4 OR 6061

FINISH: CLEAN
√μm [μin] Ra = 1.6

	NAME	DATE
DRAWN	NJS/FEL	1/AUG/06
CHECKED	J'OD	--/--/--
APPROVED	IW	--/--/--

CALIFORNIA INSTITUTE OF TECHNOLOGY MASSACHUSETTS INSTITUTE OF TECHNOLOGY IGR, GLASGOW UNIVERSITY GEO 600 GROUP RUTHERFORD APPLETON LABORATORIES	
SYSTEM	ADVANCED LIGO
SUB-SYSTEM	SUS
NEXT ASSY	QUAD N-PTYPE LOWER STRUCTURE
PART NAME	ADJUSTABLE PAD JAW ADJUSTABLE PAD ASSY (LONG)
SIZE	B
DRG. NO.	D060447
REV	A.
SCALE	1:1
PROJECTION	First Angle
SHEET	1 OF 1