

REV.	DATE	DCN #	DRAWING TREE #
A	19/OCT/06.	E060248	
H	15/JULY/08	E080368	

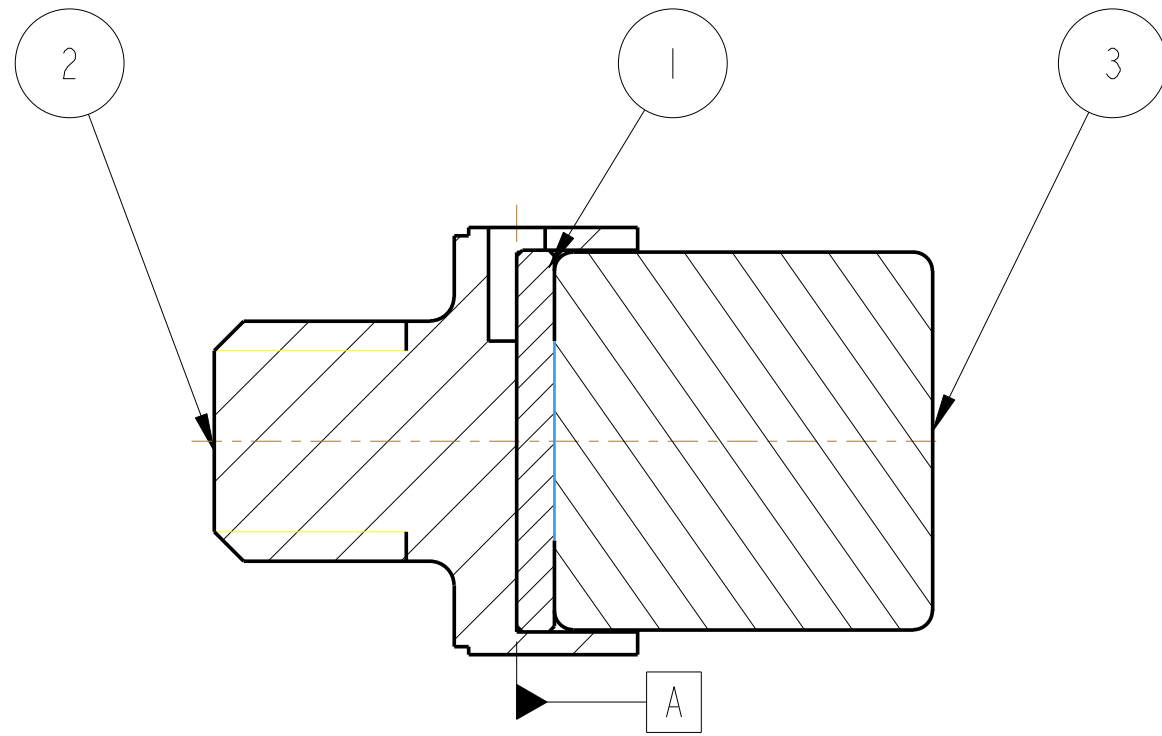

SECTION A-A

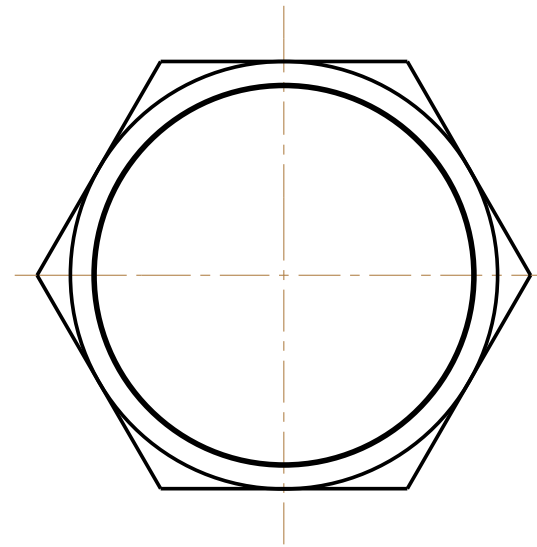

ITEM	QTY	SPARE	TOTAL	PART NUMBER	DESCRIPTION	MATERIALS
1	1			D060401	MAGNETIC PLUG; .	STAINLESS STEEL: 416
2	1			D060418	MAGNET RETAINER; (MODIFIED 1/4-20 HEX HEAD SCREW)	STAINLESS STEEL: 304/316
3	1				10MM MAGNET; .	

NOTES: (UNLESS OTHERWISE SPECIFIED)

- REMOVE ALL SHARP EDGES, R.02 MIN.
- DO NOT SCALE FROM DRAWING.
- ALL MACHINING FLUIDS SHALL BE WATER SOLUBLE AND FREE OF SULFUR, CHLORINE AND SILICONE, SUCH AS CINCINNATI MILACRON'S CIMTECH 410 (STAINLESS STEEL)
- SCRIBE, ENGRAVE OR STAMP DRAWING PART NUMBER ON NOTED SURFACE OF PART AND A THREE DIGIT SERIAL NUMBER. SERIAL NUMBERS START AT 001 FOR THE FIRST PART AND PROCEED CONSECUTIVELY. USE .07" HIGH CHARACTERS. EXAMPLE: D020188- 001. A VIBRATORY TOOL MAY BE USED.

DIMENSIONS ARE IN mm [INCHES]

TOLERANCES:
 X.XX ±0.2 mm
 ANGULAR ±0.25 °

MATERIAL: AS BOM

FINISH: AS DRW
 √μm [μin] Ra = -----

	NAME	DATE
DRAWN	I WILMUT	10/AUG/06
CHECKED	AJB	5MAY08
APPROVED	AJB	157/JULY/08

LOGO CALIFORNIA INSTITUTE OF TECHNOLOGY
 MASSACHUSETTS INSTITUTE OF TECHNOLOGY
 1GR, GLASGOW UNIVERSITY GEO 600 GROUP
 RUTHERFORD APPLETON LABORATORIES

SYSTEM **ADVANCED LIGO**

SUB-SYSTEM **SUS**

NEXT ASSY **TOP MASS QUAD N-PTYPE**

PART NAME **OSEM MAGNET AND FLAG CONCEPT**

PART BUILT

SCALE 5:1 | PROJECTION: | SHEET 1 OF 1

D
C
B
A

D
C
B
A