

REV.	DATE	DCN #	DRAWING TREE #
v1	15 SEP 2009	E0900302	E080191
-	-	-	-
-	-	-	-

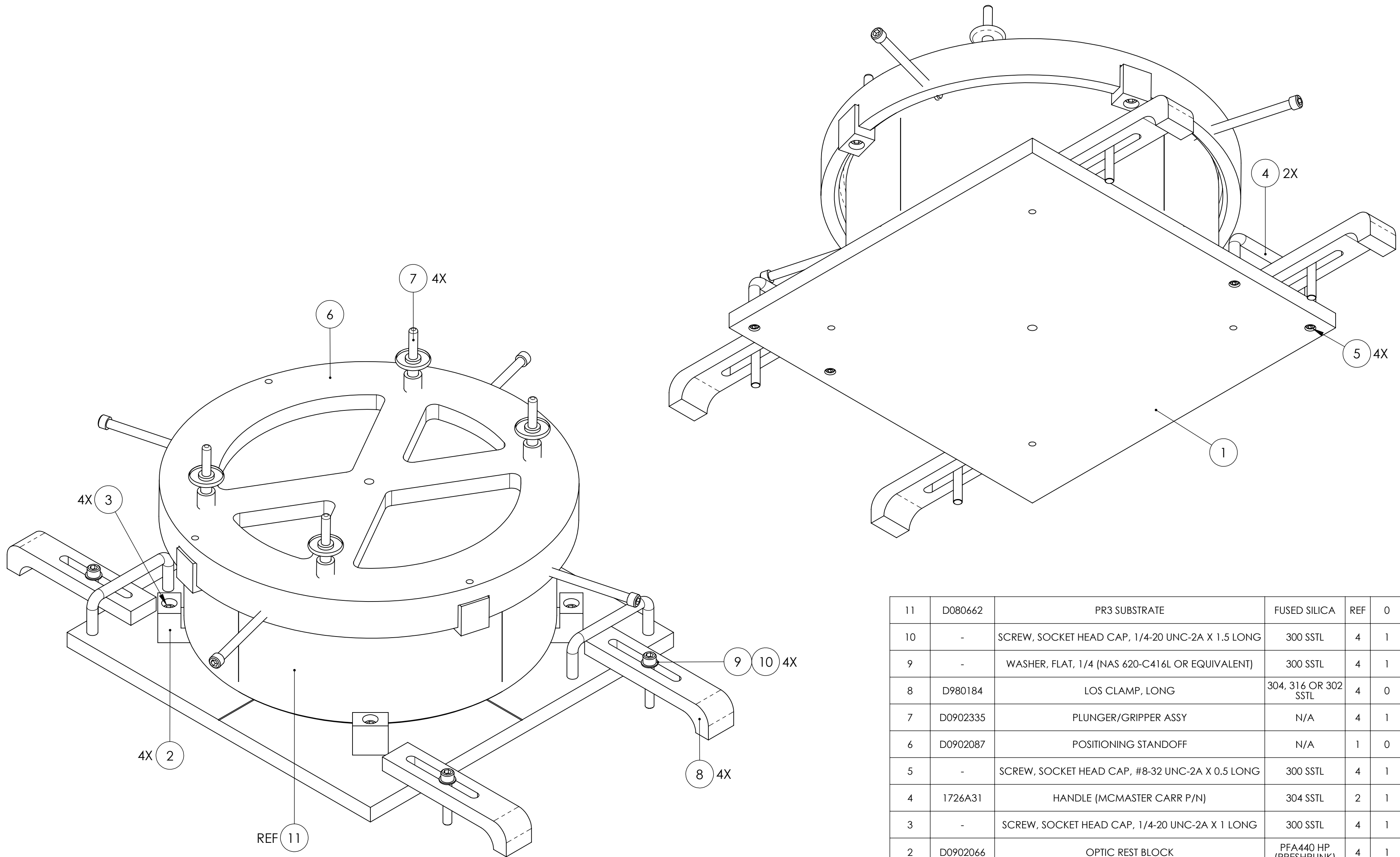

ITEM NO.	PART NUMBER	DESCRIPTION	MATERIAL	REQ	SPARE	TOTAL
11	D080662	PR3 SUBSTRATE	FUSED SILICA	REF	0	0
10	-	SCREW, SOCKET HEAD CAP, 1/4-20 UNC-2A X 1.5 LONG	300 SSTL	4	1	5
9	-	WASHER, FLAT, 1/4 (NAS 620-C416L OR EQUIVALENT)	300 SSTL	4	1	5
8	D980184	LOS CLAMP, LONG	304, 316 OR 302 SSTL	4	0	4
7	D0902335	PLUNGER/GRIPPER ASSY	N/A	4	1	5
6	D0902087	POSITIONING STANDOFF	N/A	1	0	1
5	-	SCREW, SOCKET HEAD CAP, #8-32 UNC-2A X 0.5 LONG	300 SSTL	4	1	5
4	1726A31	HANDLE (MCMASTER CARR P/N)	304 SSTL	2	1	3
3	-	SCREW, SOCKET HEAD CAP, 1/4-20 UNC-2A X 1 LONG	300 SSTL	4	1	5
2	D0902066	OPTIC REST BLOCK	PFA440 HP (PRESHRUNK)	4	1	5
1	D0902064	BASE PLATE	6061-T6 Al	1	0	1
PARTS LIST						

NOTES AND TOLERANCES: (UNLESS OTHERWISE SPECIFIED)				<b>CALIFORNIA INSTITUTE OF TECHNOLOGY MASSACHUSETTS INSTITUTE OF TECHNOLOGY</b>		<b>PART NAME</b> <b>MAGNET PLACEMENT FIXTURE, TEST MASS</b>				
SYSTEM		SUB-SYSTEM		DESIGNER	D. BRIDGES	16 SEP 2009	SIZE	DWG. NO.		REV.
ADVANCED LIGO		SUS		DRAFTER	D. BRIDGES	5 OCT 2009	<b>C</b>	<b>D0901460</b>		v1
MATERIAL		FINISH		NEXT ASSY		CHECKER				M. MEYER
N/A		N/A μinch		HLTS OVERALL ASSY AND FIXTURES		SCALE: 1:2		PROJECTION:	SHEET 1 OF 1	