

NOTES CONTINUED:
 ⑤ SCRIBE, ENGRAVE, OR MECHANICALLY STAMP (NO INKS OR DYES) DRAWING PART NUMBER AND REVISION ON NOTED SURFACE FOLLOWED ON THE NEXT LINE BY A THREE DIGIT SERIAL NUMBER. SERIAL NUMBERS START AT 001 FOR THE FIRST ARTICLE AND PROCEED CONSECUTIVELY. USE .07" HIGH CHARACTERS. EXAMPLE: DXXXXXX-VY, S/N 001. A VIBRATORY TOOL MAY BE USED.

REV.	DATE	DCN #	DRAWING TREE #
-	-	REFER TO E0900200-v1	-
-	-	-	-
-	-	-	-

D0901317 Plastic Insert, Base, Alum Box Rnd, ETM, PART PDM REV: X-000, DRAWING PDM REV: X-001

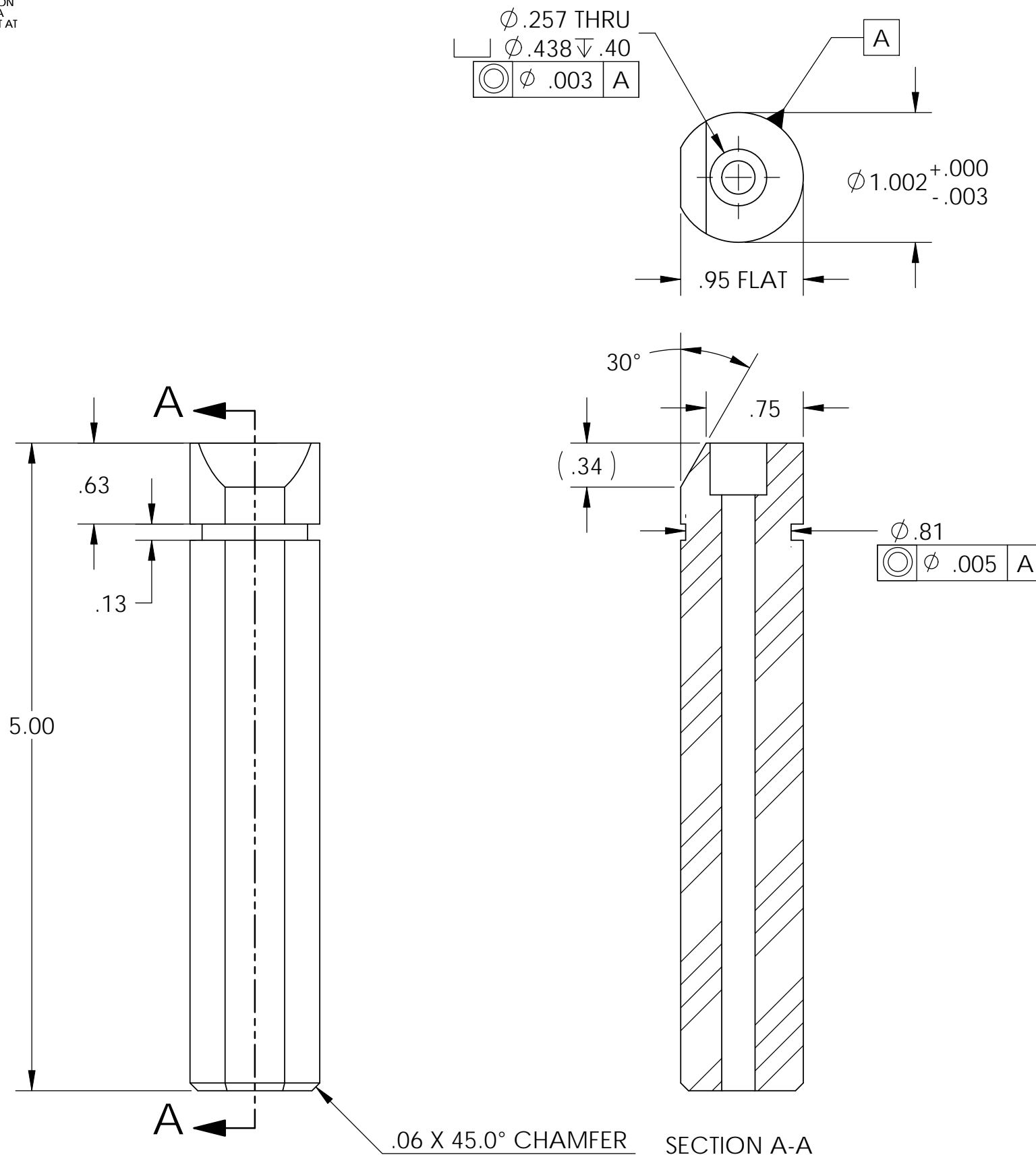

NOTES AND TOLERANCES: (UNLESS OTHERWISE SPECIFIED)	
DIMENSIONS ARE IN INCHES	
TOLERANCES: .XX ± 0.01 .XXX ± 0.005	
ANGULAR ± 0.5°	
1. INTERPRET DRAWING PER ASME Y14.5-1994. 2. REMOVE ALL SHARP EDGES, R.02 MIN. 3. DO NOT SCALE FROM DRAWING. 4. ALL MACHINING FLUIDS SHALL BE WATER SOLUBLE AND FREE OF SULFUR, CHLORINE AND SILICONE, SUCH AS CINCINNATI MILACRON'S CIMTECH 410.	
MATERIAL	FINISH
PFA 440 HP	32 μ inch

LIGO CALIFORNIA INSTITUTE OF TECHNOLOGY MASSACHUSETTS INSTITUTE OF TECHNOLOGY		PART NAME	
ADVANCED LIGO		Plastic Insert, Base, ETM Optic Container	
SYSTEM	SUB-SYSTEM	DESIGNER	DATE
ADVANCED LIGO	COC	ED CHAVEZ	17 JUN 2009
CHECKER	APPROVAL	ED CHAVEZ	14 JUL 2009
REFER TO E0900200-v1	REFER TO E0900200-v1	SIZE	DWG. NO.
REFER TO E0900200-v1	REFER TO E0900200-v1	B	D0901317
SCALE: 2:1	PROJECTION:	REV.	
		v1	
SHEET 1 OF 1			