

REV.	DATE	DCN #	DRAWING TREE #
A	17/OCT/06	E060242	.

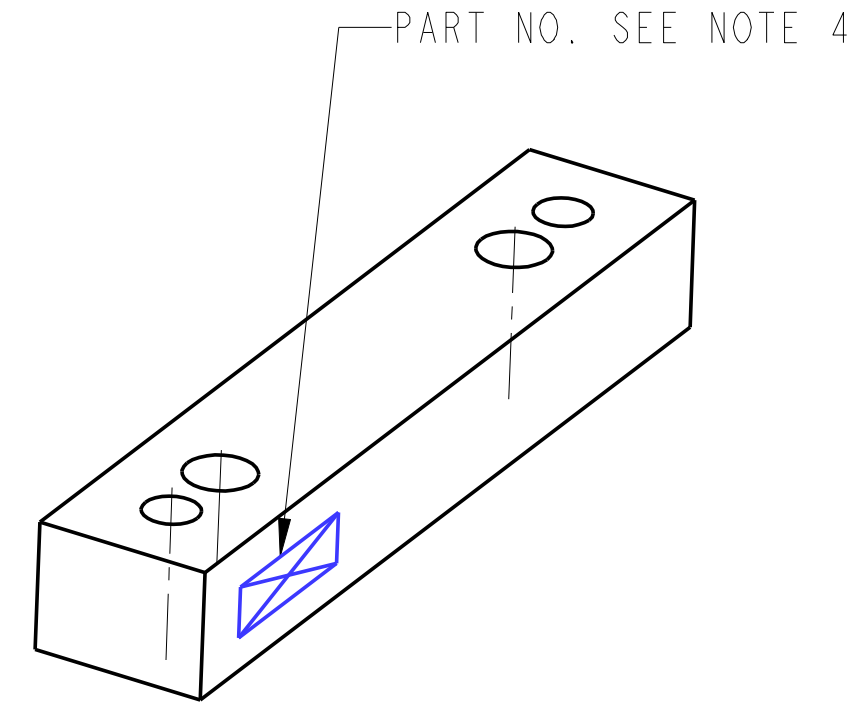
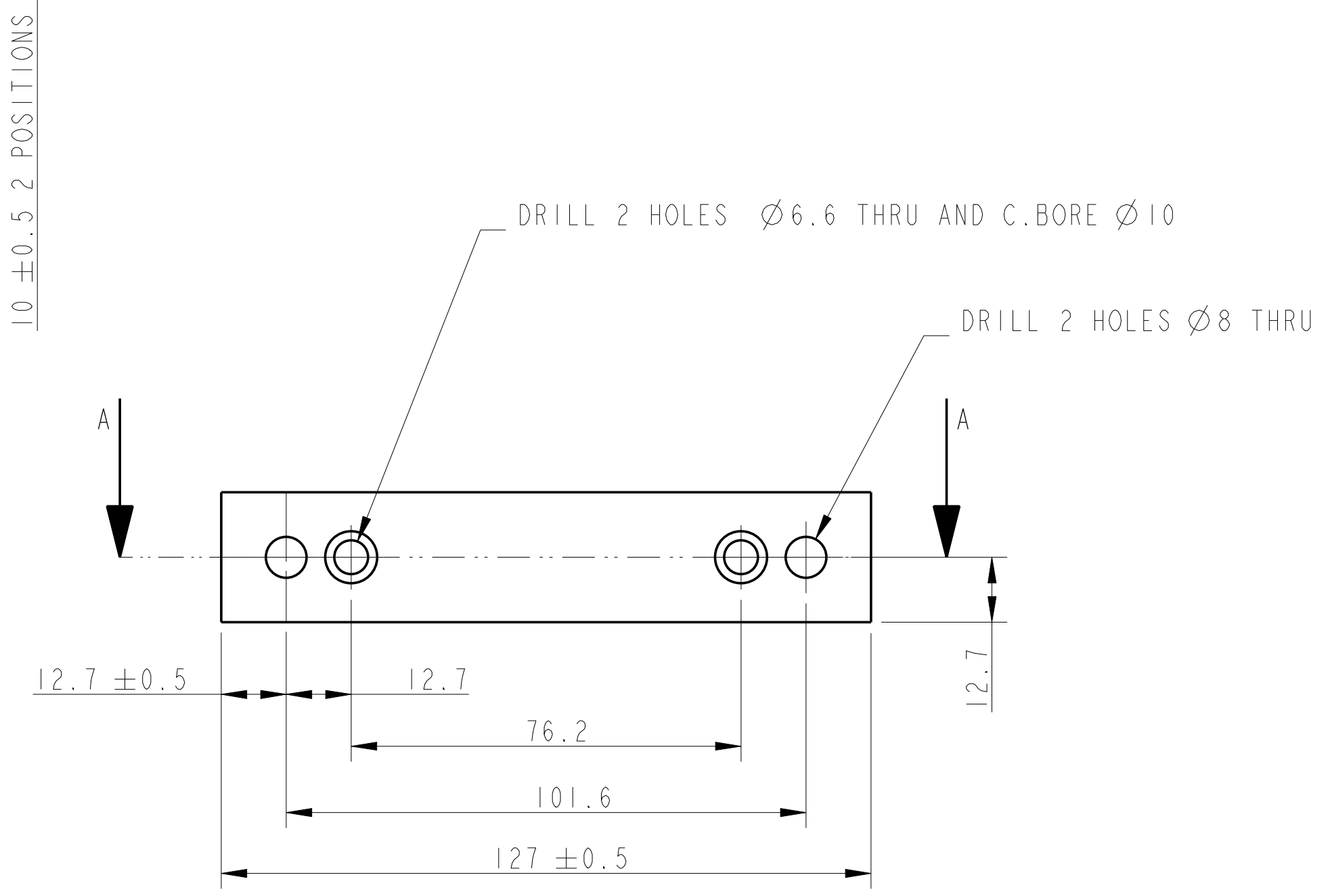
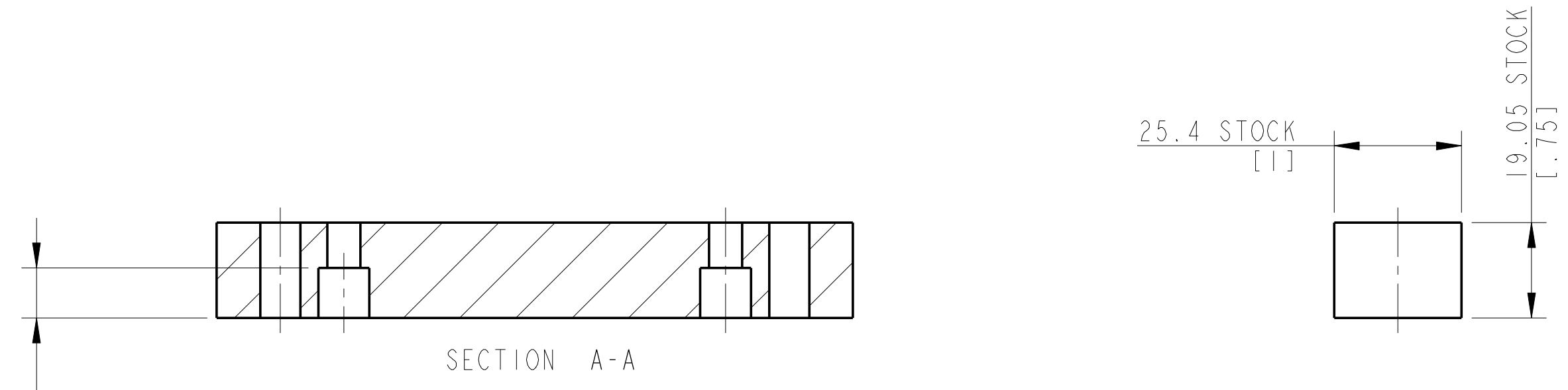

3D VIEW

NOTES: (UNLESS OTHERWISE SPECIFIED)

- REMOVE ALL SHARP EDGES. R.02 MIN.
- DO NOT SCALE FROM DRAWING.
- ALL MACHINING FLUIDS SHALL BE WATER SOLUBLE AND FREE OF SULFUR, CHLORINE AND SILICONE. SUCH AS CINCINNATI MILACRON'S CIMTECH 410 (STAINLESS STEEL)
- SCRIBE, ENGRAVE OR STAMP DRAWING PART NUMBER ON NOTED SURFACE OF PART AND A THREE DIGIT SERIAL NUMBER. SERIAL NUMBERS START AT 001 FOR THE FIRST PART AND PROCEED CONSECUTIVELY. USE .07" HIGH CHARACTERS. EXAMPLE: 0020188-001. A VIBRATORY TOOL MAY BE USED.

DIMENSIONS ARE IN mm [INCHES]

X.XX ± mm [INCHES]

ANGULAR ±0.25°

MATERIAL: AL ALLOY 6061 T6

FINISH: CLEAN AND DEGREASED
√μm [μin] Ra = 63 [1.6]

SIZE	NAME	DATE
DRAWN	I WILMUT	19/SEP/06
CHECKED	J'OD	17/OCT/06
APPROVED	RJG	17/OCT/06

CALIFORNIA INSTITUTE OF TECHNOLOGY MASSACHUSETTS INSTITUTE OF TECHNOLOGY 1GR, GLASGOW UNIVERSITY GEO 600 GROUP RUTHERFORD APPLETON LABORATORIES	
SYSTEM	ADVANCED LIGO
SUB-SYSTEM	SUS
NEXT ASSY	QUAD INPTYPE TOP STAGE: TOP STAGE BLADE TOOLING
PART NAME	STRAIGHTNING TOOLING FEET
DRG. NO.	D060369
SCALE	1:1
PROJECTION	1
SHEET	1 OF 1