

REV.	DATE	DCN #	DRAWING TREE #
A	24 JUN 2004	E040303-00	
B	9 APR 2008	E080156-00	

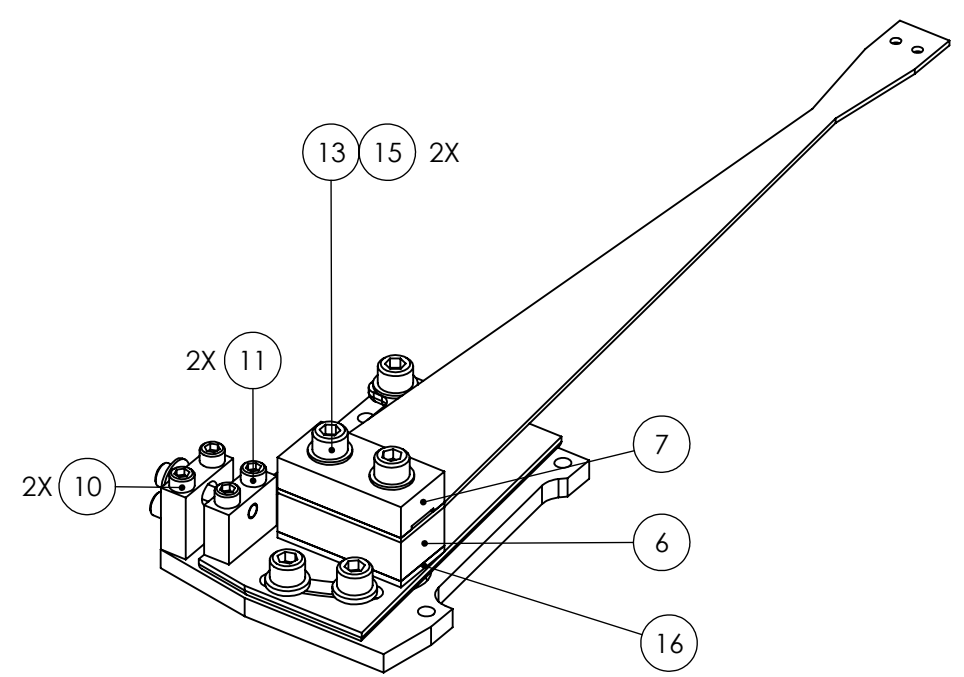
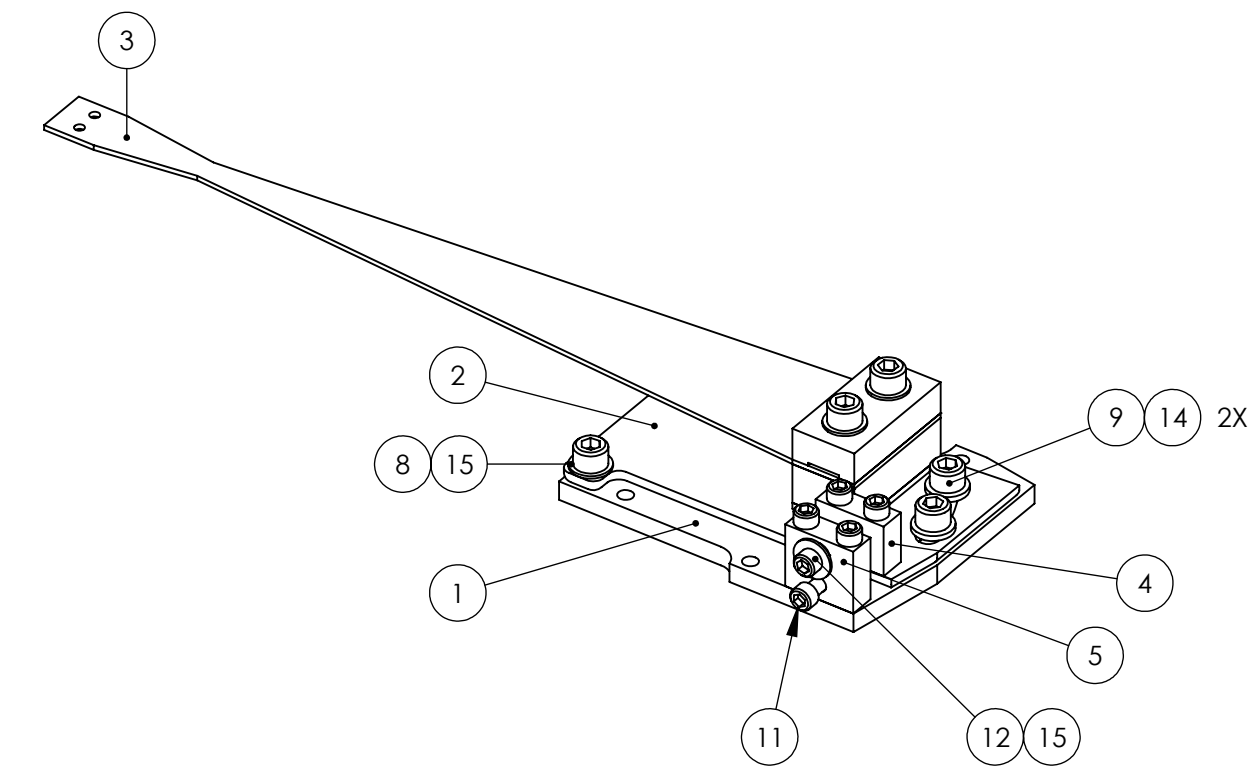

ALT	REQ	SPARE	TOTAL	PART NUMBER	DESCRIPTION	MATERIAL
				D020677	LIBRARY OF CLAMPS (SELECT ANGLED SET FOR CHOSEN BLADE) ALT TO D020166 AND D030459	302, 304 OR 316 SSSL
16	1	0	1	D020680	UPPER BLADE CLAMP LOWER SIDE SHIM 2 mm	302, 304 OR 316 SSSL
15	4	1	5	--	FLAT WASHER, 1/4 (NAS 620-C416L OR EQUIVALENT)	300 SSSL
14	2	0	2	--	FLAT WASHER, 1/4 (NAS 620-C416 OR EQUIVALENT)	300 SSSL
13	2	0	2	--	SCREW, SOCKET HEAD CAP, 1/4-20 UNC-2A X 1.25 LONG	Ag-PLATED SSSL
12	1	0	1	--	SCREW, SOCKET HEAD CAP, #8-32 UNC-2A X 1 LONG	Ag-PLATED SSSL
11	3	0	3	--	SCREW, SOCKET HEAD CAP, #8-32 UNC-2A X 0.75 LONG	Ag-PLATED SSSL
10	2	0	2	--	SCREW, SOCKET HEAD CAP, #8-32 UNC-2A X 1 LONG	300 SSSL
9	2	0	2	--	SCREW, SOCKET HEAD CAP, 1/4-20 UNC-2A X 0.5 LONG	300 SSSL
8	1	0	1	--	SCREW, SOCKET HEAD CAP, 1/4-20 UNC-2A X 0.375 LONG	300 SSSL
7	1	0	1	D020116	UPPER BLADE CLAMP UPPER SIDE 0.0 DEGREE	302, 304 OR 316 SSSL
6	1	0	1	D030459	UPPER BLADE CLAMP LOWER SIDE 0.0 DEGREE	302, 304 OR 316 SSSL
5	1	0	1	D030449	PUSH PLATE	302, 304 OR 316 SSSL
4	1	0	1	D030450	PULL PLATE	302, 304 OR 316 SSSL
3	1	1	2	D020205	UPPER BLADE	MARAGING STEEL C250
2	1	0	1	D030447	ROTATING PLATE	302, 304 OR 316 SSSL
1	1	0	1	D030448	BASE PLATE	6061-T6 Al
ITEM NO.	REQ	SPARE	TOTAL	PART NUMBER	DESCRIPTION	MATERIAL

PARTS LIST

NOTES: (UNLESS OTHERWISE SPECIFIED)

DIMENSIONS ARE IN INCHES
 TOLERANCES:
 .XX ± 0.01
 .XXX ± 0.005
 ANGULAR ± 0.5 °
 MATERIAL --
 FINISH --

	NAME	DATE
DRAWN	MPL (IGR)	4 SEP 2003
CHECKED	D. BRIDGES	21 MAY 2008
APPROVED		

LIGO CALIFORNIA INSTITUTE OF TECHNOLOGY
 MASSACHUSETTS INSTITUTE OF TECHNOLOGY
 IGR, GLASGOW UNIVERSITY GEO 600 GROUP

SYSTEM **ADVANCED LIGO**

SUB-SYSTEM **SUS**

NEXT ASSY **OUTPUT MODE CLEANER**

PART NAME **ROTATIONAL ADJUSTER ASSEMBLY**

SIZE DWG. NO. **B D030451** REV. **B**

SCALE: 1:1 PROJECTION: SHEET 1 OF 1