

4

3

2

1

NOTES CONTINUED:

- 5. SCRIBE, ENGRAVE, OR MECHANICALLY STAMP (NO DYES OR INKS) A UNIQUE THREE DIGIT SERIAL NUMBER & REVISION NUMBER ON EACH PART. SERIAL NUMBERS START AT 001 FOR THE FIRST ARTICLE AND PROCEED CONSECUTIVELY. BAG AND TAG PARTS WITH THEIR DRAWING PART NUMBER, REVISION, VARIANT OR "TYPE" (IF APPLICABLE), AND QUANTITY. IF PARTS ARE TOO SMALL TO SCRIBE, BAGGING AND TAGGING ALONE IS SUFFICIENT.
EXAMPLE (PART): 001-v1
EXAMPLE (TAG): DXXXXXX-VY, TYPE-XX, QTY: TBD
- 6. PART IS TO BE MADE FROM STOCK SOCKET HEAD CAP SCREW, 1/4-20 UNC-2A, FULLY THREADED.

REV.	DATE	DCN #	DRAWING TREE #
v1	12 AUG 2009	E0900239	-
v2	30 DEC 2009	E0900505	-
-	-	-	-

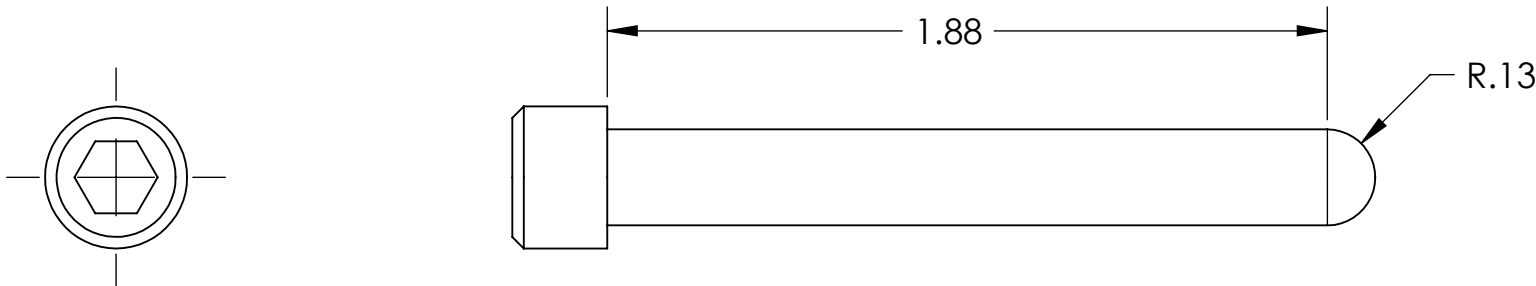

NOTES AND TOLERANCES: (UNLESS OTHERWISE SPECIFIED)

DIMENSIONS ARE IN INCHES

TOLERANCES:
.XX ± .01
.XXX ± .005

ANGULAR ± 0.5°

1. INTERPRET DRAWING PER ASME Y14.5-1994.
2. REMOVE ALL SHARP EDGES, R.02 MIN.
3. DO NOT SCALE FROM DRAWING.
4. ALL MACHINING FLUIDS MUST BE FULLY SYNTHETIC, FULLY WATER SOLUBLE AND FREE OF SULFUR, SILICONE, AND CHLORINE.

MATERIAL 300 SSSL **FINISH** N/A μinch

LIGO CALIFORNIA INSTITUTE OF TECHNOLOGY
MASSACHUSETTS INSTITUTE OF TECHNOLOGY

SYSTEM **ADVANCED LIGO** SUB-SYSTEM

NEXT ASSY **MULTIPLE ASSYS**

PART NAME SCREW, SOCKET HEAD CAP,
1/4-20 UNC-2A X 2 LONG, FULLY THREADED, ROUNDED END

DESIGNER D. BRIDGES	12 AUG 2009	SIZE DWG. NO.	REV.
DRAFTER D. BRIDGES	24 FEB 2010	A D0900999	v2
CHECKER M. MEYER	24 FEB 2010	SCALE: 2:1	PROJECTION:
APPROVAL			SHEET 1 OF 1

4

3

2

1