

4

3

2

1

NOTES CONTINUED:

- 5. BAG ALL ITEMS INDIVIDUALLY AND MARK OR TAG EACH BAG WITH DRAWING NUMBER, REVISION, AND QUANTITY. EXAMPLE: DXXXXXX-VY, QTY: 1
- 6. PART IS TO BE MADE FROM STOCK SOCKET HEAD CAP SCREW, 1/4-20 UNC-2A, FULLY THREADED.

REV.	DATE	DCN #	DRAWING TREE #
v1	08 MAY 2009	E0900129	-
-	-	-	-
-	-	-	-

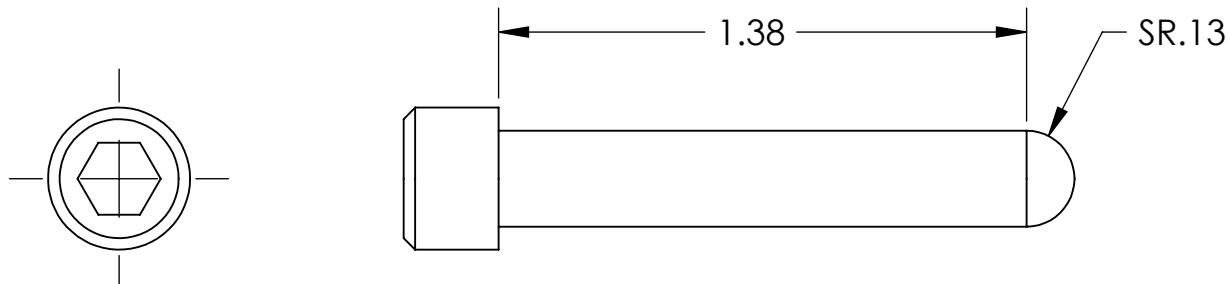

NOTES AND TOLERANCES: (UNLESS OTHERWISE SPECIFIED)

DIMENSIONS ARE IN INCHES

TOLERANCES:  
 .XX ± .01  
 .XXX ± .005

ANGULAR ± 0.5°

1. INTERPRET DRAWING PER ASME Y14.5-1994.
2. REMOVE ALL SHARP EDGES, R.02 MIN.
3. DO NOT SCALE FROM DRAWING.
4. ALL MACHINING FLUIDS SHALL BE WATER SOLUBLE AND FREE OF SULFUR, CHLORINE AND SILICONE, SUCH AS CINCINNATI MILACRON'S CIMTECH 410.

MATERIAL: 300 SSSL  
 FINISH: N/A μinch

**LIGO** CALIFORNIA INSTITUTE OF TECHNOLOGY  
 MASSACHUSETTS INSTITUTE OF TECHNOLOGY

SYSTEM: **ADVANCED LIGO**  
 SUB-SYSTEM:  
 NEXT ASSY: **MULTIPLE ASSYS**

PART NAME				SCREW, SOCKET HEAD CAP, 1/4-20 UNC-2A X 1.5 LONG, FULLY THREADED, ROUNDED END			
DESIGNER		SIZE	DWG. NO.	REV.			
DRAFTER	D. BRIDGES	29 JUL 2009	A	<b>D0900997</b>	v1		
CHECKER	M. MEYER	29 JUL 2009					
APPROVAL			SCALE: 2:1	PROJECTION:	SHEET 1 OF 1		

4

3

2

1